



DEPARTMENT OF THE ARMY
U.S. ARMY CORPS OF ENGINEERS, MOBILE DISTRICT
P.O. BOX 2288
MOBILE, AL 36628-0001

CESAM-RD-M
PUBLIC NOTICE NO. SAM-2023-00464-MJF

August 22, 2023

JOINT PUBLIC NOTICE

U.S. ARMY CORPS OF ENGINEERS (USACE)

**MISSISSIPPI DEPARTMENT OF ENVIRONMENTAL QUALITY
OFFICE OF POLLUTION CONTROL (MDEQ)**

**MISSISSIPPI DEPARTMENT OF MARINE RESOURCES
DMR23-000386**

**PROPOSED WETLAND FILL FOR ROADWAY IMPROVMENTS, GREENFIELDS
ROAD, CITY OF MOSS POINT, JACKSON COUNTY, MISSISSIPPI**

TO WHOM IT MAY CONCERN:

This District has received an application for a Department of the Army permit pursuant to Section 404 of the Clean Water Act (33 USC 1344). Please communicate this information to interested parties.

APPLICANT: Jackson County Board of Supervisors
Attention: Mr. Joe O'Neal
2915 Canty Street
Pascagoula, Mississippi 39557-4239
Joe_oneal@co.jackson.ms.us

WATERWAY AND LOCATION: Wetlands Associated with Black Creek, Greenfields Road, City of Moss Point, Jackson County, Mississippi. Section 28, Township 6 S, Range 5 W, Latitude: 30.494533° N Longitude -88.476656° W.

PROPOSED WORK: The applicant proposes to fill 0.796 acres of wetlands associated with raising the elevations of a segment of Greenfields Road in Moss Point, Jackson County, Mississippi. The proposed work would raise the elevation of a 2,138 feet segment of Greenfields Road beginning approximately 143 feet west of Lily Orchard Road and terminating approximately 1,995 feet east of Lily Orchard Road. Work would include the fill or existing roadside ditches and constructing new drainage ditches to the north and south of Greenfields Road. Work would also include the replacement of three existing culverts. In addition to road improvements, the County proposes to widen and make slope corrections to the banks of an existing outfall channel on the east side of Lily Orchard Road. The applicant proposes to provide in-kind compensatory mitigation through a mitigation bank.

COASTAL ZONE: The applicant has applied for coastal zone (CZ) consistency in accordance with the State Coastal Zone Management Program. A determination relative to CZ consistency will be made by the Mississippi Department of Marine Resources. (DMR23-000386).

WATER QUALITY: The Clean Water Act (CWA) Section 401 Certification Rule (Certification Rule, 40 CFR 121), requires certification for any license or permit that authorizes an activity that may result in a discharge. The applicant is responsible for requesting certification and providing required information to the certifying agency. As of the date of this public notice, the applicant has not submitted a certification request to the Mississippi Department of Environmental Quality (certifying authority).

HISTORIC PROPERTIES: In accordance with Section 106 of the National Historic Preservation Act, and Appendix C of 33 CFR 325, the undertaking defined in this notice is being considered for the potential to affect historic properties. In accordance with Appendix C of 33 CFR 325, the Corps has determined the permit area consists of the entire undertaking in waters of the United States, which includes the footprint of the proposed fill areas, and portions of the adjacent property that would be utilized for construction access and equipment and materials staging. The National Register of Historic Places will be consulted for properties listed, or eligible for listing, in the National Register, which are known to exist and would be affected by the proposed work. The Mobile District is seeking comments regarding the existence, or the potential for existence, of significant cultural and historic properties within the permit area. At this time, the USACE, Mobile District has made no determination regarding potential effects of the project on cultural/historic resources. Further coordination with the State Historic Preservation Officer and/or federally-recognized American Indian tribes will be performed as determined to be appropriate.

ENDANGERED SPECIES: Preliminary review of this application and the U.S. Department of the Interior's List of Endangered and Threatened Wildlife and Plants indicate the following federally-listed species are known or expected to occur within the project area: Mississippi Sandhill Crane (E), Dusky Gopher Frog (E), Black Pinesnake (T), Louisiana Quillwort (E), Eastern Black Rail (T), Wood Stork (T), and Gopher Tortoise (T). There is no designated critical habitat within the project action area. At this time, the USACE, Mobile District has made no determination regarding potential effects of the project on the above-listed species. Further coordination with the U.S. Fish and Wildlife Service (USFWS) and NMFS will be performed as determined to be appropriate.

COMMENTS: This public notice is being distributed to all known interested persons in order to assist in developing facts on which a decision by the U.S. Army Corps of Engineers can be based. For accuracy and completeness of the record, all data in support of or in opposition to the proposed work should be submitted in writing setting forth sufficient detail to furnish a clear understanding of the reasons for support or opposition.

The decision whether to issue a permit will be based on an evaluation of the probable impact including cumulative impacts of the proposed activity on the public interest. That decision will reflect the national concern for both protection and utilization of important resources. The benefit which reasonably may be expected to accrue from the proposal must be balanced against its reasonably foreseeable detriments. All factors which may be relevant to the proposal will be considered including the cumulative effects thereof; among those are conservation, economics, aesthetics, general environmental concerns, wetlands, historic properties, fish and wildlife values, flood hazards, floodplain values, land use, navigation, shoreline erosion and accretion, recreation, water supply and conservation, water quality, energy needs, safety, food and fiber production, mineral needs, consideration of property ownership and, in general, the needs and welfare of the people.

The Corps of Engineers is soliciting comments from the public; Federal, State, and local agencies and officials; Indian Tribes; and other interested parties in order to consider and evaluate the impacts of this proposed activity. Any comments received will be considered by the Corps of Engineers to determine whether to issue, modify, condition or deny a permit for this proposal. To make this decision, comments are used to assess impacts on endangered species, historic properties, water quality, general environmental effects, and the other public interest factors listed above. Comments are used in the preparation of an Environmental Assessment and/or an Environmental Impact Statement pursuant to the National Environmental Policy Act. Comments are also used to determine the need for a public hearing and to determine the overall public interest of the proposed activity.

Any person may request, in writing, within the comment period specified in this notice, that a public hearing be held to consider this application. Requests for public hearings shall state with particularity, the reasons for holding a public hearing.

Evaluation of the probable impacts involving deposits of dredged or fill material into waters of the United States will include the application of guidelines established by the Administrator of the U.S. Environmental Protection Agency.

Correspondence concerning this Public Notice should refer to Public Notice Number **SAM-2023-00464-MJF** and should be directed to the District Engineer, Mobile District, Regulatory Division, Mobile, Post Office Box 2288, Mobile, Alabama 36628-0001, Attention: Maryellen Farmer or submitted electronically at maryellen.j.farmer@usace.army.mil, (251)509-6240. Copies of all comments should be furnished to the Mississippi Department of Environmental Quality, Office of Pollution Control, Post Office Box 2261, Jackson, Mississippi 39225, and the Mississippi Department of Marine Resources, 1141 Bayview Avenue, Biloxi, Mississippi 39530.

All comments should be received no later than 30 days from the date of this Public Notice.

For additional information about our Regulatory Program, please visit our web site at www.sam.usace.army.mil/Missions/Regulatory.aspx.

MOBILE DISTRICT
U.S. Army Corps of Engineers

Attachments

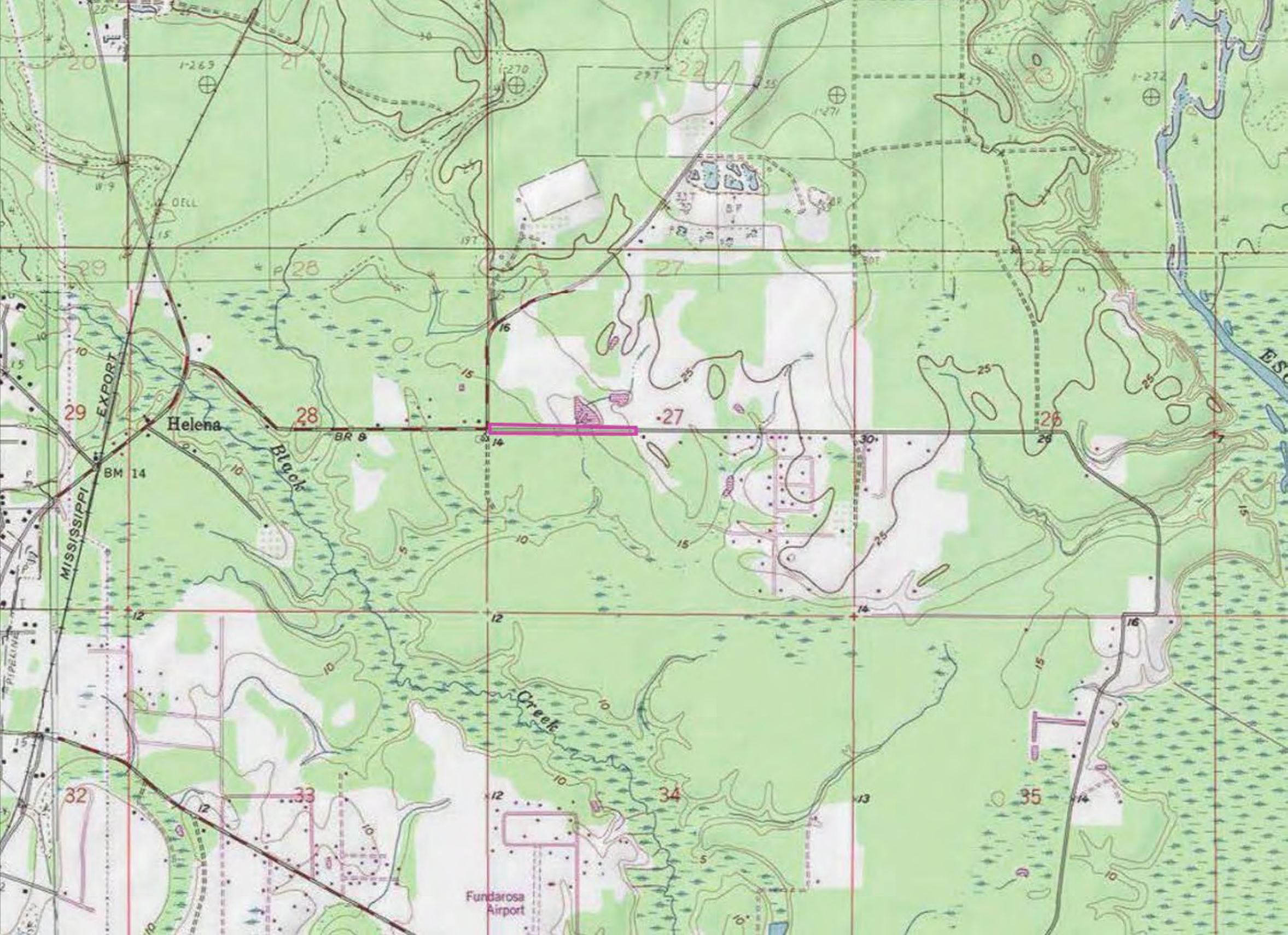

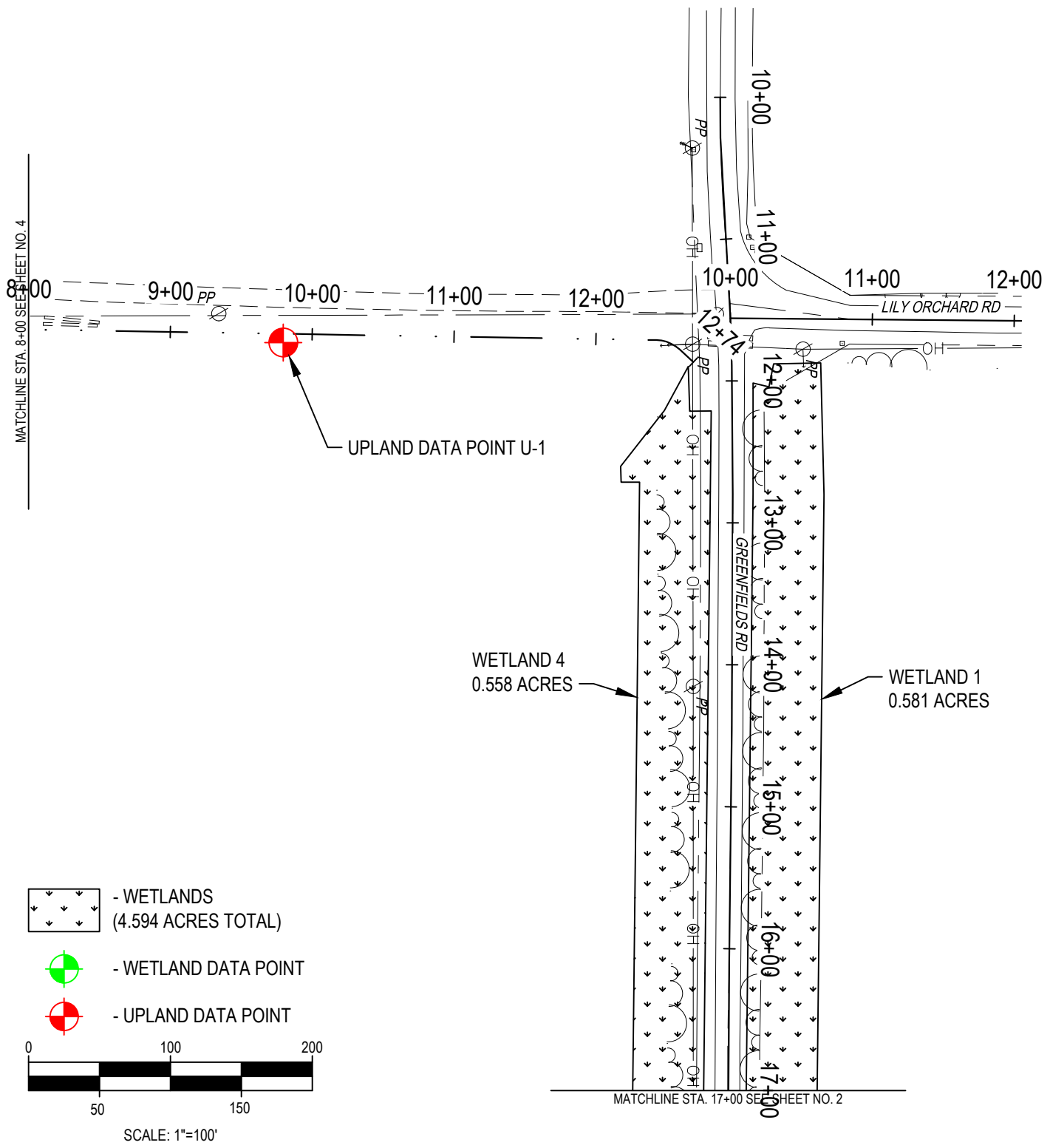

DRAWN BY: mt
 CHECKED BY: dr
 DATE: 5/3/23
 SCALE: 1"=100'
 PROJECT: 1235
 FILE: Wetland Exhibits.dwg

OVERSTREET & ASSOCIATES
CONSULTING ENGINEERS
 161 Lameuse St., Suite 203 Biloxi, MS 39530 228-967-7137
 630 Delmas Ave., Suite B Pascagoula, MS 39567 228-967-7137

JACKSON COUNTY BOARD OF SUPERVISORS
 GREENFIELDS ROAD
 DRAINAGE IMPROVEMENTS

WETLAND IMPACTS
 EXISTING CONDITIONS

SHEET
1



MATCHLINE STA. 17+00 SEE SHEET NO. 1

WETLAND 5
0.918 ACRES

WETLAND 2
0.919 ACRES

WETLAND DATA POINT W-1

GREENFIELDS RD

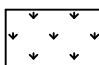
 - WETLANDS
(4.594 ACRES TOTAL)

 - WETLAND DATA POINT

 - UPLAND DATA POINT

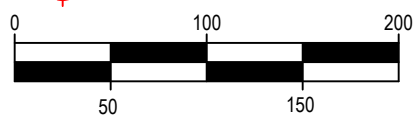

SCALE: 1"=100'

MATCHLINE STA. 25+00 SEE SHEET NO. 3

DRAWN BY: mt
CHECKED BY: dr
DATE: 5/3/23
SCALE: 1"=100'
PROJECT: 1235
FILE: Wetland Exhibits.dwg

OVERSTREET & ASSOCIATES
CONSULTING ENGINEERS

161 Lameuse St., Suite 203 Biloxi, MS 39530 228-967-7137
630 Delmas Ave., Suite B Pascagoula, MS 39567 228-967-7137

JACKSON COUNTY BOARD OF SUPERVISORS
GREENFIELDS ROAD
DRAINAGE IMPROVEMENTS

WETLAND IMPACTS
EXISTING CONDITIONS

SHEET
2



MATCHLINE STA. 25+00 SEE SHEET NO. 2

WETLAND 6
0.819 ACRES

WETLAND 3
0.799 ACRES

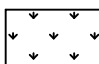
 - WETLANDS
(4.594 ACRES TOTAL)

 - WETLAND DATA POINT

 - UPLAND DATA POINT

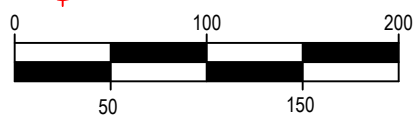

SCALE: 1"=100'

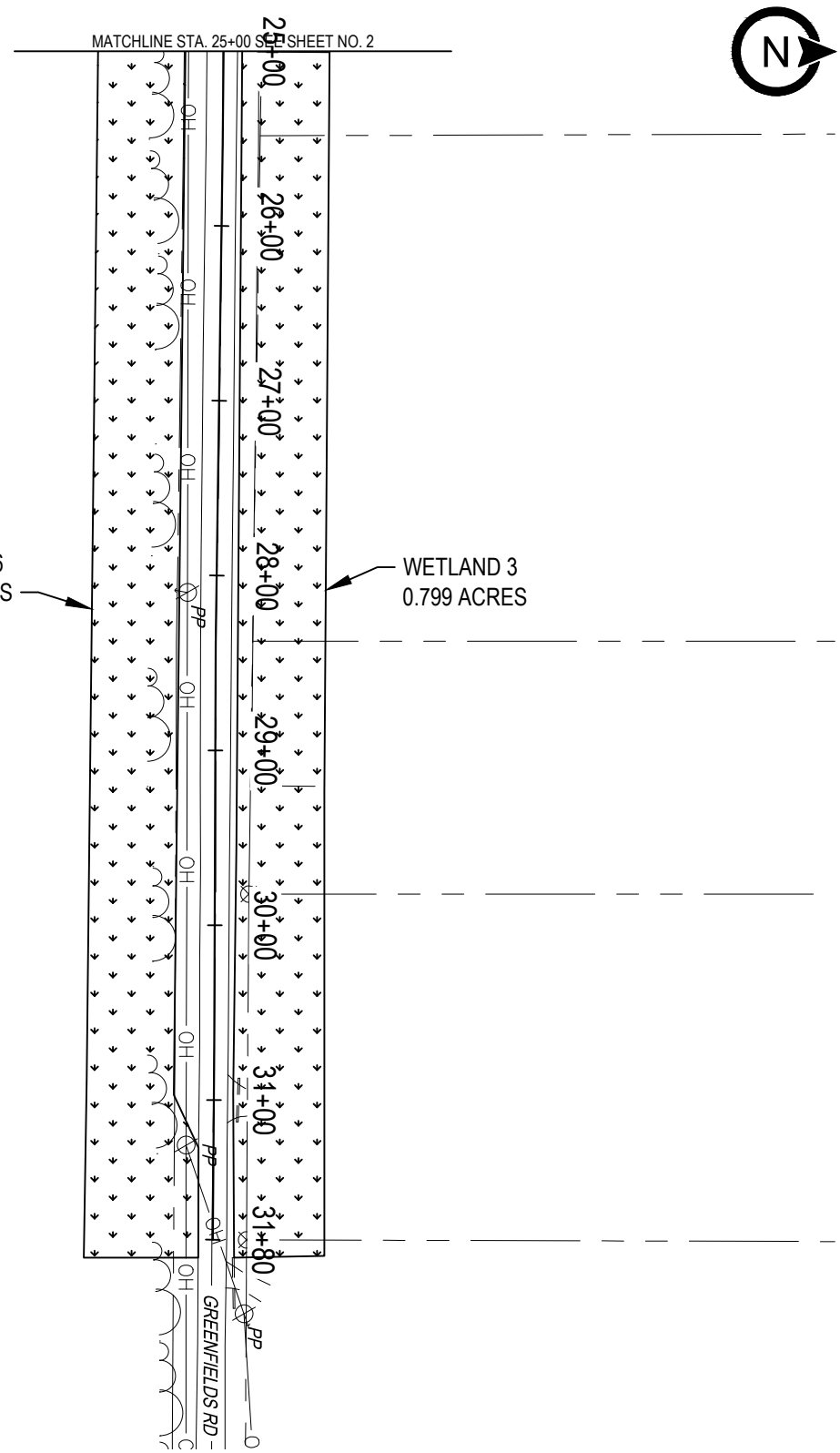

DRAWN BY: mt
CHECKED BY: dr
DATE: 5/3/23
SCALE: 1"=100'
PROJECT: 1235
FILE: Wetland Exhibits.dwg

OVERSTREET & ASSOCIATES
CONSULTING ENGINEERS

161 Lameuse St., Suite 203 Biloxi, MS 39530 228-967-7137
630 Delmas Ave., Suite B Pascagoula, MS 39567 228-967-7137

JACKSON COUNTY BOARD OF SUPERVISORS GREENFIELDS ROAD DRAINAGE IMPROVEMENTS	
WETLAND IMPACTS EXISTING CONDITIONS	SHEET 3



MATCHLINE TO A. 8+00 SEE SHEET NO. 1

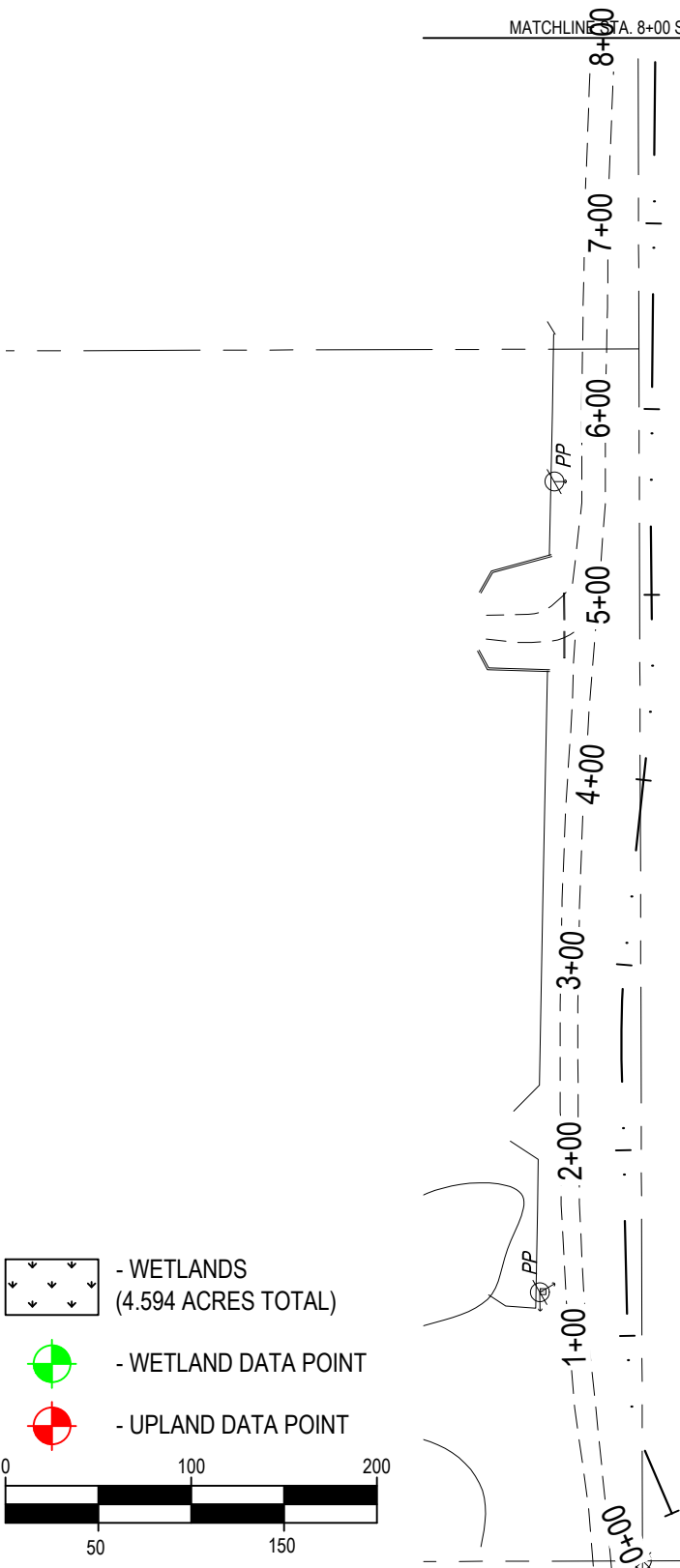

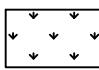
 - WETLANDS
 (4.594 ACRES TOTAL)

 - WETLAND DATA POINT

 - UPLAND DATA POINT

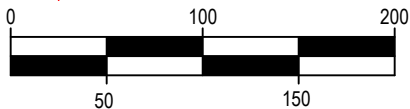

SCALE: 1"=100'

DRAWN BY: mt
 CHECKED BY: dr
 DATE: 5/3/23
 SCALE: 1"=100'
 PROJECT: 1235
 FILE: Wetland Exhibits.dwg

**OVERSTREET
& ASSOCIATES**
CONSULTING ENGINEERS

161 Lameuse St., Suite 203 Biloxi, MS 39530 228-967-7137
 630 Delmas Ave., Suite B Pascagoula, MS 39567 228-967-7137

JACKSON COUNTY BOARD OF SUPERVISORS
 GREENFIELDS ROAD
 DRAINAGE IMPROVEMENTS

WETLAND IMPACTS
 EXISTING CONDITIONS

SHEET

4

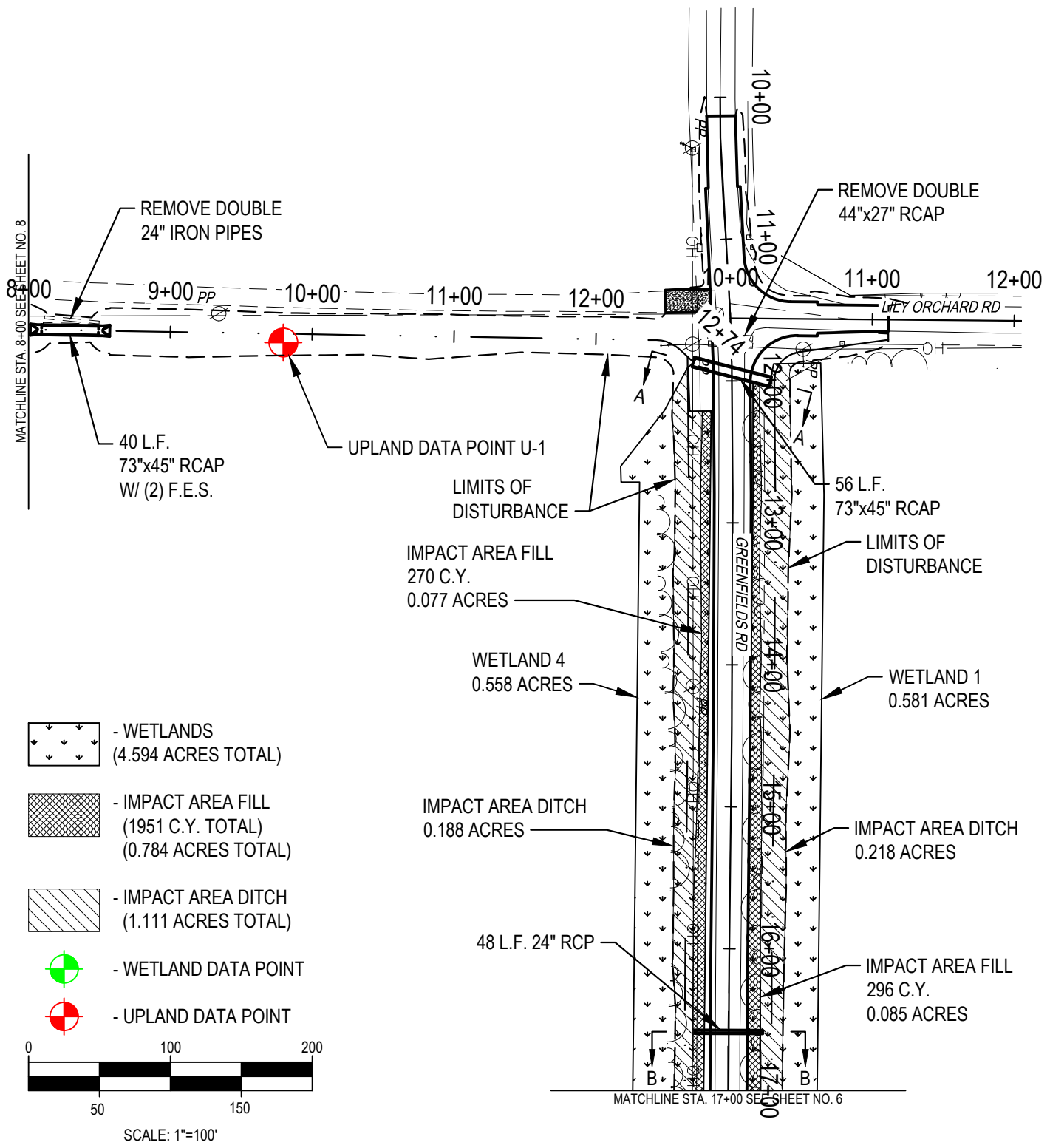

DRAWN BY: mt
 CHECKED BY: dr
 DATE: 5/3/23
 SCALE: 1"=100'
 PROJECT: 1235
 FILE: Wetland Exhibits.dwg

OVERSTREET & ASSOCIATES
CONSULTING ENGINEERS
 161 Lameuse St., Suite 203 Biloxi, MS 39530 228-967-7137
 630 Delmas Ave., Suite B Pascagoula, MS 39567 228-967-7137

JACKSON COUNTY BOARD OF SUPERVISORS
 GREENFIELDS ROAD
 DRAINAGE IMPROVEMENTS

WETLAND IMPACTS
 PROPOSED IMPROVEMENTS

SHEET
5

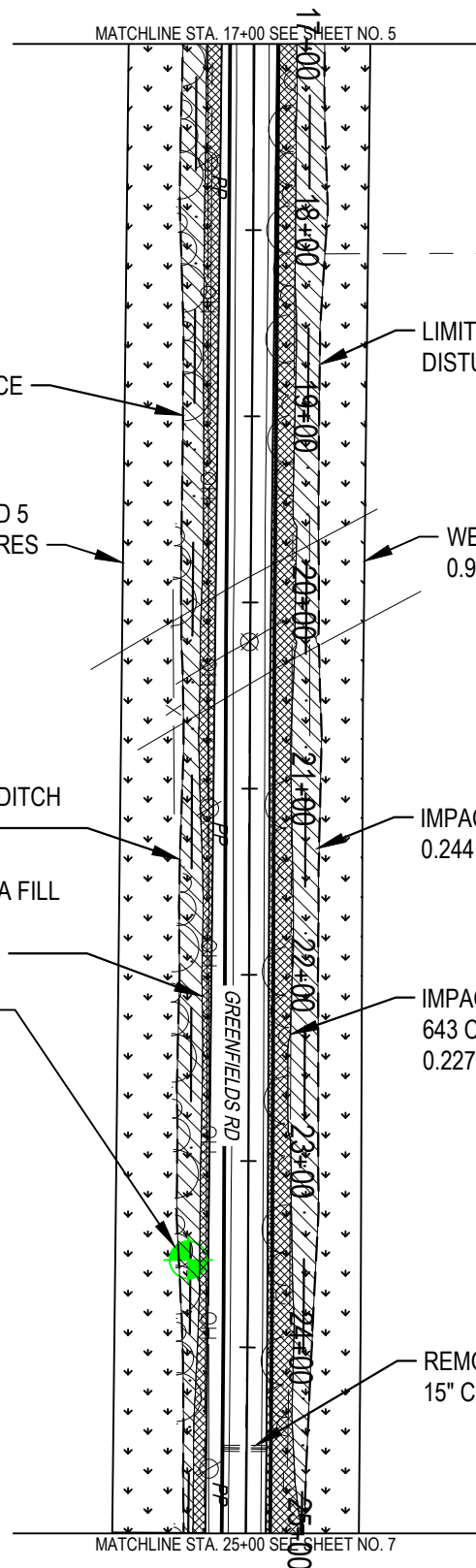

LIMITS OF DISTURBANCE

LIMITS OF DISTURBANCE

WETLAND 5
0.918 ACRES

WETLAND 2
0.919 ACRES

IMPACT AREA DITCH
0.200 ACRES

IMPACT AREA DITCH
0.244 ACRES

IMPACT AREA FILL
264 C.Y.
0.121 ACRES

IMPACT AREA FILL
643 C.Y.
0.227 ACRES

WETLAND DATA POINT W-1

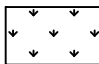
 - WETLANDS
(4.594 ACRES TOTAL)

 - IMPACT AREA FILL
(1951 C.Y. TOTAL)
(0.784 ACRES TOTAL)

 - IMPACT AREA DITCH
(1.111 ACRES TOTAL)

 - WETLAND DATA POINT

 - UPLAND DATA POINT

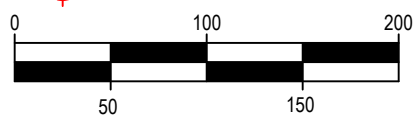

SCALE: 1"=100'

DRAWN BY: mt
CHECKED BY: dr
DATE: 5/3/23
SCALE: 1"=100'
PROJECT: 1235
FILE: Wetland Exhibits.dwg

OVERSTREET & ASSOCIATES
CONSULTING ENGINEERS

161 Lameuse St., Suite 203 Biloxi, MS 39530 228-967-7137
630 Delmas Ave., Suite B Pascagoula, MS 39567 228-967-7137

JACKSON COUNTY BOARD OF SUPERVISORS GREENFIELDS ROAD DRAINAGE IMPROVEMENTS	
WETLAND IMPACTS PROPOSED IMPROVEMENTS	SHEET 6



MATCHLINE STA. 25+00 SEE SHEET NO. 6

48 L.F. 24" RCP

LIMITS OF DISTURBANCE

LIMITS OF DISTURBANCE

IMPACT AREA FILL
72 C.Y.
0.066 ACRES

WETLAND 6
0.819 ACRES

WETLAND 3
0.799 ACRES

IMPACT AREA DITCH
0.131 ACRES

IMPACT AREA DITCH
0.130 ACRES

IMPACT AREA FILL
6 C.Y.
0.008 ACRES

IMPACT AREA FILL
397 C.Y.
0.196 ACRES

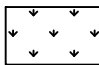
 - WETLANDS
(4.594 ACRES TOTAL)

 - IMPACT AREA FILL
(1951 C.Y. TOTAL)
(0.784 ACRES TOTAL)

 - IMPACT AREA DITCH
(1.111 ACRES TOTAL)

 - WETLAND DATA POINT

 - UPLAND DATA POINT

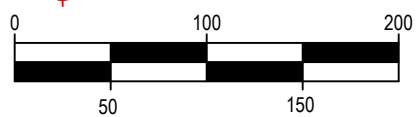

SCALE: 1"=100'

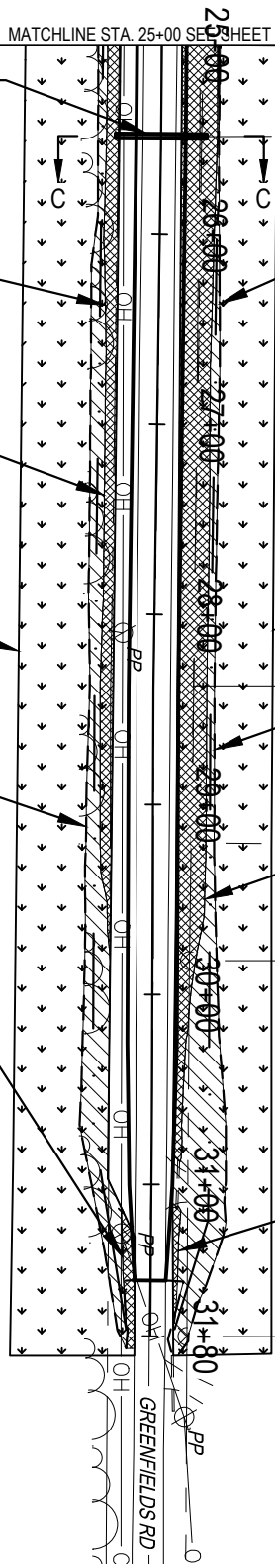

DRAWN BY: mt
CHECKED BY: dr
DATE: 5/3/23
SCALE: 1"=100'
PROJECT: 1235
FILE: Wetland Exhibits.dwg

OVERSTREET & ASSOCIATES
CONSULTING ENGINEERS

161 Lameuse St., Suite 203 Biloxi, MS 39530 228-967-7137
630 Delmas Ave., Suite B Pascagoula, MS 39567 228-967-7137

JACKSON COUNTY BOARD OF SUPERVISORS GREENFIELDS ROAD DRAINAGE IMPROVEMENTS	
WETLAND IMPACTS PROPOSED IMPROVEMENTS	SHEET 7



MATCHLINE TO A. 8+00 SEE SHEET NO. 5

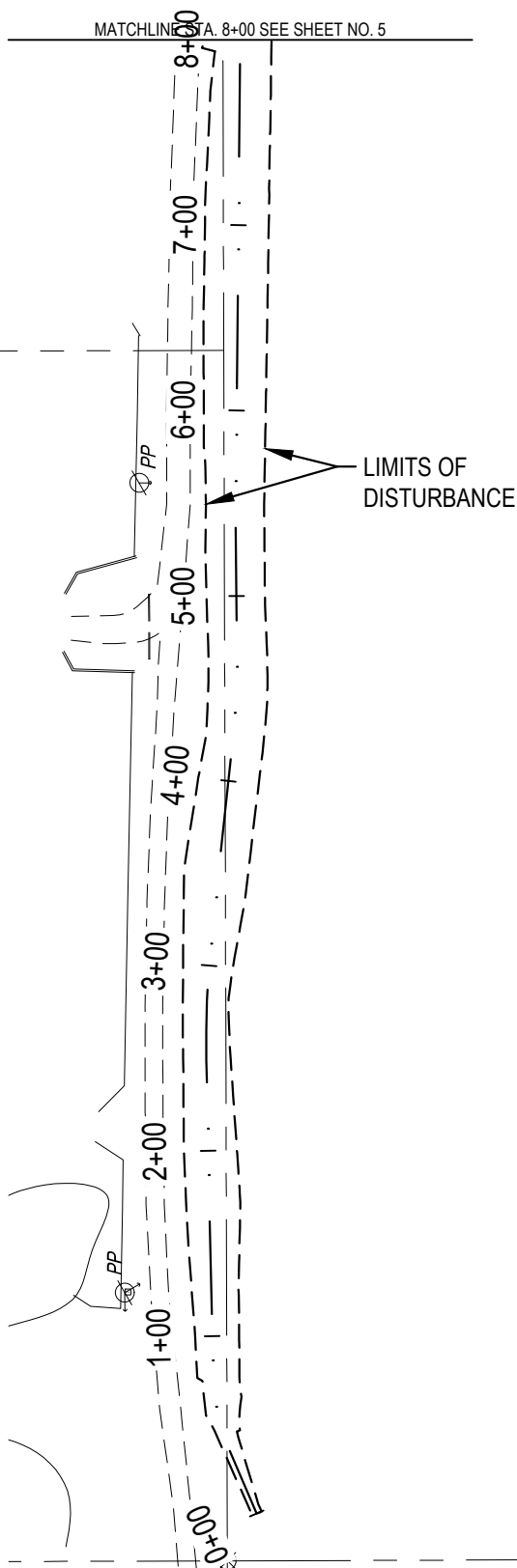

 - WETLANDS
(4.594 ACRES TOTAL)

 - IMPACT AREA FILL
(1951 C.Y. TOTAL)
(0.784 ACRES TOTAL)

 - IMPACT AREA DITCH
(1.111 ACRES TOTAL)

 - WETLAND DATA POINT

 - UPLAND DATA POINT

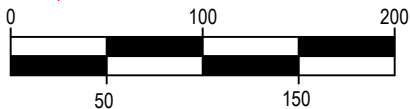

SCALE: 1"=100'

DRAWN BY: mt
CHECKED BY: dr
DATE: 5/3/23
SCALE: 1"=100'
PROJECT: 1235
FILE: Wetland Exhibits.dwg

OVERSTREET & ASSOCIATES
CONSULTING ENGINEERS

161 Lameuse St., Suite 203 Biloxi, MS 39530 228-967-7137
630 Delmas Ave., Suite B Pascagoula, MS 39567 228-967-7137

JACKSON COUNTY BOARD OF SUPERVISORS
GREENFIELDS ROAD
DRAINAGE IMPROVEMENTS

WETLAND IMPACTS
PROPOSED IMPROVEMENTS

SHEET

8

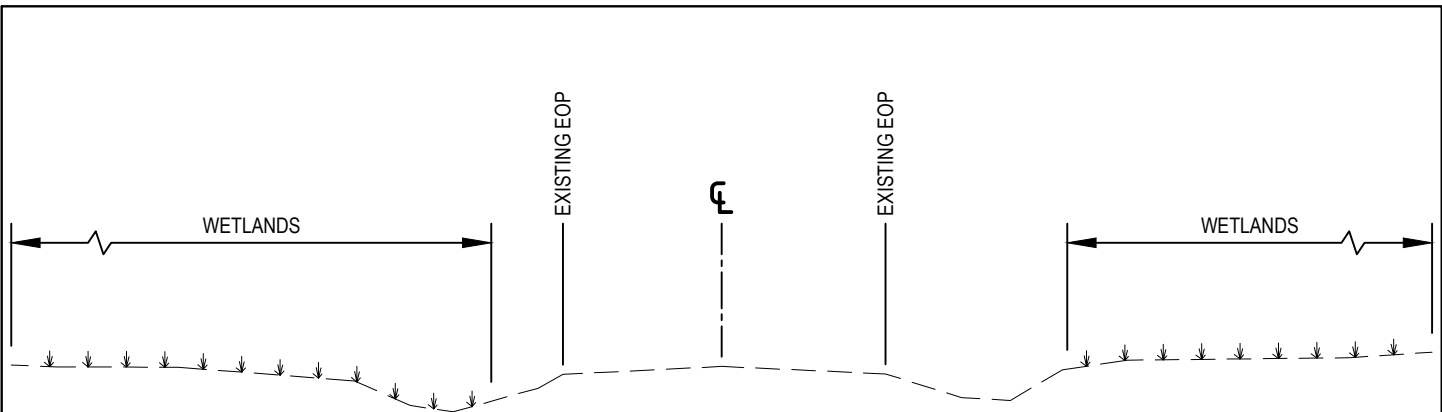

TYPICAL SECTION
EXISTING CONDITIONS
 NOT TO SCALE

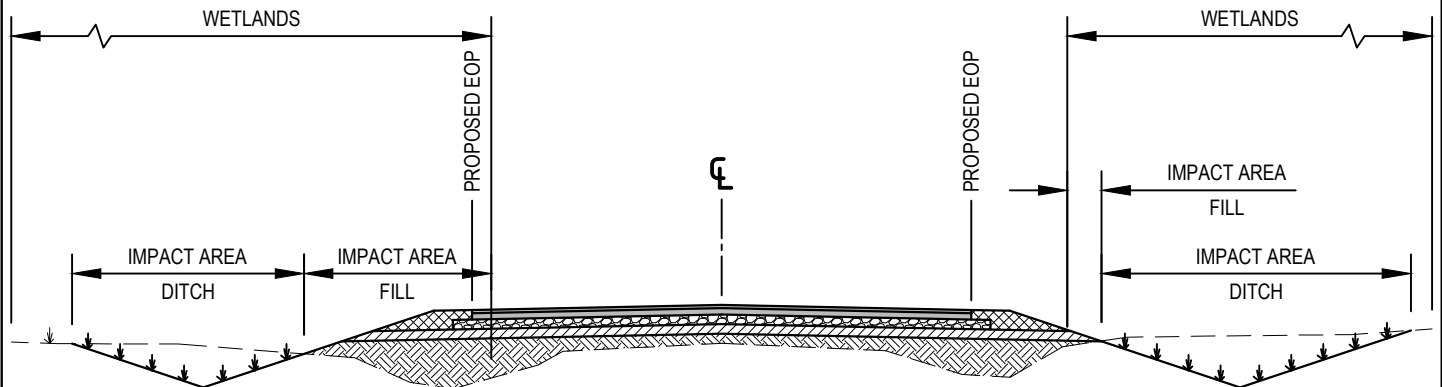

TYPICAL SECTION
PROPOSED IMPROVEMENTS
 NOT TO SCALE

DRAWN BY: mt
 CHECKED BY: dr
 DATE: 5/3/23
 SCALE: 1"=100'
 PROJECT: 1235
 FILE: Wetland Exhibits.dwg

OVERSTREET & ASSOCIATES
CONSULTING ENGINEERS
 161 Lameuse St., Suite 203 Biloxi, MS 39530 228-967-7137
 630 Delmas Ave., Suite B Pascagoula, MS 39567 228-967-7137

JACKSON COUNTY BOARD OF SUPERVISORS
 GREENFIELDS ROAD
 DRAINAGE IMPROVEMENTS

WETLAND IMPACTS
 TYPICAL SECTIONS

SHEET
9

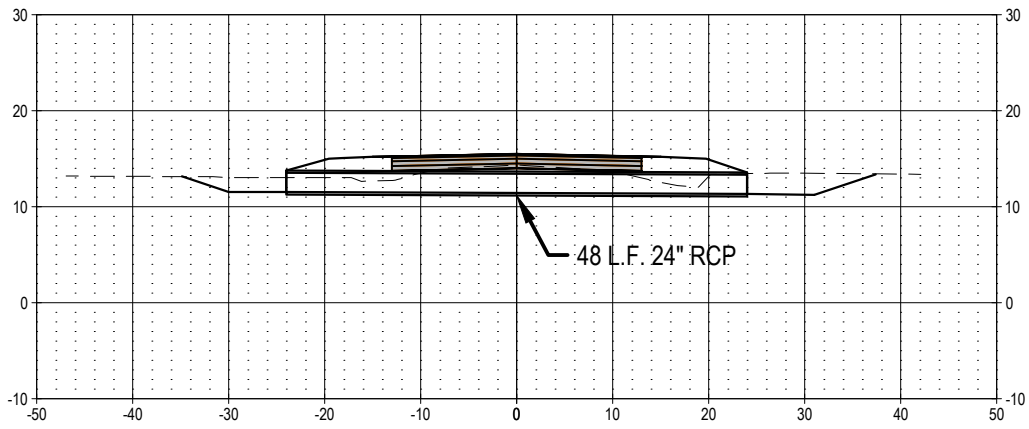

STA. 25+48.20
SECTION C-C

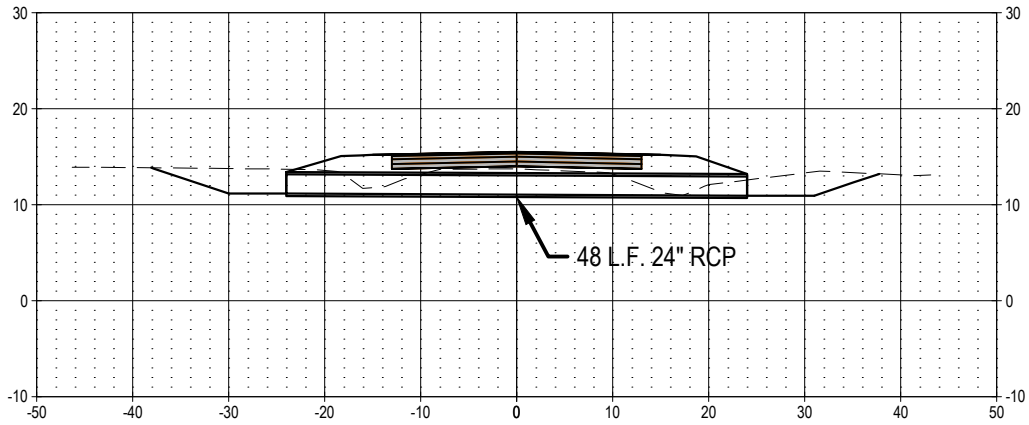

STA. 16+58.54
SECTION B-B

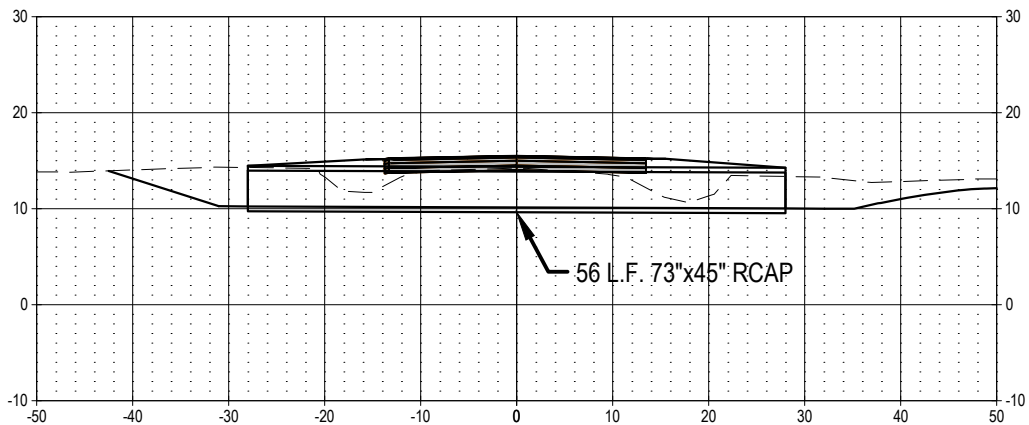

STA. 11+93.68
SECTION A-A

DRAWN BY: mt
 CHECKED BY: dr
 DATE: 7/12/23
 SCALE: 1"=100'
 PROJECT: 1235
 FILE: Wetland Exhibits.dwg

OVERSTREET & ASSOCIATES
CONSULTING ENGINEERS
 161 Lameuse St., Suite 203 Biloxi, MS 39530 228-967-7137
 630 Delmas Ave., Suite B Pascagoula, MS 39567 228-967-7137

JACKSON COUNTY BOARD OF SUPERVISORS
 GREENFIELDS ROAD
 DRAINAGE IMPROVEMENTS

WETLAND IMPACTS
 DRAINAGE CROSS SECTIONS

SHEET
10