



**DEPARTMENT OF THE ARMY**  
U.S. ARMY CORPS OF ENGINEERS, MOBILE DISTRICT  
P.O. BOX 2288  
MOBILE, AL 36628-0001

**CESAM-RD-M**  
**PUBLIC NOTICE NO. SAM-2022-00147-RCV**

**April 27, 2022**

**JOINT PUBLIC NOTICE**  
**U.S. ARMY CORPS OF ENGINEERS**

**MISSISSIPPI DEPARTMENT OF ENVIRONMENTAL QUALITY**  
**OFFICE OF POLLUTION CONTROL (MDEQ)**

**MISSISSIPPI DEPARTMENT OF MARINE RESOURCES**

**PROPOSED BEACH RE-NOURISHMENT PROJECT,**  
**PASS CRISTIAN TO BILOXI,**  
**HARRISON COUNTY, MISSISSIPPI**

TO WHOM IT MAY CONCERN:

This District has received an application for a Department of the Army (DA) permit pursuant to Section 10 of the Rivers and Harbors Act of 1899 (33 USC 403), Section 404 of the Clean Water Act (33 USC 1344), Please communicate this information to interested parties.

**APPLICANT:** Harrison County Sand Beach Authority  
Attention: Mr. Chuck Loftis Director  
842 Commerce Street  
Gulfport, Mississippi 39507

**WATERWAY AND LOCATION:** Mississippi Sound, Beginning at Henderson Point, Pass Christian and proceeding east to I-110 Loop in Biloxi, Mississippi. At the following locations:

**Table 1: Location of Renourishment Segment**

SEGMENT #	LANDMARKS	LATITUDE START	LONGITUDE START	LATITUDE STOP	LONGITUDE STOP
Segment #1	HENDERSON POINT TO PASSCHRISTIAN HARBOR	30.30349	-89.29149	30.31161	-89.24972
Segment #2	PASS CHRISTIAN HARBOR TO LONG BEACH HARBOR	30.31161	-89.24972	30.34493	-89.14509
Segment #3	LONG BEACH HARBOR TO GPT. COMMERCIAL HARBOR	30.34523	-89.14190	30.36093	-89.10068
Segment #4	GPT.SMALL CRAFT HARBOR TO KEN COMBS PIER	30.36288	-89.08550	30.37701	-89.04438
Segment #5	KEN COMBS PIERTO BROADWATER MARINA	30.37682	-89.04376	30.39097	-88.96427



Segment #6	BROADWATER MARINATO TREASURE BAY	30.39096	-88.96155	30.39163	-88.95561
Segment #7	TREASURE BAY TO I-110 LOOP	30.39086	-88.95346	30.39321	-88.89397
<b>PROJECT START AND STOP COORDINATES LANDMARKS</b>		<b>LATITUDE START</b>	<b>LONGITUDE START</b>	<b>LONGITUDE STOP</b>	<b>LONGITUDE STOP</b>
Coordinates for Project start Point and Project End Point		30.30349	-89.29149	30.39321	-88.89397

**PROPOSED WORK:** The HCSBA proposes to conduct beach renourishment activities to renourish the sand beach to its prescribed design template. The beach renourishment will utilize a hydraulic dredge to obtain sand material from designated off-shore borrow areas pumped in place at selected areas of the beach where replenishment is needed over the 10-year life of the permit

**Background:** Historically, the HCSBA renourishes large areas of the sand beach using sand which is hydraulically dredged from designated borrow areas offshore of the beach and placed in the eroded areas to restore the original beach profile. Beach renourishment by hydraulic dredging is generally performed approximately every 10 years and approximately 1,000,000 cubic yards of sand is placed on the sand beach from Biloxi to Henderson Point.

#### **Proposed Action**

HCSBA proposes to renourish seven sections of beach from Henderson Point to Biloxi. Sand will be obtained from designated borrow areas by hydraulic dredge and placed on the beach segments to restore the beach profile. The sand will be deposited in eroded areas and then graded to restore the beach to its originally permitted design width.

Surveys of the seven segments of beach indicate that the quantity of material needed to replenish the beach segments varies from 15,705 cubic yards (Segment #6 Broadwater Marina to Treasure Bay Casino) to a high of 384,398 cubic yards (Segment #2 Pass Christian to Long Beach). The total volume and total area to be renourished over the life of the project is presented in Table 2. An estimated 1,487,695 cubic yards of sand would be dredged from pre-designated borrow areas and deposited within the beach template as to re-establish approximately 138.21 acres of beach over the 10-year life of the project (See Table 2).

The initial project will require the placement of approximately 981,875 cubic yards of sand on the eroded areas of the beach. Current estimates indicate that the remaining 505,815 cubic yards of material will be utilized to renourish eroded beach segments as needed and based on erosion occurring at the eight segments. Prior to the that renourishment activity, the beach segments will be assessed and quantified, and presented to the regulatory agencies under the terms of the Ten-Year Permit.

**Table 2 – Renourishment Volume and Area by Location.**



SEGMENT #	STATION LOCATION	LANDMARKS	CUBIC YARDS	AREA ACRES
Segment #1	STA.0+00- STA.136+00	HENDERSON POINT TO PASS CHRISTIAN HARBOR	245,913	25.47
Segment #2	STA.147+50 – STA.487+50	PASS CHRISTIAN HBR TO LONG BEACH HBR	384,398	30.74
Segment #3	STA.502+00 - STA.539+52	LONG BEACH HARBOR TO GPT. COMMERCIAL HARBOR	137,178	11.92
Segment #4	STA. GN+00 - STA.812+50	GPT.SMALL CRAFT HARBOR TO KEN COMBS PIER	135,907	11.79
Segment #5	STA.812+00 - STA.1067+60	KEN COMBS PIER TO BROADWATER MARINA	296,190	33.40
Segment #6	STA.1076+16- STA.1094+55	BROADWATER MARINA TO TREASURE BAY	15,705	1.05
Segment #7	STA.1101+24- STA.1290+86	TREASURE BAY TO I-110 LOOP	272,404	23.84
<b>TOTAL</b>			<b>1,487,695</b>	<b>138.21</b>

The applicant has applied for coastal zone (CZ) consistency in accordance with the State Coastal Zone Management Program. A determination relative to CZ consistency will be made by the Mississippi Department of Marine Resources

The applicant has applied for certification from the State of Mississippi in accordance with Section 401(a)(1) of the Clean Water Act and upon completion of the required advertising; a determination relative to certification will be made

This public notice is being distributed to all known interested persons in order to assist in developing facts on which a decision by the U.S. Army Corps of Engineers (USACE) can be based. For accuracy and completeness of the record, all data in support of or in opposition to the proposed work should be submitted in writing setting forth sufficient detail to furnish a clear understanding of the reasons for support or opposition.

The decision whether to issue a permit will be based on an evaluation of the probable impact including cumulative impacts of the proposed activity on the public interest. That decision will reflect the national concern for both protection and utilization of important resources. The benefit which reasonably may be expected to accrue from the proposal must be balanced against its reasonably foreseeable detriments. All factors which may be relevant to the proposal will be considered including the cumulative effects thereof; among those are conservation, economics, aesthetics, general environmental concerns, wetlands, historic properties, fish and wildlife values, flood hazards, floodplain values, land use,

navigation, shoreline erosion and accretion, recreation, water supply and conservation, water quality, energy needs, safety, food and fiber production, mineral needs, consideration of property ownership and, in general, the needs and welfare of the people.

The USACE is soliciting comments from the public; Federal, State, and local agencies and officials; Indian Tribes; and other interested parties in order to consider and evaluate the impacts of this proposed activity. Any comments received will be considered by the USACE to determine whether to issue, modify, condition or deny a permit for this proposal. To make this decision, comments are used to assess impacts on endangered species, historic properties, water quality, general environmental effects, and the other public interest factors listed above. Comments are used in the preparation of an Environmental Assessment and/or an Environmental Impact Statement pursuant to the National Environmental Policy Act. Comments are also used to determine the need for a public hearing and to determine the overall public interest of the proposed activity.

Any person may request, in writing, within the comment period specified in this notice, that a public hearing be held to consider this application. Requests for public hearings shall state with particularity, the reasons for holding a public hearing.

Evaluation of the probable impacts involving deposits of dredged or fill material into waters of the United States will include the application of guidelines established by the Administrator of the U.S. Environmental Protection Agency.

In accordance with Section 106 of the National Historic Preservation Act, and Appendix C of 33 CFR 325, the undertaking defined in this notice is being considered for the potential to affect historic properties. In accordance with Appendix C of 33 CFR 325, the Corps has determined the permit area consists of the previously utilized borrow areas and the segments of beach renourishment. The National Register of Historic Places has been consulted and no properties listed in or eligible for the National Register are known to exist which would be affected by the proposed work. The USACE has made a preliminary determination that the proposed project would have no effect on historic properties]. However, we are seeking comment from the State Historic Preservation Officer, federally-recognized American Indian tribes, local historical societies, museums, universities, the National Park Service, and the general public regarding the existence or the potential for existence of significant cultural and historic properties which may be affected by the work. This action constitutes the full extent of cultural resources investigations unless comment to this notice is received documenting that significant sites or properties exist which may be affected by this work, or that adequately documents that a potential exists for the location of significant sites or properties within the project area.

A preliminary review of this application, the U.S. Department of the Interior List of Endangered and Threatened Wildlife and Plants and the National Marine Fisheries Service list of Mississippi's Threatened and Endangered Species indicate the proposed activity will have no effect on listed species such as the Wood Stork(*Mycteria americana*), Dusky Gopher Frog (*Rana sevosia*), but may effect the endangered West Indian manatee (*Trichechus manatus*), the threatened Eastern Black Rail (*Laterallus jamaicensis*

jamaicensis) the threatened red knot (*Calidris canutus rufa*), the threatened piping plover (*Charadrius melodus*) and its designated critical habitat, the Loggerhead Sea Turtle (*Caretta caretta*) and the Gulf Sturgeon (*Acipenser oxyrinchus desotoi*) This notice serves as request to the U.S. Fish and Wildlife Service and National Marine Fisheries Service for information on whether any listed or proposed to be listed endangered or threatened species may be present in the area which would be affected by the proposed activity.

This notice initiates the Essential Fish Habitat (EFH) consultation requirements of the Magnuson-Stevens Fishery Conservation and Management Act. The proposal would impact approximately 1,487,695 cubic yards of sand to be dredged from pre-designated borrow areas and deposited within the beach template as to re-establish approximately 138.21 acres of beach. The proposal would impact unvegetated sandy bottom substrates; no marsh or aquatic vegetation will be affected which Our initial determination is that the proposed action would not adversely impact EFH or associated fisheries managed by the Gulf of Mexico Fishery Management Council or the National Marine Fisheries Service. Our final determination relative to project impacts and the need for mitigation measures is subject to review by and coordination with the National Marine Fisheries Service.

Correspondence concerning this Public Notice should refer to Public Notice Number SAM-2022-00147-RCV and should be directed to the District Engineer, U.S. Army Engineer District, Mobile, Post Office Box 2288, Mobile, Alabama 36628-0001, Attention: South Mississippi Branch, with a copy to the Mississippi Department of Environmental Quality, Office of Pollution Control, Post Office Box 2261, Jackson, Mississippi 39225, and the Mississippi Department of Marine Resources, 1141 Bayview Avenue, Biloxi, Mississippi 39530, in time to be received within **30 days** of the date of this public notice.

If you have any questions concerning this publication, you may contact the project manager for this application, **Mr. Rudolph C. Villarreal** (**Rudolph.c.villarreal@usace.army.mil**), phone **(251) 690-3246**. Please refer to the above Public Notice number.

For additional information about our Regulatory Program, please visit our website at: [www.sam.usace.army.mil](http://www.sam.usace.army.mil) and please take a moment to complete our customer satisfaction survey while you're there. Your responses are appreciated and will allow us to improve our services.

MOBILE DISTRICT  
U.S. Army Corps of Engineers

Enclosures



S:\1676\1676-21 PERMIT\CAD\DWG\1676-21 PERMIT.dwg, 1/6/2022 8:26:00 AM, DWG To PDF.pc3

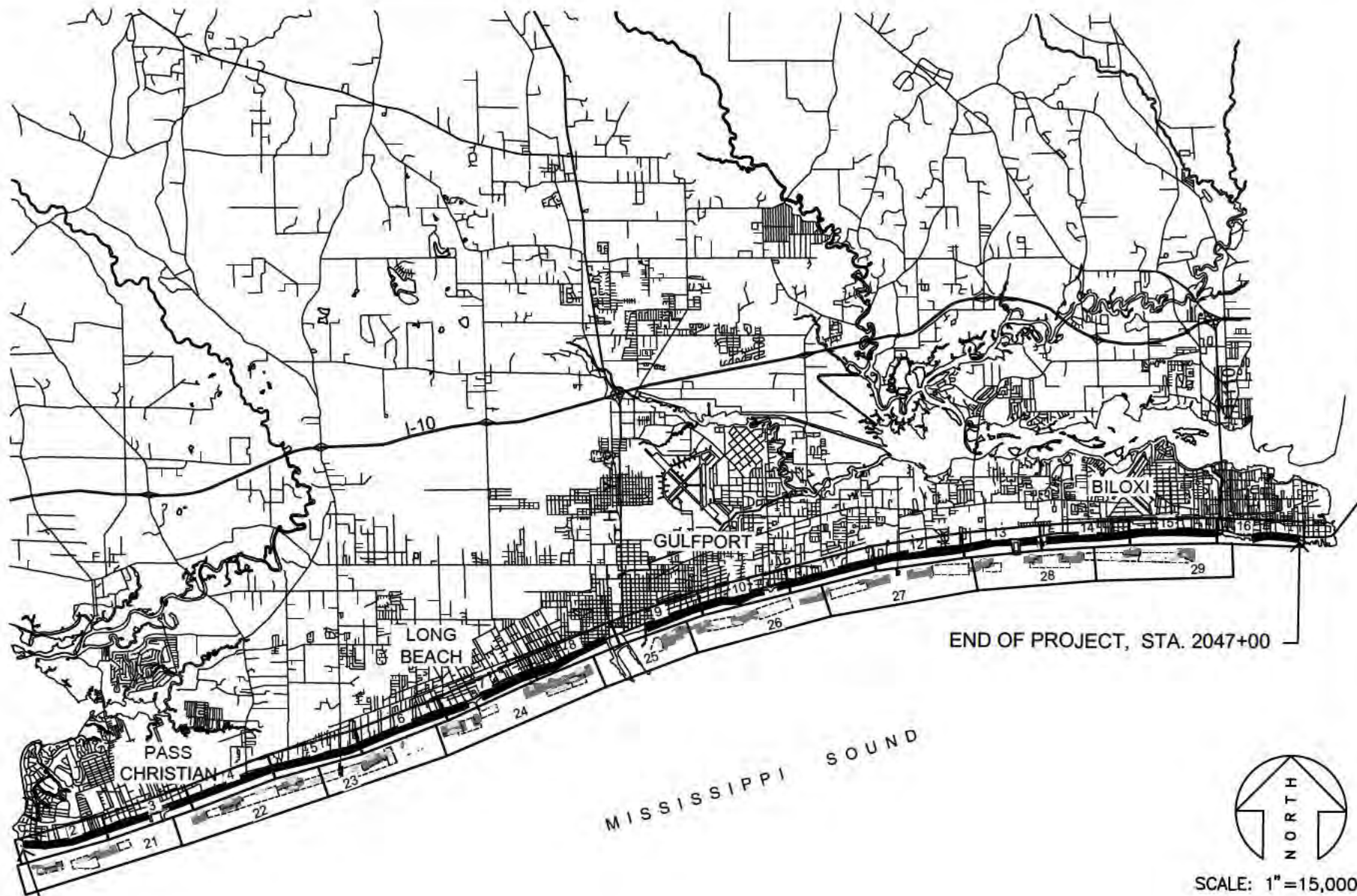

BEGINNING OF PROJECT, STA. 0+00



BROWN, MITCHELL  
& ALEXANDER, INC.  
CONSULTING ENGINEERS

11/30/21  
\\1676\1676-21\1676-21 PERMIT

VICINITY MAP  
**SAND BEACH RENOURISHMENT**  
HARRISON COUNTY SAND BEACH DEPARTMENT  
HARRISON COUNTY, MISSISSIPPI  
SHEET 1 OF 31

S:\1676\1676-21 PERMIT\CAD\DWG\1676-21 PERMIT.dwg, 12/22/2021 3:13:40 PM, DWG To PDF.pc3

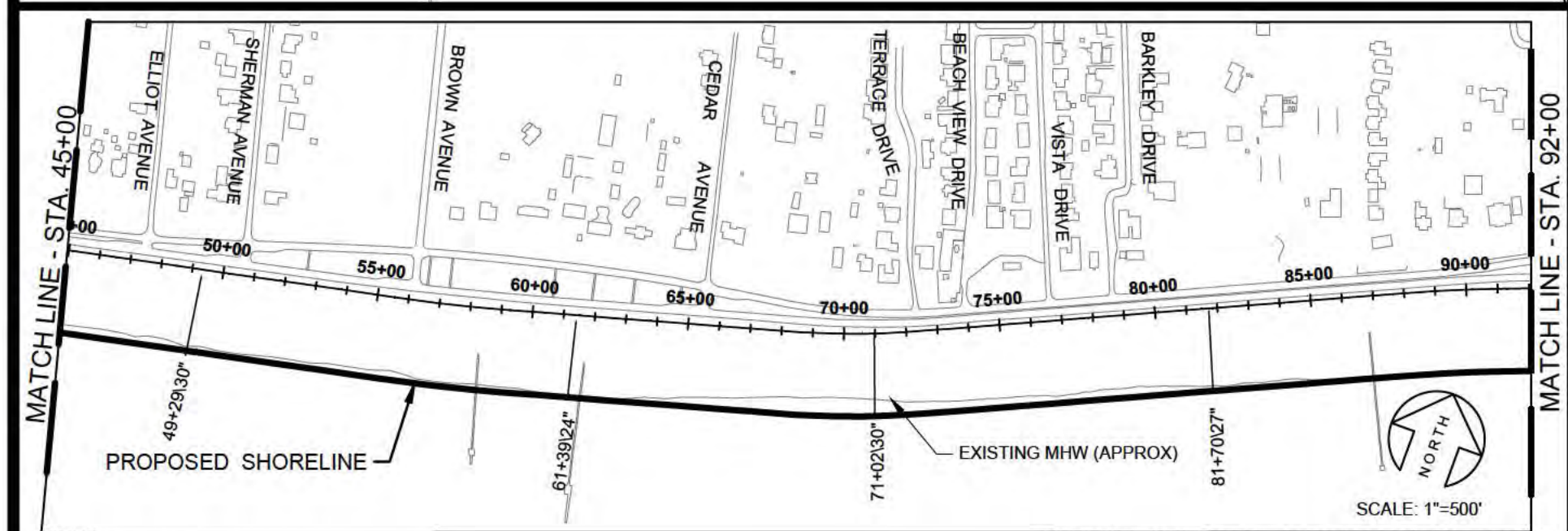
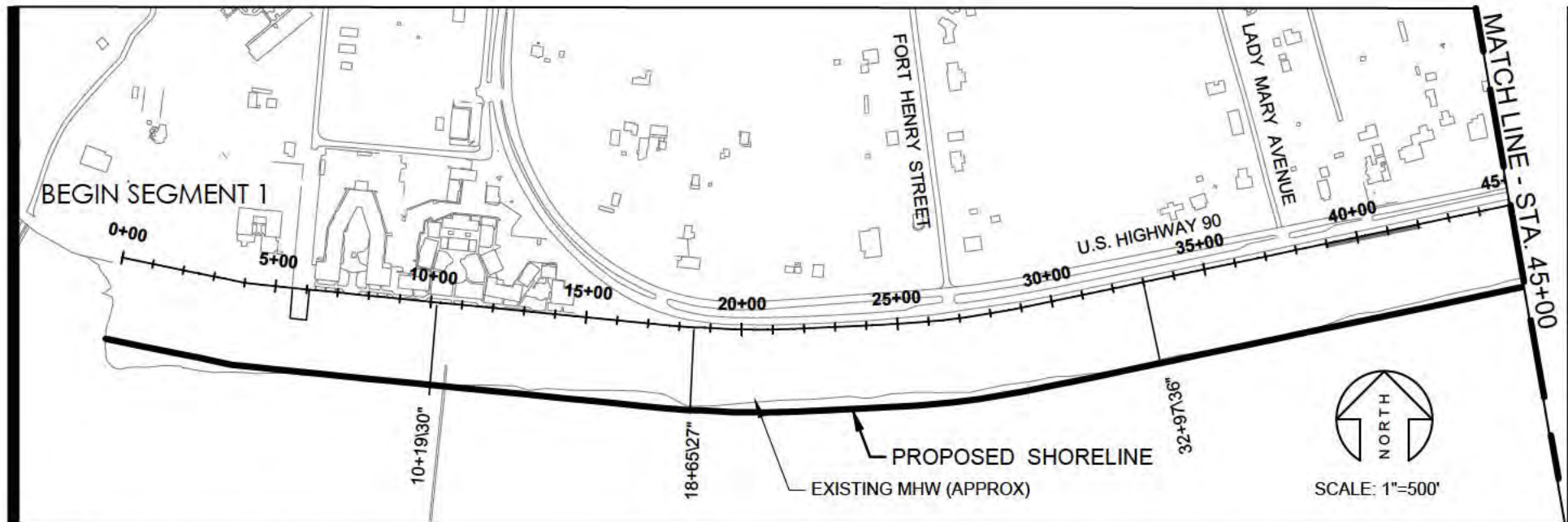

12/17/21  
\\1676\1676-21\1676-21 PERMIT

**bma** BROWN, MITCHELL  
& ALEXANDER, INC.  
CONSULTING ENGINEERS

**SAND BEACH RENOURISHMENT**  
HARRISON COUNTY SAND BEACH DEPARTMENT  
HARRISON COUNTY MISSISSIPPI  
SHEET 2 OF 31



S:\1676\1676-21 PERMIT\CAD\DWG\1676-21 PERMIT.dwg, 12/22/2021 3:13:50 PM, DWG To PDF.pc3

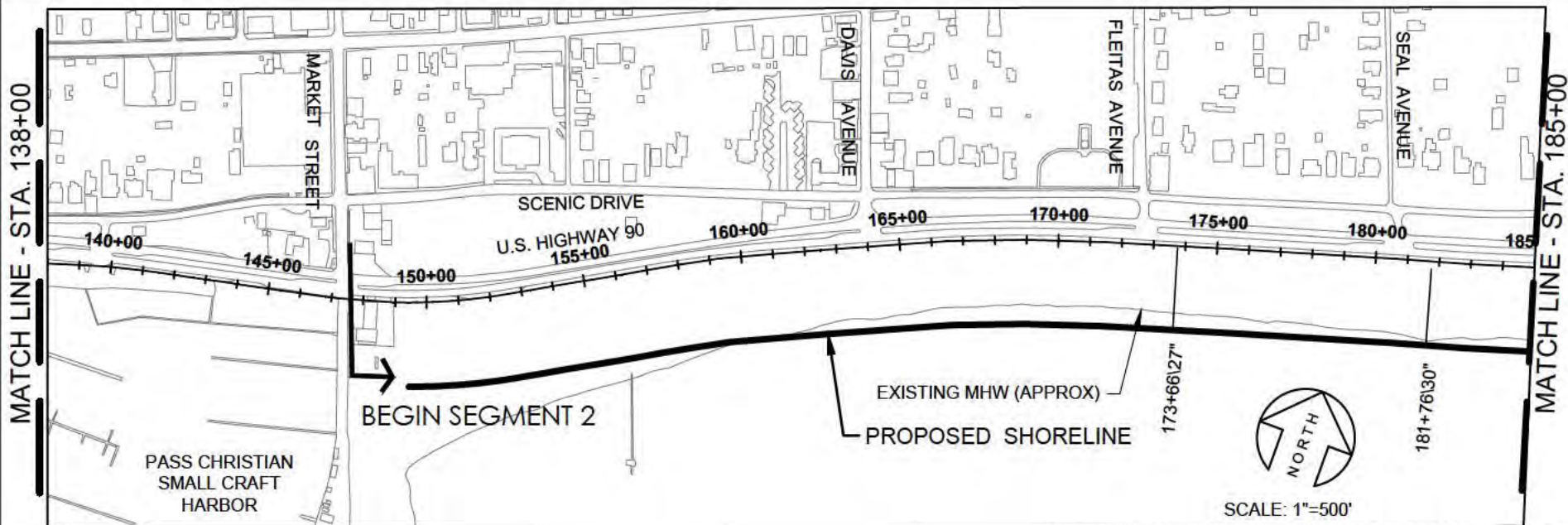
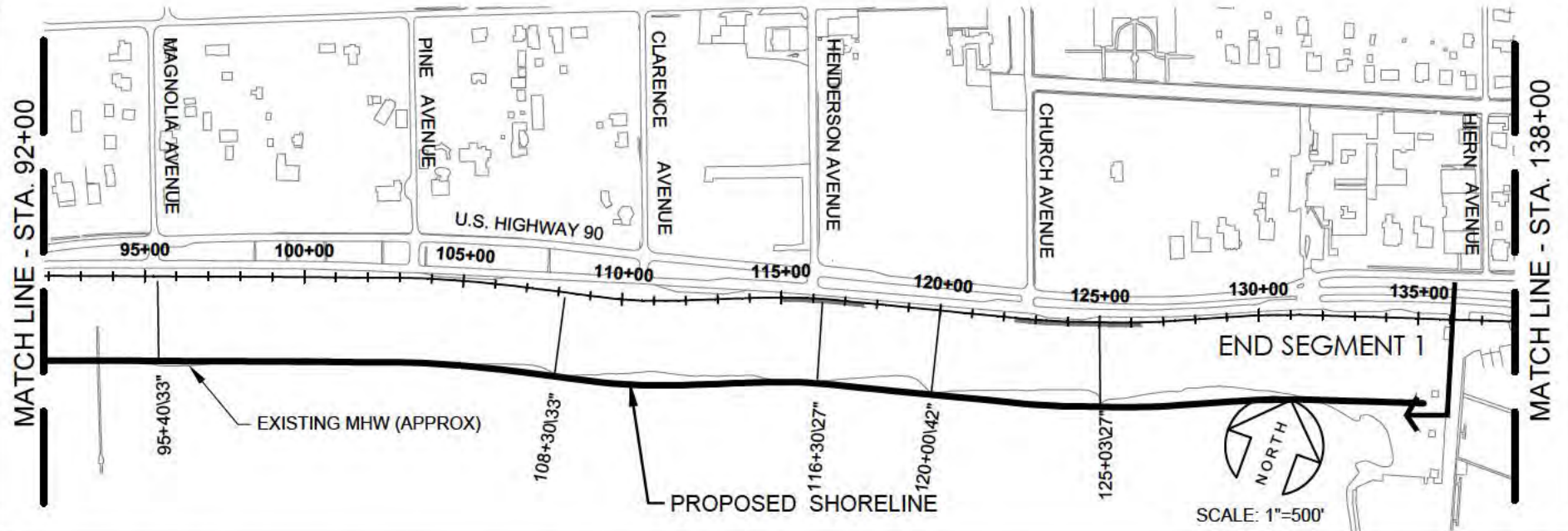

12/17/21  
\\1676\1676-21\1676-21 PERMIT



BROWN, MITCHELL  
& ALEXANDER, INC.  
CONSULTING ENGINEERS

SAND BEACH RENOURISHMENT  
HARRISON COUNTY SAND BEACH DEPARTMENT  
HARRISON COUNTY MISSISSIPPI  
SHEET 3 OF 31



S:\1676\1676-21 PERMIT\CAD\DWG\1676-21 PERMIT.dwg, 12/22/2021 3:14:00 PM, DWG To PDF.pc3

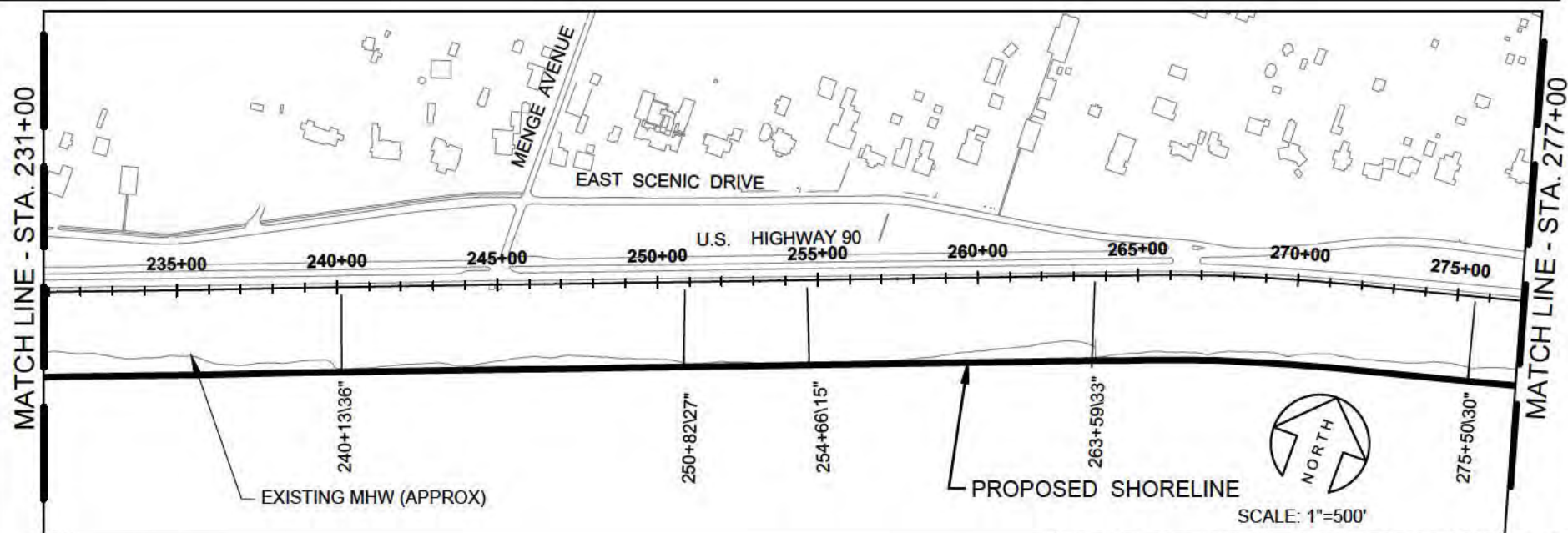
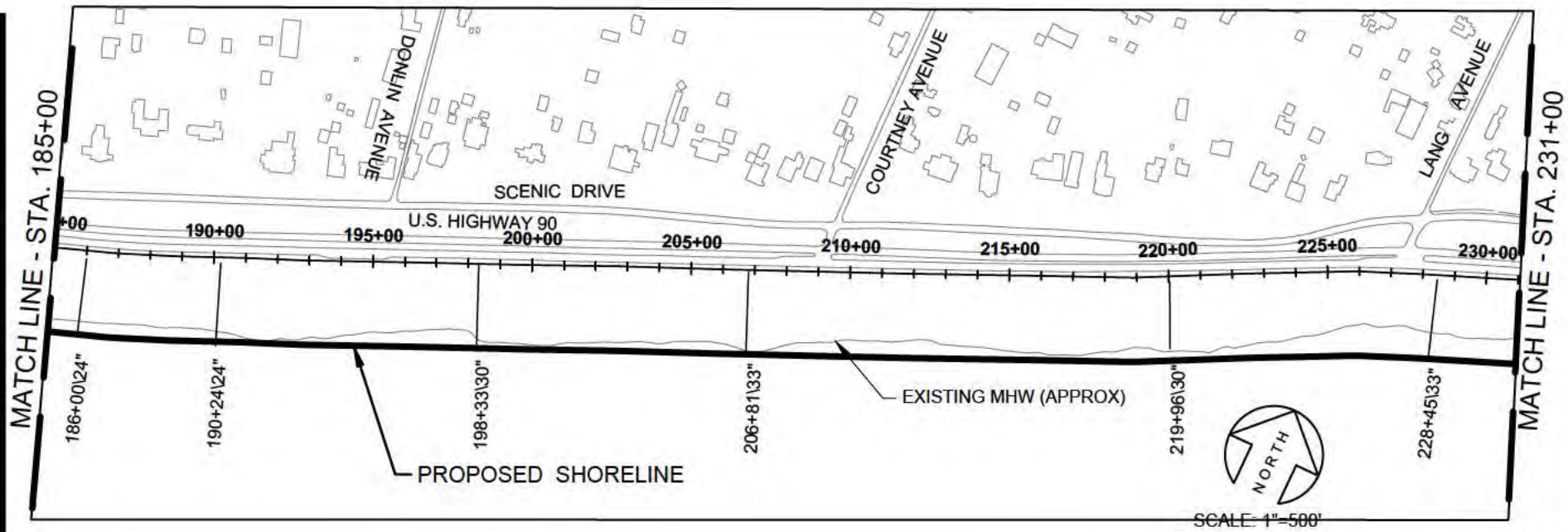

12/1/21  
\\1676\1676-21\1676-21 PERMIT



BROWN, MITCHELL  
& ALEXANDER, INC.  
CONSULTING ENGINEERS

SAND BEACH RENOURISHMENT  
HARRISON COUNTY SAND BEACH DEPARTMENT  
HARRISON COUNTY MISSISSIPPI  
SHEET 4 OF 31

**12/1/21**  
**1676\1676-21\1676-21 PERMIT**  
**BROWN, MITCHELL**  
**& ALEXANDER, INC.**  
**CONSULTING ENGINEERS**

**SAND BEACH RENOURISHMENT**  
**HARRISON COUNTY SAND BEACH DEPARTMENT**  
**HARRISON COUNTY MISSISSIPPI**  
**SHEET 5 OF 31**

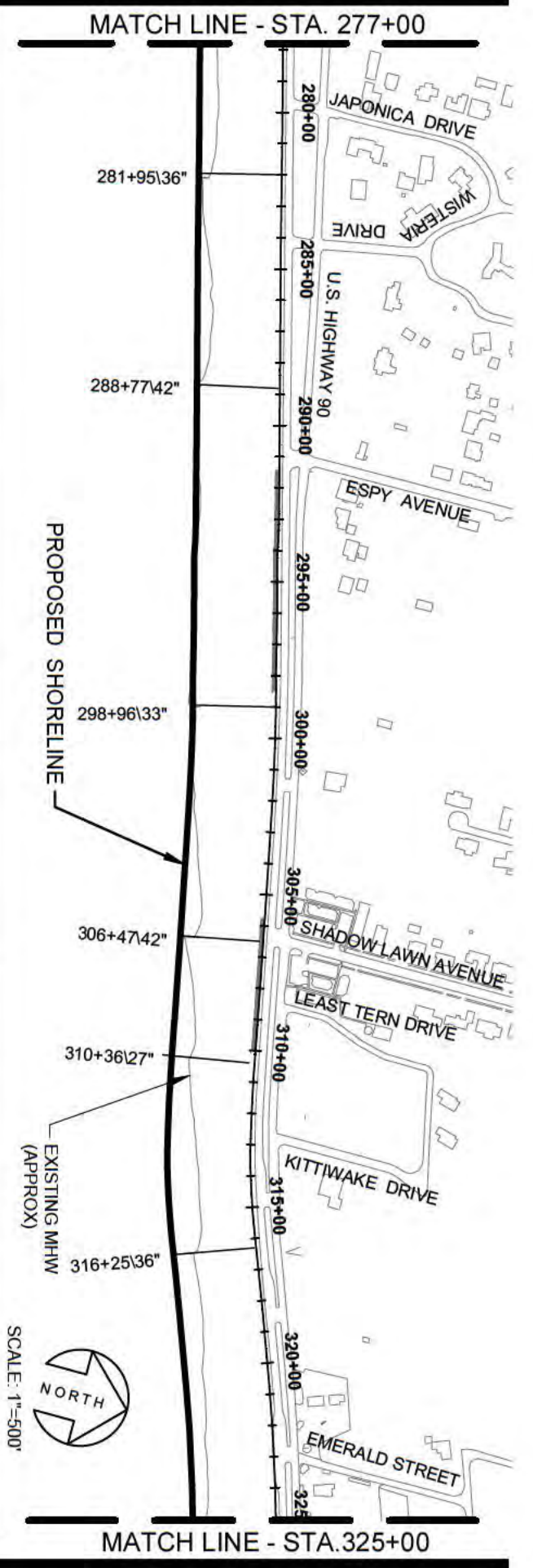
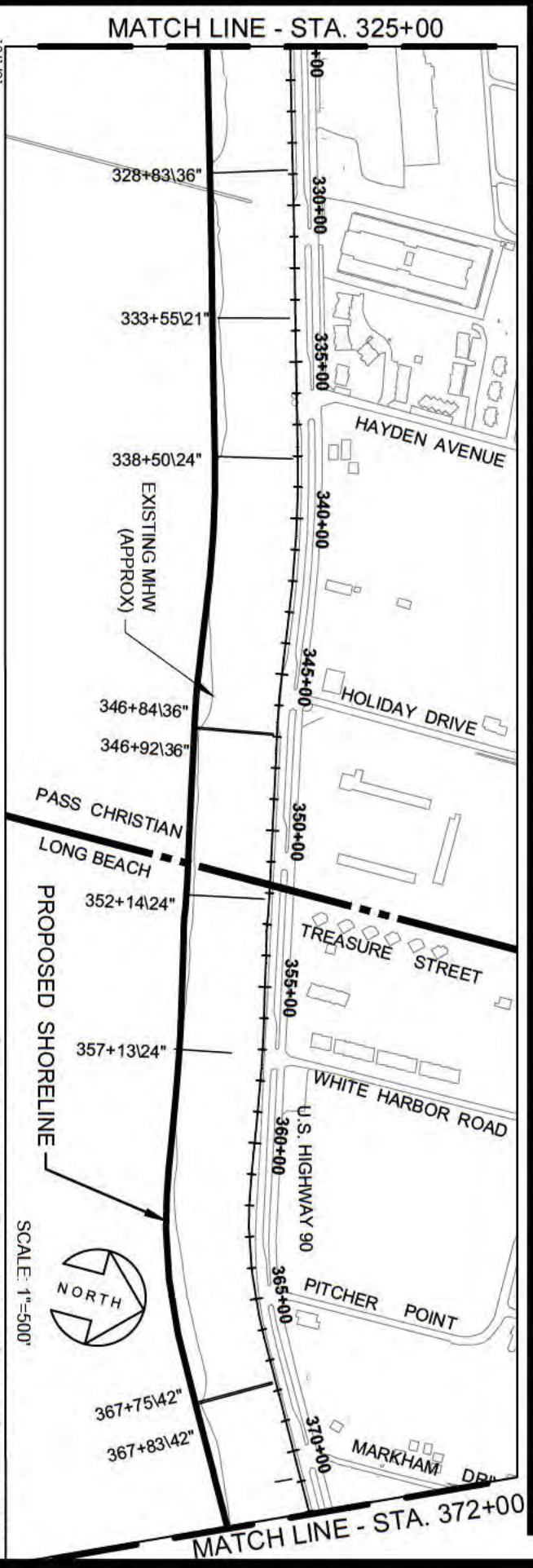



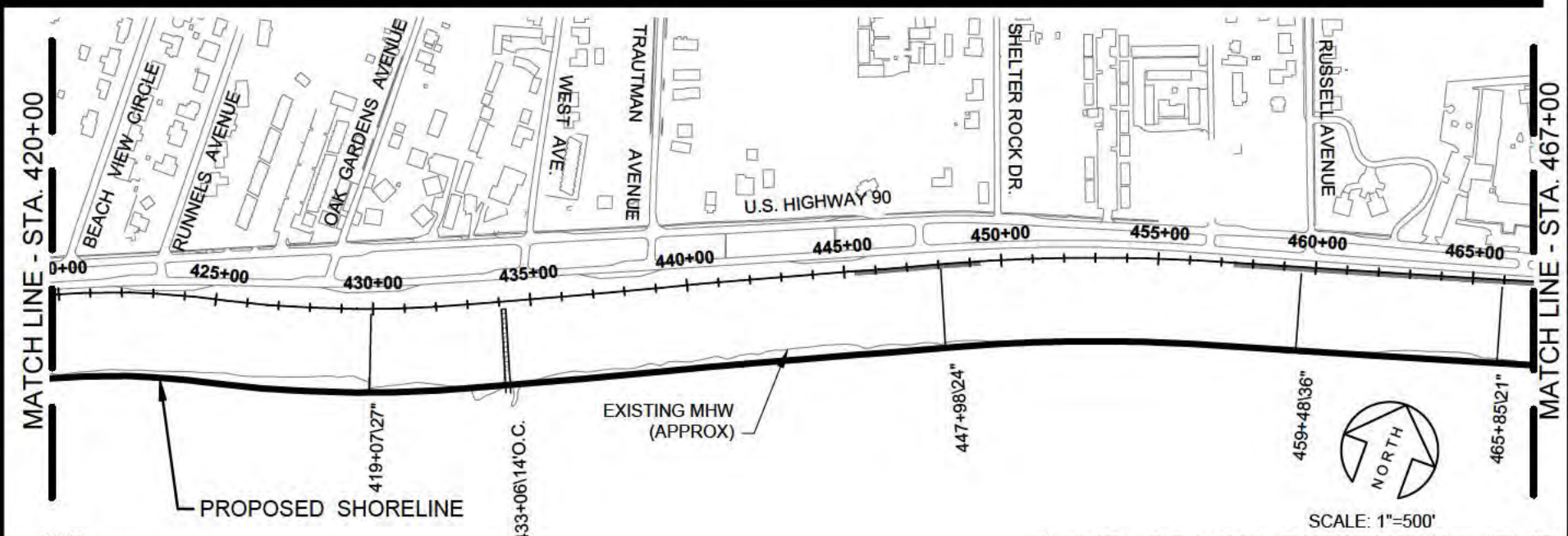
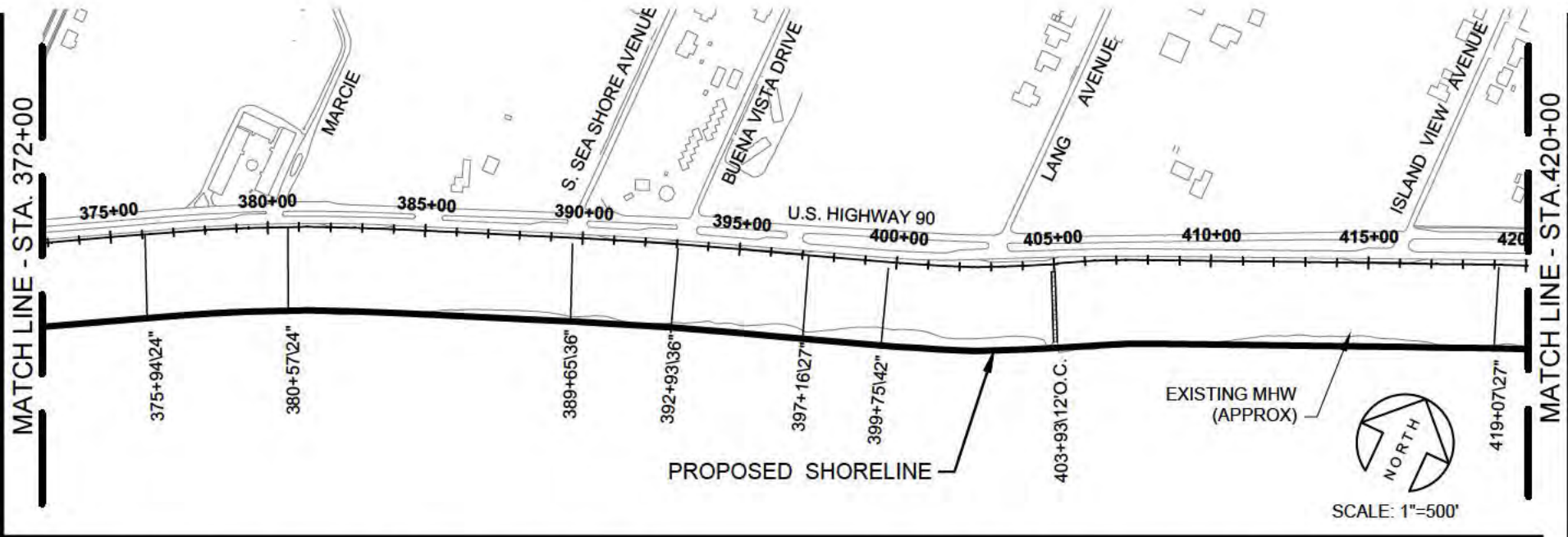

12/1/21  
\\1676\1676-21\1676-21 PERMIT



BROWN, MITCHELL  
& ALEXANDER, INC.  
CONSULTING ENGINEERS

SAND BEACH RENOURISHMENT  
HARRISON COUNTY SAND BEACH DEPARTMENT  
HARRISON COUNTY MISSISSIPPI  
SHEET 6 OF 31

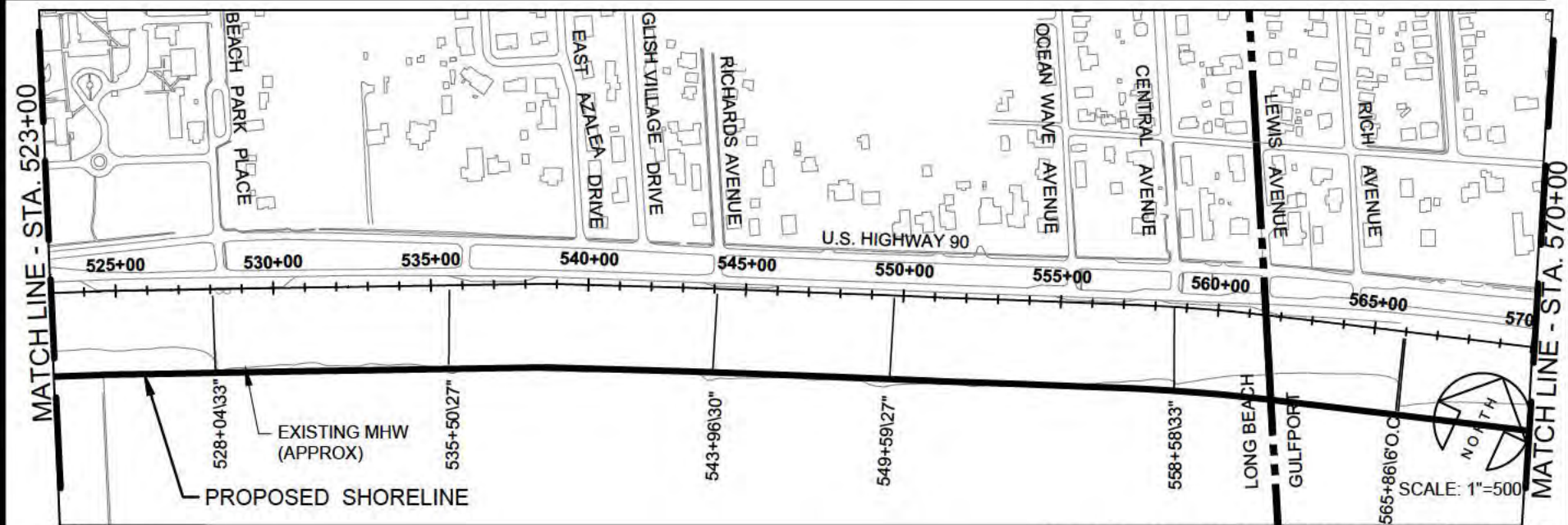
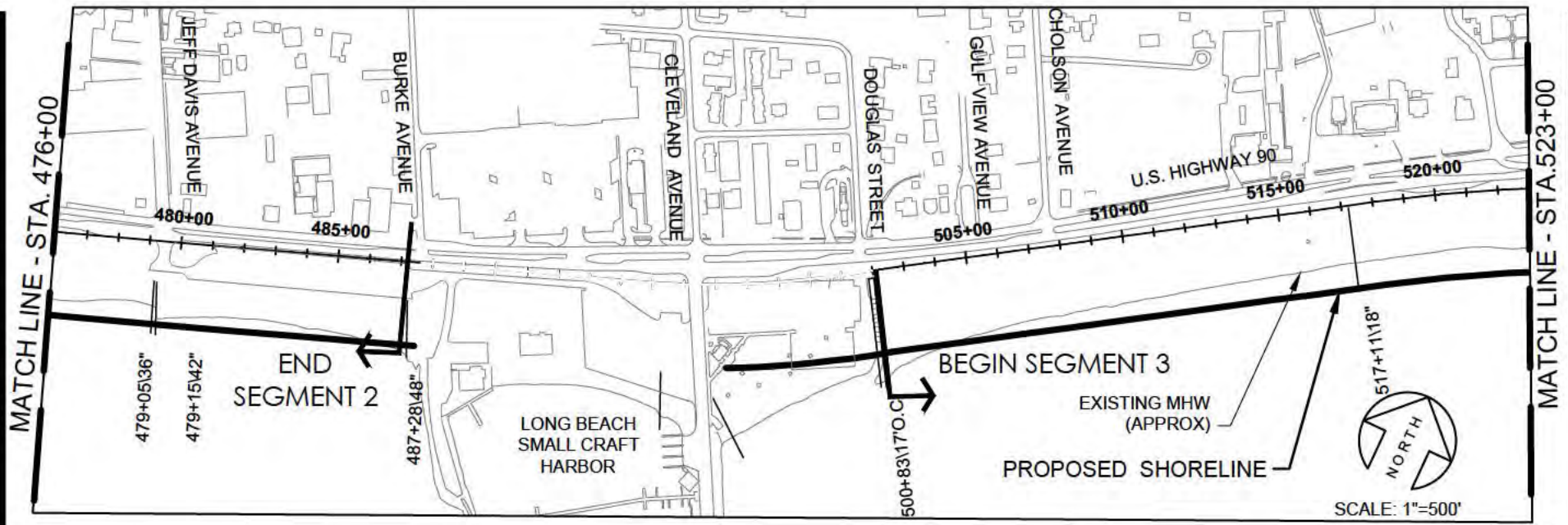

12/1/21  
\\1676\1676-21\1676-21 PERMIT



BROWN, MITCHELL  
& ALEXANDER, INC.  
CONSULTING ENGINEERS

SAND BEACH RENOURISHMENT  
HARRISON COUNTY SAND BEACH DEPARTMENT  
HARRISON COUNTY MISSISSIPPI  
SHEET 7 OF 31



S:\1676\1676-21 PERMIT\DWG\1676-21 PERMIT.dwg, 12/22/2021 2:48:47 PM, DWG To PDF.pc3

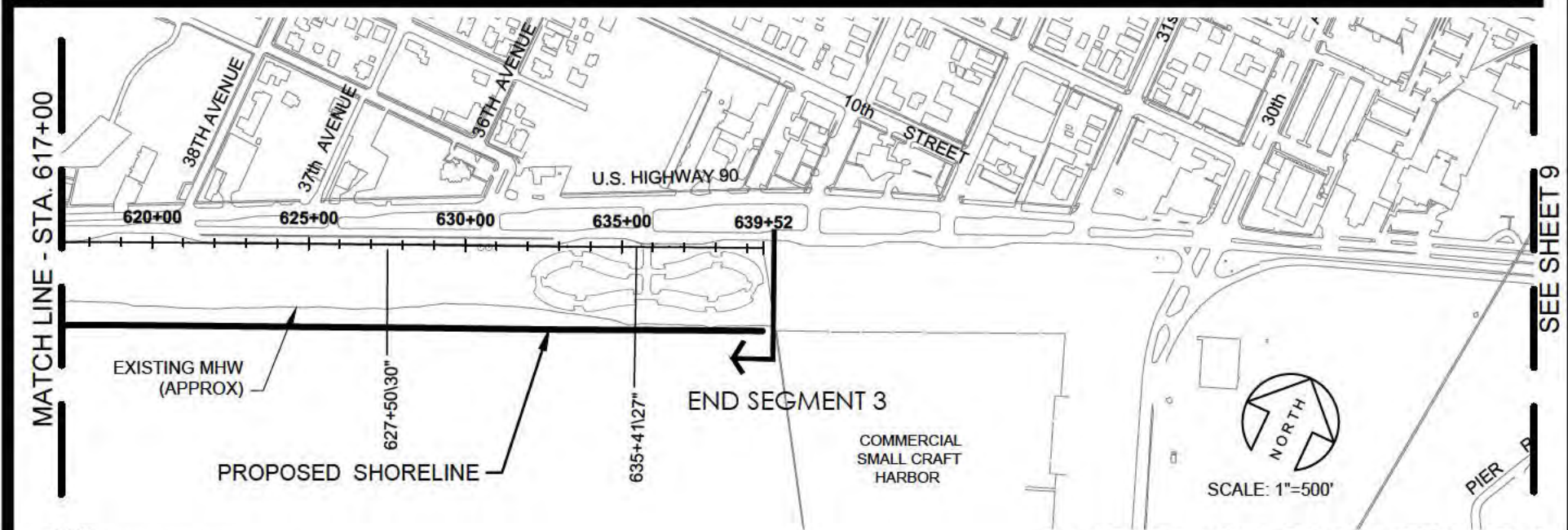
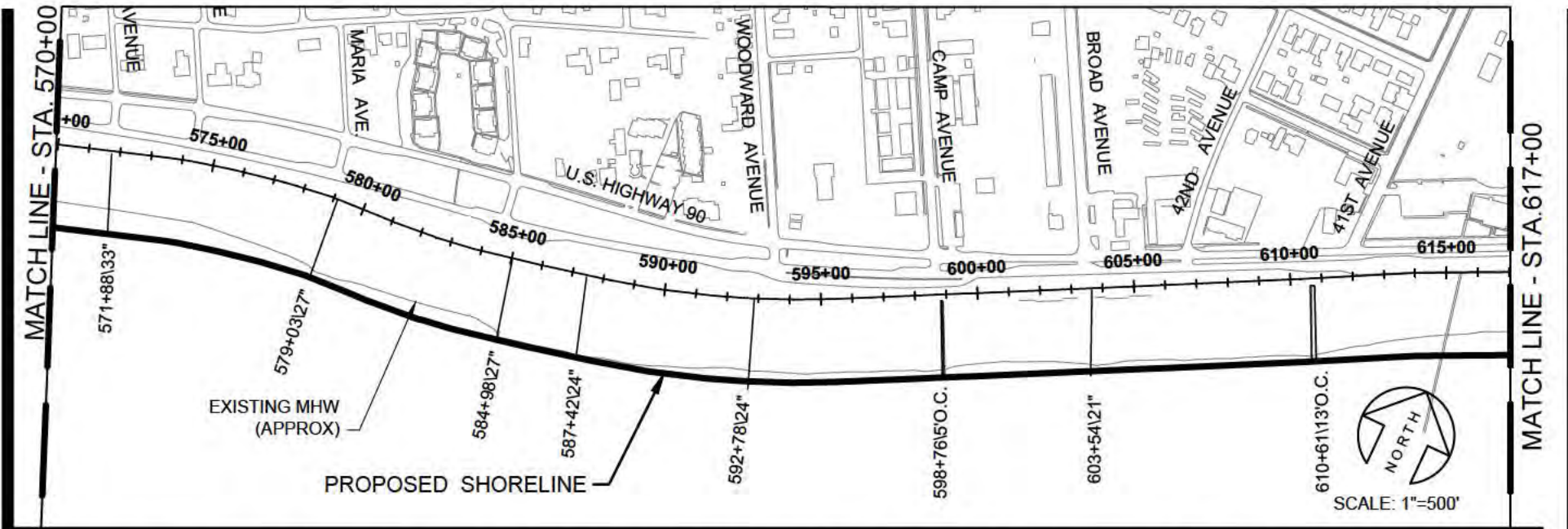

12/1/21  
\\1676\1676-21\1676-21 PERMIT



BROWN, MITCHELL  
& ALEXANDER, INC.  
CONSULTING ENGINEERS

SAND BEACH RENOURISHMENT  
HARRISON COUNTY SAND BEACH DEPARTMENT  
HARRISON COUNTY MISSISSIPPI  
SHEET 8 OF 31



S:\1676\1676-21 PERMIT\CAD\DWG\1676-21 PERMIT.dwg, 12/22/2021 2:48:57 PM, DWG To PDF.pc3

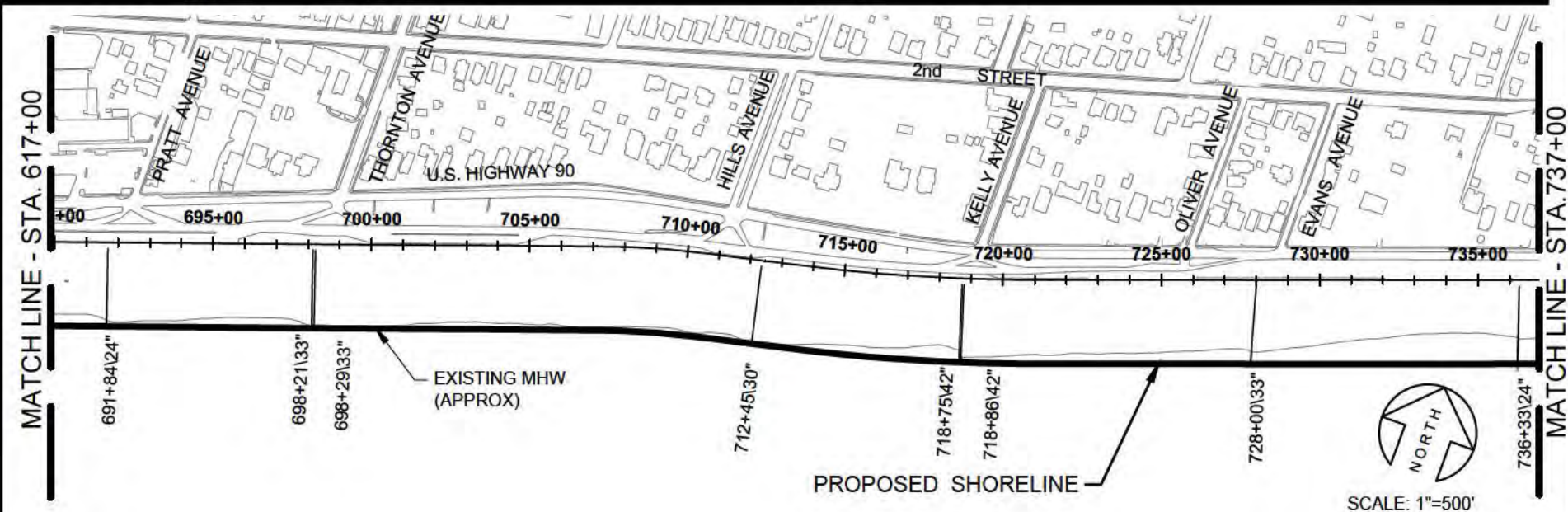
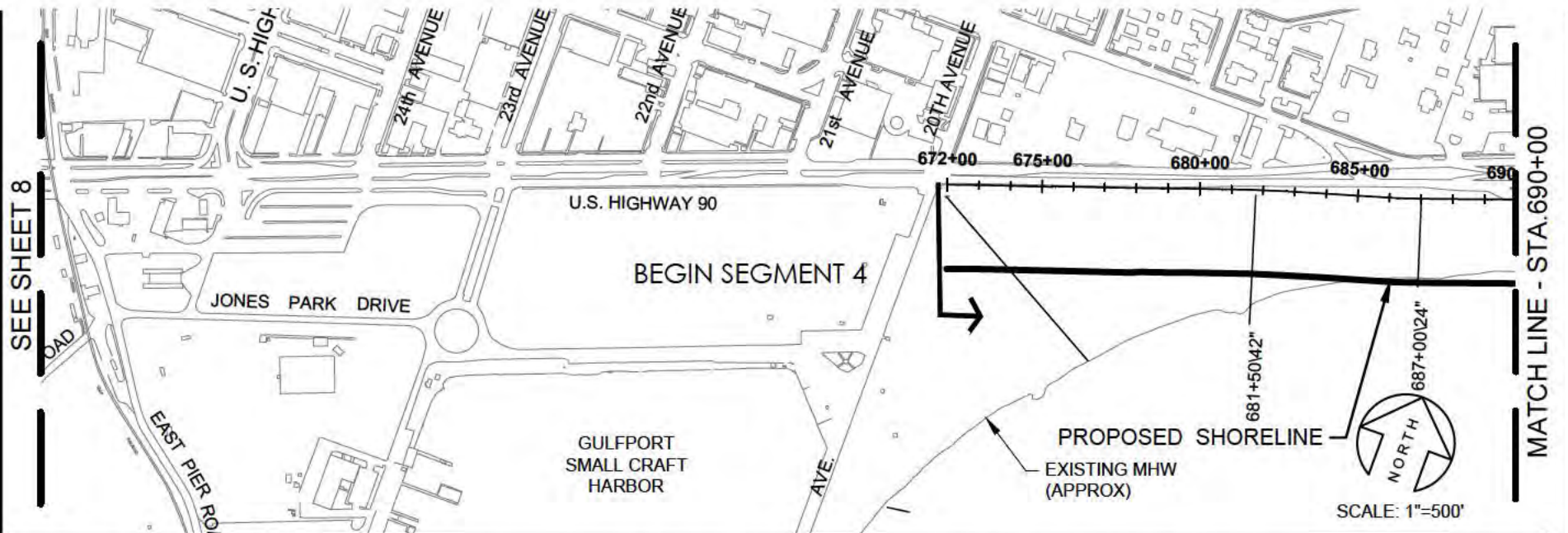

12/1/21  
\\1676\1676-21\1676-21 PERMIT

**bma** BROWN, MITCHELL  
& ALEXANDER, INC.  
CONSULTING ENGINEERS

**SAND BEACH RENOURISHMENT**  
HARRISON COUNTY SAND BEACH DEPARTMENT  
HARRISON COUNTY MISSISSIPPI  
SHEET 9 OF 31



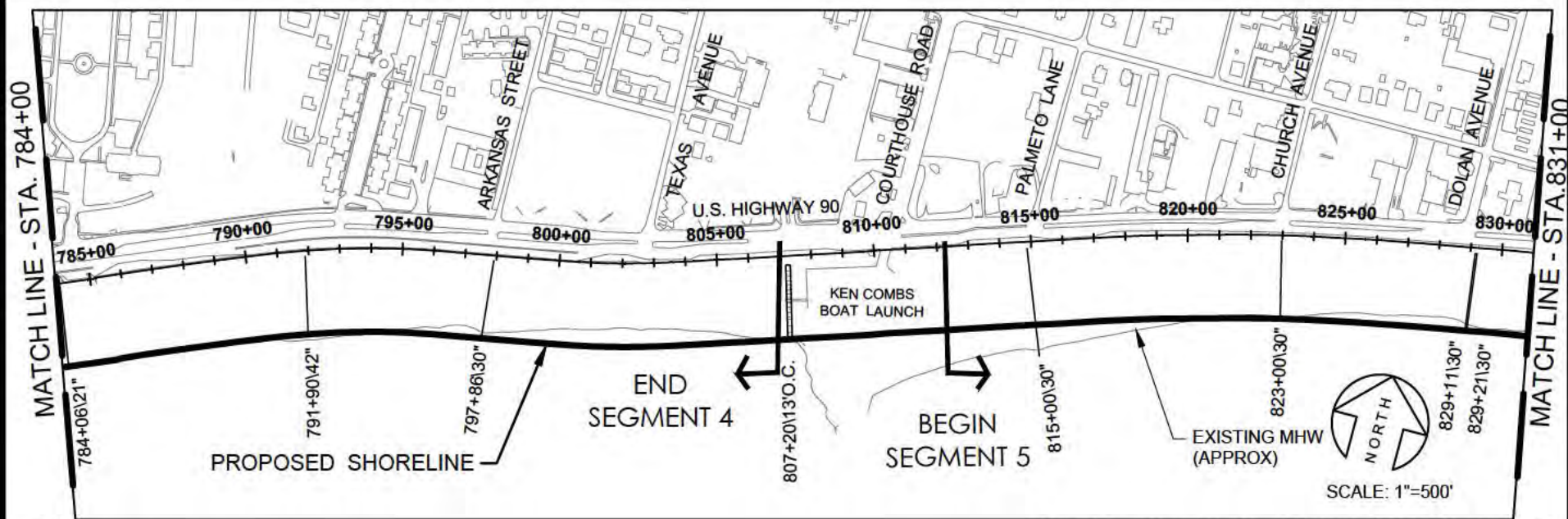
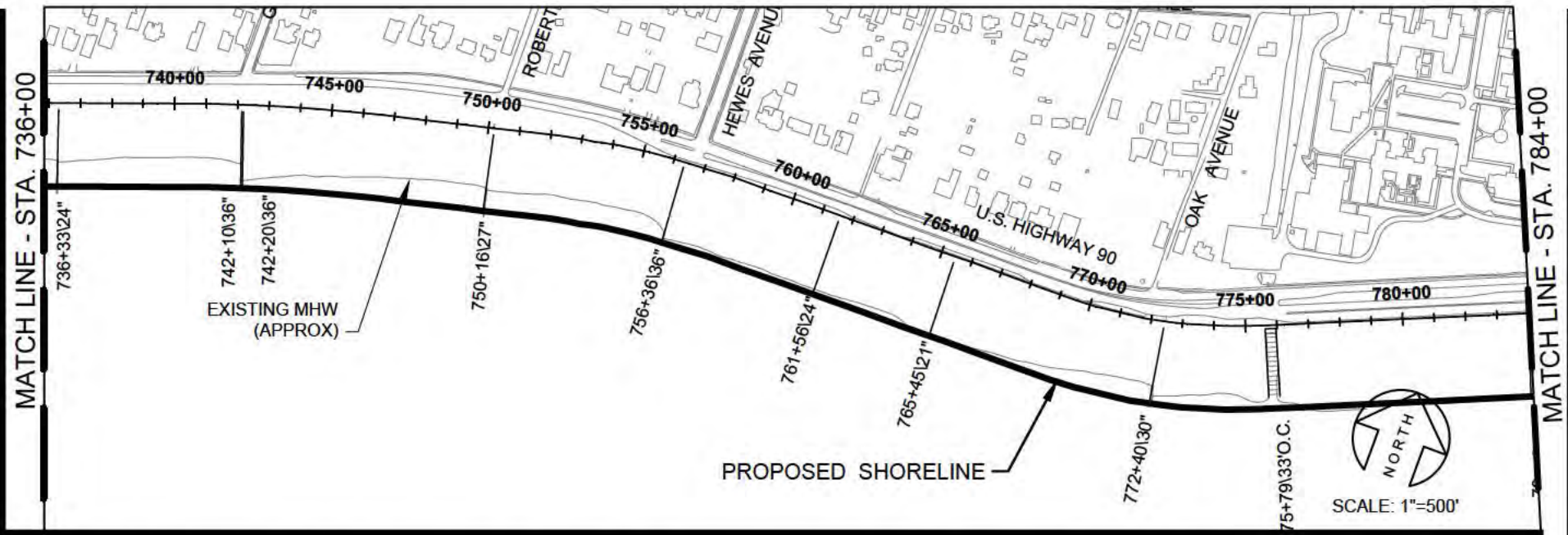

12/1/21  
\\1676\1676-21\1676-21 PERMIT



BROWN, MITCHELL  
& ALEXANDER, INC.  
CONSULTING ENGINEERS

SAND BEACH RENOURISHMENT  
HARRISON COUNTY SAND BEACH DEPARTMENT  
HARRISON COUNTY MISSISSIPPI  
SHEET 10 OF 31

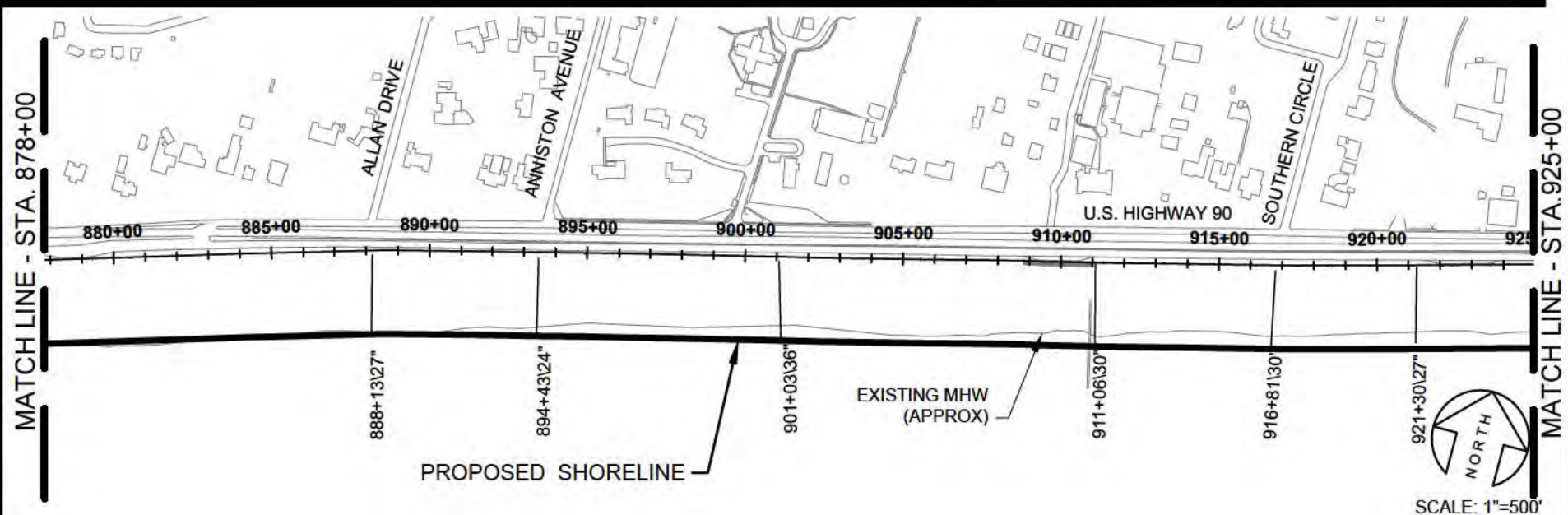
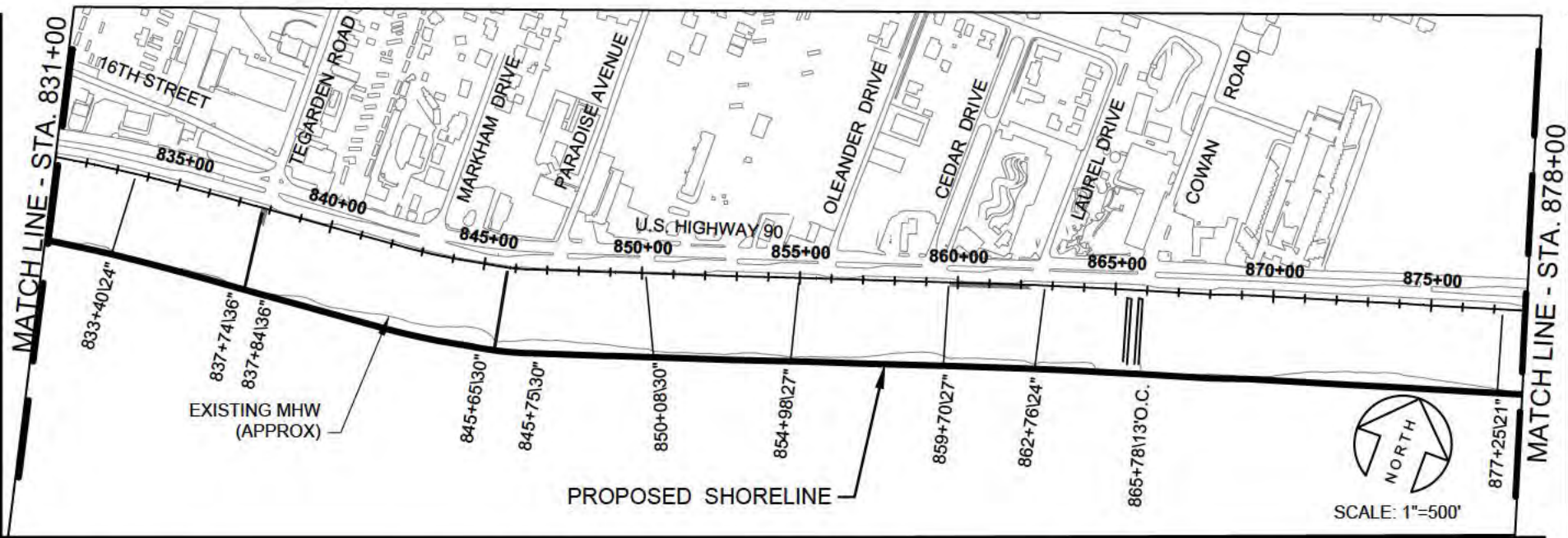

12/1/21  
 \1676\1676-21\1676-21 PERMIT

**bma** BROWN, MITCHELL  
 & ALEXANDER, INC.  
 CONSULTING ENGINEERS

**SAND BEACH RENOURISHMENT**  
 HARRISON COUNTY SAND BEACH DEPARTMENT  
 HARRISON COUNTY MISSISSIPPI  
 SHEET 11 OF 31



12/1/21  
\\676\1676-21\1676-21 PERMIT

**BROWN, MITCHELL  
& ALEXANDER, INC.**  
CONSULTING ENGINEERS

# SAND BEACH RENOURISHMENT HARRISON COUNTY SAND BEACH DEPARTMENT HARRISON COUNTY MISSISSIPPI

SHEET 12 OF 31

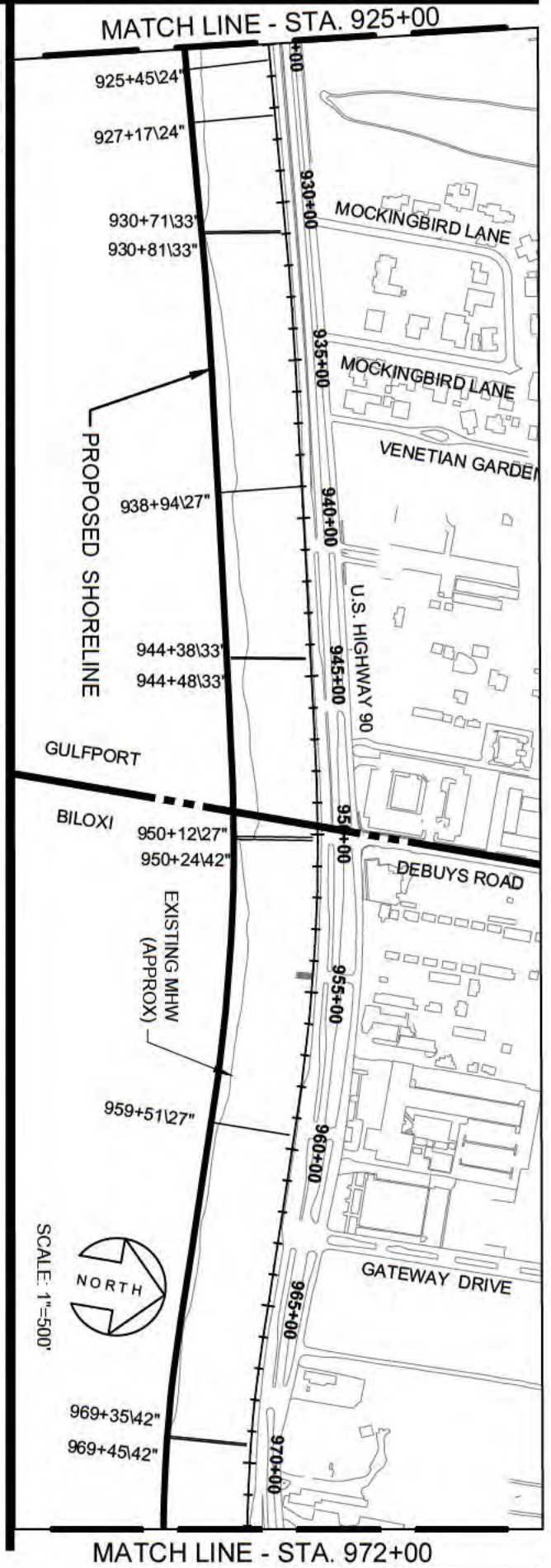
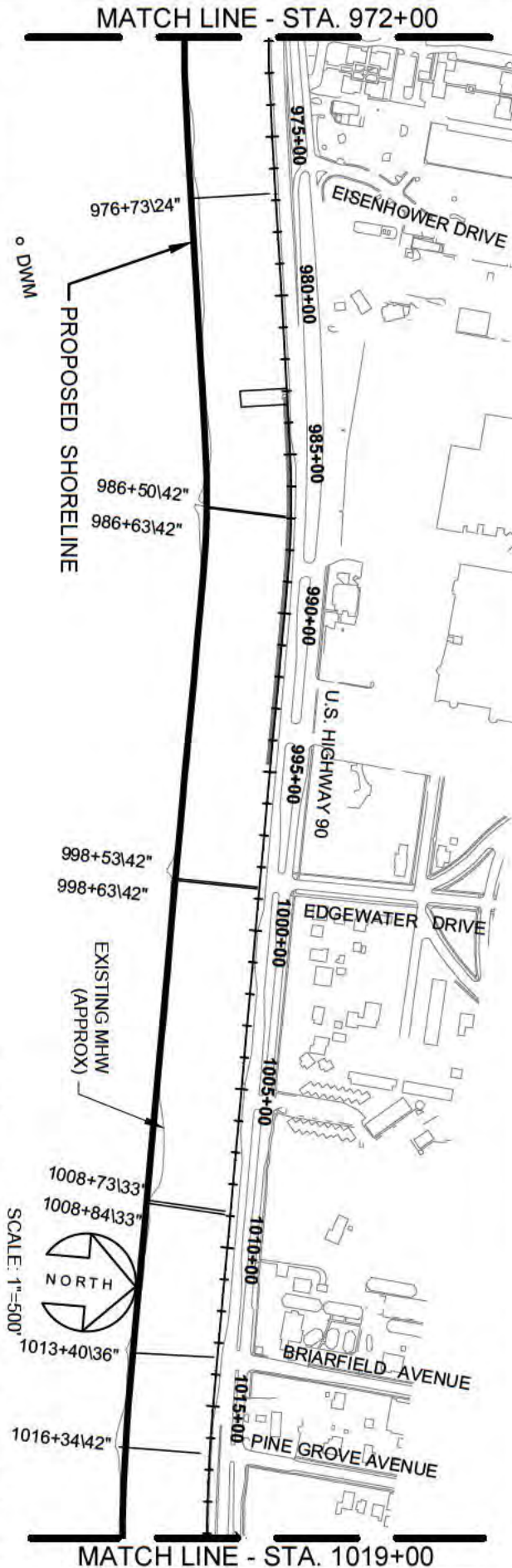





**bma**  
BROWN, MITCHELL  
& ALEXANDER, INC.  
CONSULTING ENGINEERS

12/1/21  
\\676\1676-21\1676-21 PERMIT

# SAND BEACH RENOURISHMENT

HARRISON COUNTY SAND BEACH DEPARTMENT  
HARRISON COUNTY MISSISSIPPI  
SHEET 14 OF 31

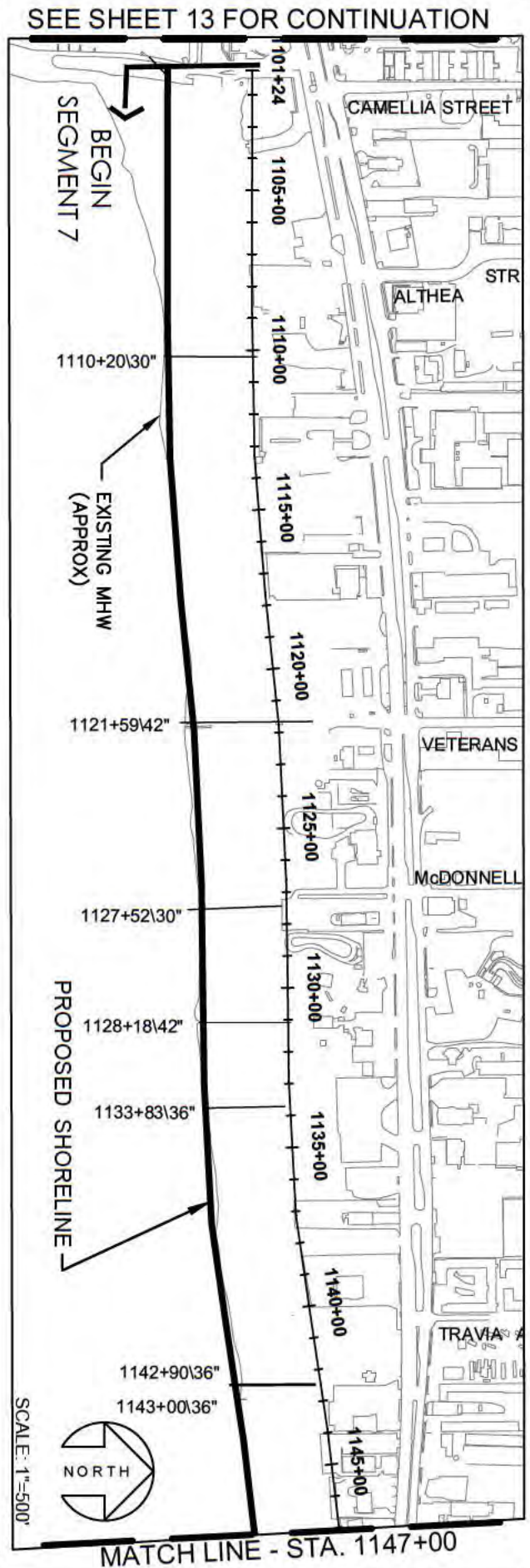
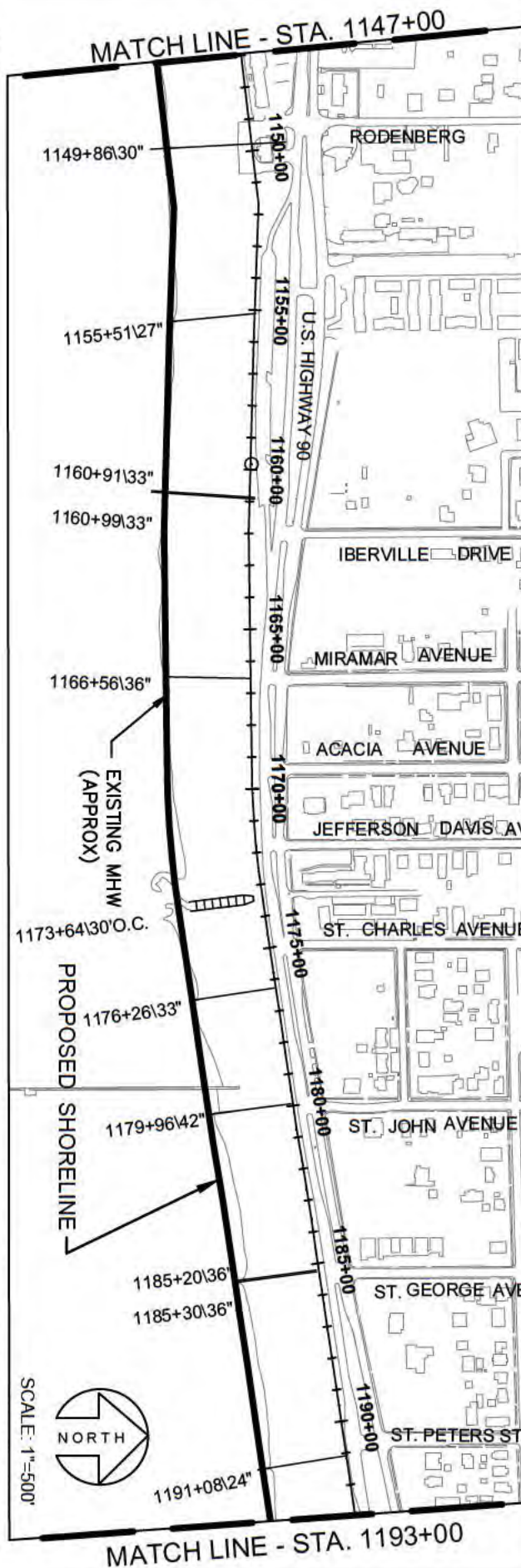

S:\1676\1676-21 PERMIT\CAD\DWG\1676-21 PERMIT.dwg, 1/13/2022 8:46:53 AM, DWG To PDF.pc3

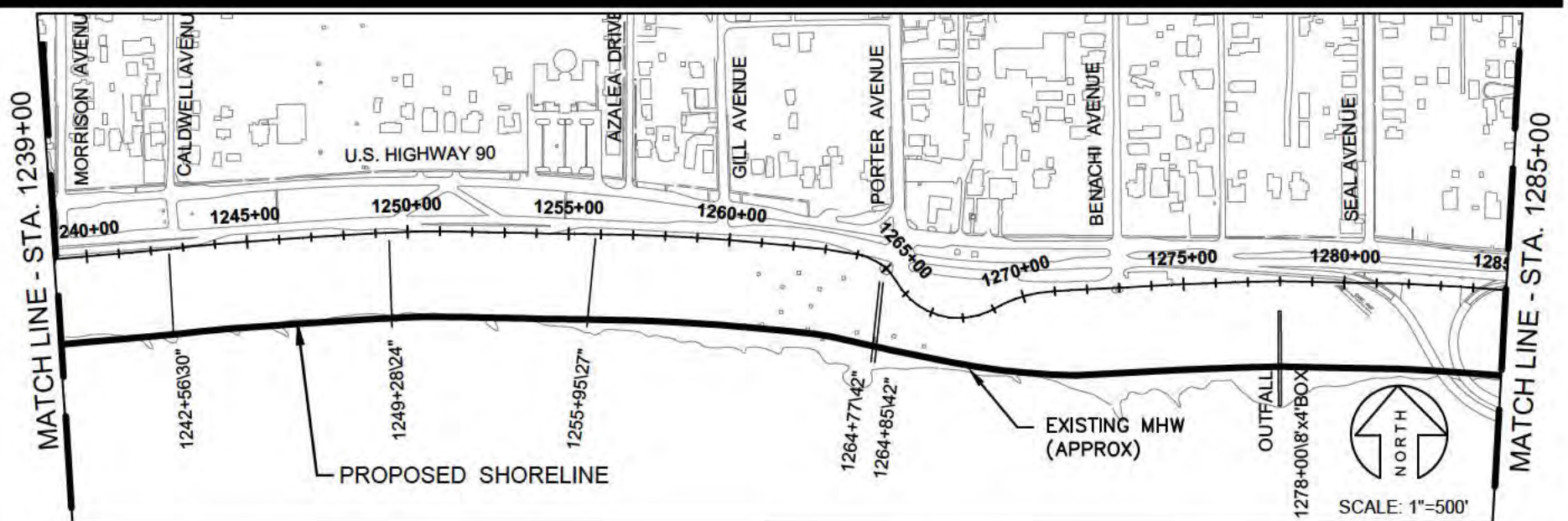
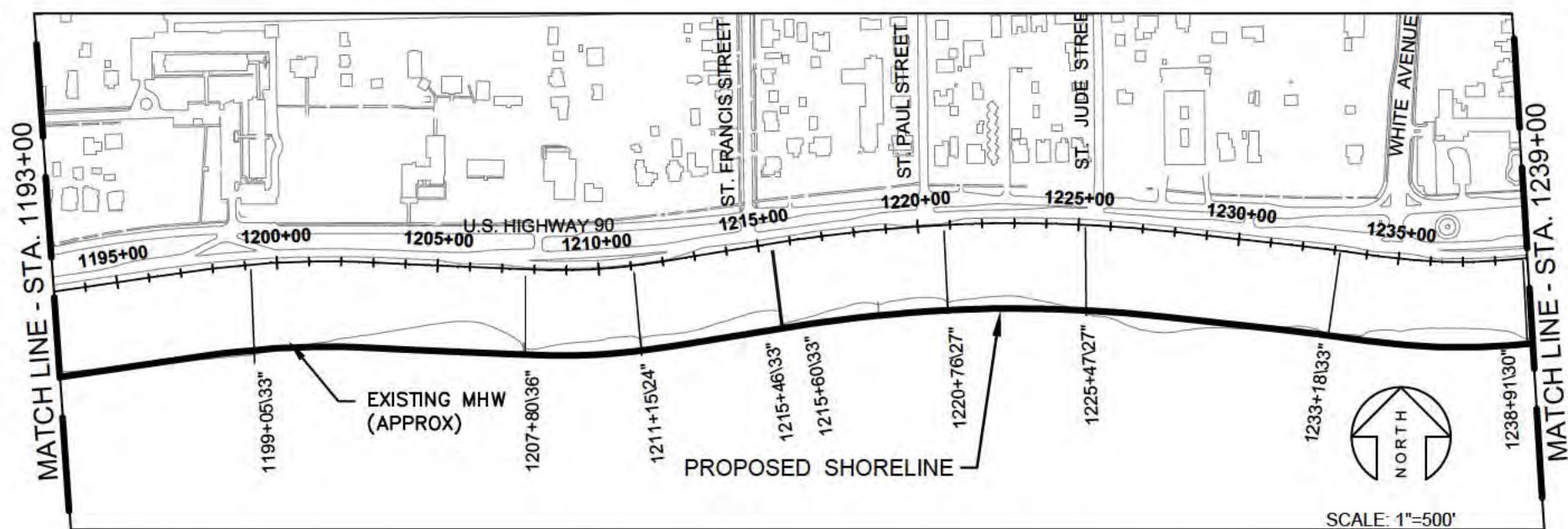

12/1/21  
\\1676\1676-21\1676-21 PERMIT

**bma** BROWN, MITCHELL  
& ALEXANDER, INC.  
CONSULTING ENGINEERS

**SAND BEACH RENOURISHMENT**  
HARRISON COUNTY SAND BEACH DEPARTMENT  
HARRISON COUNTY MISSISSIPPI  
SHEET 15 OF 31



S:\1676\1676-21 PERMIT\CAD\DWG\1676-21 PERMIT.dwg, 1/6/2022 8:20:05 AM, DWG To PDF.pc3

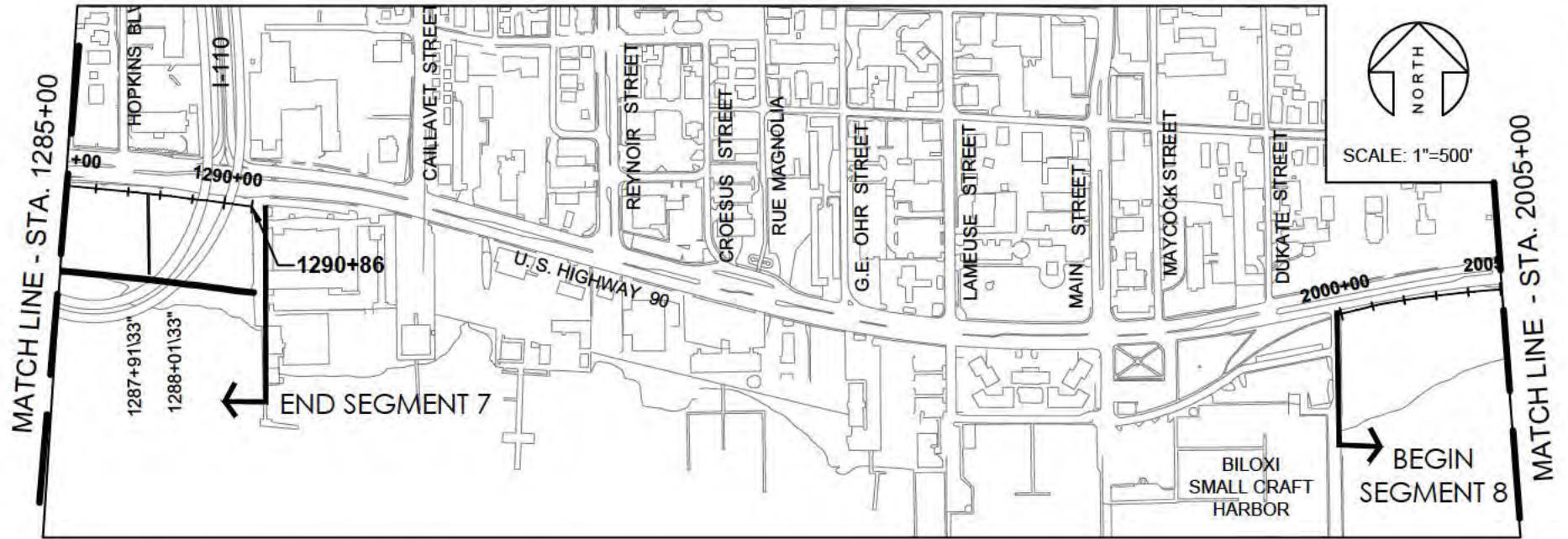
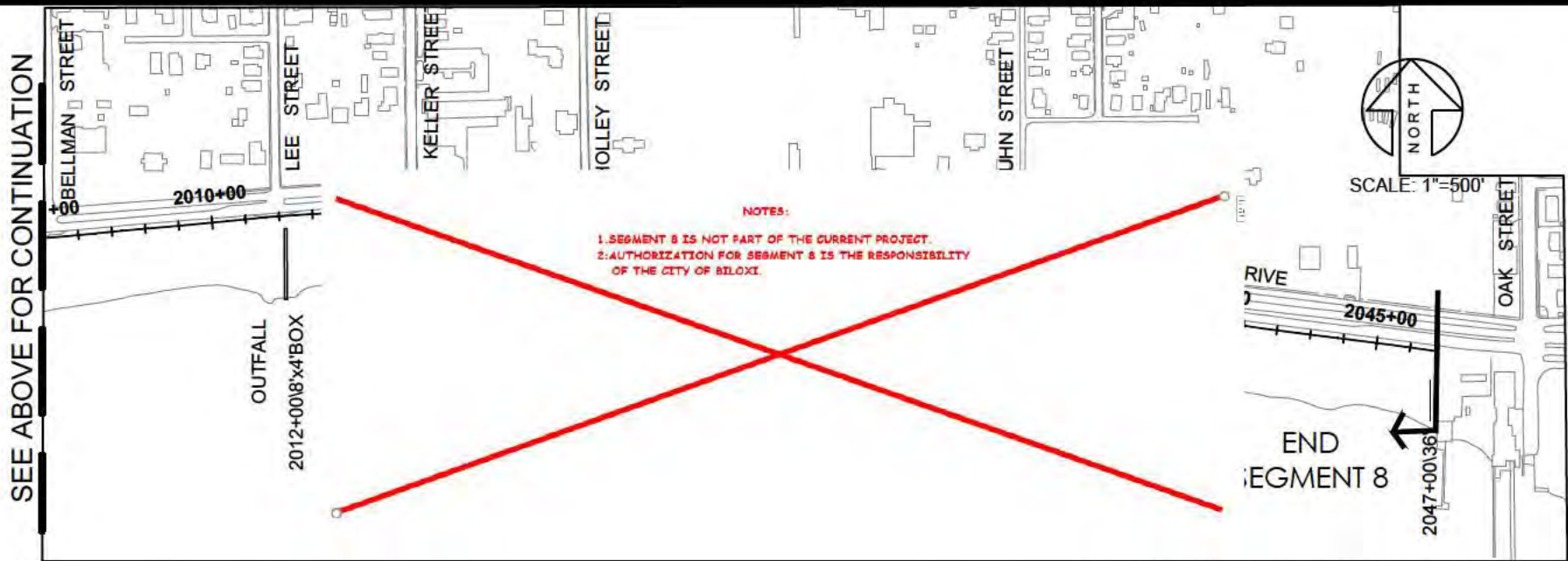

12/1/21  
\\1676\1676-21\1676-21 PERMIT

**bma** BROWN, MITCHELL  
& ALEXANDER, INC.  
CONSULTING ENGINEERS

**SAND BEACH RENOURISHMENT**  
HARRISON COUNTY SAND BEACH DEPARTMENT  
HARRISON COUNTY MISSISSIPPI  
SHEET 16 OF 31

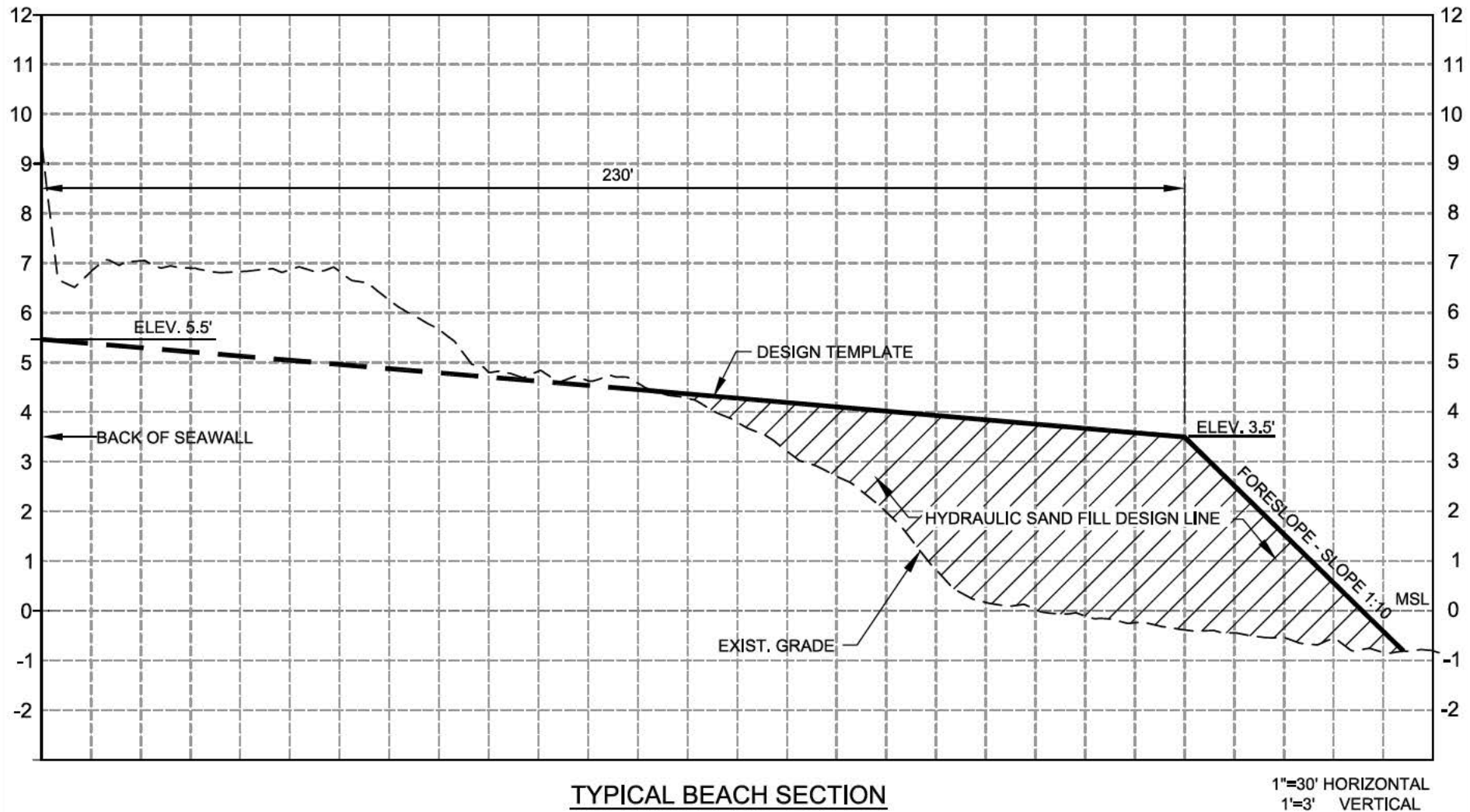

12/23/21  
\\1676\1676-21\1676-21 BORROW AREAS FOR PERMIT

**bma** BROWN, MITCHELL  
& ALEXANDER, INC.  
CONSULTING ENGINEERS

**SAND BEACH RENOURISHMENT**  
HARRISON COUNTY SAND BEACH DEPARTMENT  
TYPICAL SECTIONS  
HARRISON COUNTY, MISSISSIPPI  
SHEET 17 OF 31



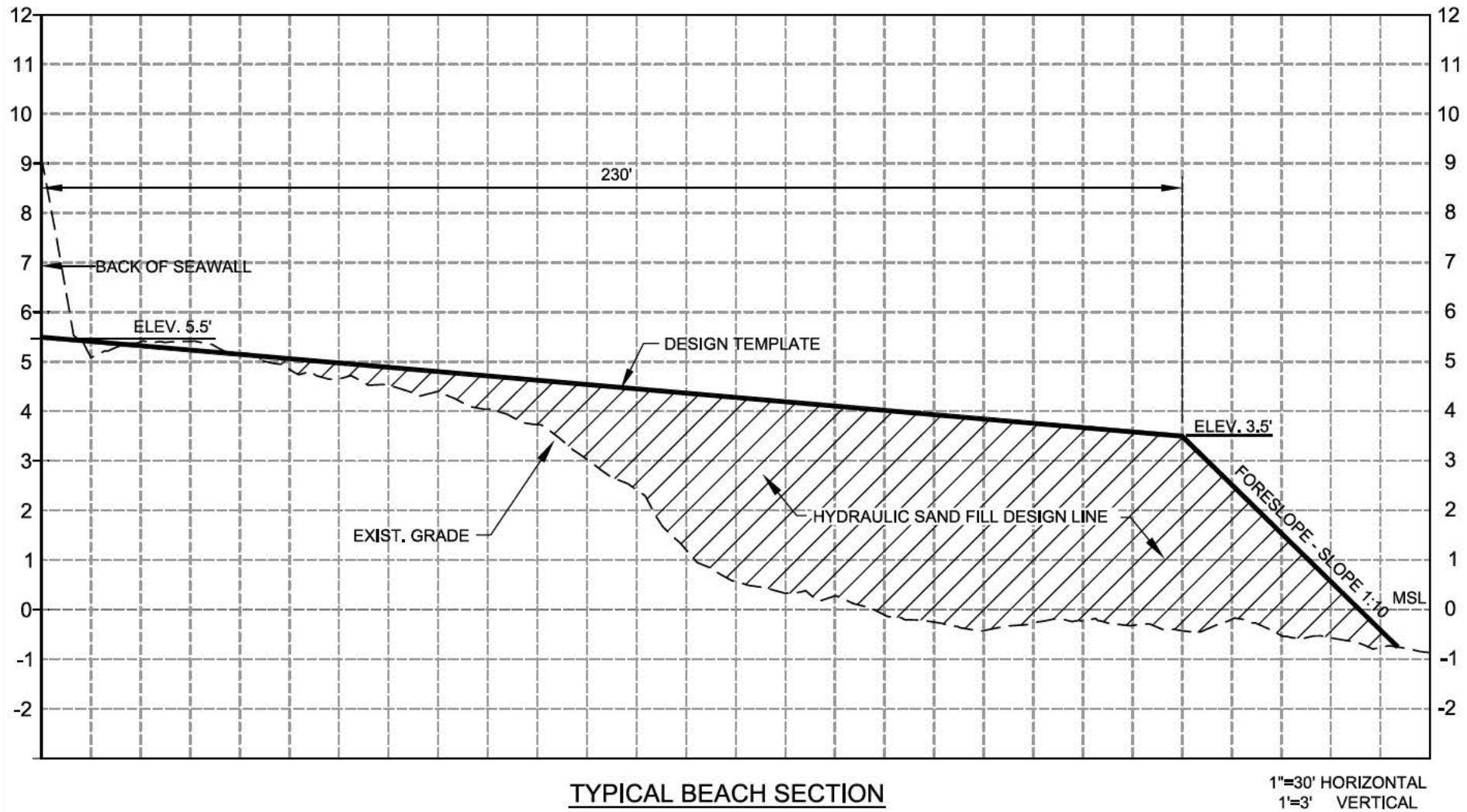

# SAND BEACH RENOURISHMENT

## HARRISON COUNTY SAND BEACH DEPARTMENT

### EARTHWORK SUMMARY TABLE

SEGMENT	LANDMARKS	FILL VOL (CY)	AREA ACRES
1	STA. 0+00 - STA. 136+00 (HENDERSON POINT TO PASS CHRISTIAN HARBOR)	245,913	25.47
2	STA. 147+50 - STA. 487+50 (PASS CHRISTIAN HARBOR TO LONG BEACH HARBOR)	384,398	30.74
3	STA. 502+00 - STA. 539+52 (LONG BEACH HARBOR TO GPT. COMM. SMALL CRAFT HARBOR)	137,178	11.92
4	STA. 672+00 - STA. 812+50 (GPT. SMALL CRAFT HARBOR TO KEN COMBS PIER)	135,907	11.79
5	STA. 812+00 - STA. 1067+60 (KEN COMBS PIER TO BROADWATER MARINA)	296,190	33.40
6	STA. 1076+16 - STA. 1094+55 (BROADWATER MARINA TO TREASURE BAY)	15,705	1.05
7	STA. 1101+24 - STA. 1290+86 (TREASURE BAY TO I-110 LOOP)	272,404	23.84
TOTALS		1,487,695	138.21

1/13/22  
\\1676\1676-21\1676-21 PERMIT



**BROWN, MITCHELL  
& ALEXANDER, INC.**  
CONSULTING ENGINEERS

**SAND BEACH RENOURISHMENT**  
**HARRISON COUNTY SAND BEACH DEPARTMENT**  
**EARTHWORK QUANTITIES**

HARRISON COUNTY MISSISSIPPI

SHEET 19 OF 31



## LEGEND



1972 DREDGE AREA



1986 DREDGE AREA



2001 DREDGE AREA



PROPOSED BORROW AREA

12/2/21  
\\1676\1676-21\1676-21 BORROW AREAS FOR PERMIT

**bma** BROWN, MITCHELL  
& ALEXANDER, INC.  
CONSULTING ENGINEERS

SAND BEACH RENOURISHMENT  
HARRISON COUNTY SAND BEACH DEPARTMENT  
BORROW AREA LEGEND

HARRISON COUNTY, MISSISSIPPI

SHEET 20 OF 31



SCALE: 1" = 2000'

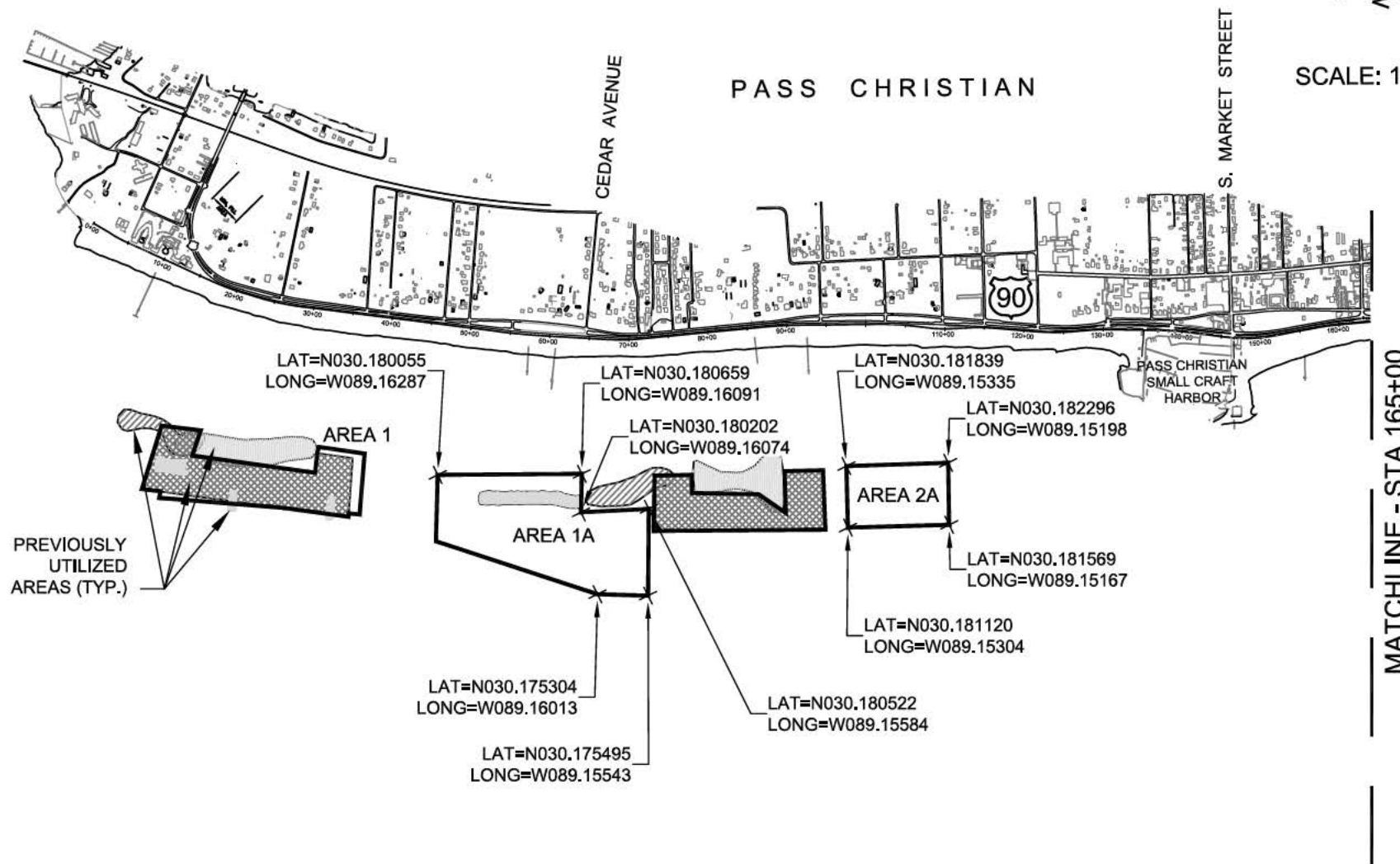

# SAND BEACH RENOURISHMENT

## HARRISON COUNTY SAND BEACH DEPARTMENT

### BORROW AREAS

HARRISON COUNTY, MISSISSIPPI

SHEET 21 OF 31

12/2/21  
\\1676\\1676-21\\1676-21 BORROW AREAS FOR PERMIT

**bma** BROWN, MITCHELL  
& ALEXANDER, INC.  
CONSULTING ENGINEERS





SCALE: 1" = 2000'

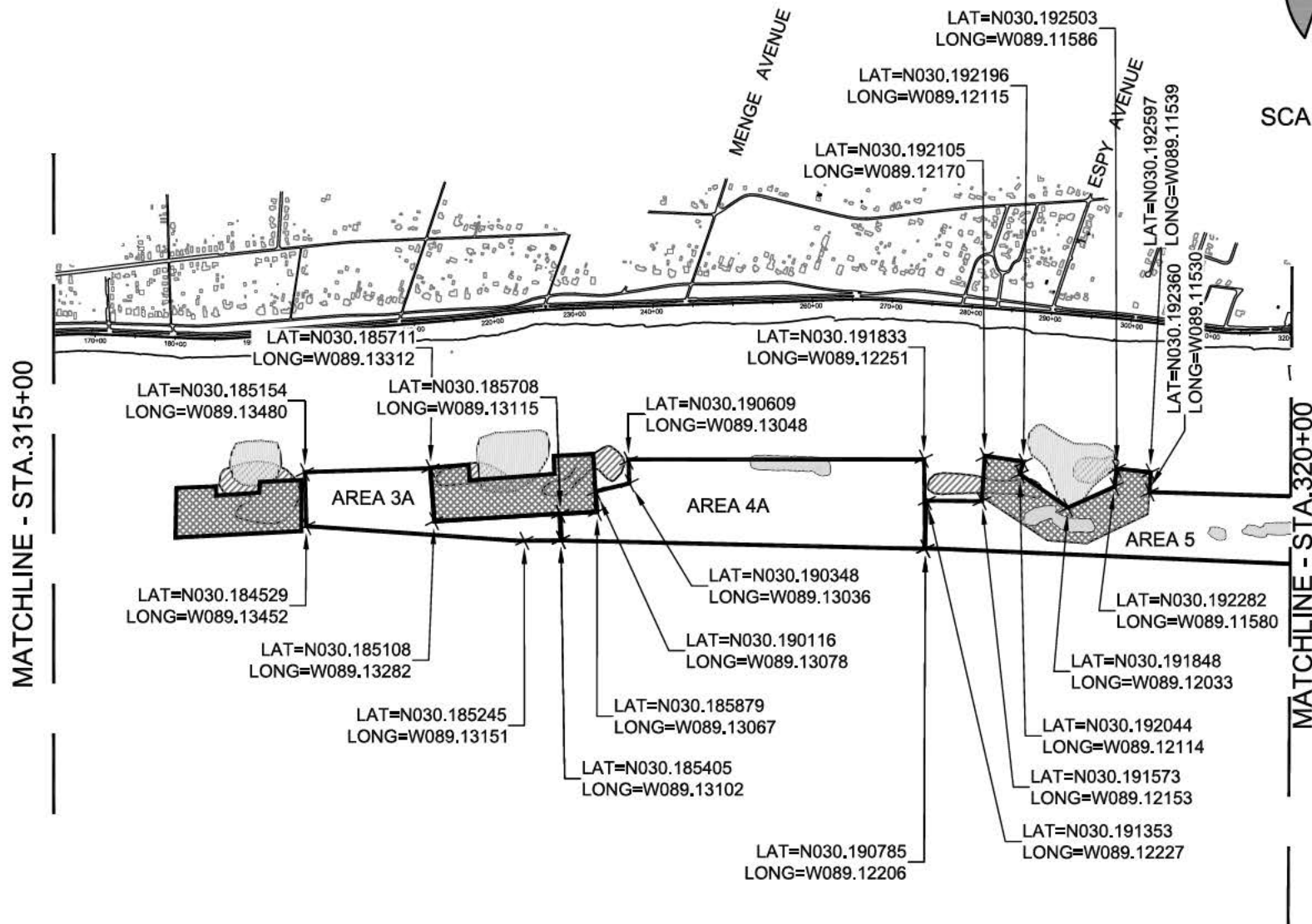

12/2/21  
\\1676\\1676-21\\1676-21 BORROW AREAS FOR PERMIT

**bma** BROWN, MITCHELL  
& ALEXANDER, INC.  
CONSULTING ENGINEERS

# SAND BEACH RENOURISHMENT HARRISON COUNTY SAND BEACH DEPARTMENT BORROW AREAS

HARRISON COUNTY, MISSISSIPPI

SHEET 22 OF 31



SCALE: 1" = 2000'

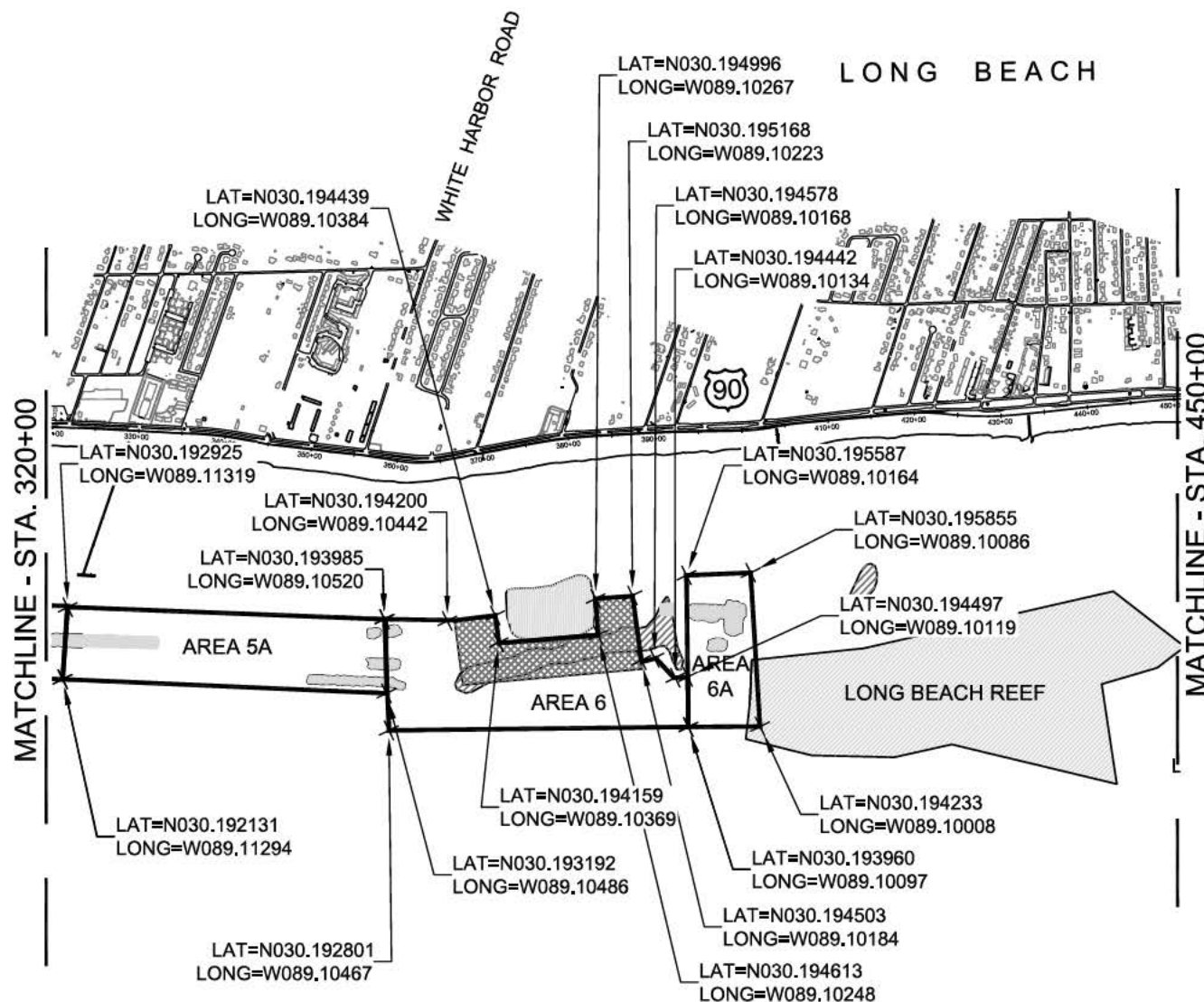

12/2/21  
\\1676\1676-21\1676-21 BORROW AREAS FOR PERMIT

**bma** BROWN, MITCHELL  
& ALEXANDER, INC.  
CONSULTING ENGINEERS

# SAND BEACH RENOURISHMENT HARRISON COUNTY SAND BEACH DEPARTMENT BORROW AREAS

HARRISON COUNTY, MISSISSIPPI

SHEET 23 OF 31





SCALE: 1" = 2000'

LONG BEACH

GULFPORT

BROAD AVENUE

JEFF DAVIS AVENUE

MATCHLINE - STA. 450+00

MATCHLINE - STA. 630+00

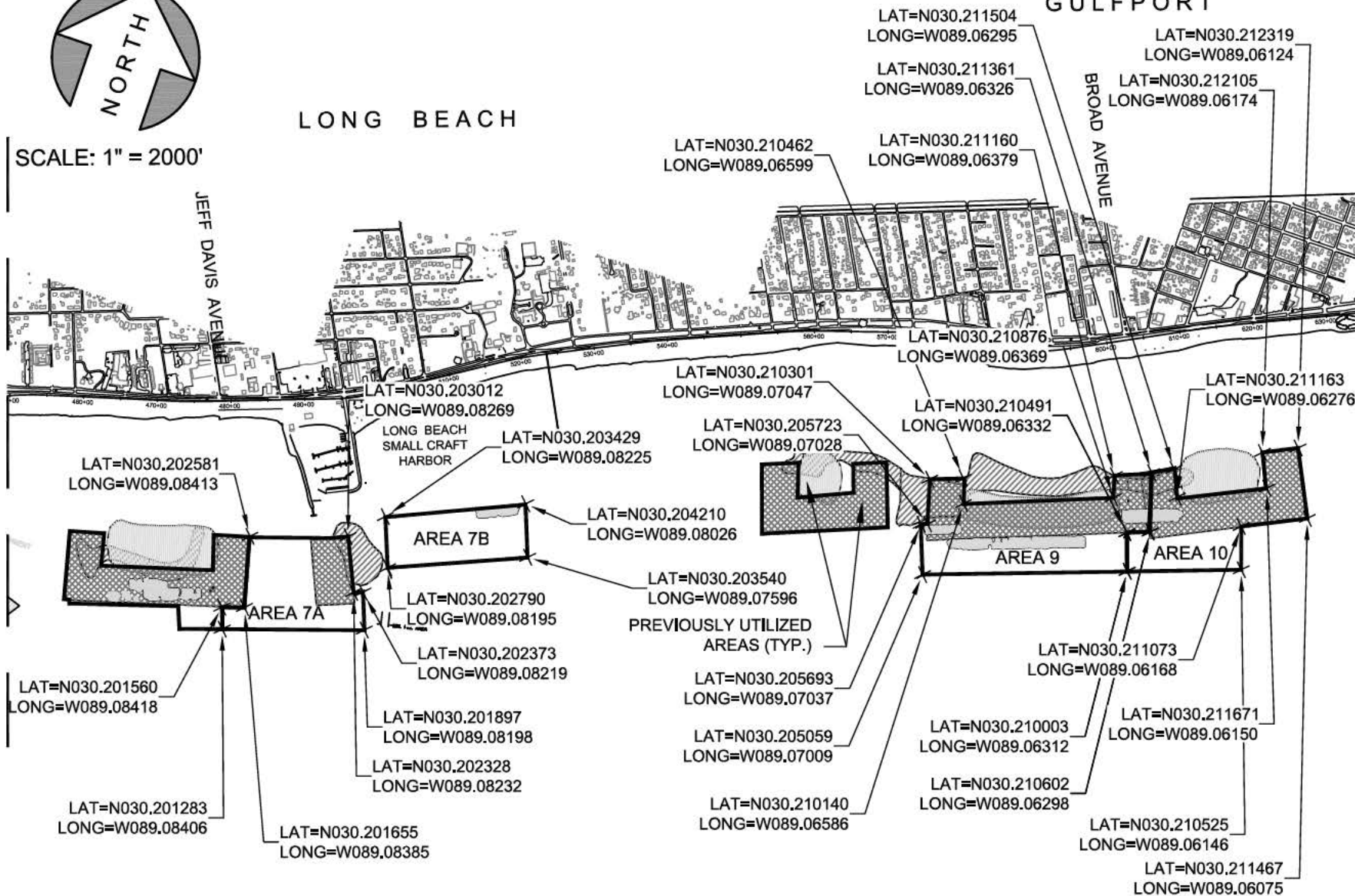

12/2/21  
\\1676\\1676-21\\1676-21 BORROW AREAS FOR PERMIT



BROWN, MITCHELL  
& ALEXANDER, INC.  
CONSULTING ENGINEERS

SAND BEACH RENOURISHMENT  
HARRISON COUNTY SAND BEACH DEPARTMENT

BORROW AREAS

HARRISON COUNTY, MISSISSIPPI

SHEET 24 OF 31



SCALE: 1" = 2000'

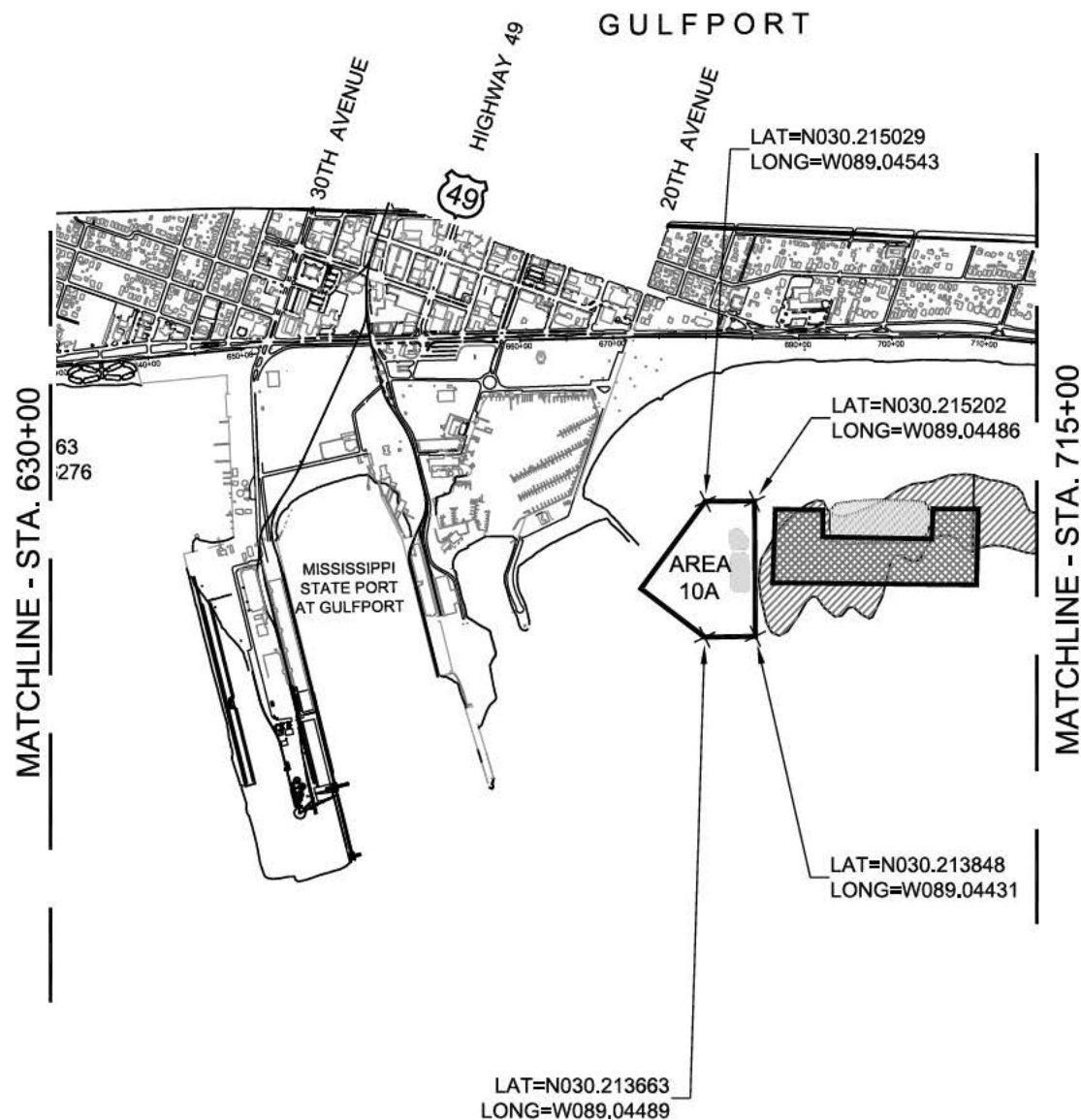

SAND BEACH RENOURISHMENT  
HARRISON COUNTY SAND BEACH DEPARTMENT  
BORROW AREAS

HARRISON COUNTY, MISSISSIPPI  
SHEET 25 OF 31

12/2/21  
\\1676\1676-21\1676-21 BORROW AREAS FOR PERMIT

**bma** BROWN, MITCHELL  
& ALEXANDER, INC.  
CONSULTING ENGINEERS





SCALE: 1" = 2000'

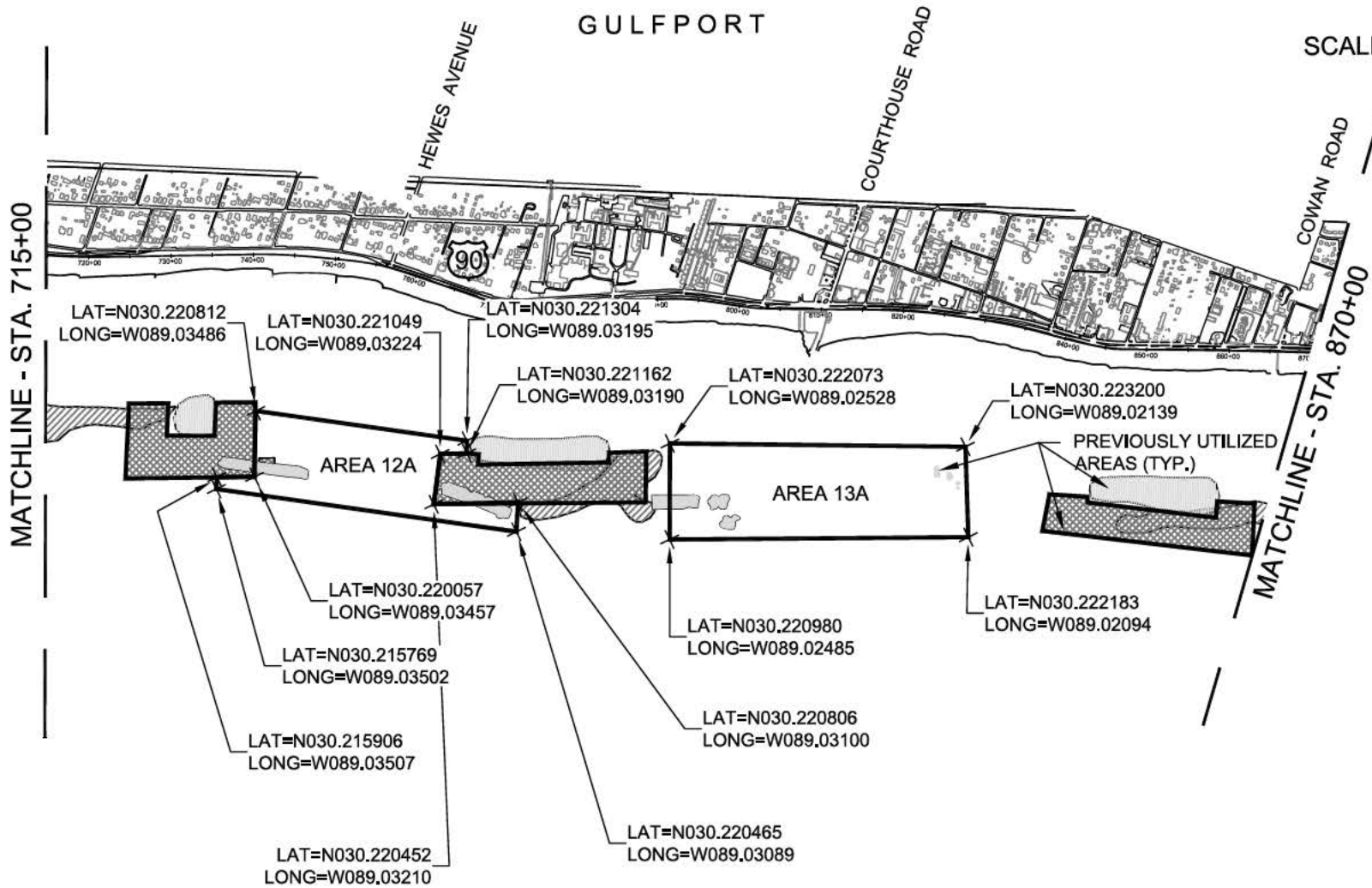

# SAND BEACH RENOURISHMENT HARRISON COUNTY SAND BEACH DEPARTMENT BORROW AREAS

HARRISON COUNTY, MISSISSIPPI  
SHEET 26 OF 31



SCALE: 1" = 2000'

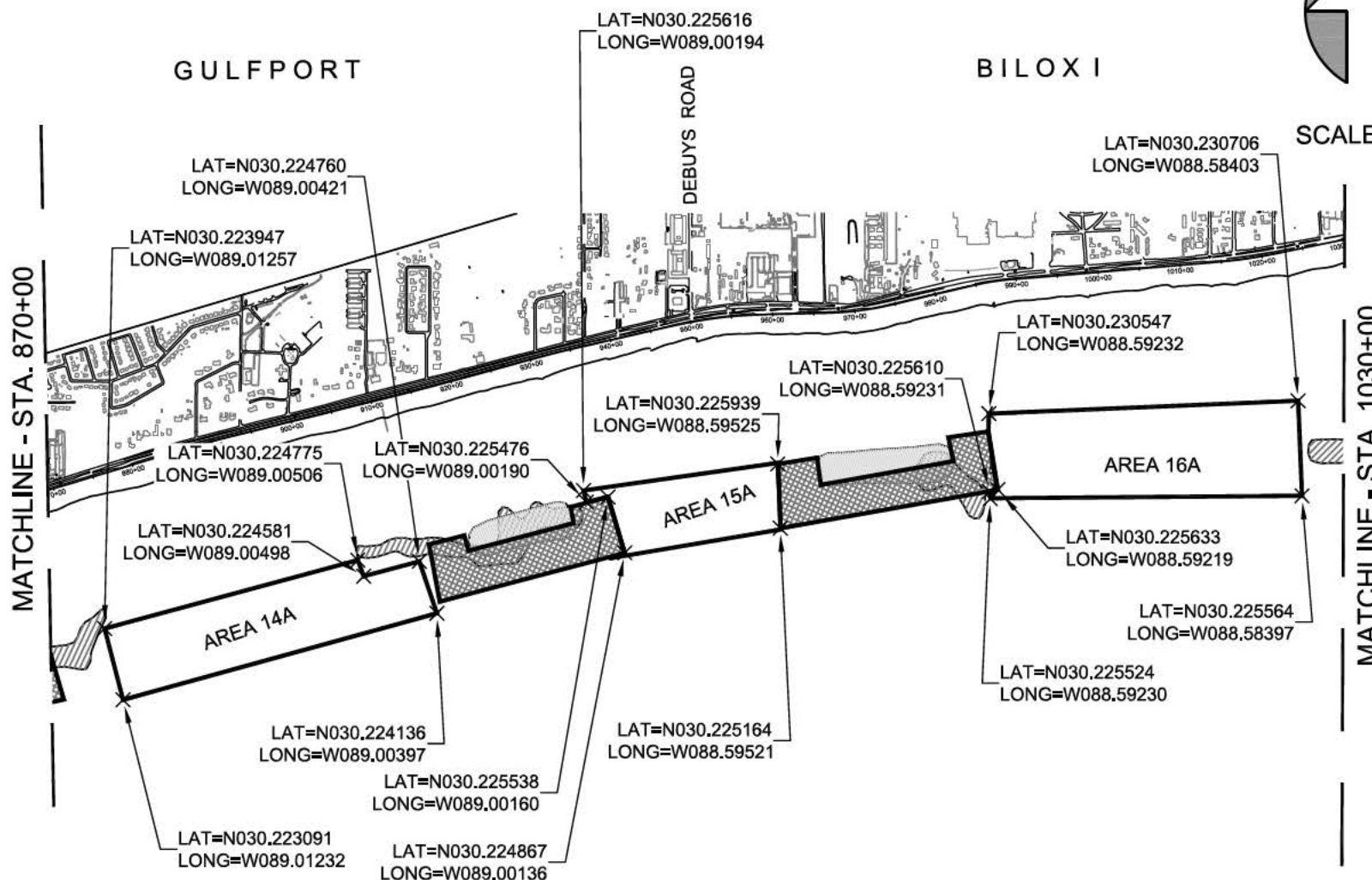

12/2/21  
\\1676\\1676-21\\1676-21 BORROW AREAS FOR PERMIT

**bma** BROWN, MITCHELL  
& ALEXANDER, INC.  
CONSULTING ENGINEERS

# SAND BEACH RENOURISHMENT

## HARRISON COUNTY SAND BEACH DEPARTMENT

### BORROW AREAS

HARRISON COUNTY, MISSISSIPPI

SHEET 27 OF 31



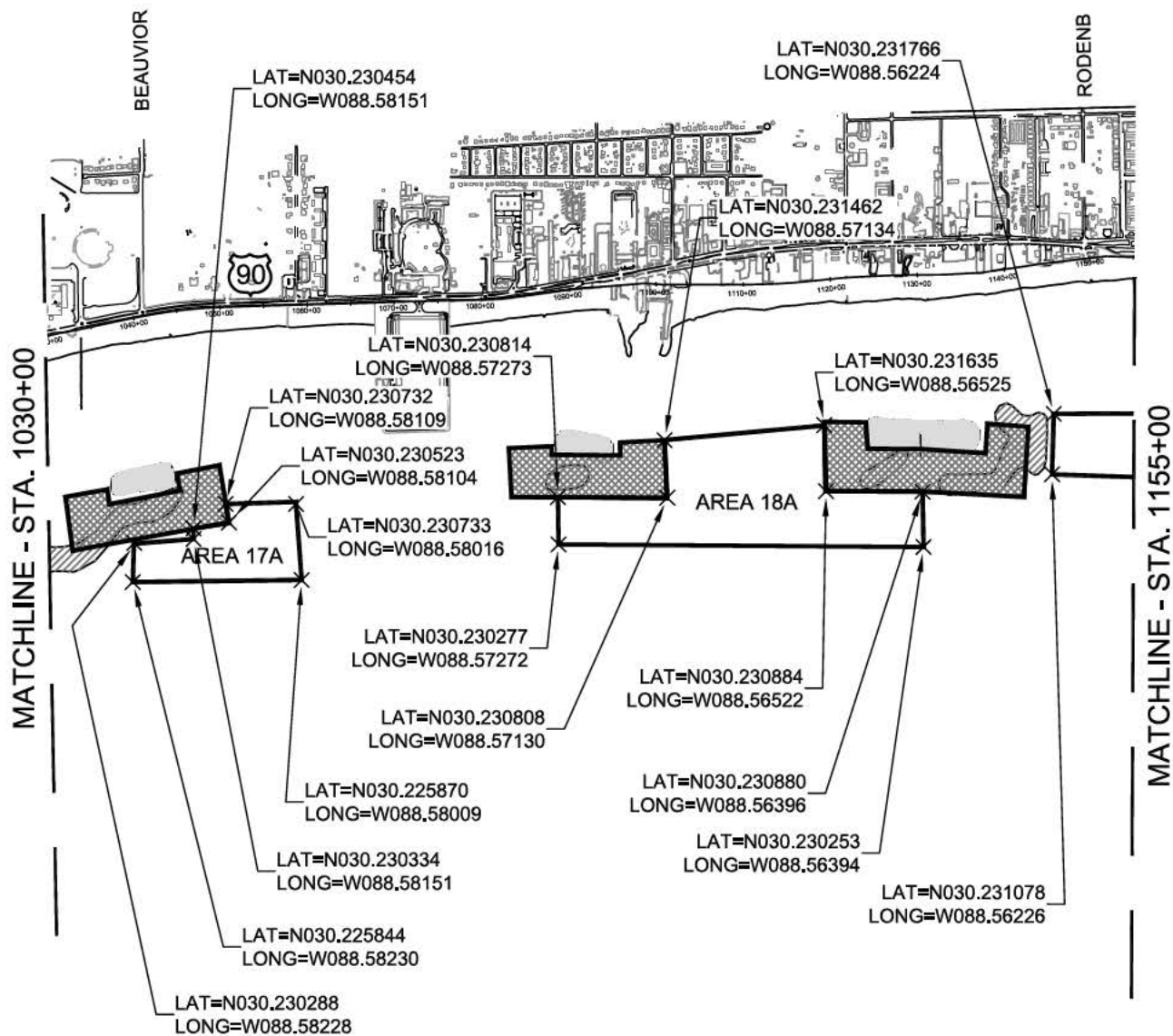

SCALE: 1" = 2000'

# SAND BEACH RENOURISHMENT HARRISON COUNTY SAND BEACH DEPARTMENT BORROW AREAS

HARRISON COUNTY, MISSISSIPPI

SHEET 28 OF 31

12/2/21  
\\1676\1676-21\1676-21 BORROW AREAS FOR PERMIT

**bma** BROWN, MITCHELL  
& ALEXANDER, INC.  
CONSULTING ENGINEERS



SCALE: 1" = 2000'

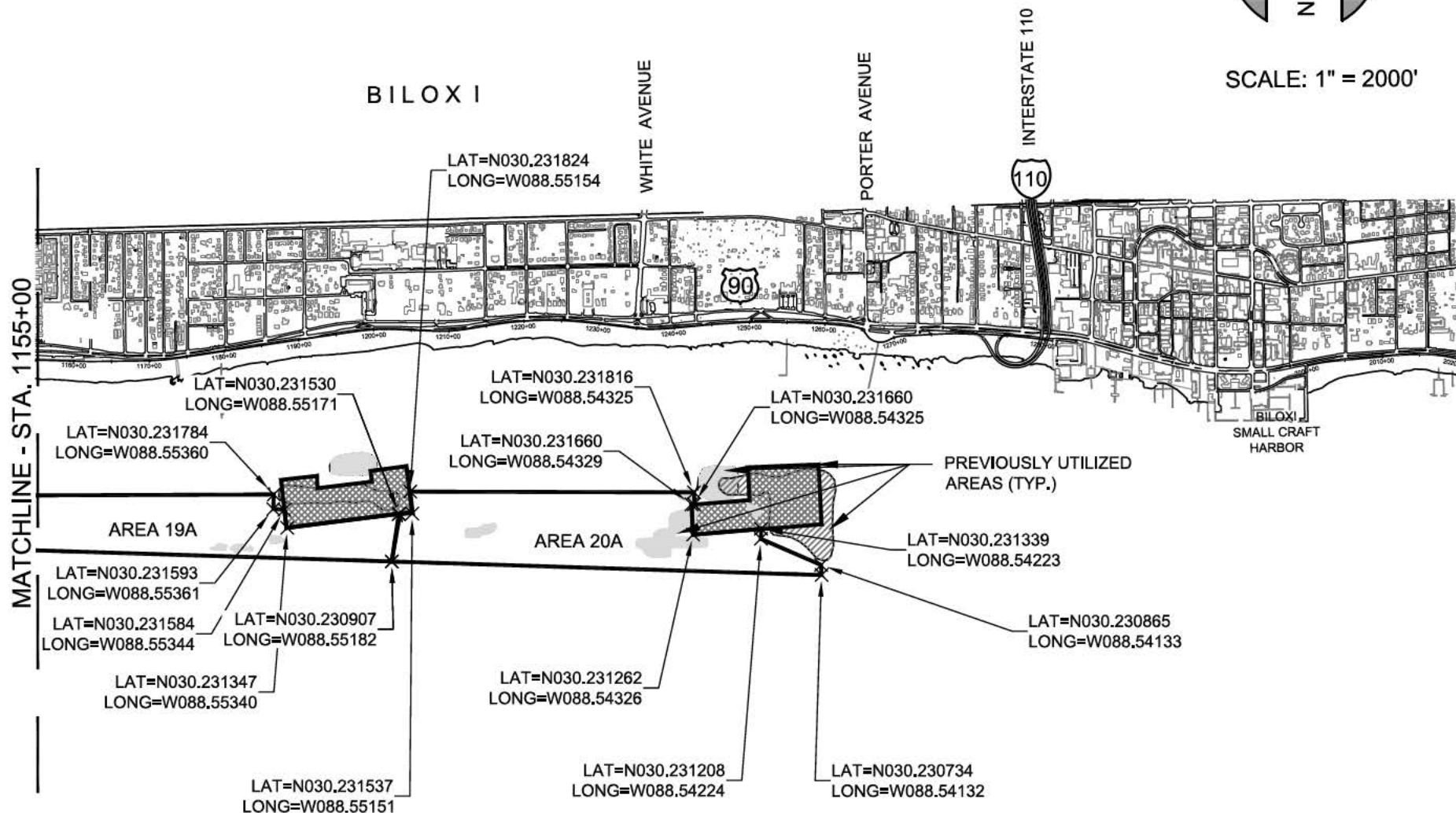



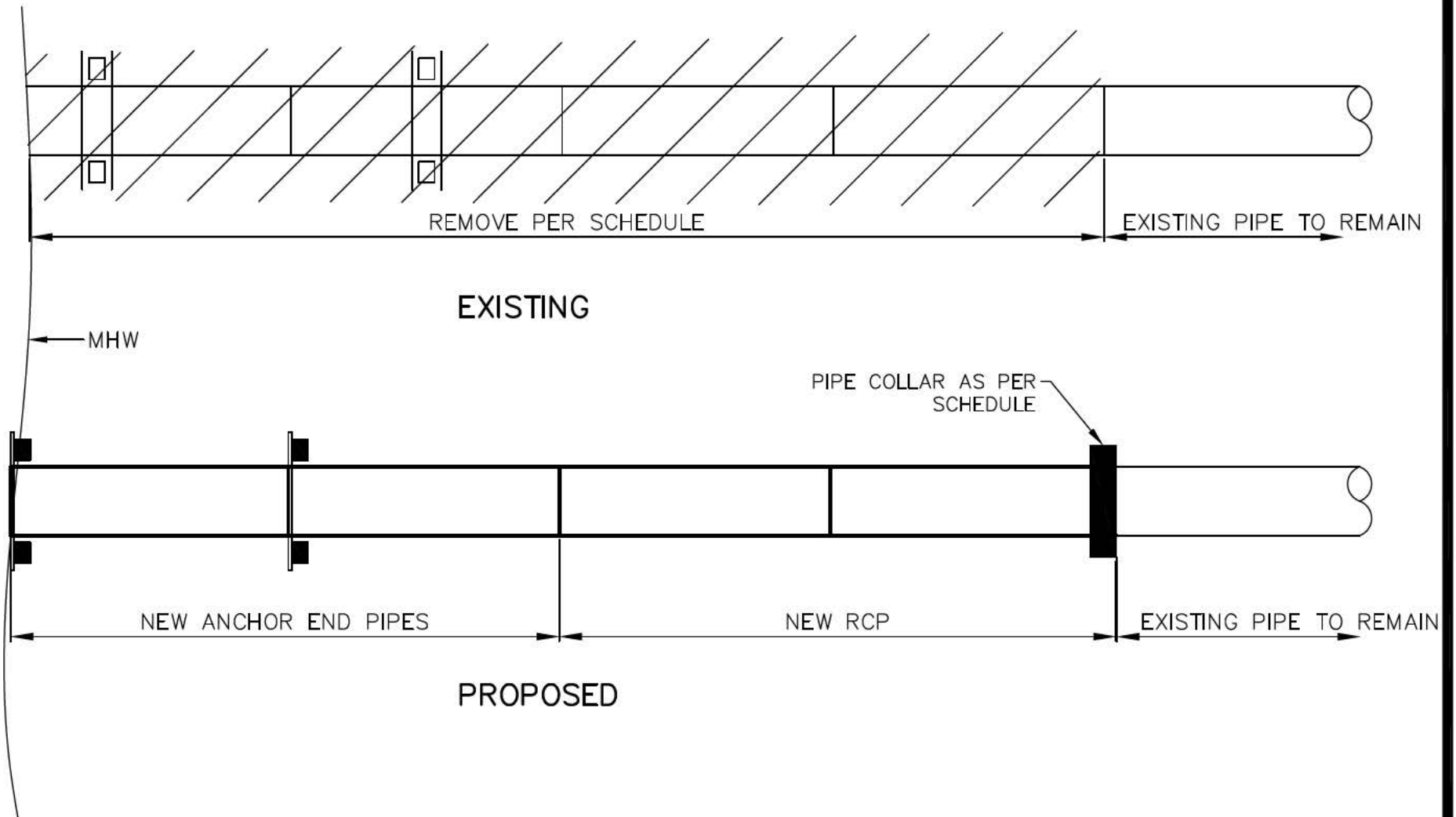

12/01/21  
\\1676\1676-21\1676-21 PERMIT DETAILS

**bma** BROWN, MITCHELL  
& ALEXANDER, INC.  
CONSULTING ENGINEERS

## SAND BEACH RENOURISHMENT HARRISON COUNTY SAND BEACH DEPARTMENT CONSTRUCTION DETAILS

HARRISON COUNTY, MISSISSIPPI

SHEET 30 OF 31

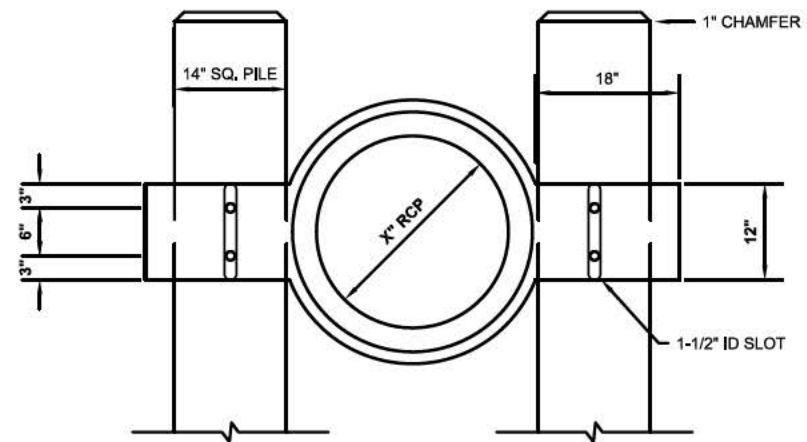
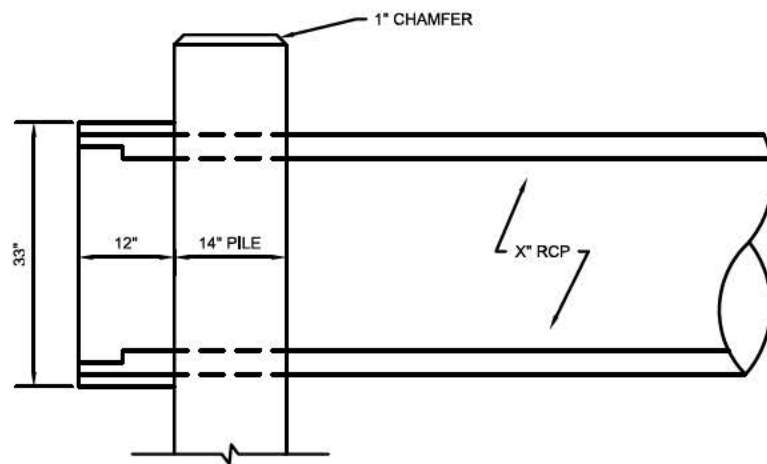
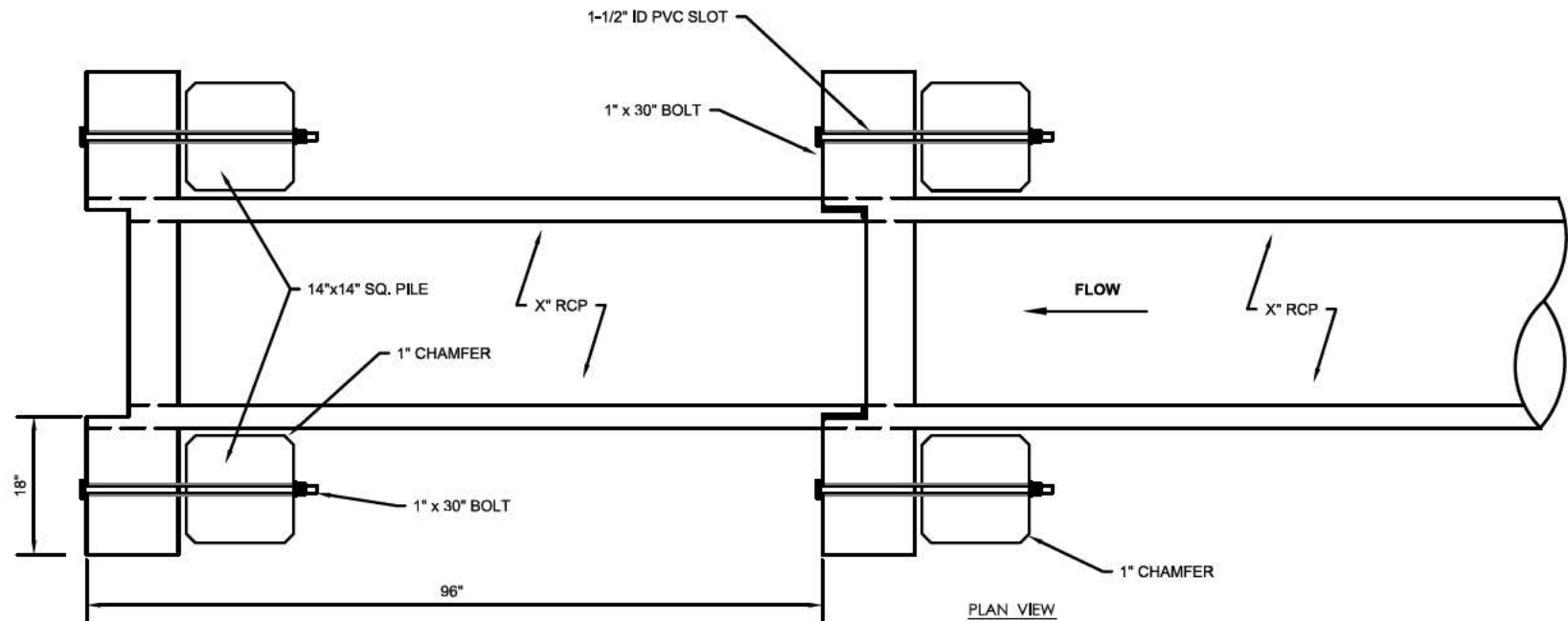

# SAND BEACH RENOURISHMENT HARRISON COUNTY SAND BEACH DEPARTMENT CONSTRUCTION DETAILS

HARRISON COUNTY, MISSISSIPPI

SHEET 31 OF 31

12/01/21  
\\1676\\1676-21\\1676-21 PERMIT DETAILS

**bma** BROWN, MITCHELL  
& ALEXANDER, INC.  
CONSULTING ENGINEERS

CONCRETE PIPE ANCHOR