



**DEPARTMENT OF THE ARMY**  
U.S. ARMY CORPS OF ENGINEERS, MOBILE DISTRICT  
P.O. BOX 2288  
MOBILE, AL 36628-0001

**CESAM-RD-M**  
**PUBLIC NOTICE NO. SAM-2021-00823-MJF**

**January 24, 2023**

**JOINT PUBLIC NOTICE**  
**U.S. ARMY CORPS OF ENGINEERS**

**MISSISSIPPI DEPARTMENT OF ENVIRONMENTAL QUALITY**  
**OFFICE OF POLLUTION CONTROL (MDEQ)**

**MISSISSIPPI DEPARTMENT OF MARINE RESOURCES**  
**DMR21-000423**

**MARINA MAINTENANCE DREDGING AND BEACH RENOURISHMENT, MISSISSIPPI**  
**SOUND, HANCOCK COUNTY, MISSISSIPPI**

TO WHOM IT MAY CONCERN:

This District has received an application for a Department of the Army (DA) permit pursuant to Section 10 of the Rivers and Harbors Act of 1899 and Section 404 of the Clean Water Act (33 USC 1344). Please communicate this information to interested parties.

**APPLICANT: City of Bay St. Louis**  
**688 Highway 90**  
**Bay St. Louis, Mississippi 39520**  
**mfavre@baystlouis-ms.gov**

**WATERWAY AND LOCATION: Within the existing Bay St. Louis Municipal Harbor and Beach Area to the South North of the Railroad Bridge, Section 29, Township 8 South, Range 13 West, Latitude 30.310562° North, Longitude -89.322863° West, Mississippi Sound, Hancock County, Mississippi.**

**PROPOSED WORK:** The applicant proposes to perform maintenance dredging of the existing Bay St. Louis Municipal Harbor. Dredging is required due to sediment deposits from Hurricane Zeta in 2020. Approximately 3,037 cubic yards of sediment would be removed by hydraulic dredging. The harbor would be dredged to an overall depth of -8 feet MLW. Dredged material disposal would be utilized to renourish the beach area near the south side of the harbor if the material is found to be suitable and approval from Hancock County is obtained. Alternative disposal location would include an approved Beneficial Use site.

The applicant has applied for coastal zone (CZ) consistency in accordance with the State Coastal Zone Management Program. The Mississippi Department of Marine Resources issued a Certificate of Waiver by letter dated August 20, 2021. (DMR21-000423).

The Clean Water Act (CWA) Section 401 Certification Rule (Certification Rule, 40 CFR 121), requires certification for any license or permit that authorizes an activity that may result in a discharge. The applicant is responsible for requesting certification and providing required information to the certifying agency. As of the date of this public notice, the applicant has not submitted a certification request to the Mississippi Department of Environmental Quality (certifying authority).

This public notice is being distributed to all known interested persons in order to assist in developing facts on which a decision by the U.S. Army Corps of Engineers (USACE) can be based. For accuracy and completeness of the record, all data in support of or in opposition to the proposed work should be submitted in writing setting forth sufficient detail to furnish a clear understanding of the reasons for support or opposition.

The decision whether to issue a permit will be based on an evaluation of the probable impact including cumulative impacts of the proposed activity on the public interest. That decision will reflect the national concern for both protection and utilization of important resources. The benefit which reasonably may be expected to accrue from the proposal must be balanced against its reasonably foreseeable detriments. All factors which may be relevant to the proposal will be considered including the cumulative effects thereof; among those are conservation, economics, aesthetics, general environmental concerns, wetlands, historic properties, fish and wildlife values, flood hazards, floodplain values, land use, navigation, shoreline erosion and accretion, recreation, water supply and conservation, water quality, energy needs, safety, food and fiber production, mineral needs, consideration of property ownership and, in general, the needs and welfare of the people.

The USACE is soliciting comments from the public; Federal, State, and local agencies and officials; Indian Tribes; and other interested parties in order to consider and evaluate the impacts of this proposed activity. Any comments received will be considered by the USACE to determine whether to issue, modify, condition or deny a permit for this proposal. To make this decision, comments are used to assess impacts on endangered species, historic properties, water quality, general environmental effects, and the other public interest factors listed above. Comments are used in the preparation of an Environmental Assessment and/or an Environmental Impact Statement pursuant to the National Environmental Policy Act. Comments are also used to determine the need for a public hearing and to determine the overall public interest of the proposed activity.

Any person may request, in writing, within the comment period specified in this notice, that a public hearing be held to consider this application. Requests for public hearings shall state with particularity, the reasons for holding a public hearing.

Evaluation of the probable impacts involving deposits of dredged or fill material into waters of the United States will include the application of guidelines established by the Administrator of the U.S. Environmental Protection Agency.

In accordance with Section 106 of the National Historic Preservation Act, and Appendix C of 33 CFR 325, the undertaking defined in this notice is being considered for the potential to affect historic properties. In accordance with Appendix C of 33 CFR 325, the Corps has determined the permit area consists of the footprint of the existing marina and the area of the beach to be renourished. The National Register of Historic Places has been consulted and no properties listed in or eligible for the National Register are known to exist which would be affected by the proposed work. The Federal Emergency Management Agency (FEMA) is the lead federal agency for this project. As such, FEMA will be responsible for coordination under Section 106 of the National Historic Preservation Act.

Preliminary review of this application and the U.S. Department of the Interior's List of Endangered and Threatened Wildlife and Plants indicated the following species may be present onsite: The Gulf Sturgeon (*Acipenser*) listed as threatened with critical habitat (TCH), the Green sea turtle (*Chelonia*) (T), the Kemp's Ridley turtle (*Lepidochelys kempii*) (E), the Loggerhead sea turtle (*Caretta caretta*) (T), the Piping Plover (*Charadrius melodus*) (TCH), the Eastern Black Rail (*jamaicensis jamaicensis*) (T), the Red Knot (*Calidris canutus rufa*), (T), and the West India Manatee (*Trichechus manatus*) (E). FEMA is the lead federal agency for this project. As such, FEMA will be responsible for coordination with the National Marine Fisheries Service (NMFS) and the United States Fish and Wildlife Service (USFWS) under Section 7 of the Endangered Species Act.

Correspondence concerning this Public Notice should refer to Public Notice Number SAM-2021-00823-MJF and should be directed to the District Engineer, U.S. Army Engineer District, Mobile, Post Office Box 2288, Mobile, Alabama 36628-0001, Attention: South Mississippi Branch, [maryellen.j.farmer@usace.army.mil](mailto:maryellen.j.farmer@usace.army.mil), with a copy to the Mississippi Department of Environmental Quality, Office of Pollution Control, Post Office Box 2261, Jackson, Mississippi 39225, [Cbarefoot@mdeq.ms.gov](mailto:Cbarefoot@mdeq.ms.gov), and the Mississippi Department of Marine Resources, 1141 Bayview Avenue, Biloxi, Mississippi 39530, [willa.brantley@dmr.ms.gov](mailto:willa.brantley@dmr.ms.gov), in time to be received within **30 days** of the date of this public notice.

If you have any questions concerning this publication, you may contact the project manager for this application, **Maryellen J. Farmer** ([maryellen.j.farmer@usace.army.mil](mailto:maryellen.j.farmer@usace.army.mil)), at (228) 523-4116. Please refer to the above Public Notice number.

For additional information about our Regulatory Program, please visit our website at: [www.sam.usace.army.mil](http://www.sam.usace.army.mil) and please take a moment to complete our customer satisfaction survey while you're there. Your responses are appreciated and will allow us to improve our services.

MOBILE DISTRICT  
U.S. Army Corps of Engineers

Enclosures



✓ -89.2526, 30.3009 ▲

# BSL Municipal Harbor

Dredging Site

Legend

State St  
N Beach Blvd  
Jody Compretta Dr

Google Earth

© 2021 Google



800 ft

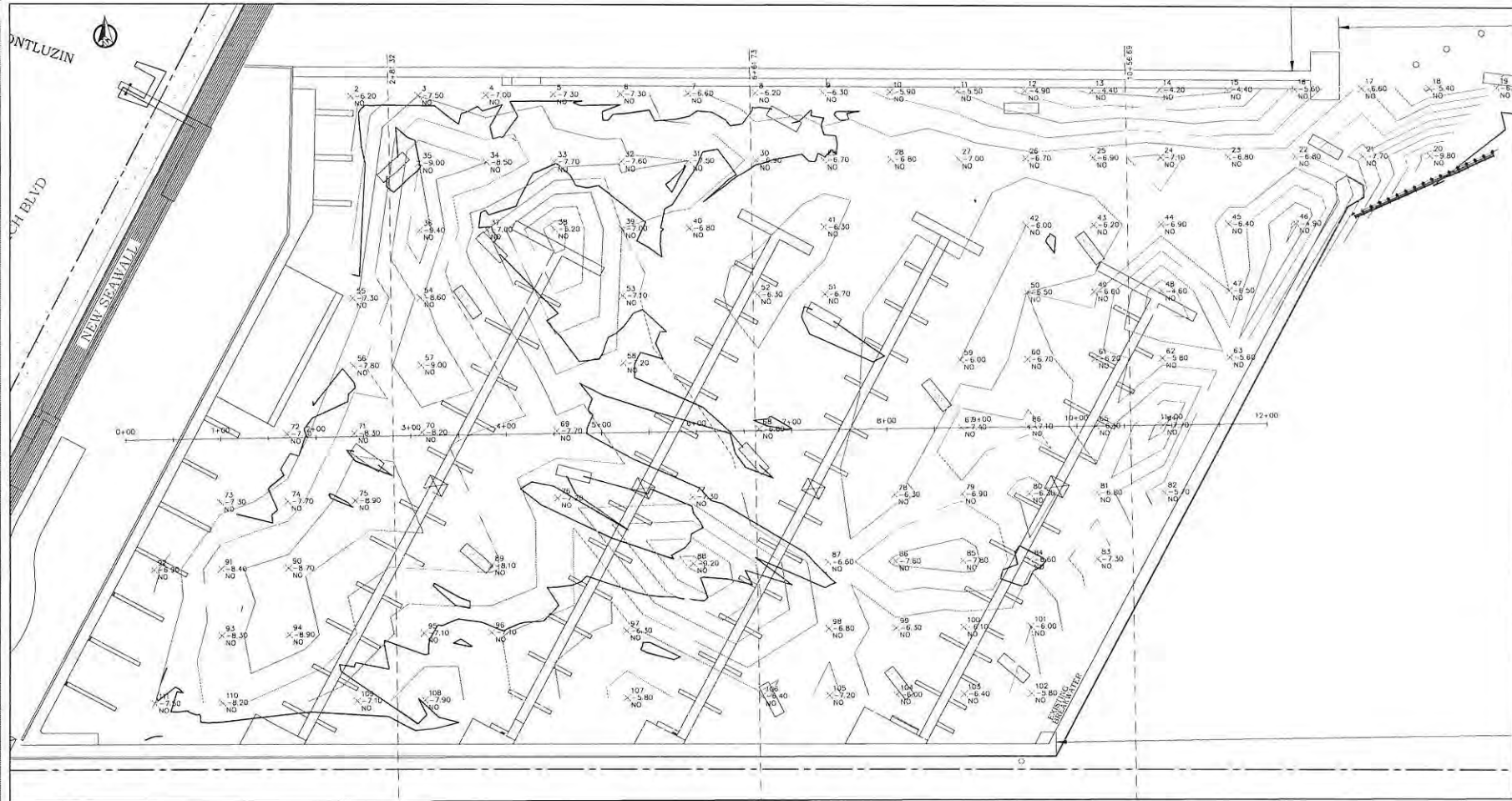

**NOTES**  
 PRE STORM HARBOR SCAN COMPLETED ON JUNE 2020 @ 10:30AM-12:00PM.  
 CONTOURS BASED ON NAVD88.  
 AVERAGE TIDE ELEVATION AT TIME OF SURVEY : +0.49' NAVD88  
 ELEVATIONS AND CONTOURS ARE BASED ON \_\_\_\_\_ DATUM  
 POST STORM HARBOR SCAN NOVEMBER 5, 2020

**SITE HYDROGRAPHY**  
 SCALE: 1"=50'

  
 412 Hwy. 90, Suite 1  
 Bay St. Louis, MS, 39520  
 Phone: (501) 251-0220  
 Email: info@jdc-engineers.com  
 Website: www.jdc-engineers.com

OWNER INFORMATION  
 THE CITY OF BAY SAINT LOUIS, MS  
 MUNICIPAL HARBOR

SHEET TITLE  
 HURRICAN ZETA  
 HYDROGRAPHY

DATE	DESCRIPTION

PROJECT NO.	21-001
DATE	03/04/2021
DRAWN BY	JDC
CHECKED BY	JDC
SCALE	1"=50'

SHEET COUNT

1

SHEET NUMBER

1



412 Hwy. 90, Suite 4  
 Bay St. Louis, MS, 39520  
 Phone: (601) 864-5176  
 Email: jchrichte@jcc.com  
 Website: www.jcc.com

OWNER INFORMATION

THE CITY OF BAY SAINT LOUIS, MS  
 MUNICIPAL HARBOR

SHEET TITLE

HURRICANE ZETA  
 SECTIONS HYDROGRAPHY

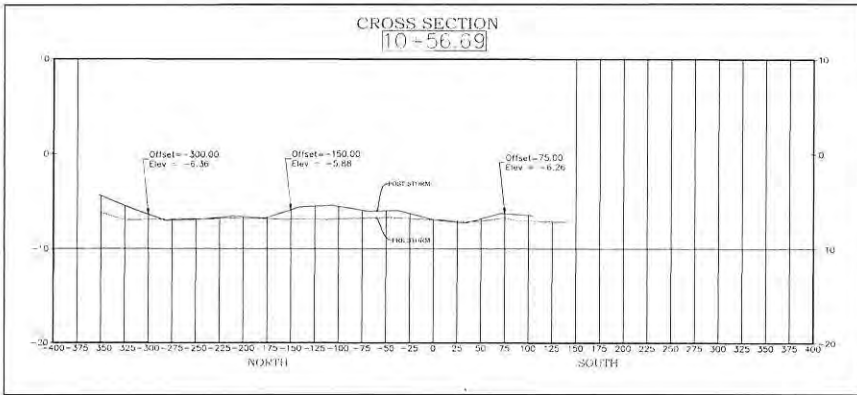
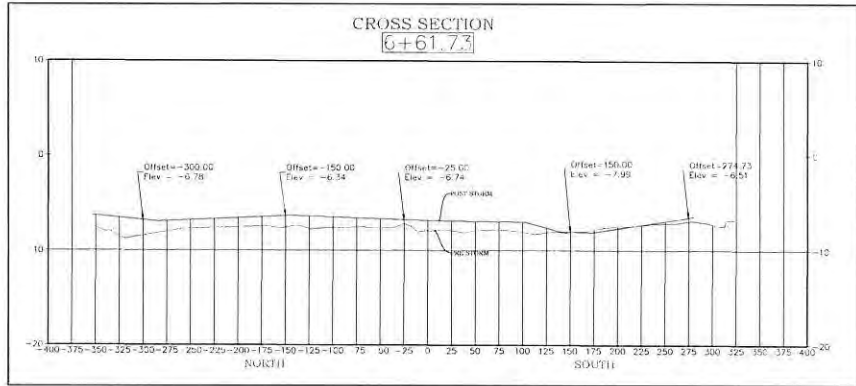
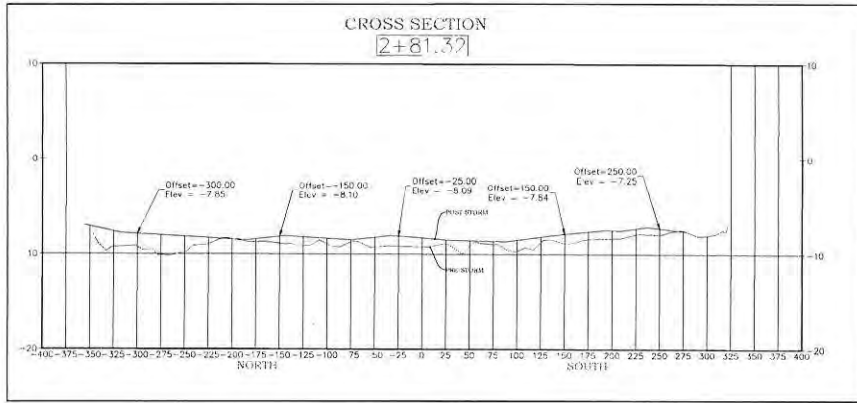

SECTIONS HYDROGRAPHY  
 SCALE: 1"=60'

DATE: 08/16/2010

PROJECT: 10

DATE: 03/04/2011

DRAWN BY: JCC

CHECKED BY: JCC

SCALE: 1"=60'

SHEET COUNT

2

SHEET NUMBER

2



Disposal Location



Bay Town Inn  
 State St  
 200 North Beach Restaurant and Bar  
 The Blind Tiger Bay St. Louis  
 Serious Bread Bakery  
 Pearl  
 Field's Steak and Oyster Bar  
 Twisted Hiki Tours  
 Sally Soul Outfitters  
 Murky Waters BBQ Bay St. Louis  
 Cuz's Old Town Oyster Bar & Grill  
 Carrot Head Bar & Grill  
 S Beach Blvd  
 Joay Competa Dr  
 Court St  
 Tripletails  
 Bucoys Bar  
 Daiquiri Shak

First Baptist Church of Bay St. Louis

Bay Saint



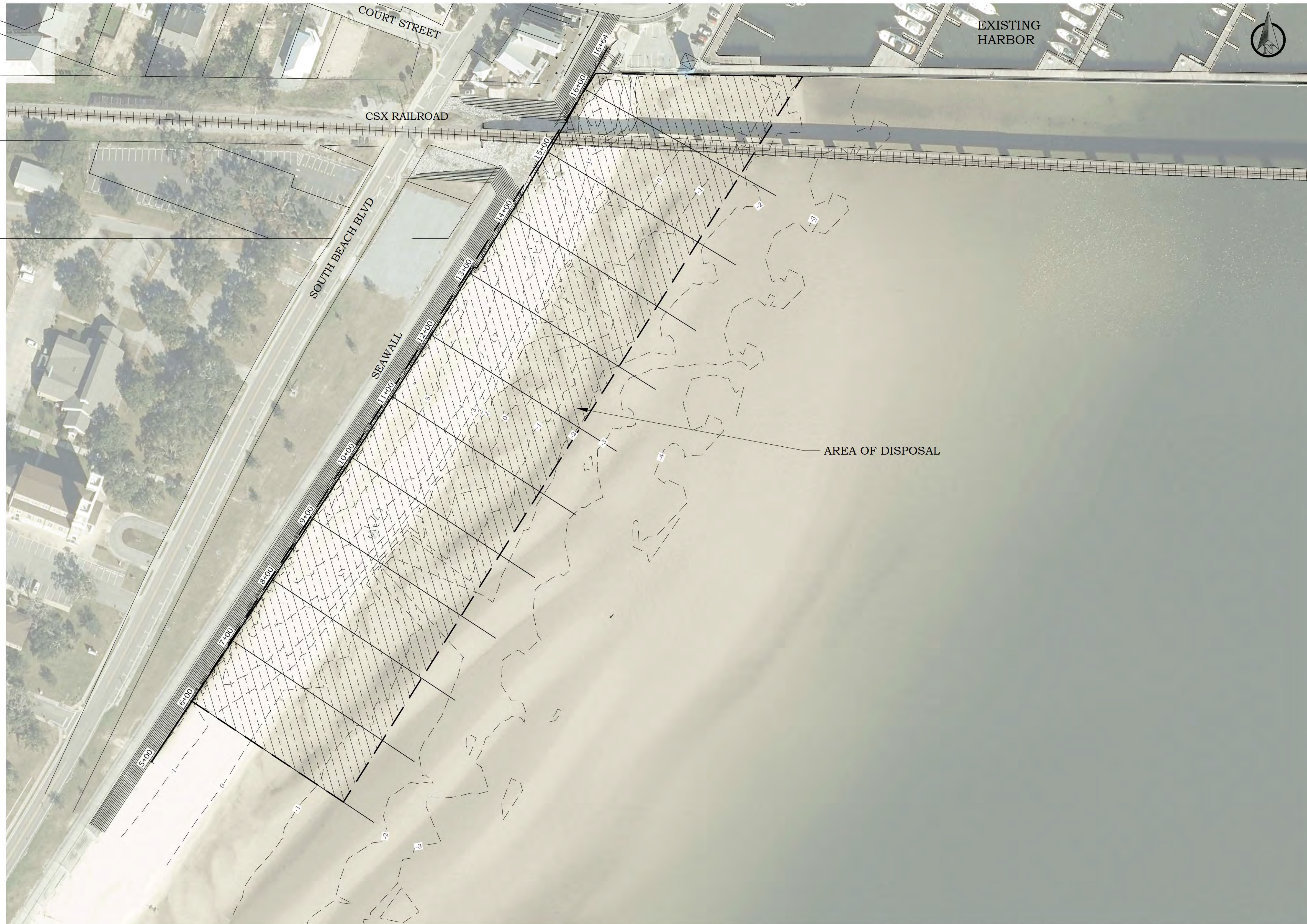

**CHINICHE**  
ENGINEERING & SURVEYING  
ESTABLISHED 1971

407 Hwy. 90  
Bay St. Louis, MS, 39520

Office - (228) 467-6755  
Email - jason@jic-eng.com  
Website - www.jic-eng.com

**OWNER INFORMATION**

CITY OF BAY SAINT LOUIS  
688 HIGHWAY 90  
BAY ST. LOUIS, MS 39520

**SHEET TITLE**

BAY ST. LOUIS MUNICIPAL HARBOR  
HURRICANE ZETA DREDGING FEMA 4576 PW-298  
SITE PLAN

**PRELIMINARY FOR REVIEW!**

MARK	DATE	DESCRIPTION
ISSUE		
PROJECT NO	21-001 PH 3	
DATE	12/1/22	
DRAWN BY	HAB	
CHECKED BY	JPC	
SCALE	-	

**SHEET COUNT**

4

**SHEET NUMBER**

C-101

EXISTING UNDERGROUND UTILITY LINES ARE SHOWN ON THE DRAWINGS BASED UPON THE BEST INFORMATION AVAILABLE TO THE ENGINEER. THE ENGINEER CAN NOT AND DOES NOT WARRANT THAT THIS INFORMATION IS COMPLETE OR ACCURATE. THE CONTRACTOR MUST CALL IN MS811 UTILITY LOCATES AND PHYSICALLY LOCATE AND VISUALLY VERIFY LOCATIONS OF ALL UTILITIES.

© JAMES J. CHINICHE, 2016  
Z:\1\Engineering\2021\2021-001\Hurricane Zeta Repair\Harbor Repair\Phase 3 Dredging\01 Design\CAD\21-001 PH 3 HARBOR DREDGING.dwg, 12/1/2022 2:19:44 PM, DWG to PDF.plt



**CHINICHE**  
ENGINEERING & SURVEYING  
ESTABLISHED 1971

407 Hwy. 90  
Bay St. Louis, MS, 39520

Office - (228) 467-6755  
Email - jason@jc-eng.com  
Website - www.jc-eng.com

**OWNER INFORMATION**

CITY OF BAY SAINT LOUIS  
688 HIGHWAY 90  
BAY ST. LOUIS, MS 39520

**SHEET TITLE**

BAY ST. LOUIS MUNICIPAL HARBOR  
HURRICANE ZETA DREDGING FEMA 4576 PW-298  
STATION PROFILE & VOLUME REPORT

**PRELIMINARY FOR REVIEW!**

MARK	DATE	DESCRIPTION
ISSUE		
PROJECT NO	21-001 PH 3 BRIDGE	
DATE	12/1/22	
DRAWN BY	IWB	
CHECKED BY	JPC	
SCALE	20' / 2"	

**SHEET COUNT**  
5

**SHEET NUMBER**  
C-111

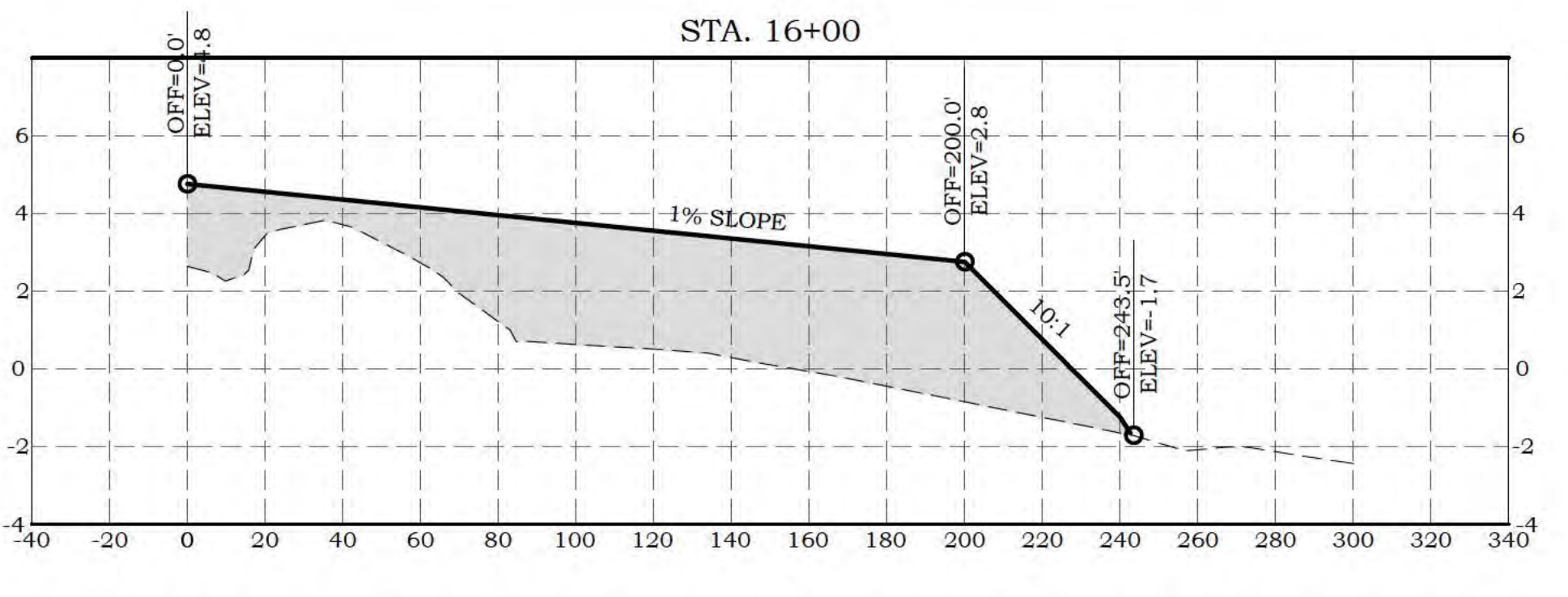
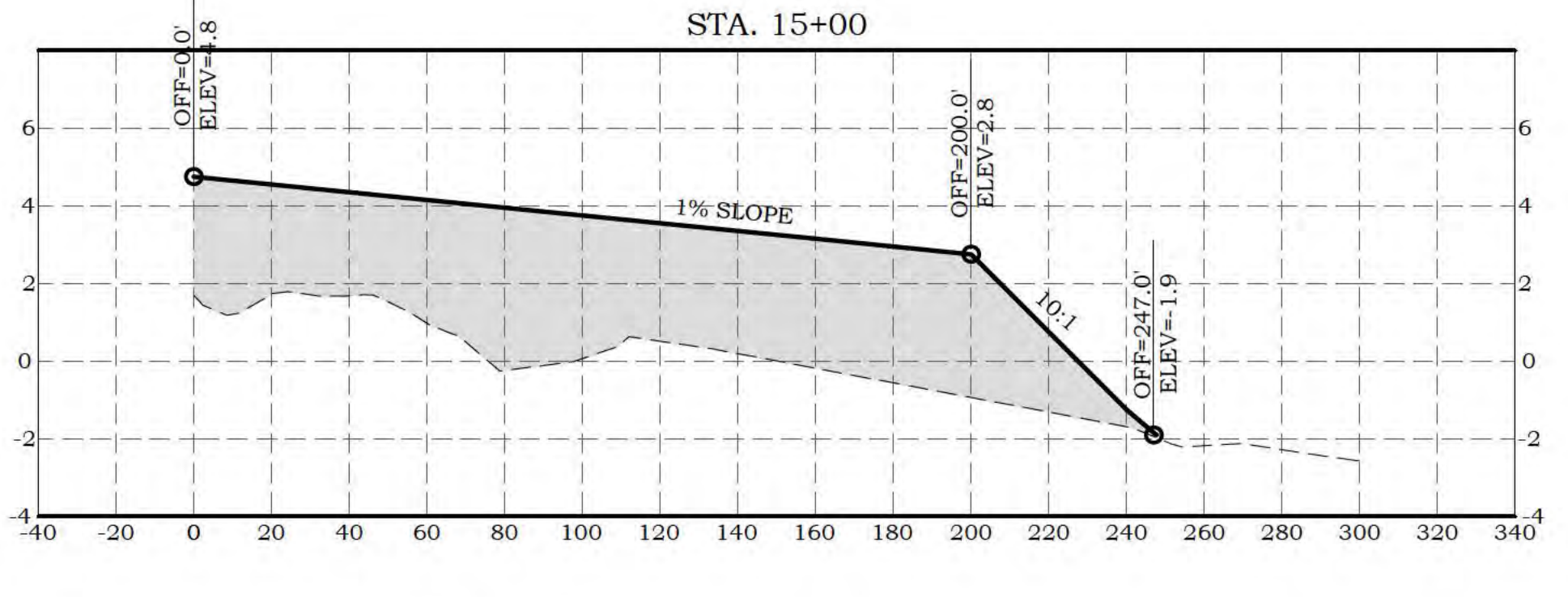
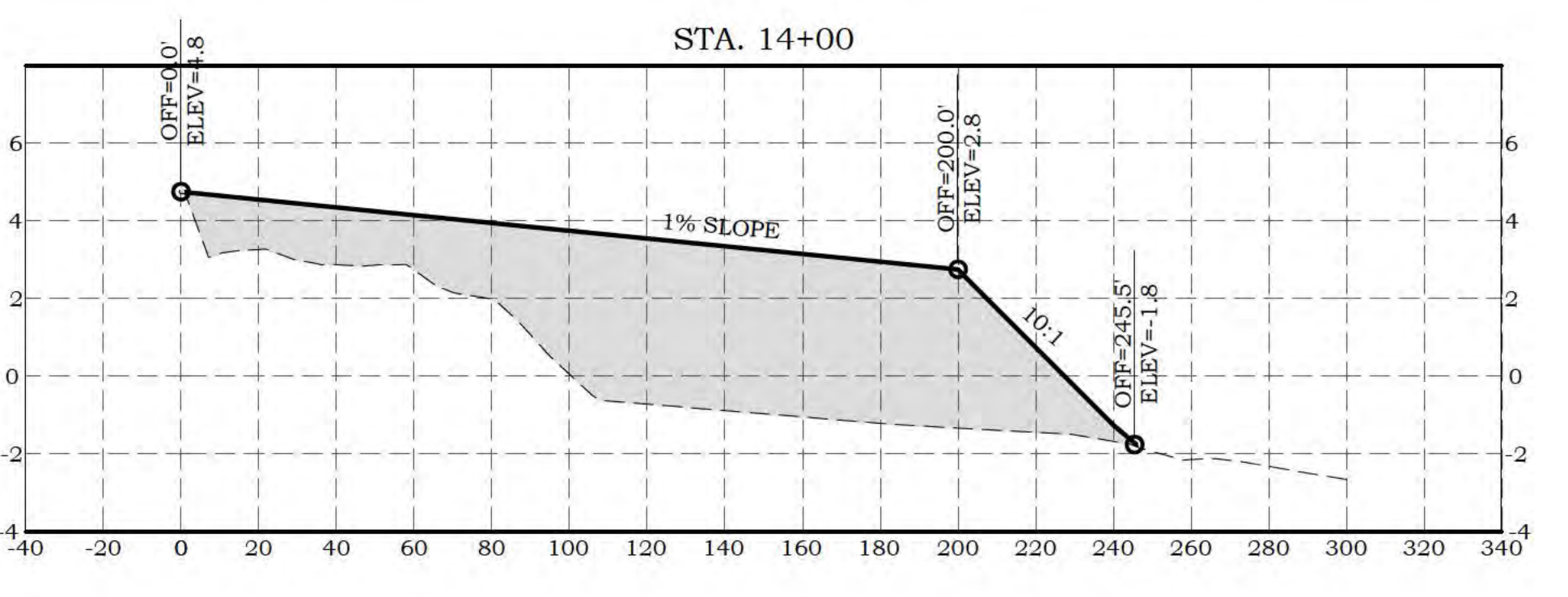
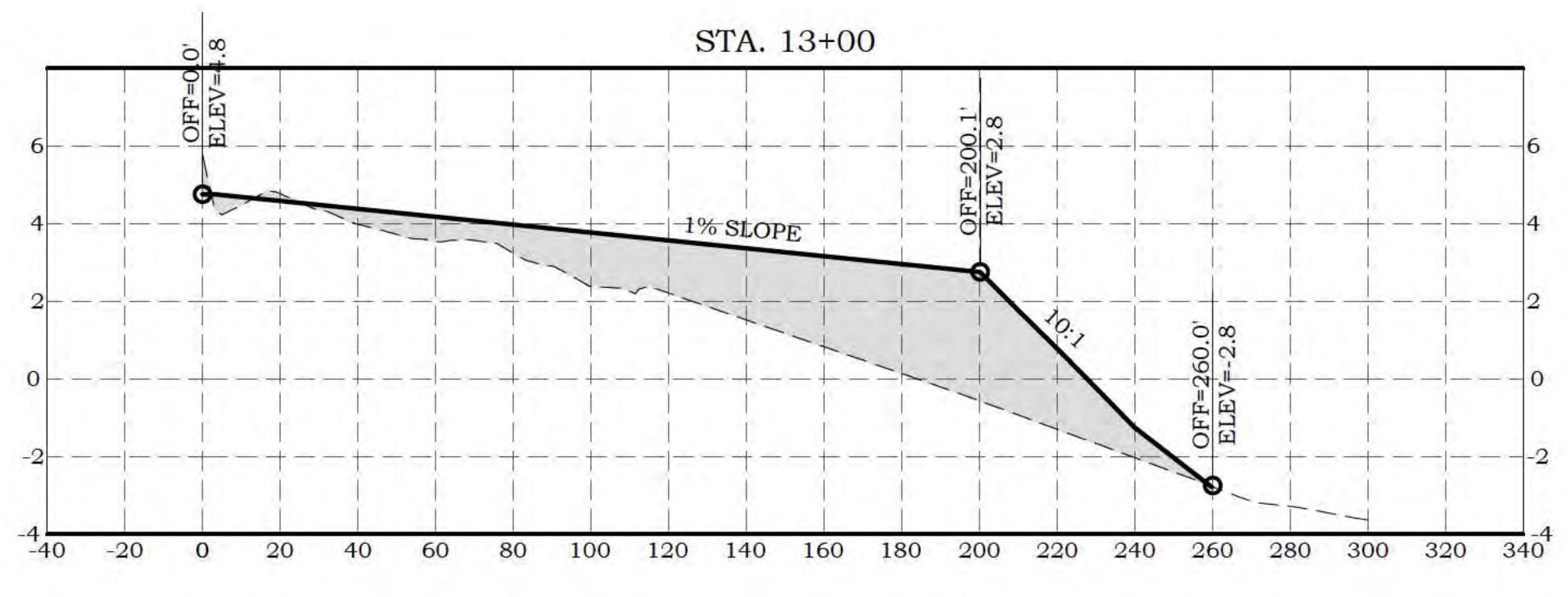
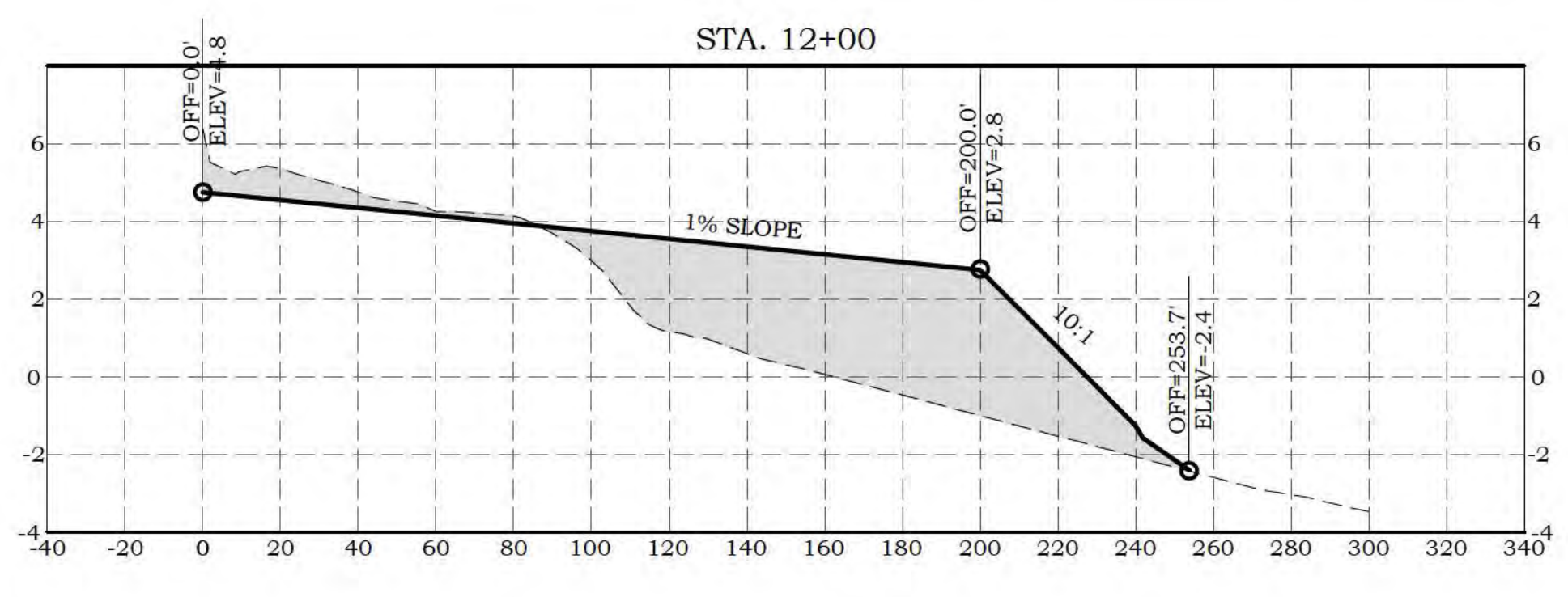
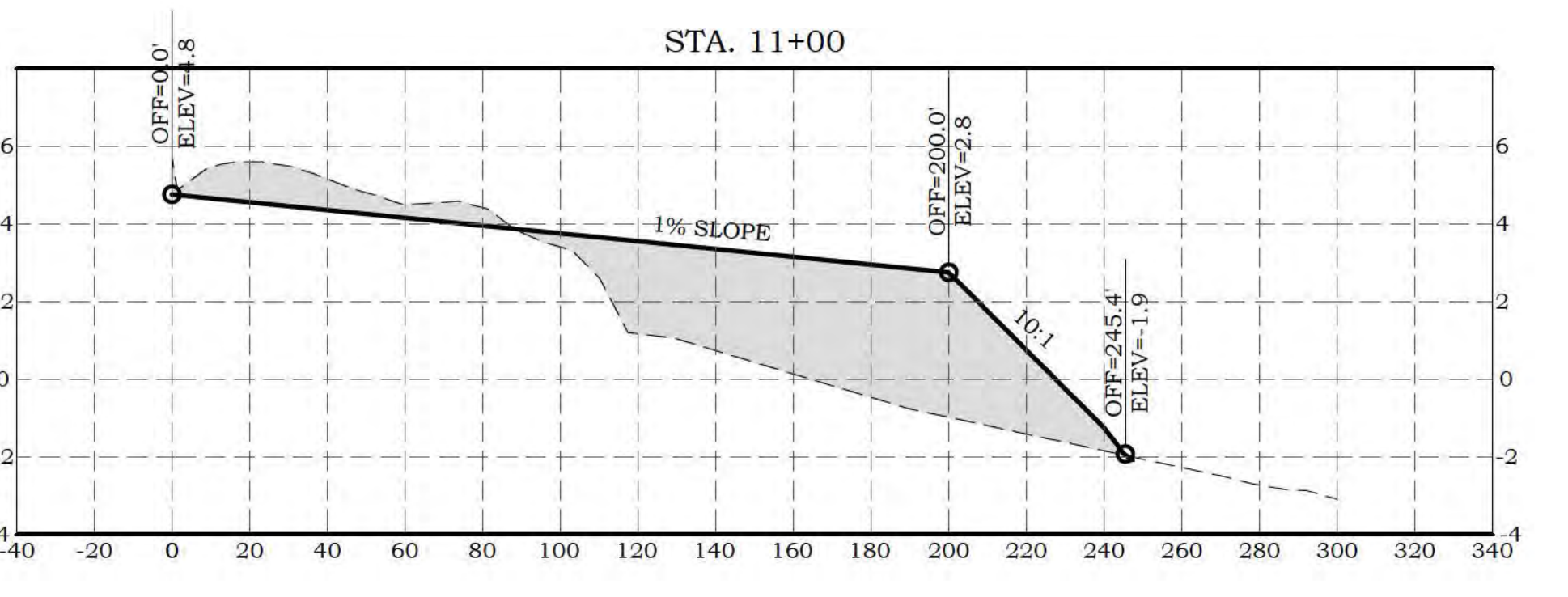
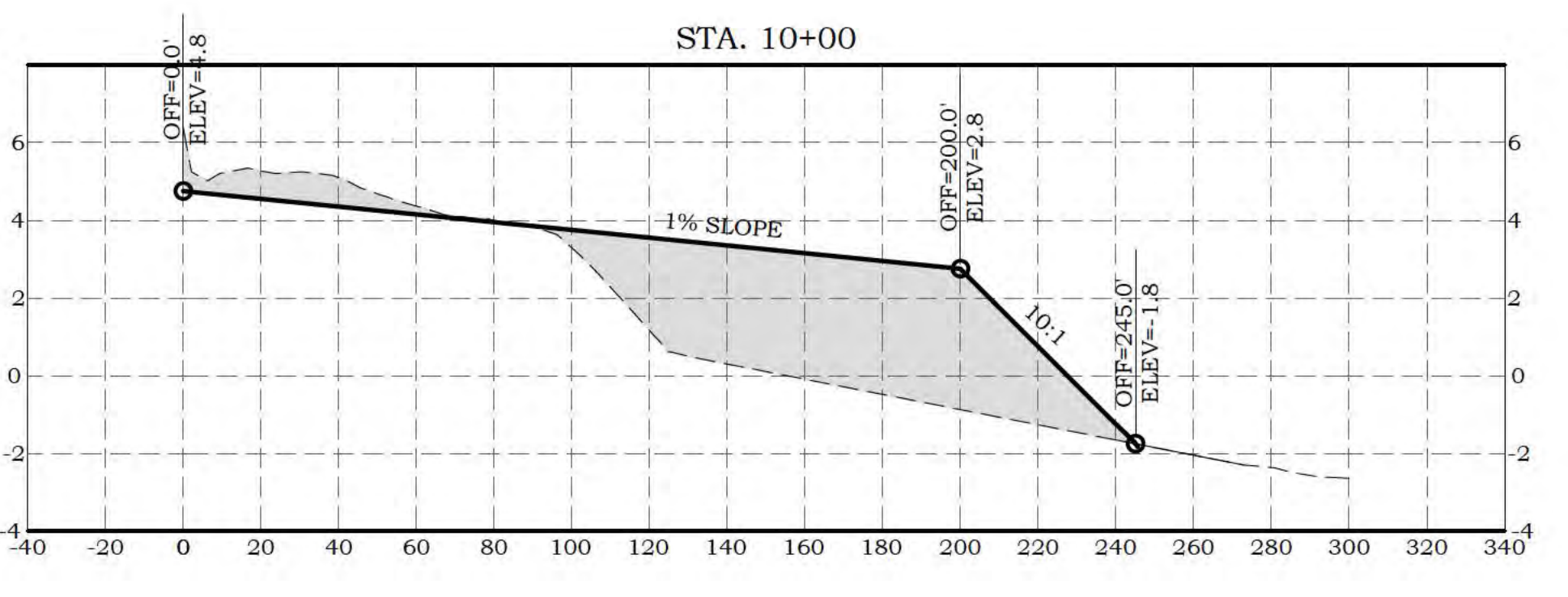
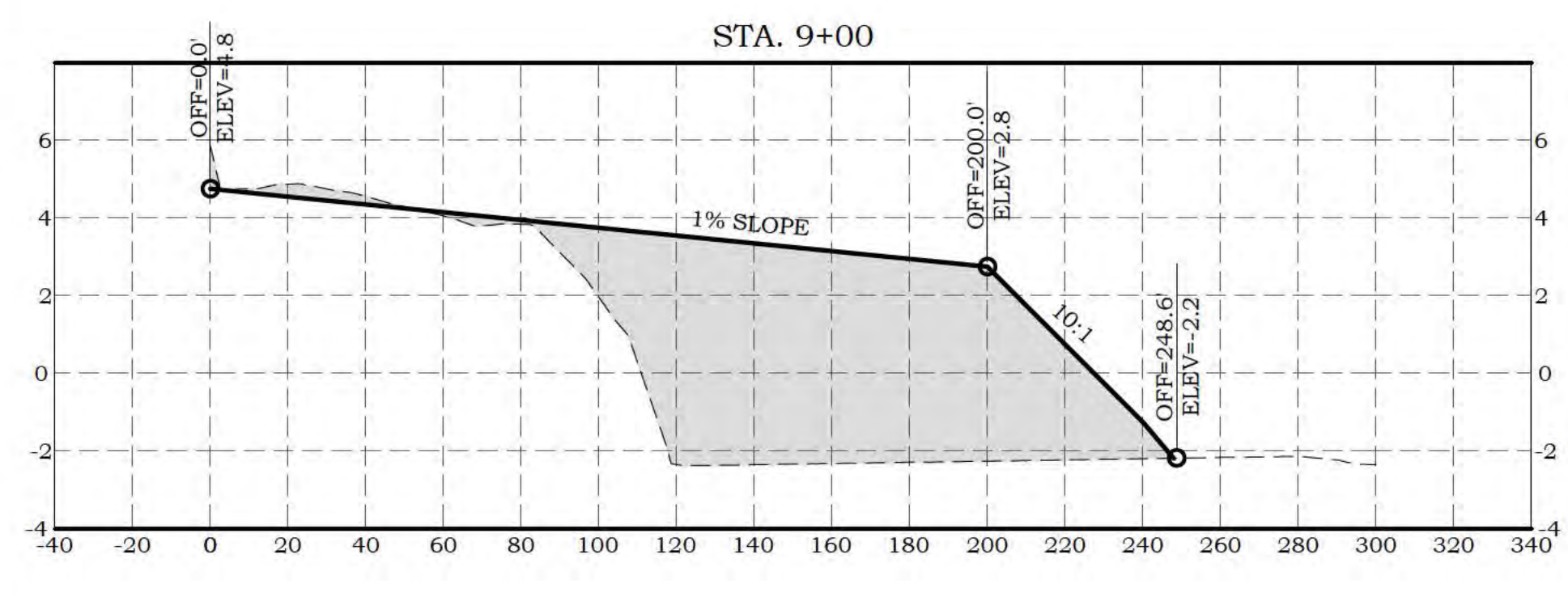
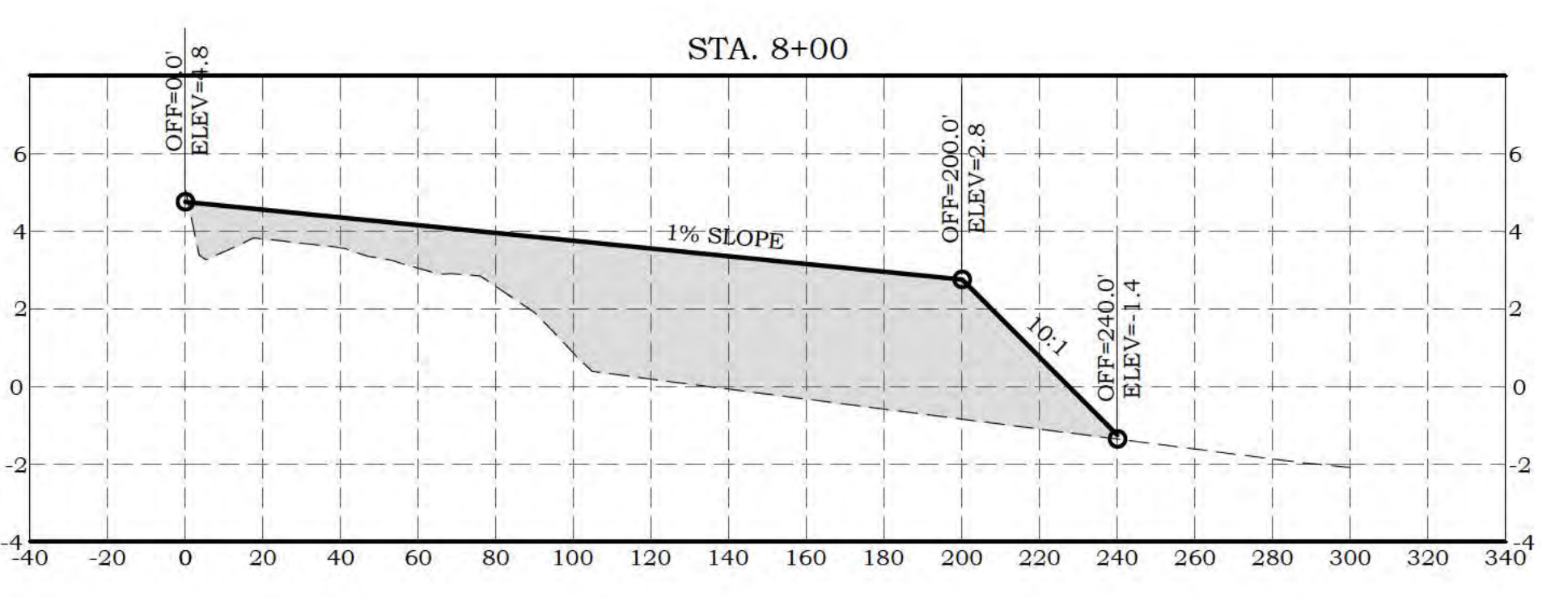
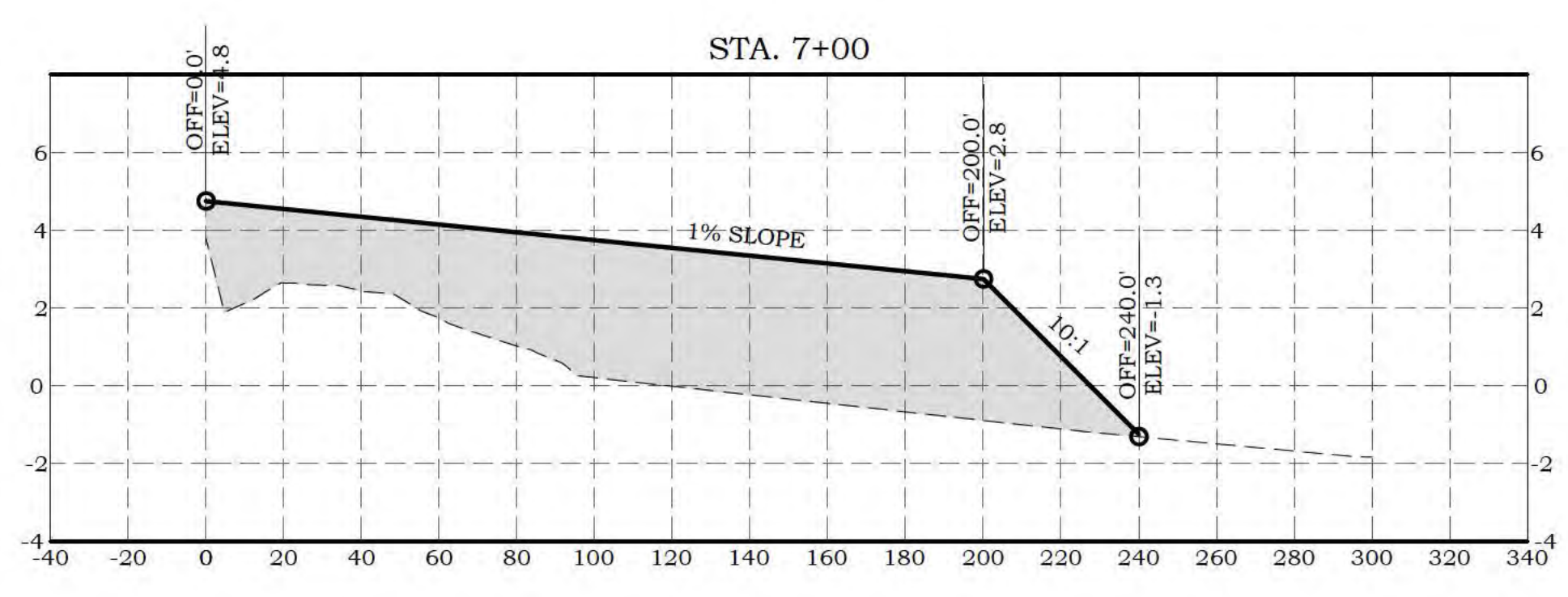
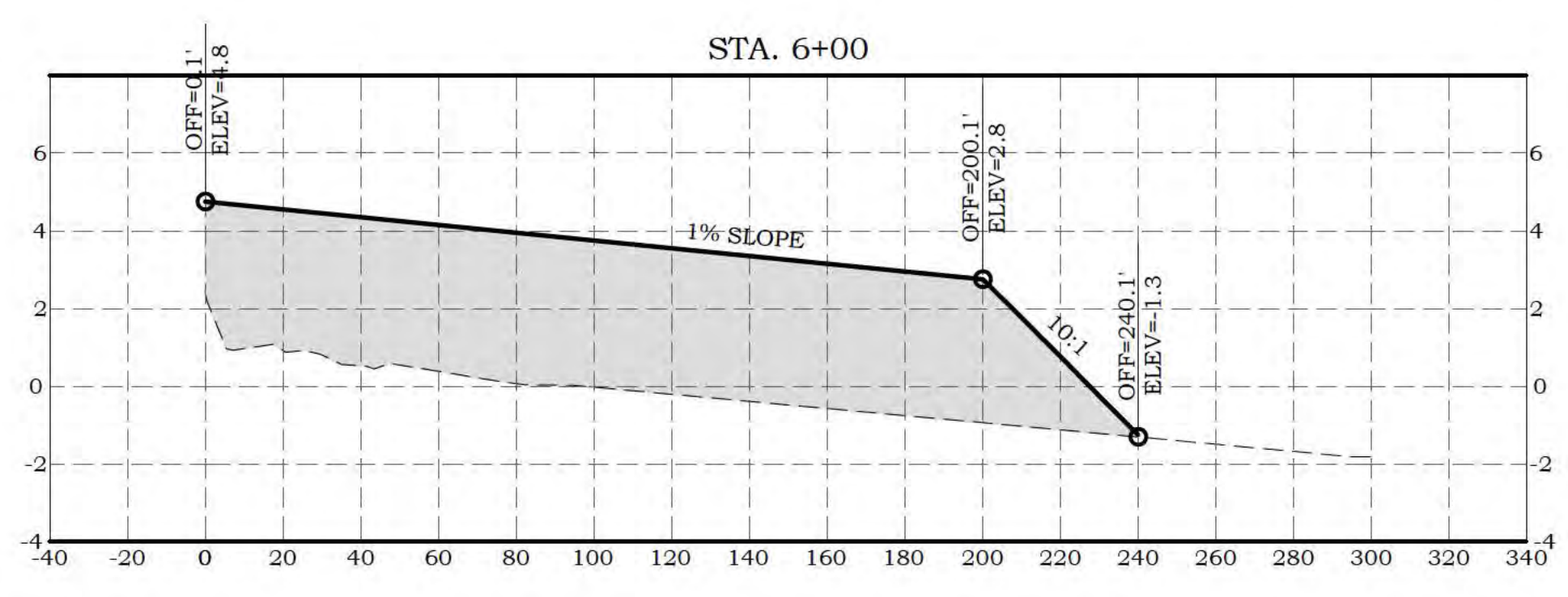

**TOTAL VOLUME TABLE**

Station	Cut Area (SF)	Fill Area (SF)	Cut Vol (CY)	Fill Vol (CY)	Cum Cut Vol (CY)	Cum Fill Vol (CY)	Net Vol (CY)
STA. 6+00	0.00	820.32	0.00	0.00	0.00	0.00	0.00
STA. 7+00	0.00	676.19	0.00	2771.31	0.00	2771.31	-2771.31
STA. 8+00	0.11	535.86	0.21	2244.54	0.21	5015.85	-5015.64
STA. 9+00	11.19	651.85	20.93	2199.46	21.13	7215.31	-7194.18
STA. 10+00	38.78	369.25	92.53	1890.92	113.66	9106.23	-8992.57
STA. 11+00	56.91	357.22	177.20	1345.30	290.86	10451.53	-10160.67
STA. 12+00	36.56	380.95	173.10	1366.97	463.96	11818.51	-11354.55
STA. 13+00	2.82	351.87	72.92	1357.08	536.88	13175.59	-12638.71
STA. 14+00	0.05	679.45	5.31	1909.86	542.19	15085.45	-14543.26
STA. 15+00	0.00	743.46	0.09	2693.22	542.28	17778.67	-17236.39
STA. 16+00	0.00	582.82	0.00	2555.07	542.28	20333.74	-19791.46

EXISTING UNDERGROUND UTILITY LINES ARE SHOWN ON THE DRAWINGS BASED UPON THE BEST INFORMATION AVAILABLE TO THE ENGINEER. THE ENGINEER CAN NOT AND DOES NOT WARRANT THAT THIS INFORMATION IS COMPLETE OR ACCURATE. THE CONTRACTOR MUST CALL IN MS811 UTILITY LOCATES AND PHYSICALLY LOCATE AND VISUALLY VERIFY LOCATIONS OF ALL UTILITIES.

Z:\1\Engineering\2021\1201\1201-001\Hurricane Zeta Repair\Harbor Repair Phase 3 Design\01 Design\CAD\31-001 PH 3 HARBOR DREDGING.dwg, 12/1/2022 2:18:18 PM, DWG to PDF.pc3

© JAMES J. CHINICHE, 2016