



**DEPARTMENT OF THE ARMY**  
CORPS OF ENGINEERS, MOBILE DISTRICT  
P.O. BOX 2288  
MOBILE, AL 36628-0001

**CESAM-RD-M**  
**PUBLIC NOTICE NO. SAM-2021-00273-AMR (DMR21-000123)**

**March 18, 2021**

**JOINT PUBLIC NOTICE**  
**U.S. ARMY CORPS OF ENGINEERS**

**MISSISSIPPI DEPARTMENT OF ENVIRONMENTAL QUALITY**  
**OFFICE OF POLLUTION CONTROL (MDEQ)**

**MISSISSIPPI DEPARTMENT OF MARINE RESOURCES**

**PROPOSED MAINTENANCE DREDGING FOR BAYOU PORTEAUX IN GULF HILLS,**  
**JACKSON COUNTY, MISSISSIPPI**

TO WHOM IT MAY CONCERN:

This District has received an application for a Department of the Army (DA) permit pursuant to Section 404 of the Clean Water Act (33 USC 1344) and Section 10 of the Rivers and Harbors Act of 1899 (33 U.S.C. 403). Please communicate this information to interested parties.

**APPLICANT:** Jackson County Board of Supervisors  
Post Office Box 998  
Pascagoula, MS 39568

**AGENT:** Seymore Engineering  
Attention: Sarah McLellan  
925 Tommy Munro Drive, Suite G  
Biloxi, Mississippi 39532

**WATERWAY AND LOCATION:** In waters of Bayou Porteaux, Section 13, Township 7 South, Range 9 West, Gulf Hills, Jackson County, Mississippi (latitude 30.439484° North, longitude -88.844868° West). The project site includes waters in Bayou Porteaux, in the Coastal Mississippi drainage (HUC 03170009).

**PROPOSED WORK:** The applicant proposes to dredge 13,200 yards<sup>3</sup> of mucky sand from 3,510 Linear Feet (LF) sections of Bayou Porteaux. Alignment A is 3,067 LF and alignment B is 443 LF. The current depths range from approximately -2' MLW to -5.0 MLW. Alignment A will be dredged to -5.0' MLW and Alignment B will be dredged to -4.0' MLW. Dredge spoils shall be placed in an approved BU site, or the HCDC disposal site, or another approved upland site. Additional maintenance would be conducted over the course of 10 years.

The applicant has applied for state water quality (WQ) certification in accordance with Section 401(a)(1) of the Clean Water Act, and for coastal zone (CZ) consistency in accordance with the State Coastal Zone Management Program. Upon completion of the required advertising and public comment review, a determination relative to WQ certification and CZ consistency will be made by the Mississippi Department of Environmental Quality and the Mississippi Department of Marine Resources.

This public notice is being distributed to all known interested persons in order to assist in developing facts on which a decision by the U.S. Army Corps of Engineers (USACE) can be based. For accuracy and completeness of the record, all data in support of or in opposition to the proposed work should be submitted in writing setting forth sufficient detail to furnish a clear understanding of the reasons for support or opposition.

The decision whether to issue a permit will be based on an evaluation of the probable impact including cumulative impacts of the proposed activity on the public interest. That decision will reflect the national concern for both protection and utilization of important resources. The benefit which reasonably may be expected to accrue from the proposal must be balanced against its reasonably foreseeable detriments. All factors which may be relevant to the proposal will be considered including the cumulative effects thereof; among those are conservation, economics, aesthetics, general environmental concerns, wetlands, historic properties, fish and wildlife values, flood hazards, floodplain values, land use, navigation, shoreline erosion and accretion, recreation, water supply and conservation, water quality, energy needs, safety, food and fiber production, mineral needs, consideration of property ownership and, in general, the needs and welfare of the people.

The USACE is soliciting comments from the public; Federal, State, and local agencies and officials; Indian Tribes; and other interested parties in order to consider and evaluate the impacts of this proposed activity. Any comments received will be considered by the USACE to determine whether to issue, modify, condition, or deny a permit for this proposal. To make this decision, comments are used to assess impacts on endangered species, historic properties, water quality, general environmental effects, and the other public interest factors listed above. Comments are used in the preparation of an Environmental Assessment and/or an Environmental Impact Statement pursuant to the National Environmental Policy Act. Comments are also used to determine the need for a public hearing and to determine the overall public interest of the proposed activity.

Any person may request, in writing, within the comment period specified in this notice, that a public hearing be held to consider this application. Requests for public hearings shall state with particularity, the reasons for holding a public hearing.

Evaluation of the probable impacts involving deposits of dredged or fill material into waters of the United States will include the application of guidelines established by the Administrator of the U.S. Environmental Protection Agency.

In accordance with Section 106 of the National Historic Preservation Act, and Appendix C

of 33 CFR 325, the undertaking defined in this notice is being considered for the potential to affect historic properties. In accordance with Appendix C of 33 CFR 325, the USACE has determined the permit area consists of the entire project site. The National Register of Historic Places has been consulted and no properties listed in or eligible for the National Register are known to exist which would be affected by the proposed work. The U.S. Army Corps of Engineers (USACE) has made a preliminary determination that the proposed project would have no effect on historic properties. However, we are seeking comment from the State Historic Preservation Officer, federally-recognized American Indian tribes, local historical societies, museums, universities, the National Park Service, and the general public regarding the existence or the potential for existence of significant cultural and historic properties which may be affected by the work. This action constitutes the full extent of cultural resources investigations unless comment to this notice is received documenting that significant sites or properties exist which may be affected by this work, or that adequately documents that a potential exists for the location of significant sites or properties within the project area.

A preliminary review of this application, the U.S. Department of the Interior List of Endangered and Threatened Wildlife and Plants and the National Marine Fisheries Service list of Mississippi's Threatened and Endangered Species indicate the proposed activity will have no effect on endangered or threatened species, or their critical habitat. This notice serves as request to the U.S. Fish and Wildlife Service and National Marine Fisheries Service for information on whether any listed or proposed to be listed endangered or threatened species may be present in the area which would be affected by the proposed activity.

Correspondence concerning this Public Notice should refer to Public Notice Number **SAM-2021-00273-AMR** and should be directed to the District Engineer, U.S. Army Engineer District, Mobile, Post Office Box 2288, Mobile, Alabama 36628-0001, Attention: South Mississippi Branch, with a copy to the Mississippi Department of Environmental Quality, Office of Pollution Control, Post Office Box 2261, Jackson, Mississippi 39225, and the Mississippi Department of Marine Resources, 1141 Bayview Avenue, Biloxi, Mississippi 39530.

**All Comments should be received no later than 30 days from the date of this Public Notice.** If you have any questions concerning this publication, you may contact the project manager at (251) 455-6785, or email at [angela.m.rangel@usace.army.mil](mailto:angela.m.rangel@usace.army.mil). Please refer to the above Public Notice number.

MOBILE DISTRICT  
U.S. Army Corps of Engineers

Enclosures



# Bayou Porteaux North Property Ownership Map

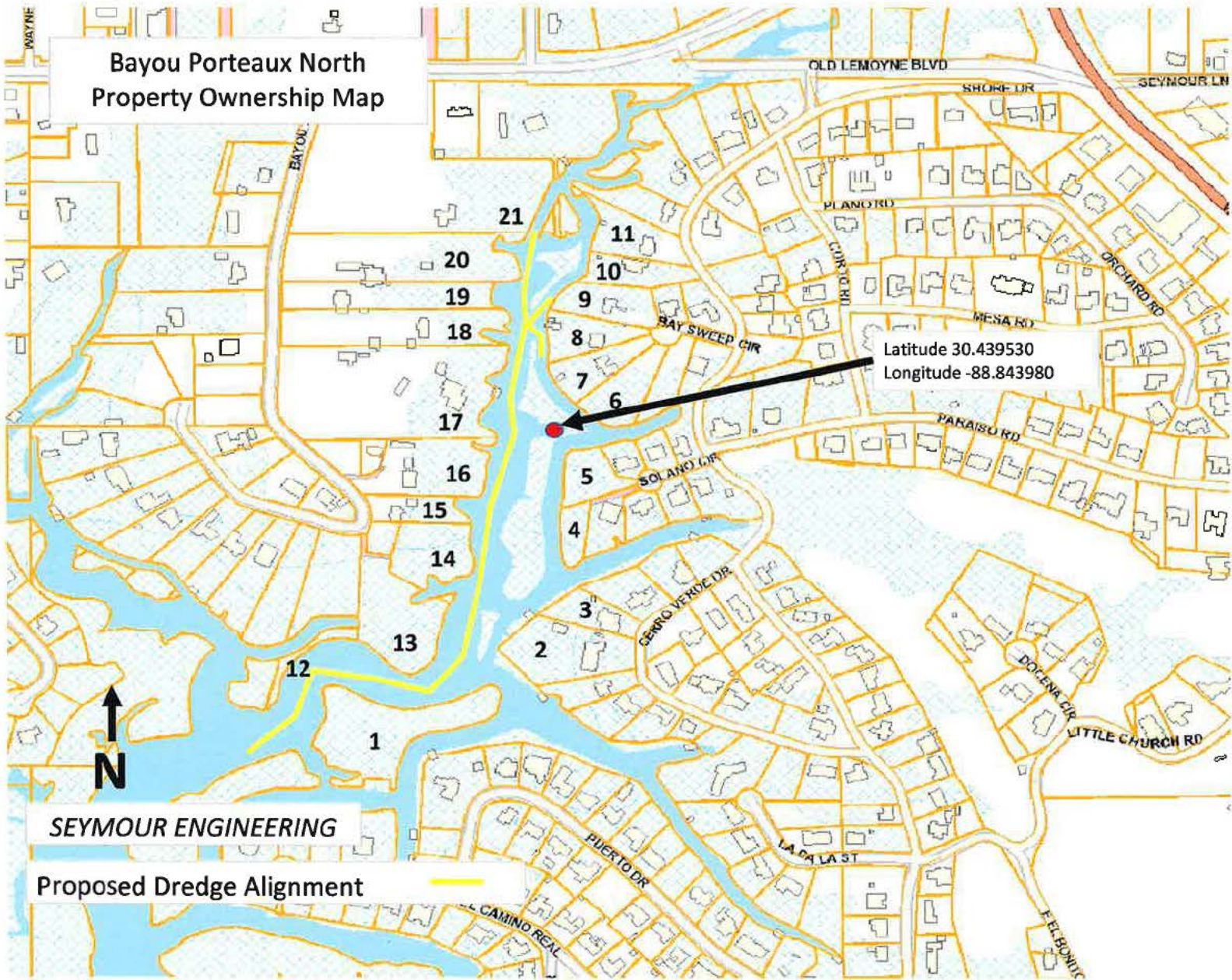

Latitude 30.439530  
Longitude -88.843980



SEYMOUR ENGINEERING

Proposed Dredge Alignment



Revised	
Drawn	K. NETTO
Checked	S. McLELLAN
Approved	M. SEYMOUR
Date	01/06/2021

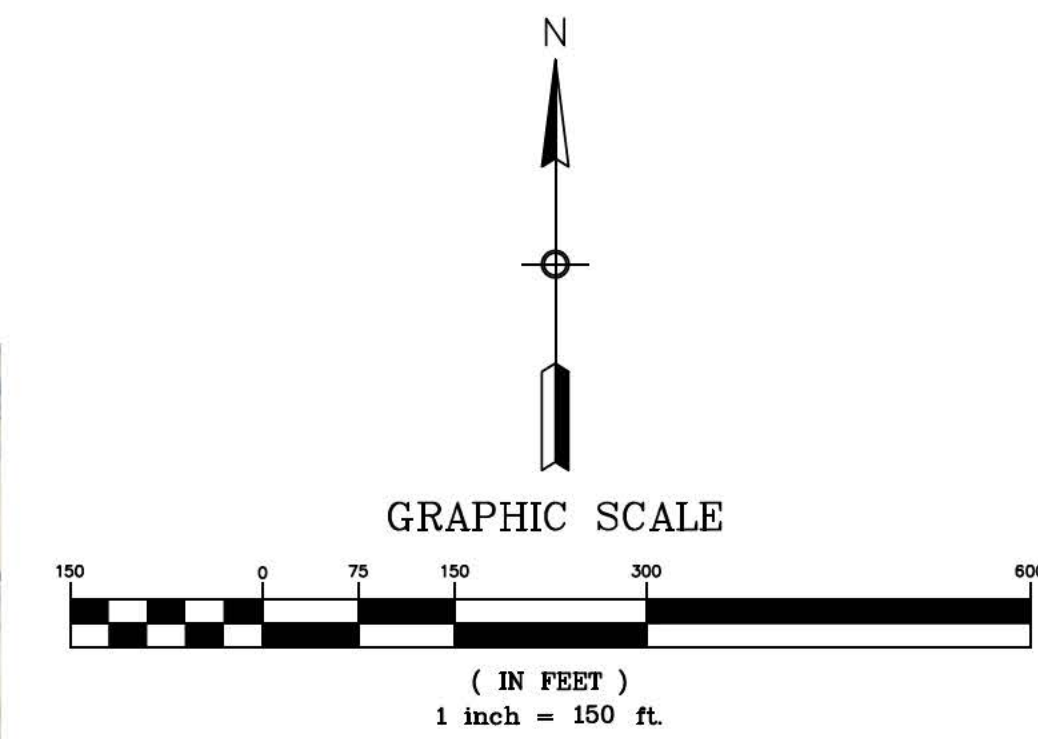

- GENERAL NOTES:**
1. ALL SURVEY ELEVATIONS SHOWN REFLECT MEAN LOW WATER.
  2. AERIAL IMAGERY PROVIDED BY MISSISSIPPI GEOSPATIAL CLEARINGHOUSE AND HAS BEEN GEOREFERENCED IN RELATION TO HYDROGRAPHIC SURVEY DATA SHOWN. ACTUAL IMAGE DIMENSIONS MAY VARY.
  3. ALL SURVEY ELEVATIONS REPRESENT CONDITIONS OF THE DREDGING AREAS AND ANY DISCREPANCIES SHOULD BE IDENTIFIED AND FIELD VERIFIED BY THE CONTRACTOR AND BROUGHT TO THE ATTENTION OF THE ENGINEER PRIOR TO COMMENCEMENT OF ANY WORK.
  4. CONTRACTOR SHALL MINIMIZE INTERFERENCE WITH AND SHALL PERMIT SUFFICIENT SPACE FOR THE SAFE NAVIGATIONAL USE OF CHANNELS AND PASSAGES.

<b>PROJECT DREDGING LEGEND</b>
Alignment A = Sta. 0+00 - 19+00 x 30' @ -5.0' MLW Sta. 19+00 - 30+67 x 15' @ -5.0' MLW
Alignment B = Sta. 0+00 - 4+43 x 15' @ -4.0' MLW
<b>Total Channel Dredge Length = 3,510 LF</b>

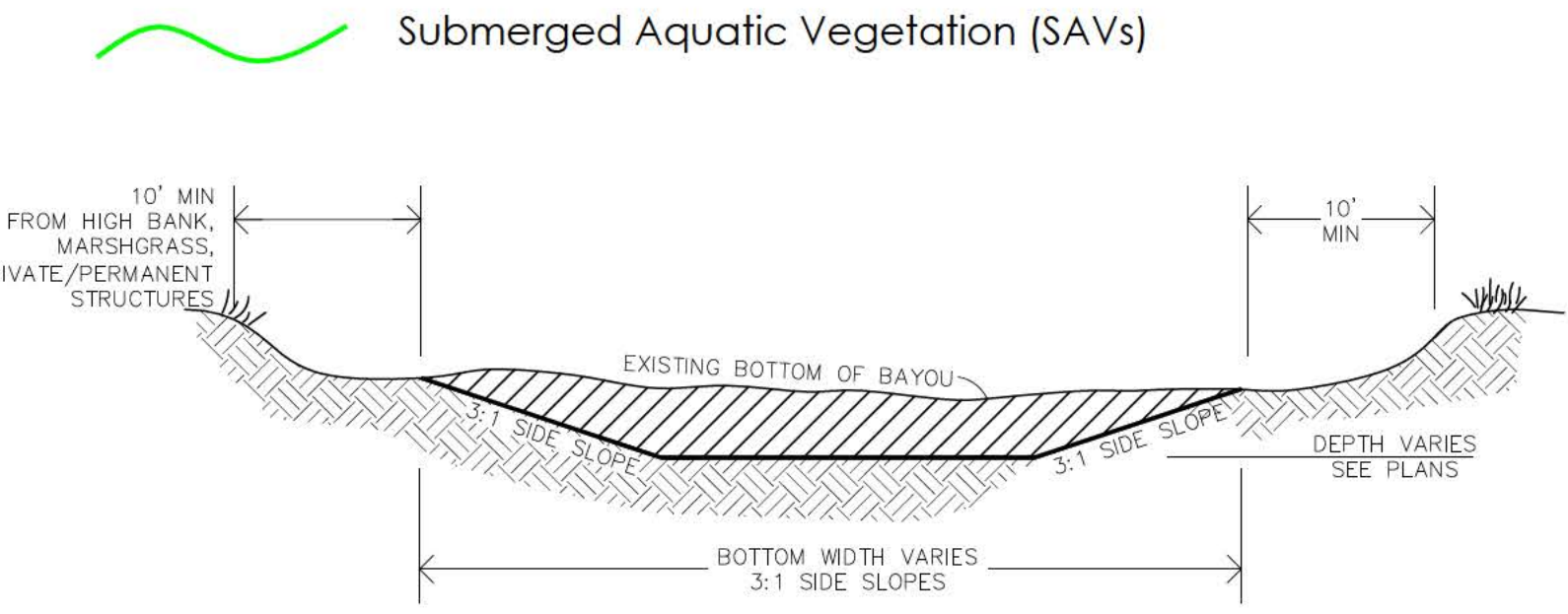

TYPICAL SECTION DETAIL  
SCALE: NONE

Sheet Title  
**SITE 5  
BAYOU PORTEAUX NORTH  
DREDGE PLAN**

Project Name  
**WEST JACKSON COUNTY #3  
PERMITTING/DREDGE PROJECT  
JACKSON COUNTY, MISSISSIPPI**

**SEYMOUR ENGINEERING**  
PHONE: 228-365-2350 925 TOMMY MUNRO DRIVE, SUITE G  
BILOXI, MISSISSIPPI 39532  
FAX: 228-365-2353

Sheet  
**C1**

Project No.  
20-065.03



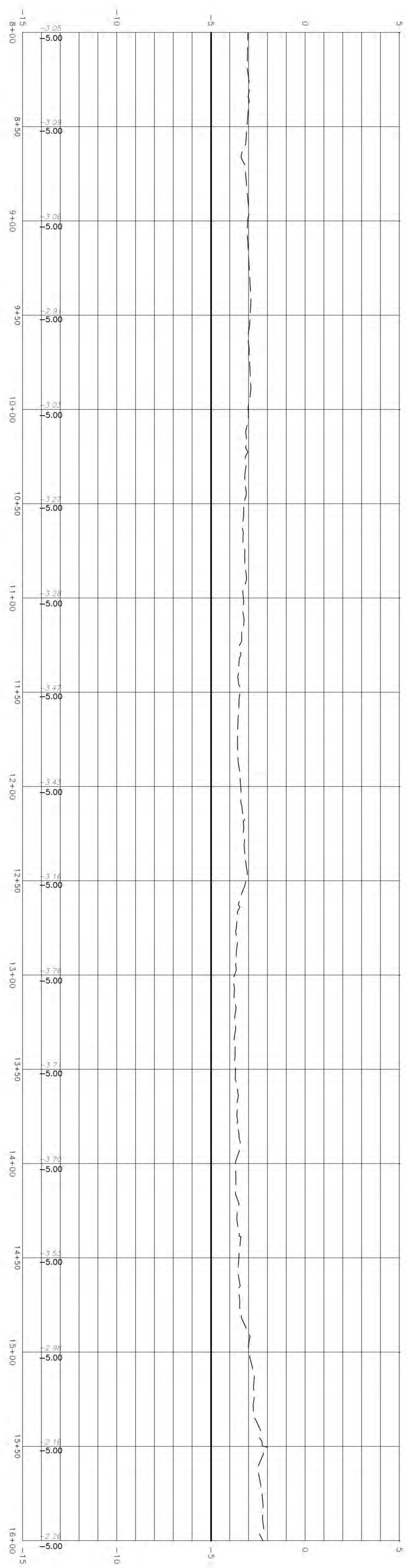
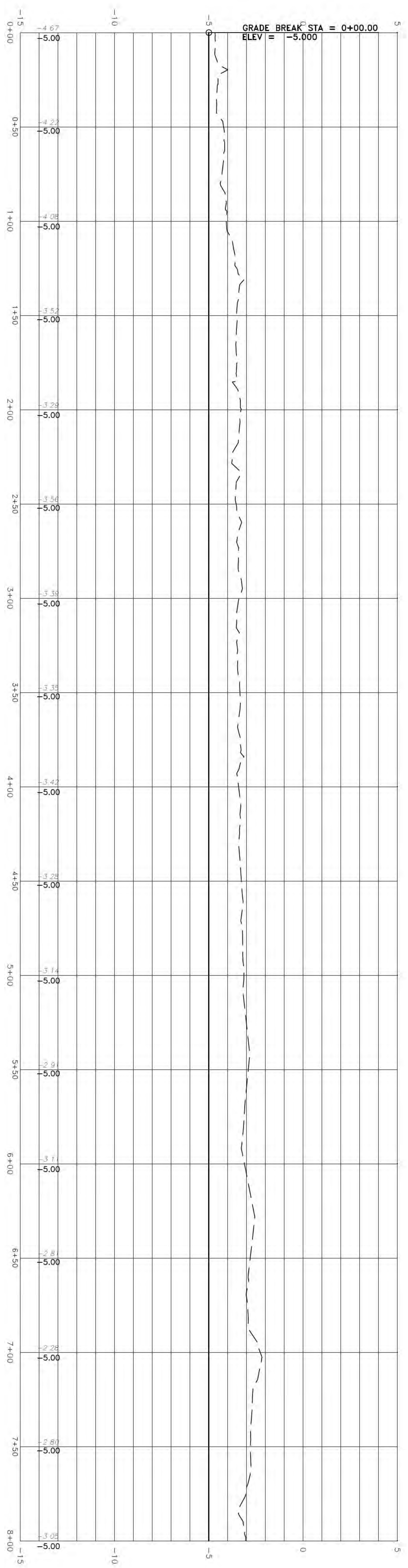

⊕ SITE 5: DREDGE PROFILE ALIGNMENT A  
BAYOU PORTEAUX NORTH

SCALE: 1" = 30'H  
1" = 3'V

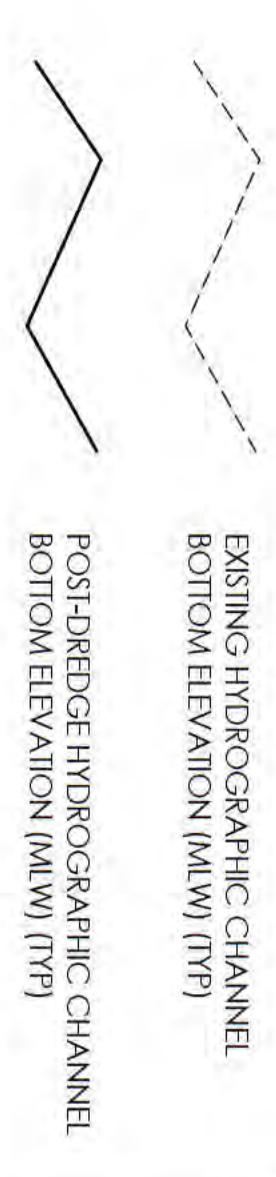

Drawn	K. NETO
Checked	S. WILLIAMS
Approved	M. STANBOR
Date	01/04/2021

Sheet Title  
**SITE 5  
BAYOU PORTEAUX NORTH  
DREDGE PROFILE  
ALIGNMENT A**

Project Name  
**WEST JACKSON COUNTY #3  
PERMITTING/DREDGE PROJECT  
JACKSON COUNTY, MISSISSIPPI**

**SEYMOUR ENGINEERING**  
 PHONE: 228-385-2350    925 TOMMY MUNRO DRIVE, SUITE G    FAX: 228-385-2353  
 BILOXI, MISSISSIPPI 39532

Sheet  
**C2**  
Project No.  
20-065.03



Revised	
Drawn	K. NETO
Checked	S. WILLIAMS
Approved	M. STANBOR
Date	01/04/2021

Sheet Title  
**SITE 5  
 BAYOU PORTEAUX NORTH  
 DREDGE PROFILE  
 ALIGNMENT A**

Project Name  
**WEST JACKSON COUNTY #3  
 PERMITTING/DREDGE PROJECT  
 JACKSON COUNTY, MISSISSIPPI**

**SEYMOUR ENGINEERING**  
 PHONE: 228-385-2350 925 TOMMY MUNRO DRIVE, SUITE G BILOXI, MISSISSIPPI 39532 FAX: 228-385-2353

Sheet  
**C3**  
 Project No.  
 20-065.03

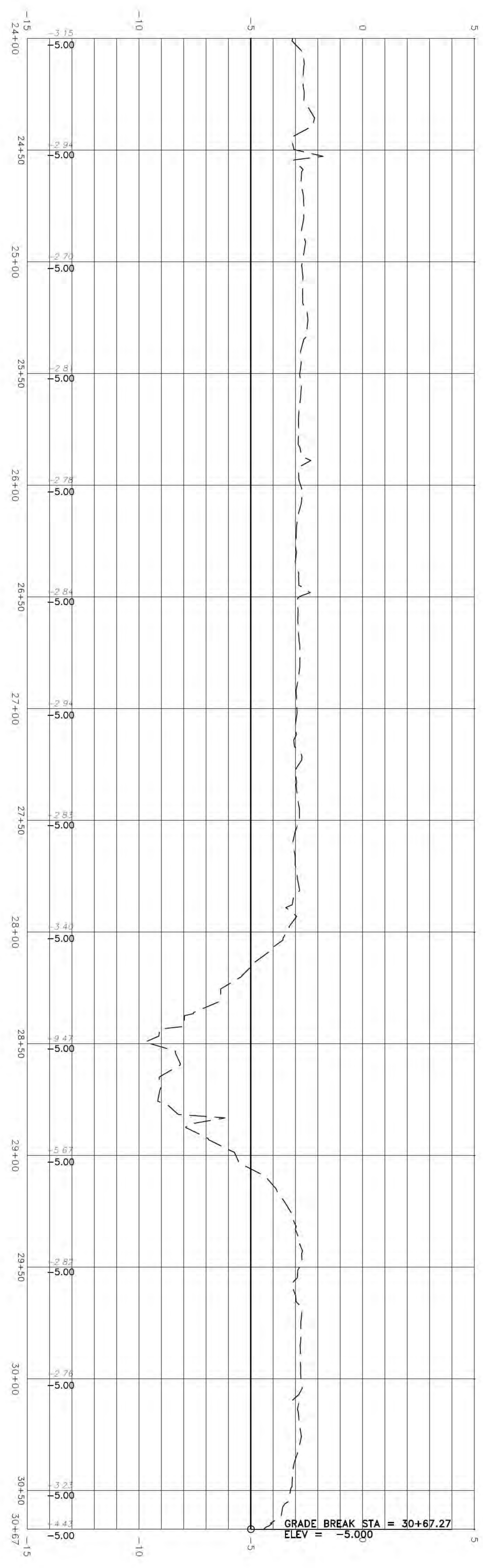
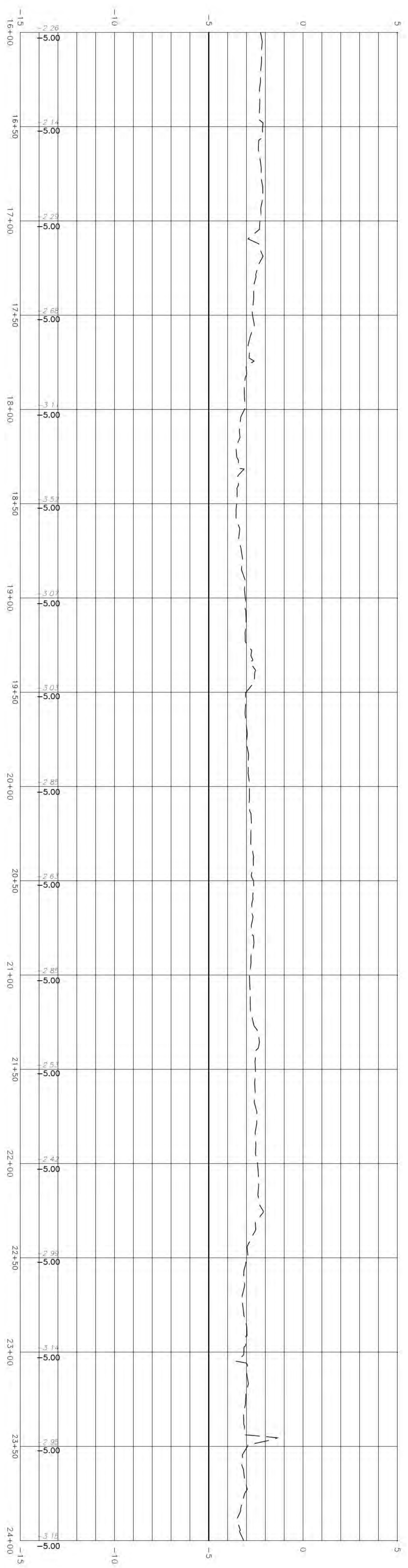

**SITE 5: DREDGE PROFILE ALIGNMENT A  
 BAYOU PORTEAUX NORTH**

SCALE: H' = 30H  
 V' = 3V





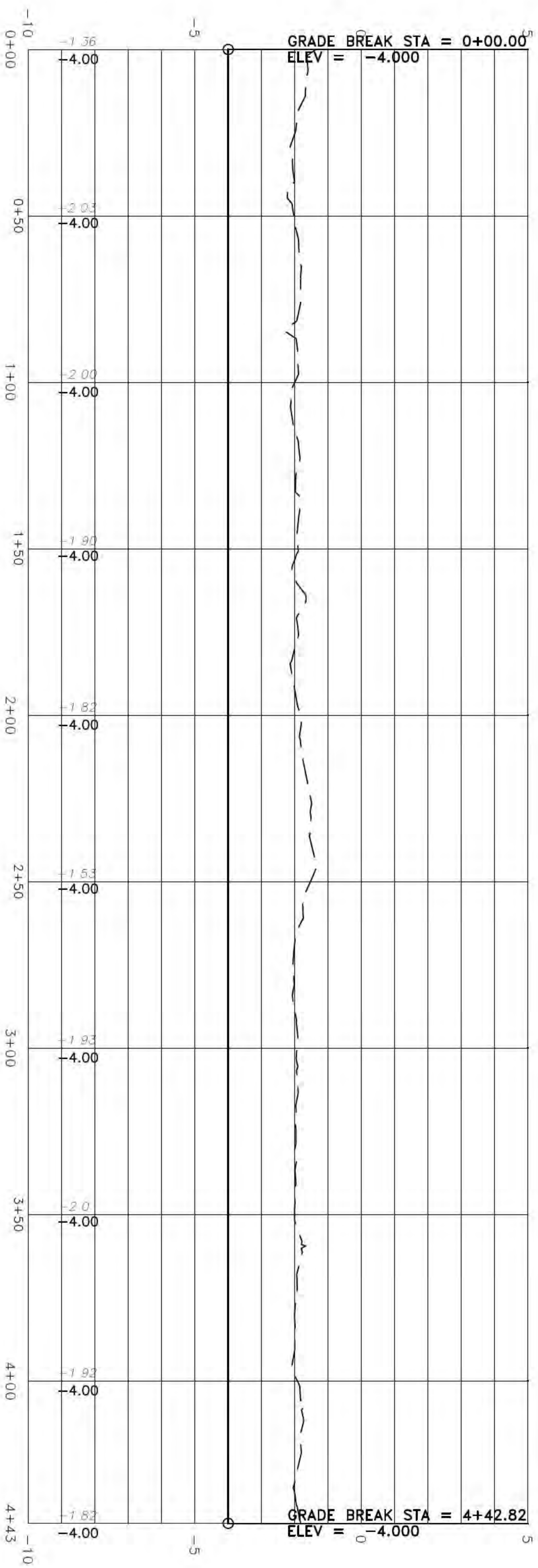

⊕ SITE 5: DREDGE PROFILE ALIGNMENT B  
BAYOU PORTEAUX NORTH

SCALE: 1" = 30'H  
1" = 3'V

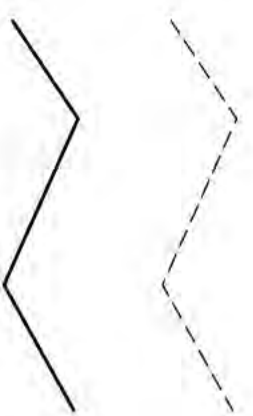

EXISTING HYDROGRAPHIC CHANNEL  
BOTTOM ELEVATION (MLM) (TVP)

POST-DREDGE HYDROGRAPHIC CHANNEL  
BOTTOM ELEVATION (MLM) (TTP)

Drawn	K. NETO
Checked	S. WILLIAMS
Approved	M. STANBOR
Date	01/04/2021

Sheet Title

**SITE 5  
BAYOU PORTEAUX NORTH  
DREDGE PROFILE  
ALIGNMENT B**

Project Name

**WEST JACKSON COUNTY #3  
PERMITTING/DREDGE PROJECT  
JACKSON COUNTY, MISSISSIPPI**

**SEYMOUR ENGINEERING**

PHONE: 228-385-2350 925 TOMMY MUNRO DRIVE, SUITE G FAX: 228-385-2353  
BILOXI, MISSISSIPPI 39532

Sheet

**C4**

Project No.  
20-065.03