



**DEPARTMENT OF THE ARMY**  
CORPS OF ENGINEERS, MOBILE DISTRICT  
P.O. BOX 2288  
MOBILE, AL 36628-0001

**CESAM-RD-A**  
**PUBLIC NOTICE NO. SAM-2017-01292-JEB**

**October 26, 2018**

**JOINT PUBLIC NOTICE**  
**U.S. ARMY CORPS OF ENGINEERS**  
**AND**  
**STATE OF ALABAMA**  
**DEPARTMENT OF ENVIRONMENTAL MANAGEMENT**

**REQUEST FOR AUTHORIZATION FOR CONSTRUCTION OF A NEW ATHLETIC PRACTICE FIELD AT SARALAND HIGH SCHOOL, SARALAND, MOBILE COUNTY, ALABAMA**

TO WHOM IT MAY CONCERN:

This District has received an application for a Department of the Army permit pursuant to Section 10 of the River and Harbor Act of 1899 (33 USC 403), and Section 404 of the Clean Water Act (33 USC 1344). Please communicate this information to interested parties.

**APPLICANT: Saraland Board of Education**  
**Saraland City Schools**  
**Attention: Dr. Aaron Milner, Superintendent**  
**943 Highway 43 South**  
**Saraland, Alabama 36571**

**AGENT: Wetland Resources Consulting**  
**Attention: Ms. Gena Todia**  
**Post Office Box 2694**  
**Daphne, Alabama 36526**

**LOCATION OF WORK: 1115 Industrial Parkway, near Latitude 30.7949° North, Longitude -88.0979° West, Section 8, Township 3 South, Range 1 West, Chickasabogue Creek, Saraland, Mobile County, Alabama.**

**PROPOSED WORK: The currently proposed project constitutes a substantial change in scope of the project and design, and therefore is being evaluated as a new permit action in accordance with 33 CFR Part 325.7. The original project proposal was advertised in a Public Notice dated March 29, 2018. However, the public comment period is being limited to 15 days.**

**The applicant requests authorization for construction of a new athletic practice field at Saraland High School. Parking areas, an athletic building and additional practice fields will be constructed in uplands to provide access to all of the facilities. The proposed project will include the unavoidable impact to 100,714 square feet (2.31 acres) of jurisdictional bayhead drain/ bottomland hardwood wetlands and 11,379 square feet**

**(0.26 acre) of isolated, non-jurisdictional wetlands. The new proposal eliminates wetland fill from all on-site coastal wetlands.**

**AVOIDANCE AND MINIMIZATION: The applicant has stated the following concerning avoidance and minimization to waters of the United States: “The initial site plan involved a minor amount of coastal wetland fill. The project has been redesigned to completely avoid coastal wetlands. Because the project requires approximately 14 acres of usable land to accommodate the needed facilities and the upland area to the east of the campus is over 12 acres, total wetland avoidance is not feasible. The project architect and engineers have spent significant amounts of time carefully evaluating all aspects of the project, including site conditions, how slopes can be stabilized, how to deal with stormwater, and related issues. The attached revised site plan is the best-case scenario that will meet the project objectives and keep wetland impacts to the minimum feasible amount.”**

**COMPENSATORY MITIGATION: The applicant has stated the following concerning mitigation for unavoidable impacts to waters of the United States: “The chosen alternative will result in the loss of 2.31 acres of high-quality jurisdictional wetlands, as determined using Wetland Rapid Assessment Procedure (WRAP). The isolated wetland was not assessed since it is non-jurisdictional under Section 404 of the Clean Water Act. The WRAP score is: 2.31 acre of impact (north side of project area): 80.56 % = High Quality. Wetlands to be impacted are classified as bayhead drain / bottomland hardwood; therefore, credits for this type of wetland system will be purchased from an established mitigation bank with a service area that includes the project site at the appropriate ratios prior to impacts occurring.”**

**WATER QUALITY: The applicant has applied for certification from the State of Alabama in accordance with Section 401(a)(1) of the Clean Water Act, and upon completion of the required advertising a determination relative to certification will be made.**

**PUBLIC REVIEW: This public notice is being distributed to all known interested persons in order to assist in developing facts on which a decision by the U.S. Army Corps of Engineers (USACE) can be based. For accuracy and completeness of the record, all data in support of or in opposition to the proposed work should be submitted in writing setting forth sufficient detail to furnish a clear understanding of the reasons for support or opposition. The decision whether to issue a permit will be based on an evaluation of the probable impact, including secondary and cumulative impacts, of the proposed activity on the public interest. That decision will reflect the national concern for both protection and utilization of important resources. The benefit which reasonably may be expected to accrue from the proposal must be balanced against its reasonably foreseeable detriments. All factors which may be relevant to the proposal will be considered, including the cumulative effects thereof; among those are conservation, economics, aesthetics, general environmental concerns, wetlands, cultural values, fish and wildlife values, flood hazards, flood plain values, land use, navigation, shoreline erosion and accretion, recreation, water supply and conservation, water quality, energy needs, safety, food production, and in general, the needs and welfare of the people.**

**HISTORIC PROPERTIES:** The National Register of Historic Places will be consulted for properties listed in or eligible for the National Register which are known to exist and would be affected by the proposed work. Additional notification will be furnished to the State Historic Preservation Officer via this Public Notice. This review constitutes the full extent of cultural resources investigations unless comment to this notice is received documenting that significant sites or properties exist which may be affected by this work, or that adequately documents that a potential exists for the location of significant sites or properties within the permit area. Copies of this notice are being sent to the U.S. Department of the Interior, National Park Service, Division of Archeological Services.

**ENDANGERED SPECIES:** Preliminary review of this application and the U.S. Department of the Interior List of Endangered and Threatened Wildlife and Plants indicates that no listed endangered and threatened species or their critical habitat occur within the project area. Notification to the United States Fish and Wildlife Service will be furnished via this Public Notice.

The USACE is soliciting comments from the public; Federal, State, and local agencies and officials; Indian Tribes; and other interested parties in order to consider and evaluate the impacts of this proposed activity. Any comments received will be considered by the USACE to determine whether to issue, modify, condition or deny a permit for this proposal. To make this decision, comments are used to assess impacts on endangered species, historic properties, water quality, general environmental effects, and the other public interest factors listed above. Comments are used in the preparation of an Environmental Assessment and/or an Environmental Impact Statement pursuant to the National Environmental Policy Act. Comments are also used to determine the need for a public hearing and to determine the Overall public interest of the proposed activity.

Any person may request, in writing, within the comment period specified in this notice, that a public hearing be held to consider this application. Requests for public hearings shall state with particularity, the reasons for holding a public hearing. Evaluation of the probable impacts involving deposits of dredged or fill material into waters of the United States will include the application of guidelines established by the Administrator of the U.S. Environmental Protection Agency.

Correspondence concerning this Public Notice should refer to Public Notice Number **SAM-2017-01292-JEB**, and should be directed to the District Engineer, USACE, Mobile District, Attention: Mr. Eric Buckelew, CESAM-RD-A, Post Office Box 2288, Mobile, Alabama 36628-0001, with a copy to the Alabama Department of Environmental Management, Coastal Section, 3664 Dauphin Street, Suite B, Mobile, Alabama 36608.

Comments should be received **no later than 15 days** from the date of this Public Notice. If you have any questions concerning this publication, you may contact this office, **Mr. Buckelew at (251) 690-3184, or by e-mail at james.e.buckelew@usace.army.mil**. Please refer to the above Public Notice number.

For additional information about our Regulatory Program, please visit our web site at [www.sam.usace.army.mil/Missions/Regulatory.aspx](http://www.sam.usace.army.mil/Missions/Regulatory.aspx).

MOBILE DISTRICT  
U.S. Army Corps of Engineers

Enclosures

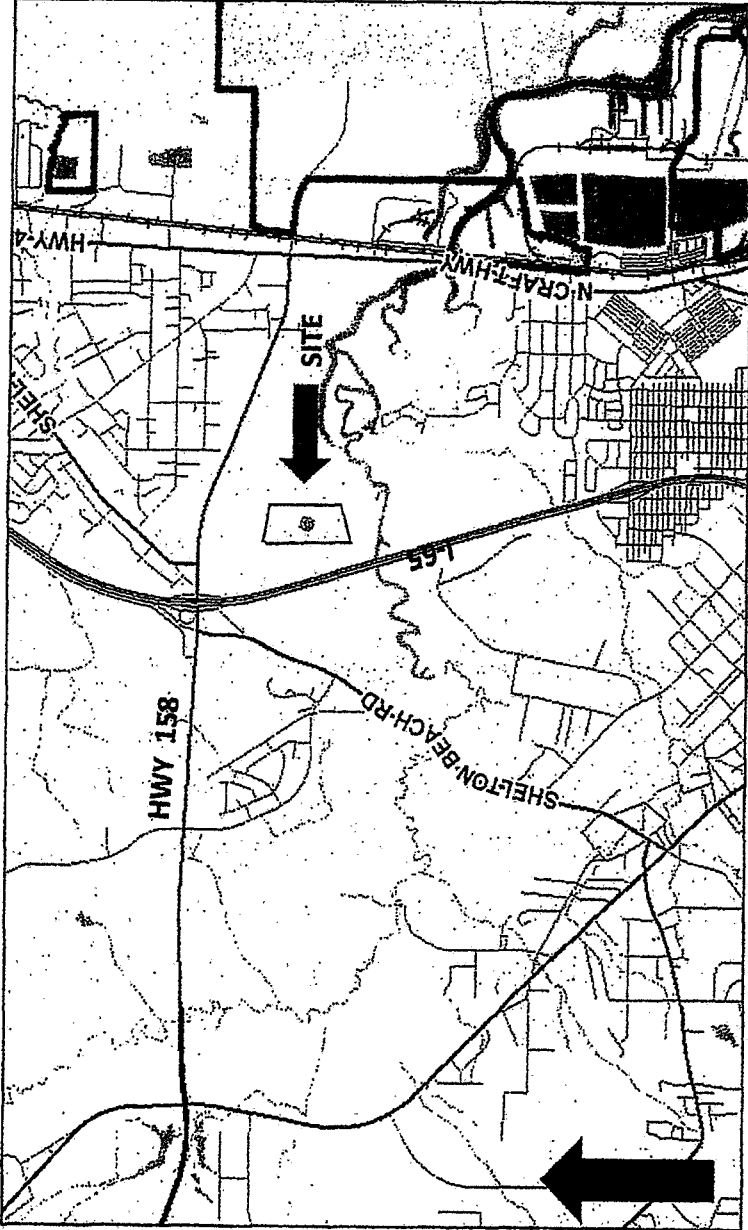

**VICINITY MAP**  
**Saraland Board of Education Property**  
**Saraland High School Campus**  
**Saraland, Mobile Co., Alabama**



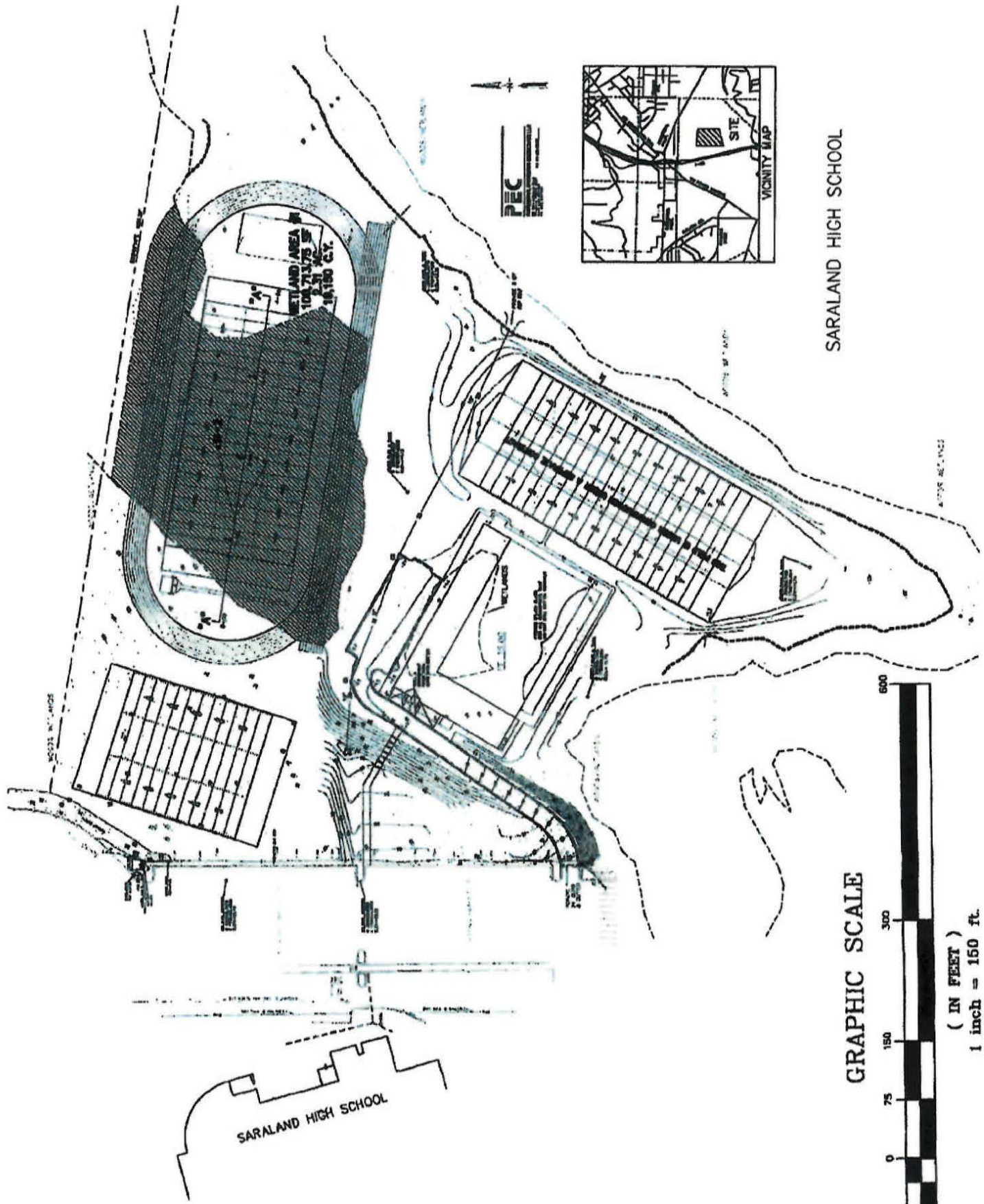

SARALAND HIGH SCHOOL

GRAPHIC SCALE



( IN FEET )  
1 inch = 150 ft.



**PEC**  
 PROFESSIONAL ENGINEERING CONSULTANTS, LLC  
 1000 W. 10th Street  
 Des Moines, IA 50319  
 Phone: (515) 281-7272  
 Fax: (515) 281-7299

S80°49'14"E 1051.27'

WOODS/WETLANDS

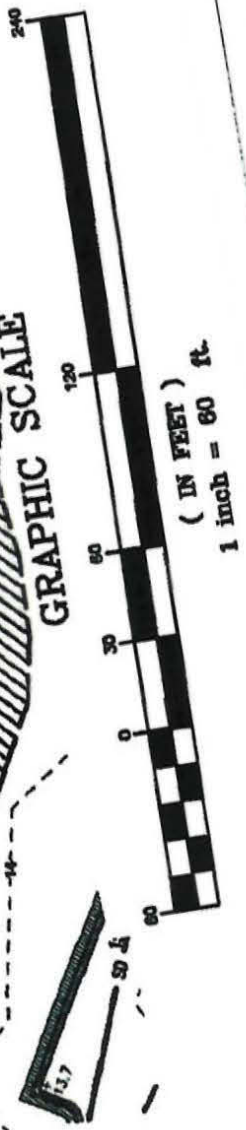
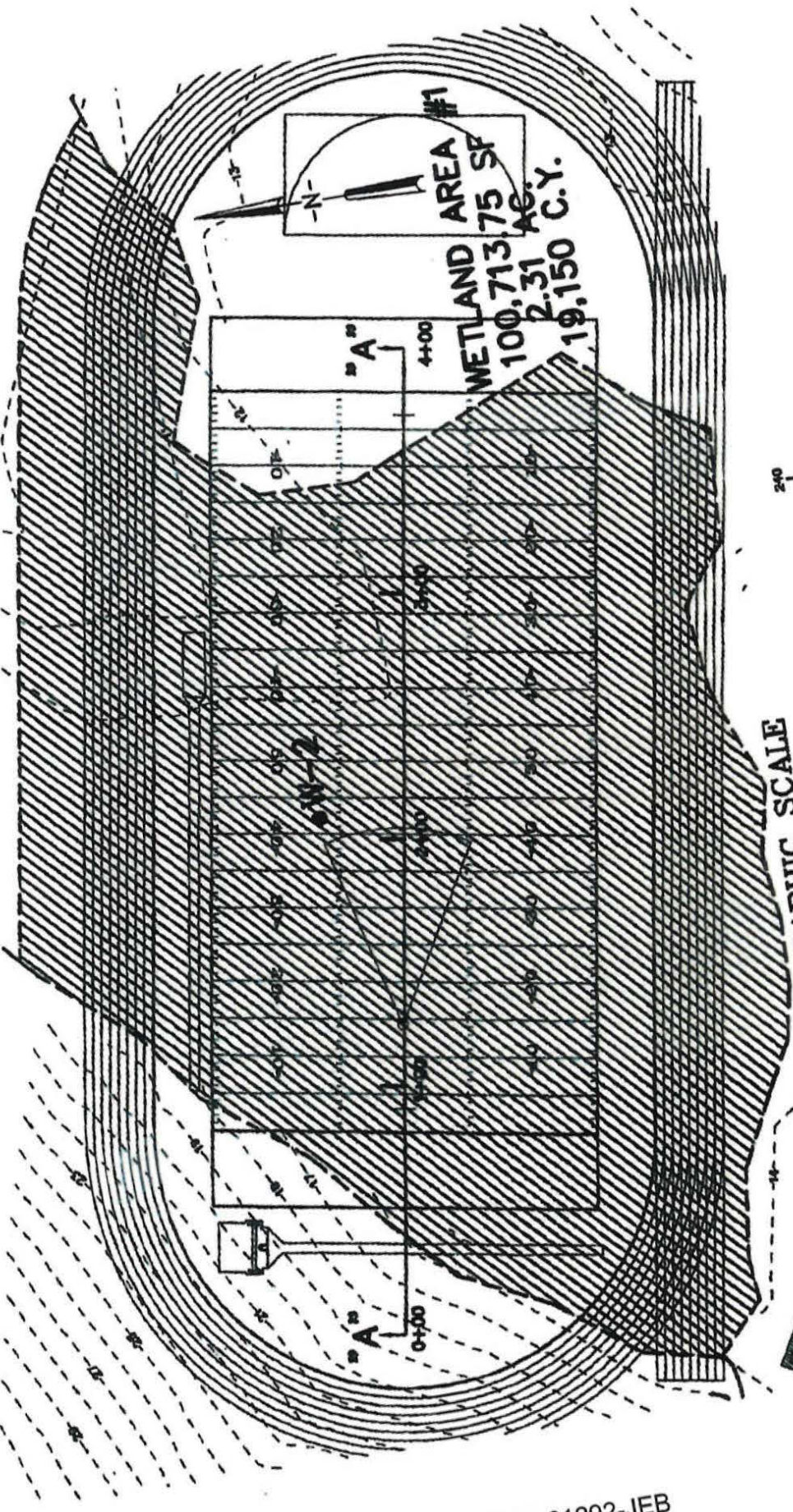





PROFESSIONAL ENGINEERING CONSULTANTS, LLC  
 CIVIL ENGINEERS & LAND SURVEYORS  
 207 SOUTH WASHINGTON STREET  
 SUITE 300  
 CHARLOTTE, NC 28202-4307  
 REG. NO. 17-071

SCALES  
 HORIZONTAL : 1" = 40'  
 VERTICAL : 1" = 5'

