



REPLY TO  
ATTENTION OF:

DEPARTMENT OF THE ARMY  
U.S. ARMY ENGINEER DISTRICT, MOBILE DISTRICT  
P.O. BOX 2288  
MOBILE, ALABAMA 36628-0001

CESAM-RD-M  
PUBLIC NOTICE NO. SAM-2013-00702-MJF

August 12, 2019

JOINT PUBLIC NOTICE  
U.S. ARMY CORPS OF ENGINEERS

MISSISSIPPI DEPARTMENT OF ENVIRONMENTAL QUALITY  
OFFICE OF POLLUTION CONTROL

MISSISSIPPI DEPARTMENT OF MARINE RESOURCES  
DMR-170023

**PROPOSED IMPACTS ASSOCIATED WITH THE CONSTRUCTION OF A PUBLIC  
RECREATION PARK, WETLANDS ASSOCIATED WITH MARY WALKER BAYOU,  
JACKSON COUNTY, MISSISSIPPI**

TO WHOM IT MAY CONCERN:

This District has received an application for a Department of the Army (DA) permit pursuant to Section 404 of the Clean Water Act. Please communicate this information to interested parties.

APPLICANT: **City of Gautier**  
**3330 Highway 90**  
**Gautier, Mississippi 39553**  
**pyancey@gautier-ms.gov**

AGENT: **Culpepper and Associates**  
**Mr. Billy Culpepper**  
**P.O. Box 1407**  
**Long Beach, Mississippi 39560**  
**billyculpepper@gmail.com**

LOCATION: **Wetlands and Other Waters Associated with Mary Walker Bayou, located on Dolphin Drive, City of Gautier, Jackson County, Mississippi. Section 34, Township 7 South, Range 7 West, Latitude 30.398256° North, Longitude -88.65465° West. This area is depicted on the MS-GAUTIER NORTH Quadrangle, United States Geological Survey Topographic Map, Hydrologic Unit Code 03170006.**

WORK: **The applicant originally requested to permanently impact 2.37 acres of jurisdictional wetlands, temporary impacts to 0.60 acre of wetlands, and impacts to 0.07 acre of linear other waters (by Public Notice dated November 1, 2016) for the construction of a public recreational park. The original project was has been modified and would now result in permanent impacts to 3.36 acre of jurisdictional wetlands and 0.052 acre of other waters of the U.S. The subject property is an approximately 32.3-**

acre site containing approximately 12.55 acres of wetlands and 1.6 acres of other waters. The public recreational park would include an outdoor amphitheater and pavilion with restrooms, a lake, an interpretive asphalt nature trail with three walking bridges spanning a water conveyance, a multi-purpose athletic field, basketball and pickleball courts, a splash pad, a musical playground, concession stand with restrooms, open space, 587 parking spaces, ingress and egress roads to include one culverted road crossing, stormwater facilities, 290-linear foot extension of an existing culvert crossing Dolphin Drive, and all other necessary water and electrical utilities. The on-site wetlands are located in four areas, three of which are pine savannah wetlands (11.03 acres) and one which is an emergent wetland (1.39 acres labeled as Wetlands Area #3). Other waters located on the site consist of four ponds and four un-named tributaries to Mary Walker Bayou. Three of the four perennial tributaries on-site appear to be man-made and all three flow into an un-named tributary to Mary Walker Bayou, a portion of which is labeled on the attached plans as "Other Waters #8". The wetlands and other waters located on the subject property drain eastward toward Mary Walker Bayou, which, in turn flows into the Pascagoula River

**EXISTING CONDITIONS:** The 32.3-acre site is mostly overgrown pine savannah. The site contains a high-tension power line which intersects the property, a power substation and a water tower. The site is bordered to the south by Dolphin Drive and the old Singing River Mall property. The Gautier-Vancleave Road is adjacent to the eastern border of the property with residential properties east of this road. The property to the north and west is mostly forested.

**PROJECT PURPOSE:** As stated by the Agent, "The City of Gautier does not have a venue for concerts or festivals or a public-use athletic field. The proposed project will serve that public need." The U.S. Army Corps of Engineers (USACE) initially determined the basic project purpose is construction of a city park and would not be considered a water dependent activity. Additional review will be performed by the USACE and cooperating agencies.

**AVOIDANCE AND MINIMIZATION:** As stated by the Agent, "Best management practices will be employed throughout the project to ensure no construction related siltation leaves the site."

**ALTERNATIVES:** The applicant evaluated three properties located within the City of Gautier for site selection. On-site alternatives provided by the Agent include the proposed layout and the previously requested layout. Additional review of alternatives will be performed by the USACE and cooperating agencies.

**MITIGATION:** According to the applicant's Agent "The applicant is proposing to provide compensatory mitigation of unavoidable impacts to 3.36 acres of low quality palustrine forested and emergent wetland. The mitigation would be provided by the purchase of the required wetland mitigation credits from an approved mitigation bank servicing the location of the project". Additional review of mitigation requirements will be performed by the USACE and cooperating agencies. Final compensatory mitigation will be

**evaluated by the USACE and cooperating resource agencies throughout the review process for the proposed project.**

The applicant has applied for certification from the State of Mississippi in accordance with Section 401(a)(1) of the Clean Water Act and upon completion of the required advertising; a determination relative to certification will be made.

The applicant has applied for coastal zone consistency from the State of Mississippi Department of Marine Resources in accordance with Section 57-15-6 of the Mississippi Code Annotated. (DMR-170023).

This public notice is being distributed to all known interested persons in order to assist in developing facts on which a decision by the USACE can be based. For accuracy and completeness of the record, all data in support of or in opposition to the proposed work should be submitted in writing setting forth sufficient detail to furnish a clear understanding of the reasons for support or opposition. The decision whether to issue a permit will be based on an evaluation of the probable impact, including cumulative impacts, of the proposed activity on the public interest. That decision will reflect the national concern for both protection and utilization of important resources.

The benefits, which reasonably may be expected to accrue from the proposal, must be balanced against its reasonably foreseeable detriments. All factors, which may be relevant to the proposal, will be considered, including the cumulative effects thereof; among those are conservation, economics, aesthetics, general environmental concerns, wetlands, cultural values, fish and wildlife values, protected species, flood hazards, flood plain values, land use, navigation, shoreline erosion and accretion, recreation, water supply and conservation, water quality, energy needs, safety, food production and in general, the needs and welfare of the people.

The USACE is soliciting comments from the public; Federal, State and local agencies and officials; Indian Tribes; and other interested parties in order to consider and evaluate the impacts of this proposed activity. Any comments received will be considered by the USACE to determine whether to issue, modify, condition or deny a permit for this proposal. To make this decision, comments are used to assess impacts on endangered species, historic properties, water quality, general environmental effects and the other public interest factors listed above. Comments are used in the preparation of an Environmental Assessment and/or an Environmental Impact Statement pursuant to the National Environmental Policy Act. Comments are also used to determine the need for a public hearing and to determine the overall public interest of the proposed activity. Any person may request, in writing, within the comment period specified in this notice, that a public hearing be held for consideration of this application. Requests for public hearings shall state with particularity, the reasons for holding a public hearing.

Evaluation of the probable impacts involving deposits of dredged or fill material into waters of the United States will include the application of guidelines established by the Administrator of the U.S. Environmental Protection Agency.

In accordance with Section 106 of the National Historic Preservation Act, and Appendix C of 33 CFR 325, the undertaking defined in this notice is being considered for the potential to effect cultural and historic properties within the permit area. In accordance with Appendix C of 33 CFR Part 325, the USACE has determined that the permit area is the overall project footprint to include the 32.3-acre parcel. We are seeking comment from the State Historic Preservation Officer, federally-recognized American Indian tribes, local historical societies, museums, universities, the National Park Service, and the general public regarding the existence or the potential for existence of significant cultural and historic properties which may be affected by the work. The USACE has determined that the proposed project would have “**no effect**” on cultural resources in the permit area.

Preliminary review of this application and the U.S. Department of the Interior List of Endangered and Threatened Wildlife and Plants indicated the following species may be present within the watershed: the Dusky Gopher Frog (*Rana sevosa*) (E), the Gopher Tortoise (*Gopherus Polyphemus*) (T), the Wood Stork (*Mycteria americana*) (T), The West India manatee (*Trichechus manatus*) (E), the Mississippi Sandhill Crane (*Grus Canadensis pulla*) (E), the Piping Plover (*Charadrius melodus*) (T), The Red Knot (*Calidris canutus rufa*) (T), the Alabama Red-Bellied Turtle (*Pseudemys alabamensis*) (E), The Loggerhead Sea Turtle (*Caretta Caretta*) (E), and the Gulf Sturgeon (*Acipenser oxyrinchus desotoi*) (T-CH). Preliminary review of this application and the U.S. Department of the Interior List of Endangered and Threatened Wildlife and Plants for the watershed suggest that the proposed activity **may affect, but is not likely to adversely affect** listed endangered or threatened species, the **Dusky Gopher Frog, the Wood Stork, and the Mississippi Sandhill Crane**. This determination is being coordinated with the U.S. Fish and Wildlife Service via this public notice and will be submitted to the National Marine Fisheries Service for coordination via their website.

Correspondence concerning this Public Notice should refer to Public Notice Number **SAM-2013-00702-MJF** and should be directed to the District Engineer, USACE, Mobile District, Attention: **Ms. Maryellen Farmer**, 1141 Bayview Avenue, Suite 104, Biloxi, Mississippi 39530, Attention: USACE Biloxi Field Office, with a copy to the Mississippi Department of Environmental Quality, Office of Pollution Control, **Attention: Ms. Florance Bass, P.E.**, Post Office Box 2261, Jackson, Mississippi 39225 and the Mississippi Department of Marine Resources, **Attention: Mrs. Jennifer Wilder**, 1141 Bayview Avenue, Suite 501, Biloxi, Mississippi 39530.

**All Comments should be received no later than 30 days from the date of this Public Notice.** If you have any questions concerning this publication, you may contact the project manager at (228) 523-4116, or email at [maryellen.j.farmer@usace.army.mil](mailto:maryellen.j.farmer@usace.army.mil). Please refer to the above Public Notice number.

**CESAM-RD-M**  
**SAM-2013-00702-MJF**

**August 12, 2019**  
**Page 5 of 5**

For additional information about our Regulatory Program, please visit our web site at:  
[www.sam.usace.army.mil/Missions/Regulatory.aspx](http://www.sam.usace.army.mil/Missions/Regulatory.aspx).

MOBILE DISTRICT  
U.S. Army Corps of Engineers

Enclosures

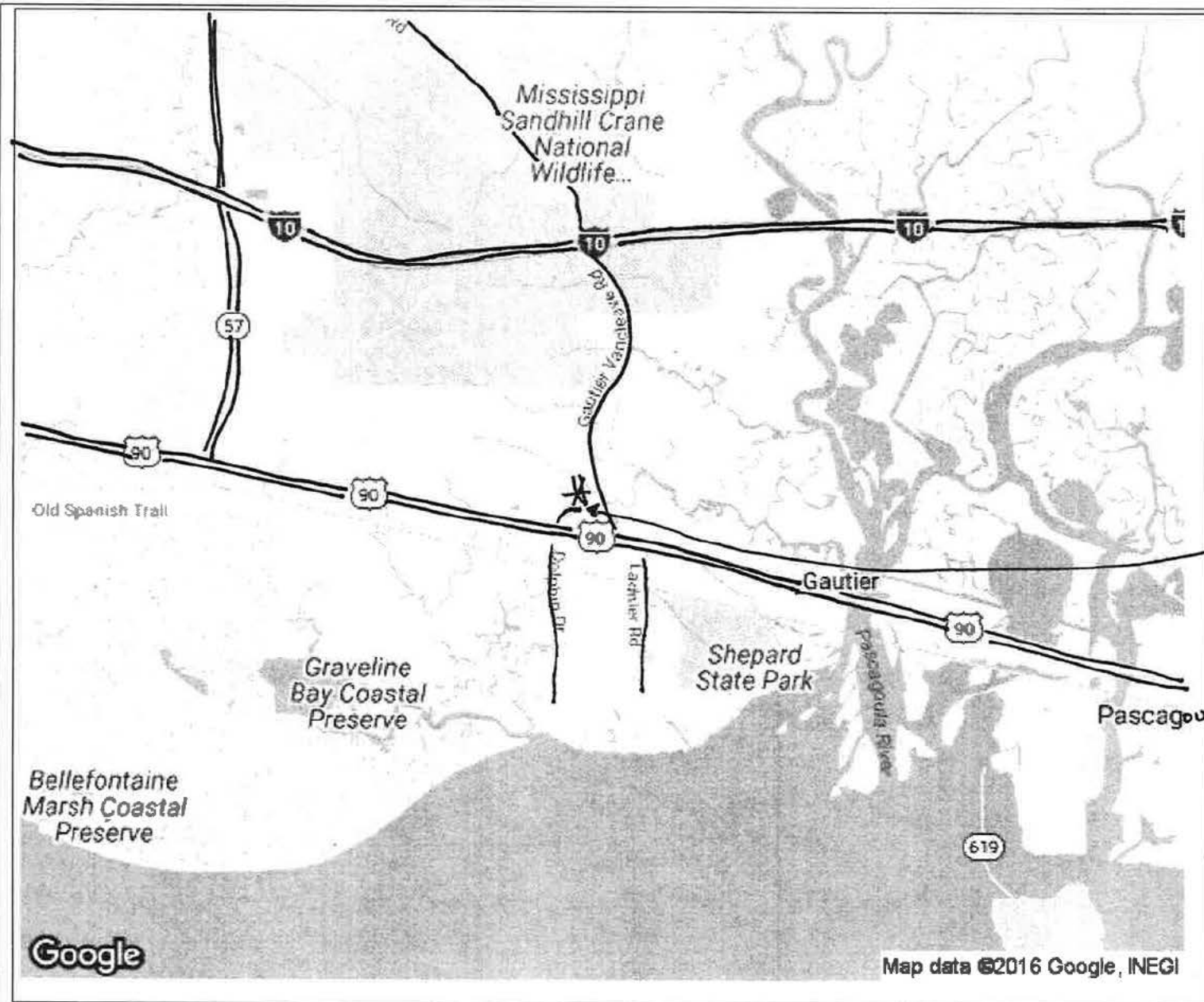

site

**SAM-2013-00702-KMN**

City of Gautier  
Public Recreational Park

0 1 2 3km

Date Printed: 10.31.2016 Map Scale: 1:108336



City of Gautier, Town Commons Park, Dolphin Dr., Gautier, Jackson Co., MS

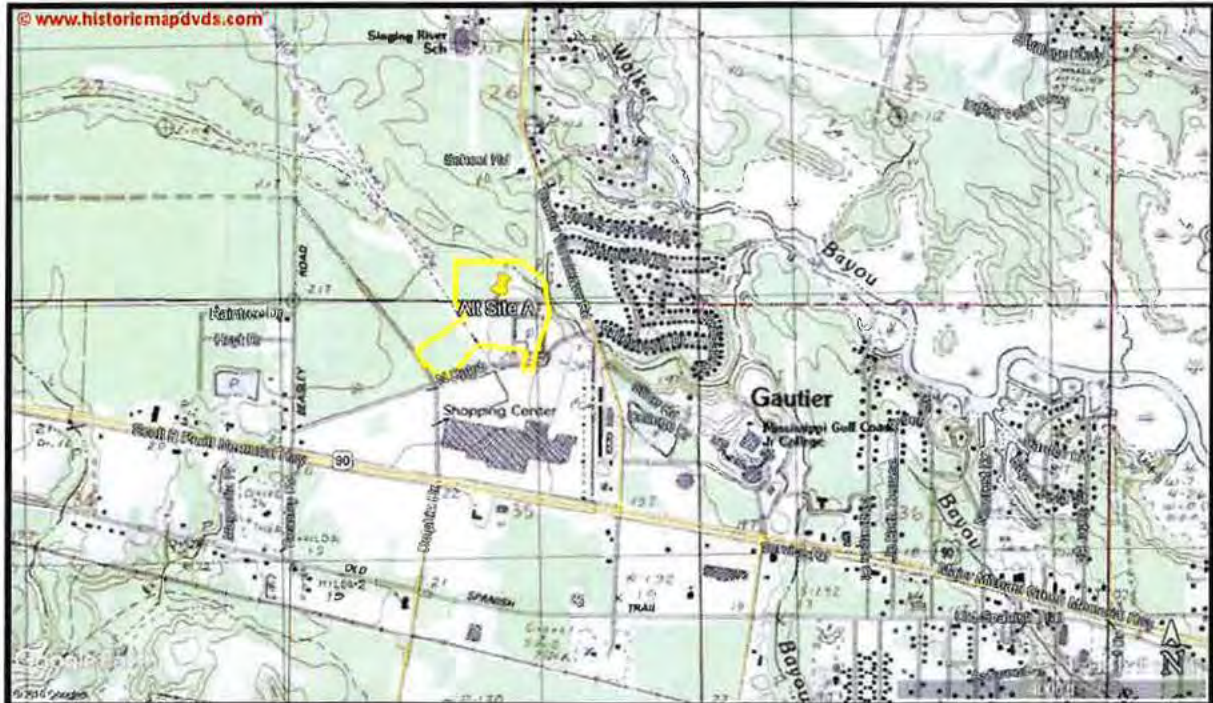

tier High School

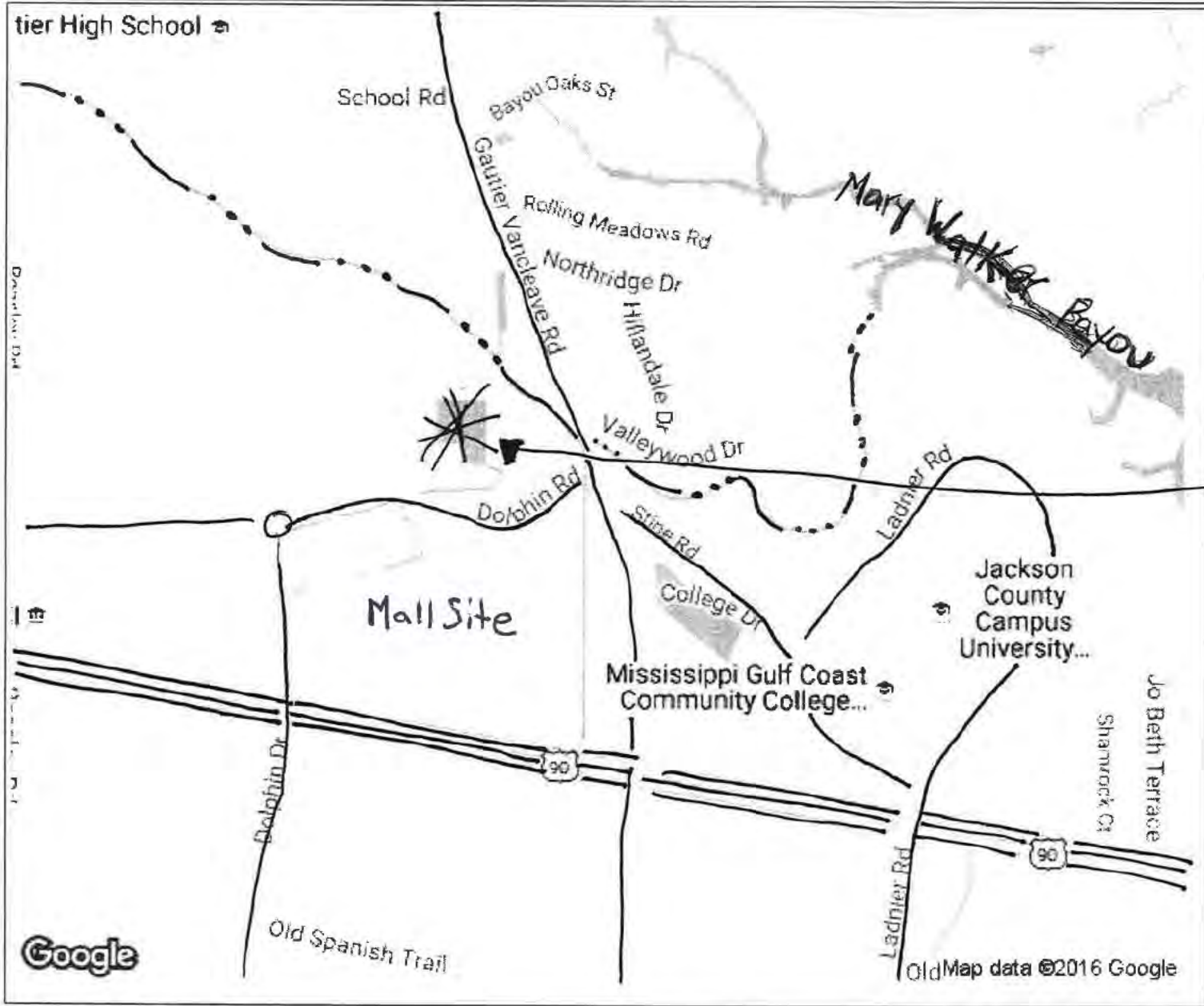

Site

Mall Site

Mary Walker Bayou

Google

OldMap data ©2016 Google

SAM-2013-00702-KMN



City of Gautier  
Public Recreational Park



Date Printed: 10.31.2016

Map Scale: 1:13352





# TOWN COMMONS PARK CITY OF GAUTIER



## GRAPHIC SCALE



( IN FEET )  
1 inch = 300 ft.

### WETLANDS ACREAGE:

AREA NUMBER	TOTAL Ac.	IMPACTED
WETLAND #1	6.247 Ac.	0.69 Ac.
WETLAND #2	1.601 Ac.	—
WETLAND #3	1.439 Ac.	0.08 Ac.
WETLAND #12	3.268 Ac.	2.59 Ac.
	12.555 Ac.	3.36 Ac.

### OTHER WATER ACREAGE:

AREA NUMBER	TOTAL Ac.	IMPACTED
AREA #4	0.579 Ac.	0.05 Ac.
AREA #5	0.112 Ac.	0.002 Ac.
AREA #6	0.339 Ac.	—
AREA #7	0.004 Ac.	—
AREA #8	0.134 Ac.	—
AREA #9	0.200 Ac.	—
AREA #10	0.149 Ac.	—
AREA #11	0.085 Ac.	—
	1.602 Ac.	0.052 Ac.

### LEGEND

WETLAND		12.56 Ac. WETLAND
WETLAND IMPACT		3.36 Ac. IMPACT

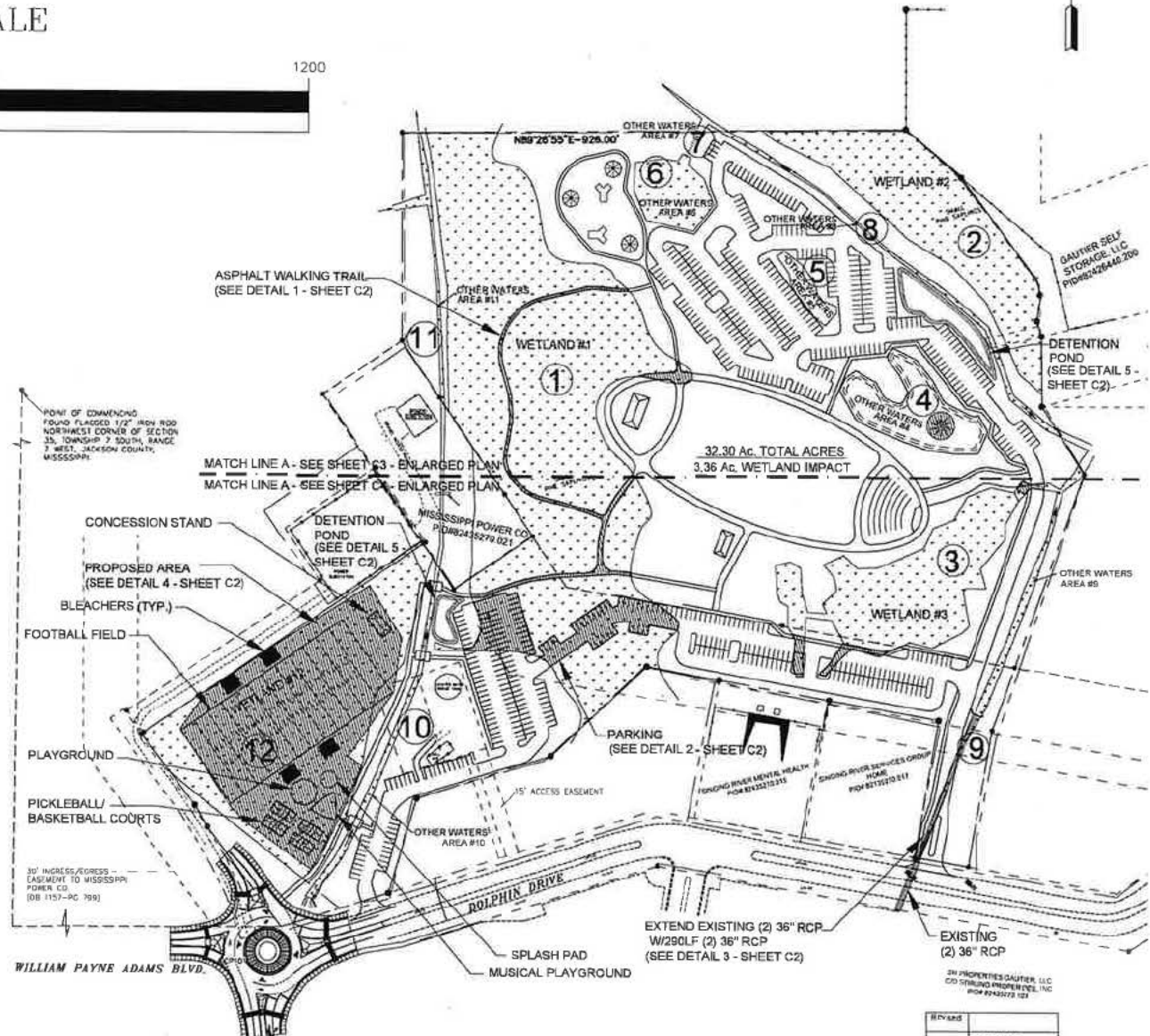

## SEYMOUR ENGINEERING

PHONE: 228-385-2350 925 TOMMY MURDO BILOXI, MISSISS. JTE: 0 FAX: 228-385-2352

Revised		
Drawn	07/19/2019	SHEET
Checked	DEPREO	
Approved	M. SEYMOUR	<b>C1</b>
Date	06/21/2019	OF 4

# TOWN COMMONS PARK CITY OF GAUTIER

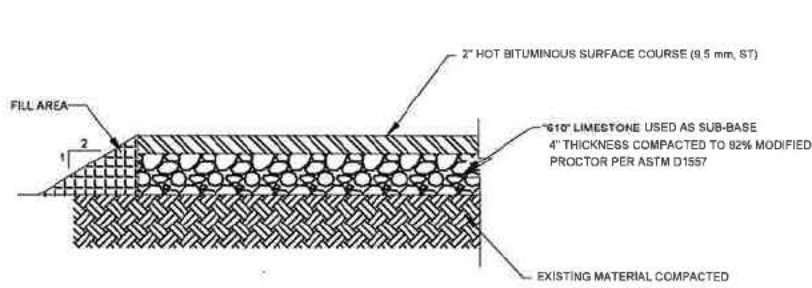

**1** ASPHALT WALKING TRAIL

SCALE: N.T.S.

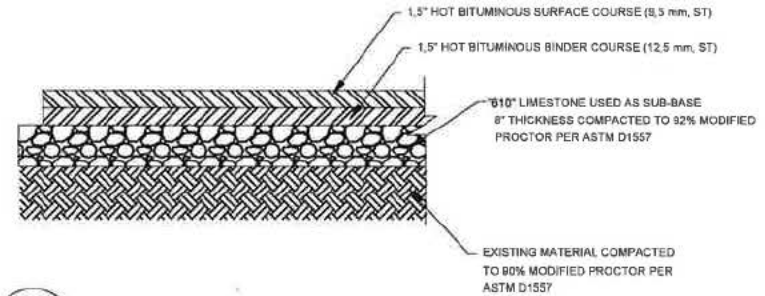

**2** ASPHALT PAVEMENT DETAIL

SCALE: N.T.S.

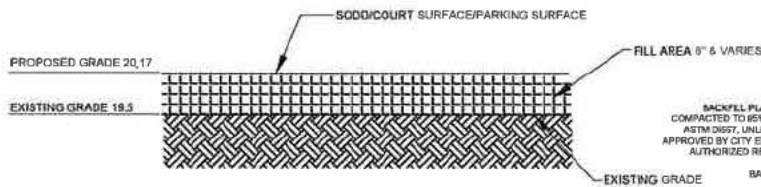

**4** TYPICAL PROPOSED AREA

SCALE: N.T.S.

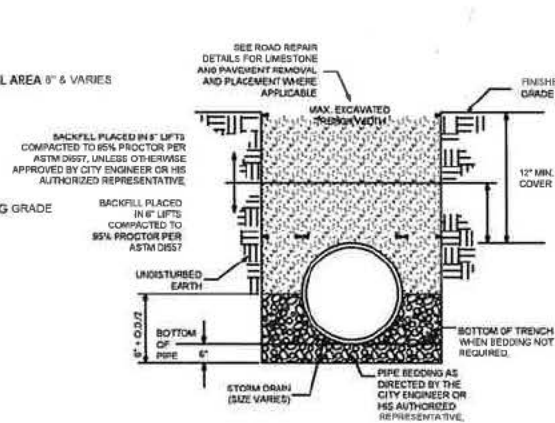

**STORM DRAIN PIPE NOTES:**

1. STORM DRAIN PIPE SHALL BE CONCRETE OR HDPE THERMOPLASTIC IN ACCORDANCE WITH THE SPECIFICATIONS. LOCATION FOR INSTALLATION OF HDPE THERMOPLASTIC SHALL BE AS SHOWN ON THE DRAWINGS OR AS DIRECTED BY THE ENGINEER OR HIS AUTHORIZED REPRESENTATIVE. ONLY CONCRETE STORM DRAIN PIPE SHALL BE INSTALLED UNDER PAVED AREAS.
2. ALL STORM DRAIN JOINTS SHALL BE WRAPPED WITH GEOTEXTILE FABRIC. FABRIC SHALL BE 3" WIDE (CENTERED OVER JOINT) AND LONG ENOUGH TO WRAP AROUND THE PIPE JOINT AND OVERLAP 1/3 THE CIRCUMFERENCE. THE COST OF FABRIC SHALL BE ABSORBED IN THE UNIT PRICE BID FOR STORM DRAIN PIPE AND SHALL NOT BE MEASURED FOR SEPARATE PAYMENT.
3. STORM DRAIN PIPE SHALL BE BURIED IN ACCORDANCE WITH THE PIPE MANUFACTURER'S WRITTEN MINIMUM COVER REQUIREMENTS, BUT COVER SHALL NOT BE LESS THAN 12".
4. REFER TO DETAILS FOR DRAINAGE STRUCTURES, CONCRETE PIPE REPAIR METHODS, PIPE END TREATMENTS, & GRATES.
5. PIPE BEDDING SHALL BE IN ACCORDANCE WITH SECTION 2 OF THE SPECIFICATIONS. TYPE AND LOCATION OF BEDDING SHALL BE IN COORDINATION WITH THE ENGINEER OR HIS REPRESENTATIVE. BEDDING FOR ARCH PIPE SHALL COVER THE HAUNCHES.
6. BACKFILL MATERIAL SHALL BE PLACED ON BOTH SIDES OF PIPE SIMULTANEOUSLY DURING BACKFILLING OPERATIONS TO PREVENT SHIFTING OR DAMAGE TO PIPE.
7. "MAXIMUM EXCAVATED TRENCH WIDTH" REFERS TO THE MAXIMUM WIDTH THAT WILL BE USED FOR COMPUTATION OF APPLICABLE PAY ITEMS FOR BEDDING, BORROW FOR BACKFILL, LIMESTONE, OR PAVING. THE CONTRACTOR MAY EXCAVATE A WIDER TRENCH AT HIS OWN EXPENSE AS LONG AS TRENCH REMAINS WITHIN THE LIMITS OF CITY P.O.B.L. PROPERTY OR EASEMENT AND THE CITY ENGINEER OR HIS AUTHORIZED REPRESENTATIVE APPROVES THE DIMENSIONS OF THE WIDER TRENCH.

**3** TYPICAL STORM DRAIN DETAIL

SCALE: N.T.S.

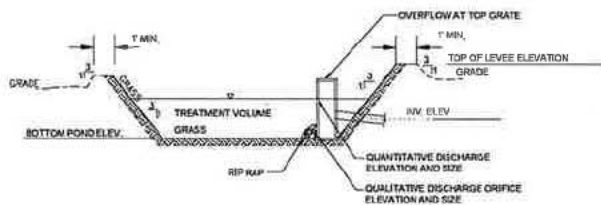

**5** DETENTION POND CROSS SECTION

SCALE: N.T.S.

## SEYMOUR ENGINEERING

PHONE: 228-365-2350 925 TOMMY MURPHY BILOXI, MISSISSIPPI LITE: G FAX: 228-365-2350

Revised		
Drawn	07/19/2019	SHEET
Checked	N. DEPRIO	
Approved	M. SEYMOUR	<b>C2</b>
Date	06/21/2019	

# TOWN COMMONS PARK CITY OF GAUTIER

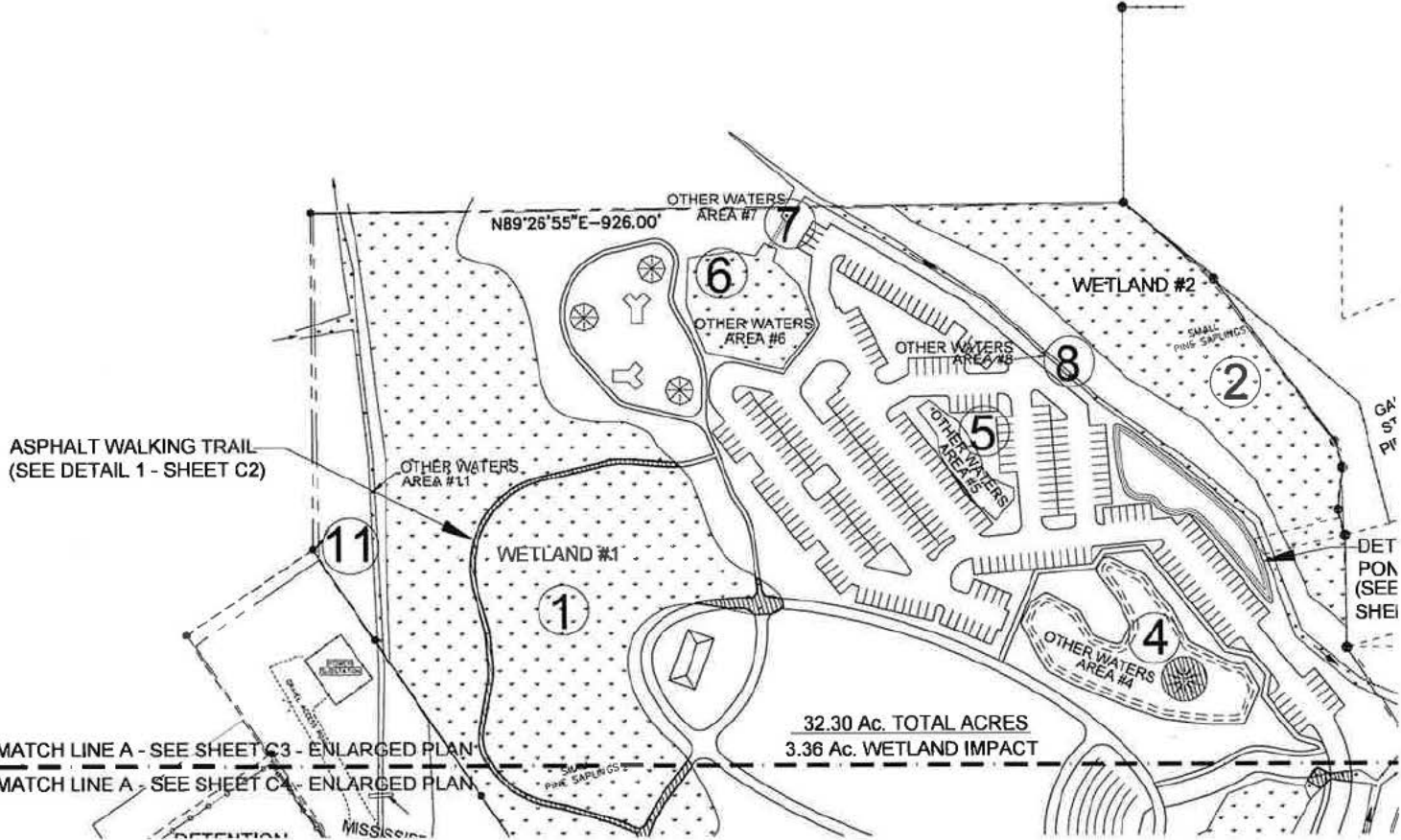

ASPHALT WALKING TRAIL  
(SEE DETAIL 1 - SHEET C2)

POINT OF COMMENCING  
FOUND FLAGGED 1/2" IRON ROD  
NORTHWEST CORNER OF SECTION  
35, TOWNSHIP 7 SOUTH, RANGE  
7 WEST, JACKSON COUNTY,  
MISSISSIPPI

MATCH LINE A - SEE SHEET C3 - ENLARGED PLAN  
MATCH LINE A - SEE SHEET C4 - ENLARGED PLAN

32.30 Ac. TOTAL ACRES  
3.36 Ac. WETLAND IMPACT

## SEYMOUR ENGINEERING

PHONE: 228-385-2350 925 TOMMY MURDO DRIVE, SUITE G BLOOMINGVILLE, MISSISSIPPI 39532 FAX: 228-385-2353

Revised		
Drawn	07/18/2018	SHEET
Checked	N. SEPVED	<b>C3</b>
Approved	M. SEYMOUR	
Date	05/21/2019	OF 4

# TOWN COMMONS PARK CITY OF GAUTIER

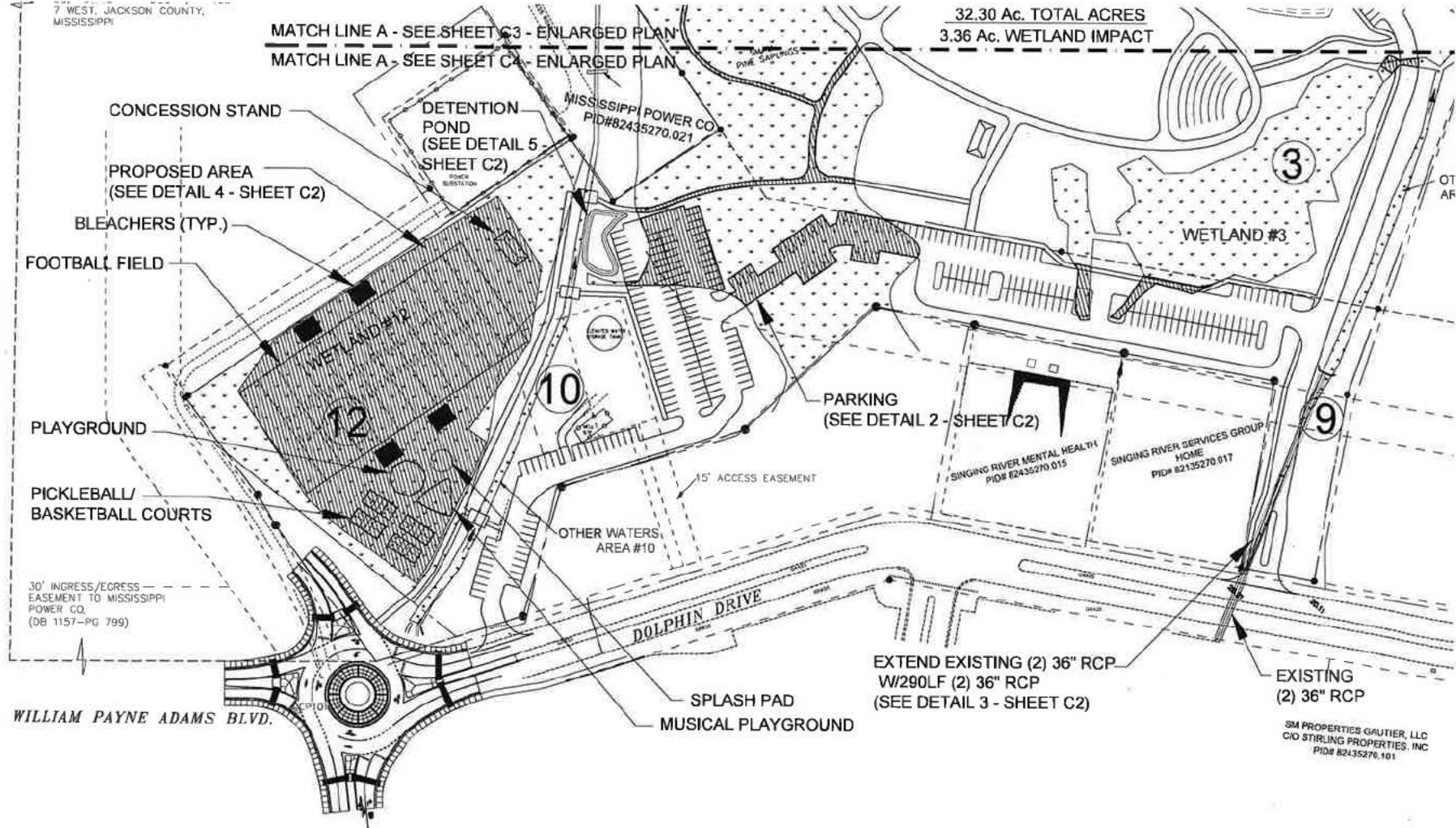

## SEYMOUR ENGINEERING

PHONE: 228-385-2350 925 TOMMY MUNRO DR. BILLOKI, MISSISSIPPI G FAX: 228-385-2353

Revised		<b>C4</b>
Drawn	07/19/2018	
Checked	N. DEPREZ	
Approved	V. SEYMOUR	
Date	08/21/2018	

SHEET  
OF 4