

DRY LAND APPROVED JURISDICTIONAL DETERMINATION FORM¹
U.S. Army Corps of Engineers

This form should be completed by following the instructions provided in Section IV of the JD Form Instructional Guidebook.

SECTION I: BACKGROUND INFORMATION

A. REPORT COMPLETION DATE FOR APPROVED JURISDICTIONAL DETERMINATION (JD): March 6, 2019

B. DISTRICT OFFICE, FILE NAME, AND NUMBER: MOBILE DISTRICT, GAUTIER SOCCER COMPLEX PARKING AREA, SAM-2018-1168-APS

C. PROJECT LOCATION AND BACKGROUND INFORMATION:

State: MS County/parish/borough: JACKSON City: GAUTIER

Center coordinates of site (lat/long in degree decimal format): Lat. 30.405790 °, Long. -88.693513 °
Universal Transverse Mercator: 337316.064193, 3364974.042467

Name of nearest waterbody: UNNAMED TRIBUTARY TO GRAVELINE BAYOU

Name of watershed or Hydrologic Unit Code (HUC): 03170009, BILOXI BAY-MS SOUND

- ☒ Check if map/diagram of review area is available upon request.
- ☐ Check if other sites (e.g., offsite mitigation sites, disposal sites, etc...) are associated with this action and are recorded on a different JD form.

D. REVIEW PERFORMED FOR SITE EVALUATION (CHECK ALL THAT APPLY):

- ☒ Office (Desk) Determination. Date: March 6, 2019
- ☒ Field Determination. Date(s): January 11, 2019

SECTION II: SUMMARY OF FINDINGS

A. RHA SECTION 10 DETERMINATION OF JURISDICTION.

There are **no** "navigable waters of the U.S." within Rivers and Harbors Act (RHA) jurisdiction (as defined by 33 CFR part 329) in the review area.

B. CWA SECTION 404 DETERMINATION OF JURISDICTION.

There are **no** "waters of the U.S." within Clean Water Act (CWA) jurisdiction (as defined by 33 CFR part 328) in the review area.

SECTION III: DATA SOURCES.

A. SUPPORTING DATA. Data reviewed for JD (check all that apply - checked items shall be included in case file and, where checked and requested, appropriately reference sources below):

- ☒ Maps, plans, plots or plat submitted by or on behalf of the applicant/consultant: COMPTON ENGINEERING
- ☒ Data sheets prepared/submitted by or on behalf of the applicant/consultant.
- ☒ Office concurs with data sheets/delineation report.
- ☐ Office does not concur with data sheets/delineation report.
- ☐ Data sheets prepared by the Corps:
- ☐ U.S. Geological Survey Hydrologic Atlas:
- ☐ USGS NHD data.
- ☐ USGS 8 and 12 digit HUC maps.
- ☒ U.S. Geological Survey map(s). Cite scale & quad name: GAUTIER NORTH, 1:24,000
- ☒ USDA Natural Resources Conservation Service Soil Survey. Citation: NRCS WEB SOIL SURVEY (WEBSOILSURVEY.NRCS.USDA.GOV/)
- ☒ National wetlands inventory map(s). Cite name: USFWS NWI ONLINE MAPPER (WWW.FWS.GOV/WETLANDS/)
- ☐ State/Local wetland inventory map(s):
- ☐ FEMA/FIRM maps:
- ☐ 100-year Floodplain Elevation is: (National Geodetic Vertical Datum of 1929) Photographs:
- ☐ Aerial (Name & Date):
- ☐ or ☐ Other (Name & Date):
- ☐ Previous determination(s). File no. and date of response letter:
- ☐ Applicable/supporting case law:
- ☐ Applicable/supporting scientific literature:
- ☒ Other information (please specify): SITE VISIT CONDUCTED BY USACE AND AGENT ON 01/11/2019

B. REQUIRED ADDITIONAL COMMENTS TO SUPPORT JD. EXPLAIN RATIONALE FOR DETERMINATION THAT THE REVIEW AREA ONLY INCLUDES DRY LAND:

¹ This form is for use only in recording approved JDs involving dry land. It extracts the relevant elements of the longer approved JD form in use since 2007 for aquatic areas and adds no new fields.

DEPARTMENT OF THE ARMY
SAM-2018-1168-APS

SAM-2018-1168

© 2018 Google

Google earth

556 ft

1992

Imagery Date: 2/25/2017 lat 30.404937° lon -88.693325° elev 22 ft eye alt 2424 ft

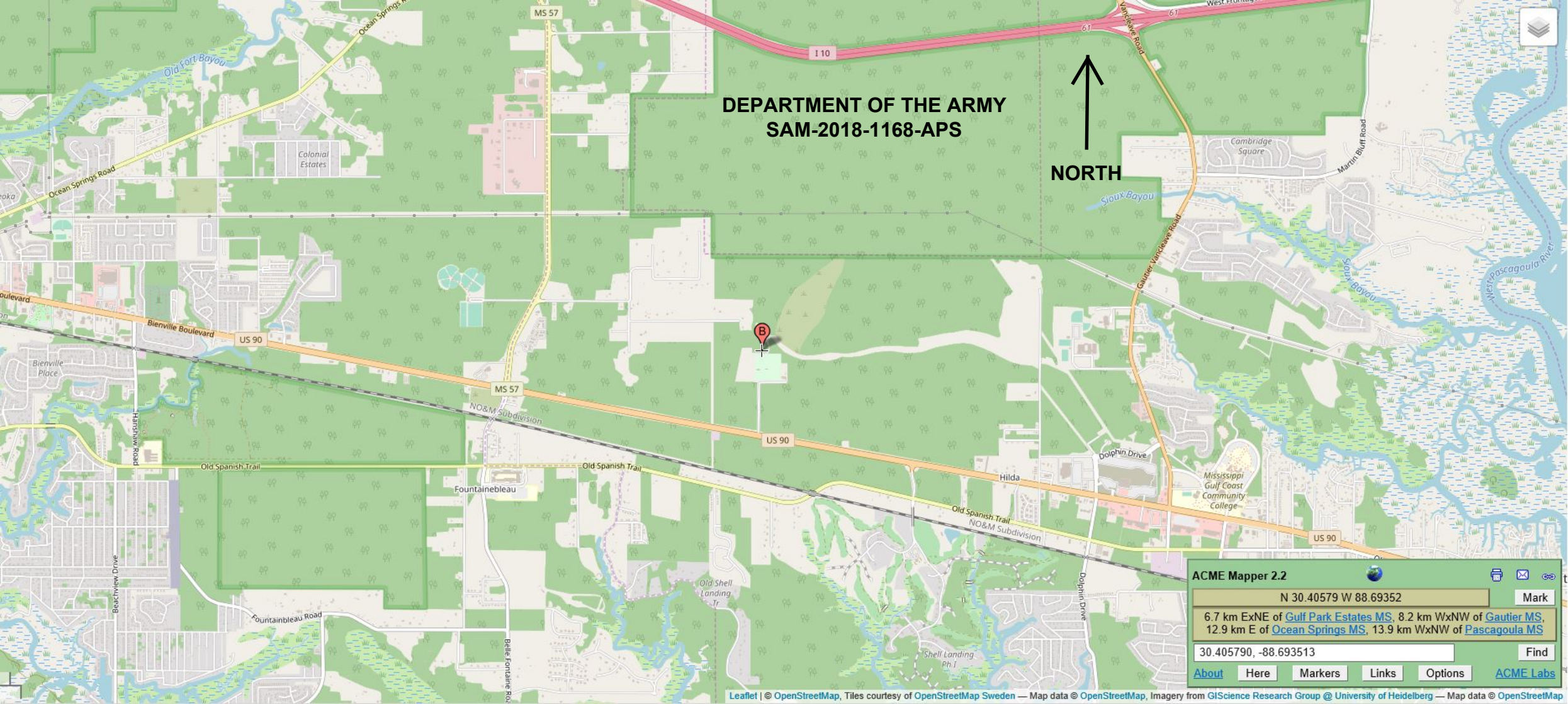

DEPARTMENT OF THE ARMY
SAM-2018-1168-APS



ACME Mapper 2.2

N 30.40579 W 88.69352

Mark

6.7 km ExNE of [Gulf Park Estates MS](#), 8.2 km WxNW of [Gautier MS](#),
12.9 km E of [Ocean Springs MS](#), 13.9 km WxNW of [Pascagoula MS](#)

30.405790, -88.693513

Find

[About](#)

[Here](#)

[Markers](#)

[Links](#)

[Options](#)

[ACME Labs](#)

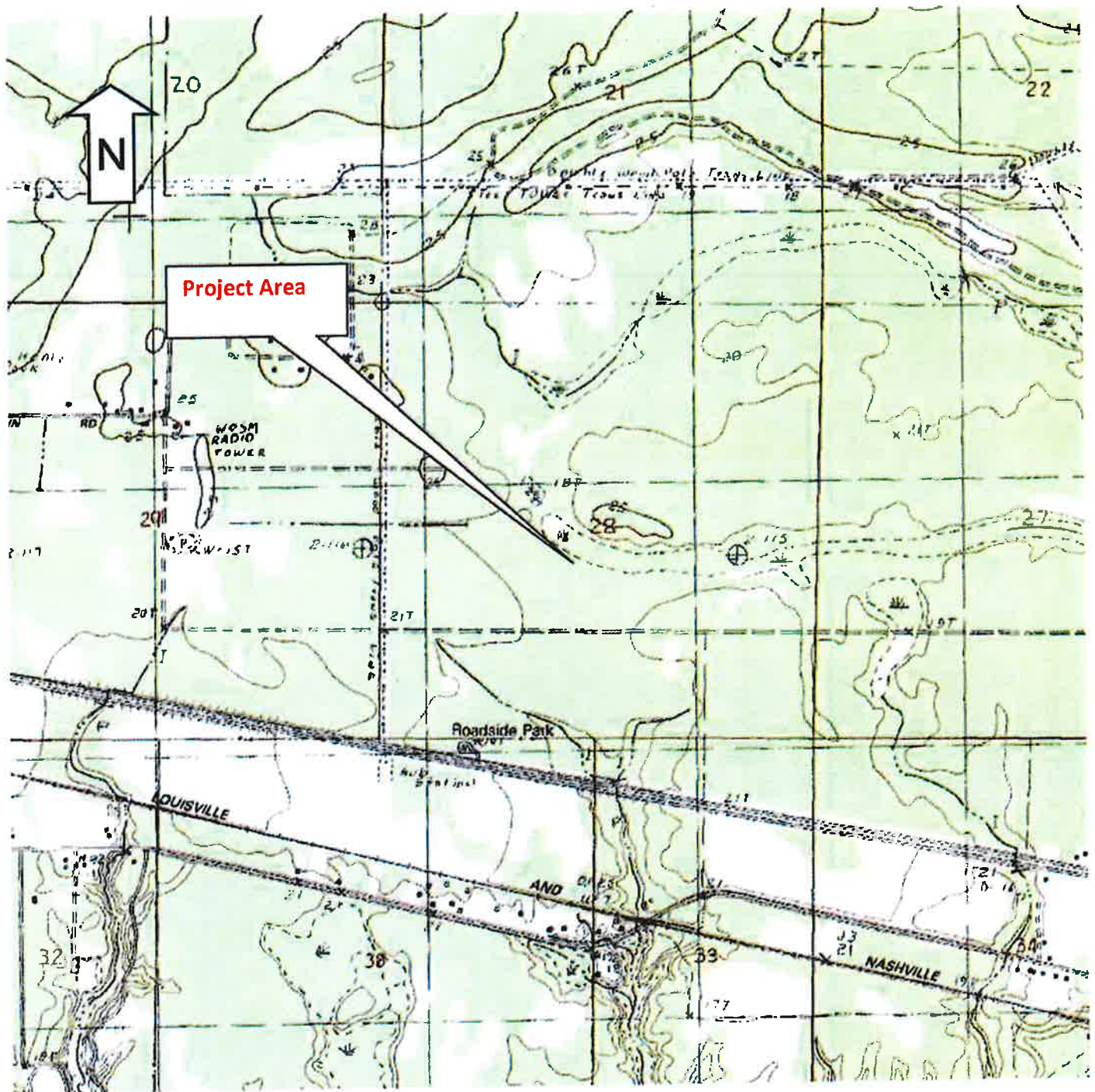

COMPTON ENGINEERING, INC.
Engineering, Surveying, and Environmental Services
156 Nixon Street
Biloxi, Mississippi 39530
Phone: (228) 432-2133 Fax: (228) 432-8149
E-mail: compton@comptonengineering.com

Site: Gautier Soccer Fields Wetland
Delineation
Audubon Lane
Gautier, Jackson County, MS

Figure Title: **Topographic Map** (Map Source: MyTopo Map Pass. Photo Date: September 9, 2012)

Appendix ID:
A

DEPARTMENT OF THE ARMY
SAM-2018-1168-APS