

Notice to Navigation interests



U.S. ARMY CORPS OF ENGINEERS

BUILDING STRONG®

August 2, 2013

TECHNICAL SUPPORT BRANCH

NAVIGATION BULLETIN NO. 13-24

NOTICE TO NAVIGATION INTERESTS:

GULF INTRACOASTAL WATERWAY, FLORIDA

Reference Navigation Bulletin Nos. 13-19, 13-21, and 13-23.

Notice is given to mariners that Inland Dredging Company's dredge "INTEGRITY" completed dredging the channel blockage at Mile 263. The shoaled material immediately adjacent to the slope failure was completely removed; however, debris from the slope material may still lie outside the channel so mariners should use caution.

Some material from the slope failure migrated just east of the site leaving depths of 10 feet or greater, as shown on the attached hydrographic survey. This area will be periodically surveyed to monitor changes and the surveys will be posted on our website:

<http://navigation.sam.usace.army.mil/surveys/index.asp>

Mariners are urged to use extreme caution when transiting this area. For further information, please contact the U.S. Army Corps of Engineers, Panama City Site Office at (850) 784-9780.

Codes A3 and A10



CARL E. DYESS
Chief, Navigation Section

U.S. ARMY CORPS OF ENGINEERS – MOBILE DISTRICT

P.O. BOX 2288, MOBILE, AL. 36628-0001

<http://sam.usace.army.mil/>

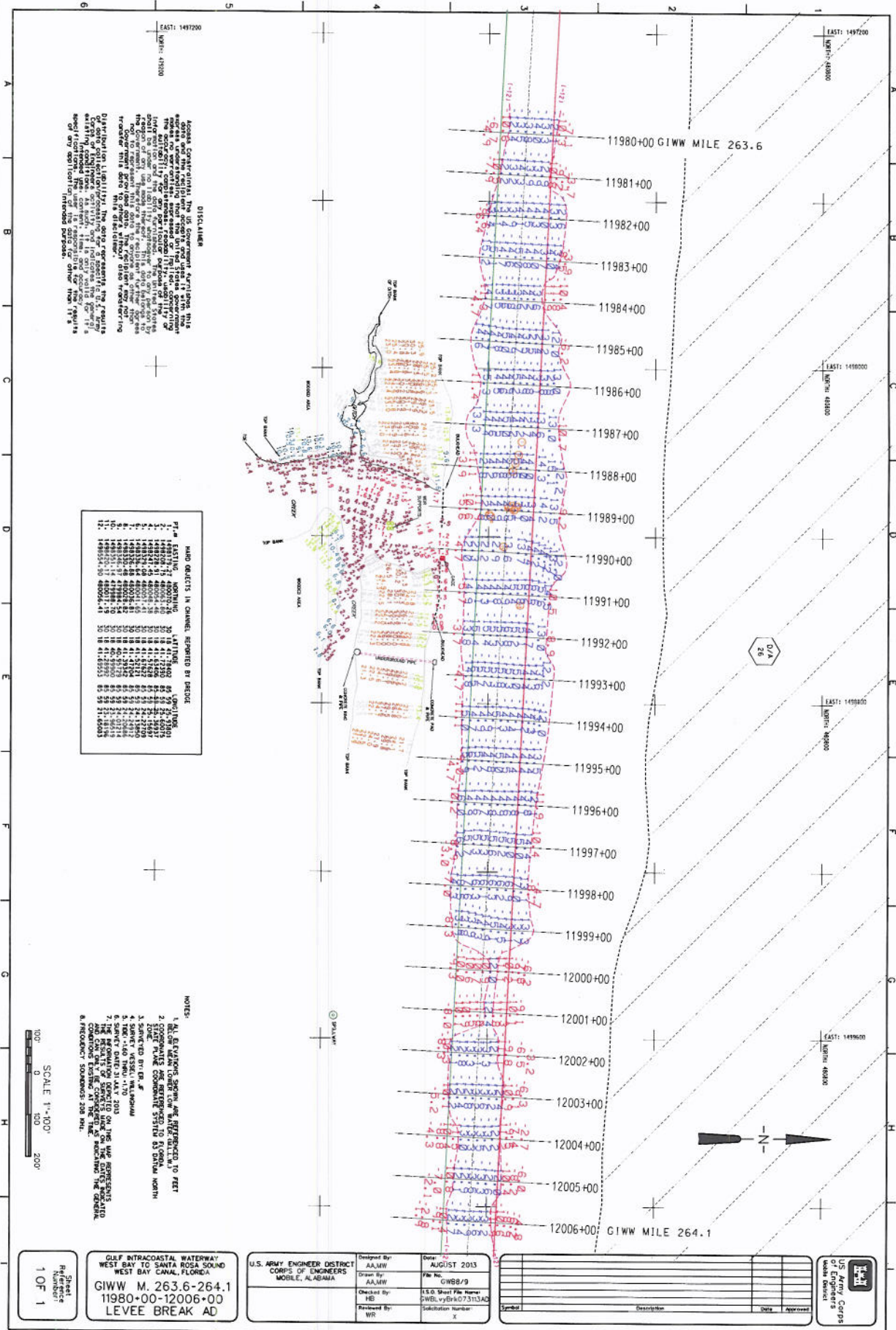
Attn: OP-TN



DISCLAIMER

Accora Corporation, The US Government, and its agents, contractors, and subcontractors, make no warranty, express or implied, for the use of the data for any purpose other than that for which it was collected. The data is provided "AS IS" and "AS AVAILABLE" without any representation or warranty of accuracy, completeness, or timeliness. The user of the data is responsible for the accuracy, completeness, and timeliness of the data. The user of the data is responsible for the accuracy, completeness, and timeliness of the data. The user of the data is responsible for the accuracy, completeness, and timeliness of the data.

FILE EASTING, NORTHING

1	1489175.00	480071.25
2	1489175.00	480071.25
3	1489175.00	480071.25
4	1489175.00	480071.25
5	1489175.00	480071.25
6	1489175.00	480071.25
7	1489175.00	480071.25
8	1489175.00	480071.25
9	1489175.00	480071.25
10	1489175.00	480071.25
11	1489175.00	480071.25
12	1489175.00	480071.25

- NOTES**
1. ALL ELEVATIONS SHOWN ARE REFERENCED TO MEAN SEA LEVEL.
 2. ALL SOUNDINGS ARE REFERENCED TO MEAN SEA LEVEL.
 3. SPREED SHEET.
 4. SPREED SHEET, WASHINGTON.
 5. SPREED SHEET, WASHINGTON.
 6. SPREED SHEET, WASHINGTON.
 7. THE INFORMATION SHOWN ON THIS MAP REPRESENTS THE BEST AVAILABLE DATA AS OF THE DATE OF SURVEY.
 8. PRECISION: SOUNDINGS: 0.5M.



Sheet Reference
1 OF 1

GULF INTRACOASTAL WATERWAY
WEST BAY TO SANTA ROSA SOUND
WEST BAY CANAL, FLORIDA
GIWW M. 263.6-264.1
11980+00-12006+00
LEVEE BREAK AD

U.S. Army Engineer District
CORPS OF ENGINEERS
MOBILE, ALABAMA

Designed By: AAMW
Drawn By: AAMW
Checked By: HE
Reviewed By: WJ
Date: AUGUST 2013
File No.: GWSB/19
U.S.G. Sheet File Name: GWSB.vyErk07313AD
Solicitation Number: X

Symbol	Description	Date	Approved

U.S. Army Corps of Engineers
Mobile District