



US Army Corps
of Engineers
Mobile District

Symbol	Description	Date	Approved

Designed By:	Date:	File No.
	07 MAY 2019	
Drawn By: <th colspan="2">U.S.O. Sheet File Name:</th>	U.S.O. Sheet File Name:	
G. KELLY		
Checked By: <th colspan="2">Station Number:</th>	Station Number:	
J. BROWN		
Reviewed By: <td colspan="2"> </td>		
J. OLIVER		

TENNESSEE TOMBIGEE WATERWAY
COLUMBUS LAKE
C019_3550_3560_24APRIL2019
MI 355.0 TO MI 356.0
CONDITION SURVEY

Sheet
Reference
Number:
19 OF 20

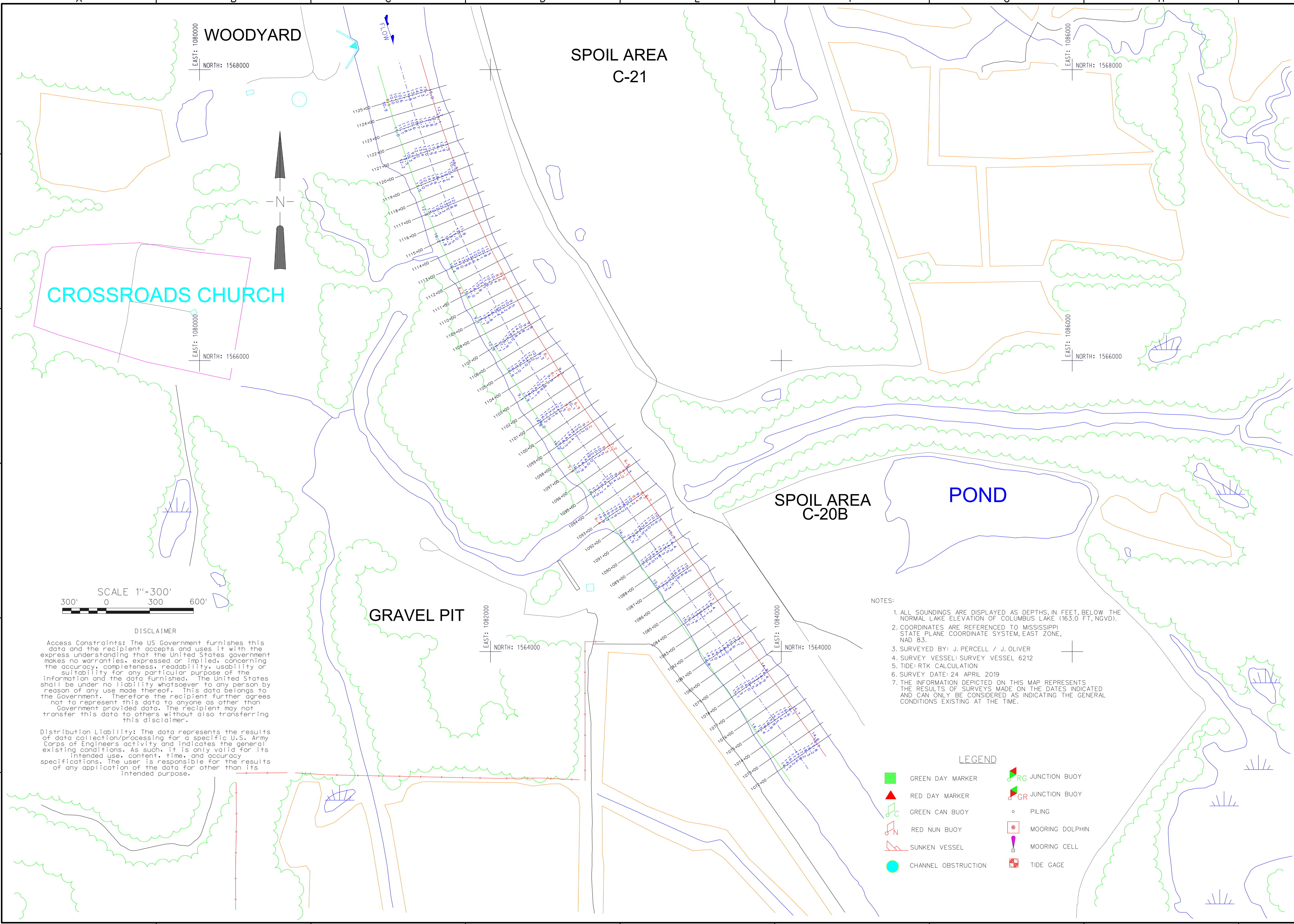

NOTES:

- ALL SOUNDINGS ARE DISPLAYED AS DEPTHS, IN FEET, BELOW THE NORMAL LAKE ELEVATION OF COLUMBUS LAKE (163.0 FT, NGVD).
- COORDINATES ARE REFERENCED TO MISSISSIPPI STATE PLANE COORDINATE SYSTEM, EAST ZONE, NAD 83.
- SURVEYED BY: J. PERCELL / J. OLIVER
- SURVEY VESSEL: SURVEY VESSEL 6212
- TIDE: RTK CALCULATION
- SURVEY DATE: 24 APRIL 2019
- THE INFORMATION DEPICTED ON THIS MAP REPRESENTS THE RESULTS OF SURVEYS MADE ON THE DATES INDICATED AND CAN ONLY BE CONSIDERED AS INDICATING THE GENERAL CONDITIONS EXISTING AT THE TIME.

LEGEND	
	GREEN DAY MARKER
	RED DAY MARKER
	GREEN CAN BUOY
	RED NUN BUOY
	SUNKEN VESSEL
	CHANNEL OBSTRUCTION
	JUNCTION BUOY
	JUNCTION BUOY
	PILING
	MOORING DOLPHIN
	MOORING CELL
	TIDE GAGE

DISCLAIMER

Access Constraints: The US Government furnishes this data and the recipient accepts and uses it with the express understanding that the United States government makes no warranties, expressed or implied, concerning the accuracy, completeness, readability, usability or suitability for any particular purpose of the information and the data furnished. The United States shall be under no liability whatsoever to any person by reason of any use made thereof. This data belongs to the Government. Therefore the recipient further agrees not to represent this data to anyone as other than Government provided data. The recipient may not transfer this data to others without also transferring this disclaimer.

Distribution Liability: The data represents the results of data collection/processing for a specific U.S. Army Corps of Engineers activity and indicates the general existing conditions. As such, it is only valid for its intended use, content, time, and accuracy specifications. The user is responsible for the results of any application of the data for other than its intended purpose.

