

Date	File No.	U.S.O. Sheet File Name	Description
08 NOV 2018			

Designed By:	Drawn By:	Checked By:	Reviewed By:
	G. KELLY	J. BROWN	J. OLIVER

TENNESSEE TOMBIGBEE WATERWAY
ALICEVILLE LAKE
AL06_3140-3155_08NOV2018
MI 314.0 TO MI 315.5
CONDITION SURVEY

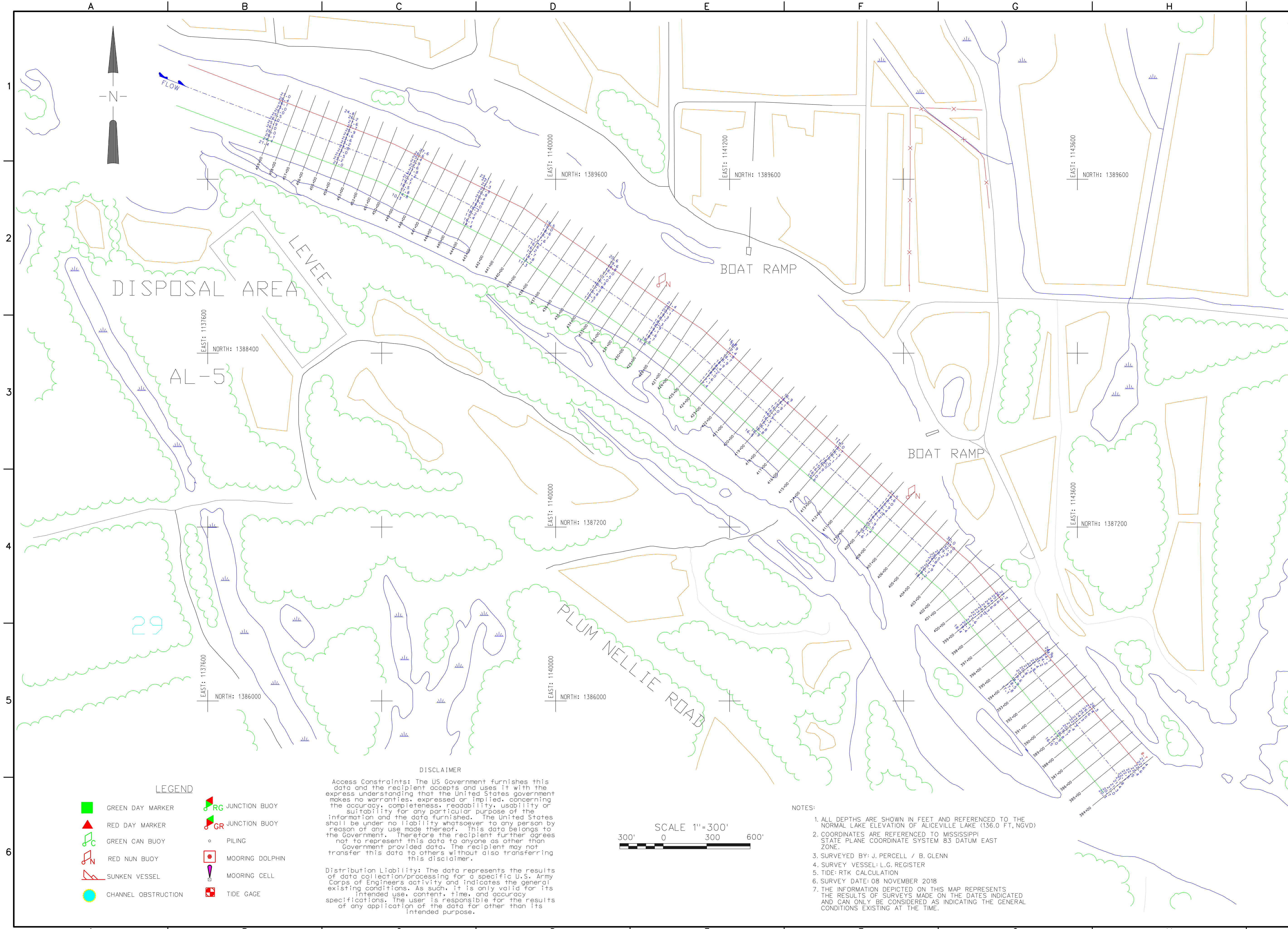

LEGEND

	GREEN DAY MARKER		GR JUNCTION BUOY
	RED DAY MARKER		GR JUNCTION BUOY
	GREEN CAN BUOY		PILING
	RED NUN BUOY		MOORING DOLPHIN
	SUNKEN VESSEL		MOORING CELL
	CHANNEL OBSTRUCTION		TIDE GAGE

DISCLAIMER

Access Constraints: The US Government furnishes this data and the recipient accepts and uses it with the express understanding that the United States government makes no warranties, expressed or implied, concerning the accuracy, completeness, readability, usability or suitability for any particular purpose of the information and the data furnished. The United States shall be under no liability whatsoever to any person by reason of any use made thereof. This data belongs to the Government. Therefore the recipient further agrees not to represent this data to anyone as other than Government provided data. The recipient may not transfer this data to others without also transferring this disclaimer.

Distribution Liability: The data represents the results of data collection/processing for a specific U.S. Army Corps of Engineers activity and indicates the general existing conditions. As such, it is only valid for its intended use, content, time, and accuracy specifications. The user is responsible for the results of any application of the data for other than its intended purpose.

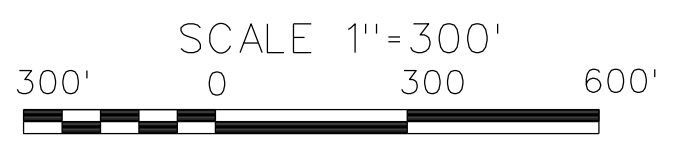

- NOTES:**
- ALL DEPTHS ARE SHOWN IN FEET AND REFERENCED TO THE NORMAL LAKE ELEVATION OF ALICEVILLE LAKE (136.0 FT. NGVD)
 - COORDINATES ARE REFERENCED TO MISSISSIPPI STATE PLANE COORDINATE SYSTEM 83 DATUM EAST ZONE.
 - SURVEYED BY: J. PERCELL / B. GLENN
 - SURVEY VESSEL: L.G. REGISTER
 - TIDE: RTK CALCULATION
 - SURVEY DATE: 08 NOVEMBER 2018
 - THE INFORMATION DEPICTED ON THIS MAP REPRESENTS THE RESULTS OF SURVEYS MADE ON THE DATES INDICATED AND CAN ONLY BE CONSIDERED AS INDICATING THE GENERAL CONDITIONS EXISTING AT THE TIME.