

US Army Corps of Engineers  
Mobile District

Symbol	Description	Date	Approved

U.S. ARMY ENGINEER DISTRICT CORPS OF ENGINEERS MOBILE, ALABAMA	Designed By:	Date:
G. KELLY	G. KELLY	03 AUG 2017
J. OLIVER	J. OLIVER	03 AUG 2017

TENNESSEE TOMBIGBEE WATERWAY GAINESVILLE LAKE MI 290.5 TO MI 293.0 CONDITION SURVEY	Drawn By:	File No.:
G. KELLY	G. KELLY	GA18-2905-2930-21JUL2017
J. OLIVER	J. OLIVER	GA18-2905-2930-21JUL2017

Sheet Reference Number:
18 OF 28

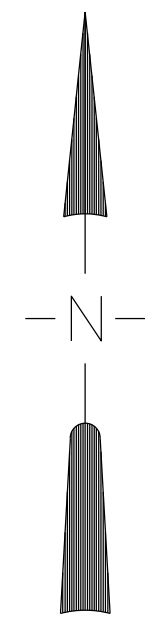
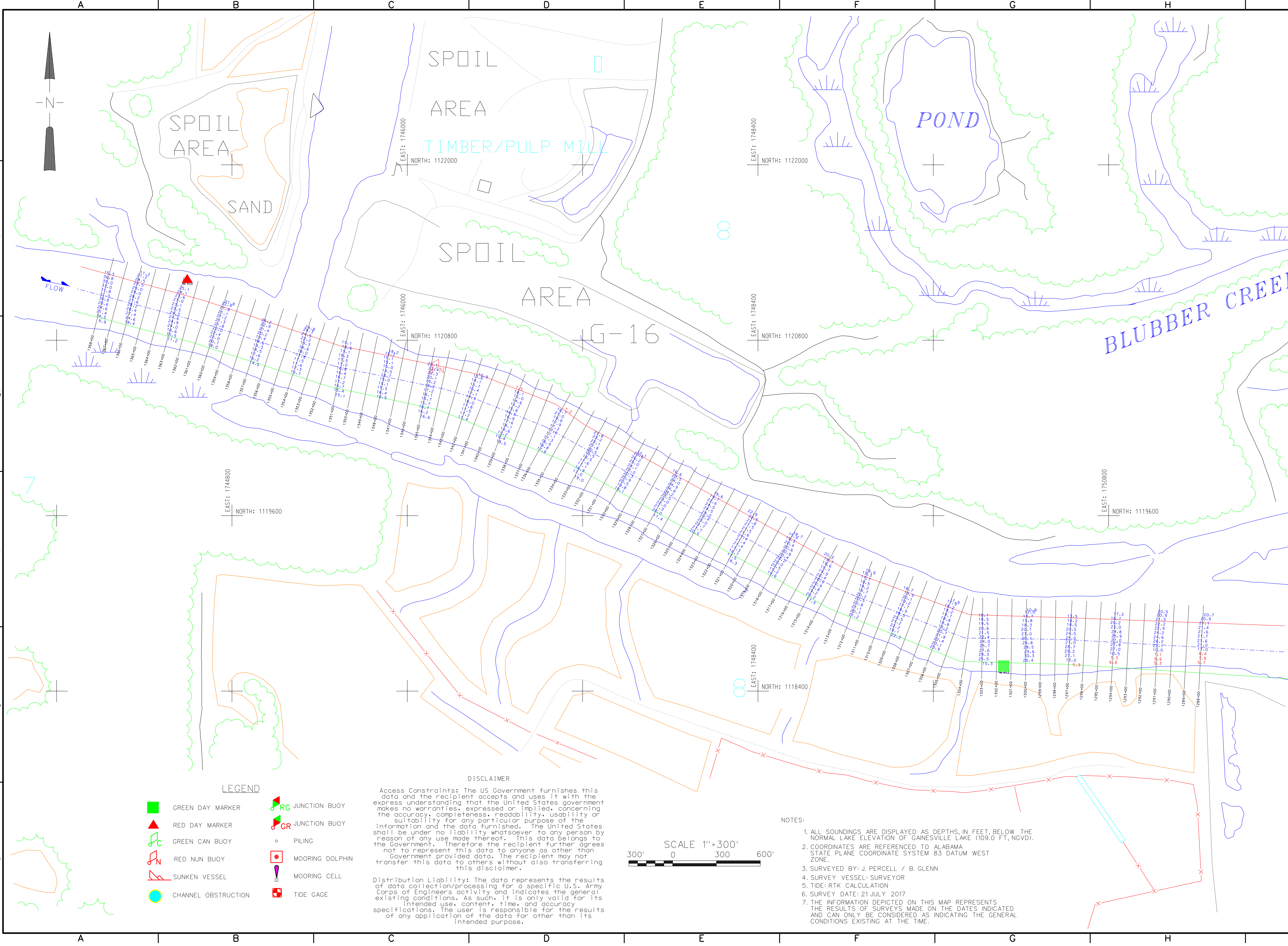

**LEGEND**

	GREEN DAY MARKER		RED DAY MARKER		GREEN CAN BUOY		RED NUN BUOY		SUNKEN VESSEL		CHANNEL OBSTRUCTION		JUNCTION BUOY		JUNCTION BUOY		PILING		MOORING DOLPHIN		MOORING CELL		TIDE GAGE
--	------------------	--	----------------	--	----------------	--	--------------	--	---------------	--	---------------------	--	---------------	--	---------------	--	--------	--	-----------------	--	--------------	--	-----------

**DISCLAIMER**

Access Constraints: The US Government furnishes this data and the recipient accepts and uses it with the express understanding that the United States government makes no warranties, expressed or implied, concerning the accuracy, completeness, readability, usability or suitability for any particular purpose of the information and the data furnished. The United States shall be under no liability whatsoever to any person by reason of any use made thereof. This data belongs to the Government. Therefore the recipient further agrees not to represent this data to anyone as other than Government provided data. The recipient may not transfer this data to others without also transferring this disclaimer.

Distribution Liability: The data represents the results of data collection/processing for a specific U.S. Army Corps of Engineers activity and indicates the general existing conditions. As such, it is only valid for its intended use, content, time, and accuracy specifications. The user is responsible for the results of any application of the data for other than its intended purpose.

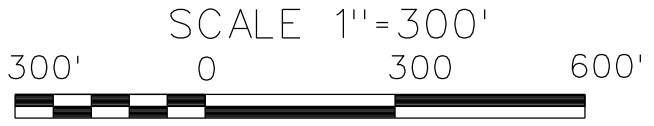

- NOTES:**
- ALL SOUNDINGS ARE DISPLAYED AS DEPTHS, IN FEET, BELOW THE NORMAL LAKE ELEVATION OF GAINESVILLE LAKE (109.0 FT, NGVD).
  - COORDINATES ARE REFERENCED TO ALABAMA STATE PLANE COORDINATE SYSTEM 83 DATUM WEST ZONE.
  - SURVEYED BY: J. PERCELL / B. GLENN
  - SURVEY VESSEL: SURVEYOR
  - TIDE: RTK CALCULATION
  - SURVEY DATE: 21 JULY 2017
  - THE INFORMATION DEPICTED ON THIS MAP REPRESENTS THE RESULTS OF SURVEYS MADE ON THE DATES INDICATED AND CAN ONLY BE CONSIDERED AS INDICATING THE GENERAL CONDITIONS EXISTING AT THE TIME.