



REPLY TO
ATTENTION OF:

DEPARTMENT OF THE ARMY
U.S. ARMY ENGINEER DISTRICT, MOBILE DISTRICT
P.O. BOX 2288
MOBILE, ALABAMA 36628-0001

CESAM-RD-IN
PUBLIC NOTICE NO. SAM2011-00660-JMT

June 21, 2011

**PUBLIC NOTICE
U.S. ARMY CORPS OF ENGINEERS**

**MISSISSIPPI DEPARTMENT OF ENVIRONMENTAL QUALITY
OFFICE OF POLLUTION CONTROL**

**PROPOSED FILL OF WETLANDS AND AN INTERMITTENT STREAM FOR THE
EXPANSION OF AN EXISTING RAILWAY YARD, LOWNDES COUNTY, MISSISSIPPI**

TO WHOM IT MAY CONCERN:

This District has received an application for a Department of the Army permit pursuant to Section 10 of the River and Harbor Act of 1899 (33 USC 403), and Section 404 of the Clean Water Act (33 USC 1344). Please communicate this information to interested parties.

APPLICANT: Kansas City Southern Railway Company
Attention: Mr. Lee Peek
Post Office Box 219335
Kansas City, Missouri 64121-9335

AGENT: Wildlife Technical Services, Inc.
Attention: Mr. J. Clay Cromwell
Post Office Box 820188
Vicksburg, Mississippi 39182-0188

LOCATION OF WORK: The project is located on Artesia Road East near the community of Artesia in Sections 16, 17, and 20, Township 18 North, Range 16 East, Lowndes County, Mississippi (N 33.423365, W -88.627318).

PROJECT PURPOSE: The project purpose is to expand an existing railway yard.

June 21, 2011

PROPOSED WORK: The applicant is seeking authorization to fill wetlands and waters located within an eighty-five foot work zone south of the existing tracks.

No formal determination has been made to the exact extent of filling impacts at the time of this notice. Impacts submitted by the applicant's agent are identified on the enclosed Wetland Location Worksheet. The applicant has proposed purchasing wetland credits from an approved wetland mitigation bank for wetland losses and conducting on-site stream mitigation for stream impacts.

The applicant has applied for state water quality (WQ) certification in accordance with Section 401(a)(1) of the Clean Water Act. Upon completion of the required advertising, and public comment review, a determination relative to WQ certification will be made by the Mississippi Department of Environmental Quality.

This public notice is being distributed to all known interested persons in order to assist in developing facts on which a decision by the U.S. Army Corps of Engineers (Corps) can be based. For accuracy and completeness of the record, all data in support of or in opposition to the proposed work should be submitted in writing setting forth sufficient detail to furnish a clear understanding of the reasons for support or opposition. The decision whether to issue a permit will be based on an evaluation of the probable impact, including cumulative impacts, of the proposed activity on the public interest. That decision will reflect the national concern for both protection and utilization of important resources.

The benefit which reasonably may be expected to accrue from the proposal must be balanced against its reasonably foreseeable detriments. All factors which may be relevant to the proposal will be considered, including the cumulative effects thereof; among those are conservation, economics, aesthetics, general environmental concerns, wetlands, cultural values, fish and wildlife values, flood hazards, flood plain values, land use, navigation, shoreline erosion and accretion, recreation, water supply and conservation, water quality, energy needs, safety, food production, and in general, the needs and welfare of the people.

The Corps is soliciting comments from the public; Federal, State, and local agencies and officials; Indian Tribes; and other interested parties in order to consider and evaluate the impacts of this proposed activity. Any comments received will be considered by the Corps to determine whether to issue, modify, condition or deny a permit for this proposal. To make this decision, comments are used to assess impacts on endangered species, historic properties, water quality, general environmental effects, and the other public interest factors listed above. Comments are used in the

CESAM-RD-I N
PUBLIC NOTICE NO. SAM2011-00660-JMT

June 21, 2011

preparation of an Environmental Assessment and/or an Environmental Impact Statement pursuant to the National Environmental Policy Act. Comments are also used to determine the need for a public hearing and to determine the overall public interest of the proposed activity.

Any person may request, in writing, within the comment period specified in this notice, that a public hearing be held to consider this application. Requests for public hearings shall state with particularity, the reasons for holding a public hearing.

Evaluation of the probable impacts involving deposits of dredged or fill material into waters of the United States will include the application of guidelines established by the Administrator of the U.S. Environmental Protection Agency.

In accordance with Section 106 of the National Historic Preservation Act, and Appendix C of 33 CFR 325, the undertaking defined in this notice is being considered for the potential to effect cultural and historic properties within the permit area. Although the extent of federal control and responsibility for these considerations are confined to the limits of the permit area for this particular project, the potential indirect effects that may occur to historic properties as a result of this undertaking are also being considered. We are seeking comment from the State Historic Preservation Officer, federally-recognized American Indian tribes, local historical societies, museums, universities, the National Park Service, and concerned citizens regarding the existence or the potential for existence of significant cultural and historic properties within the permit area. Historic architectural or archaeological investigations may be necessary to ascertain the existence of such resources. Efforts will be made through the consultation process to avoid, minimize, or mitigate any adverse effects to significant cultural and historic properties that may occur as a result of this undertaking. The district engineer remains the final decision authority.

Correspondence concerning this Public Notice should refer to Public Notice Number **SAM2011-00660-JMT** and should be directed to:

U.S. Army Engineer District, Mobile
Attention: Mr. Joe Tanko
218 Summit Parkway, Suite 222
Birmingham, Alabama 35209

CESAM-RD-IN
PUBLIC NOTICE NO. SAM2011-00660-JMT

June 21, 2011

With a Copy to:

Mississippi Department of Environmental Quality
Office of Pollution Control
Post Office Box 10385
Jackson, Mississippi 39289

Comments should be received no later than **21 days** from the date of this Public notice.

If you have any questions concerning this publication, you may contact the project manager via e-mail at **joseph.m.tanko@usace.army.mil** or telephone number **(205) 290-9096**. Please refer to the above Public Notice number.

For additional information about our Regulatory Program, please visit our web site at www.sam.usace.army.mil/RD/reg, and please take a moment to complete our customer satisfaction survey while you are there. Your responses are appreciated and will allow us to improve our services.

Enclosures

MOBILE DISTRICT
U.S. Army Corps of Engineer



U.S.G.S. Artesia & Bent
Oak, Mississippi

Kansas City Southern Railway
Artesia Yard Expansion
Lowndes County, Mississippi
General Location Map

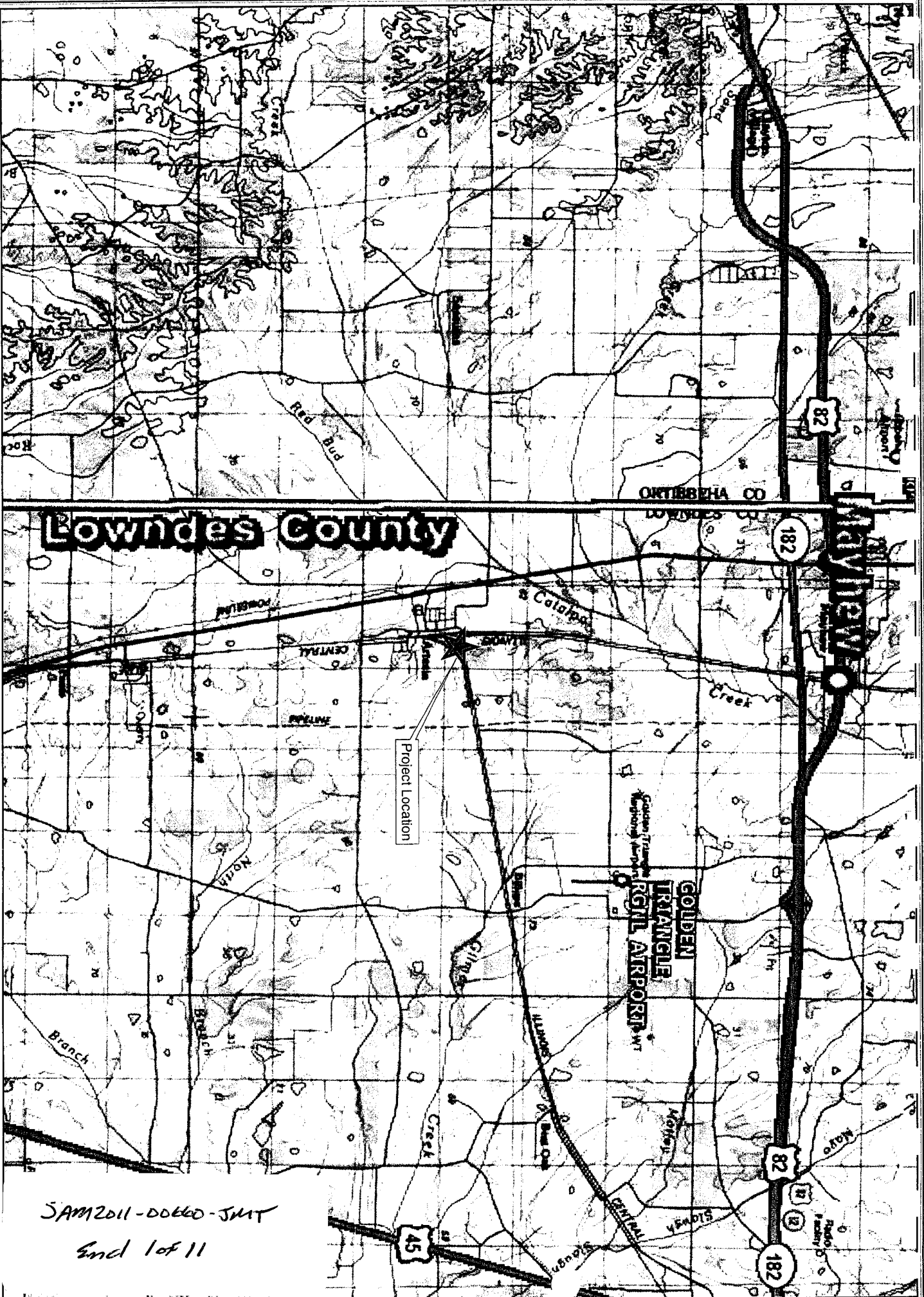
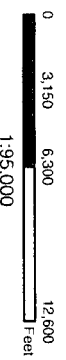

SAM2011-00660-SMT
End 1 of 11



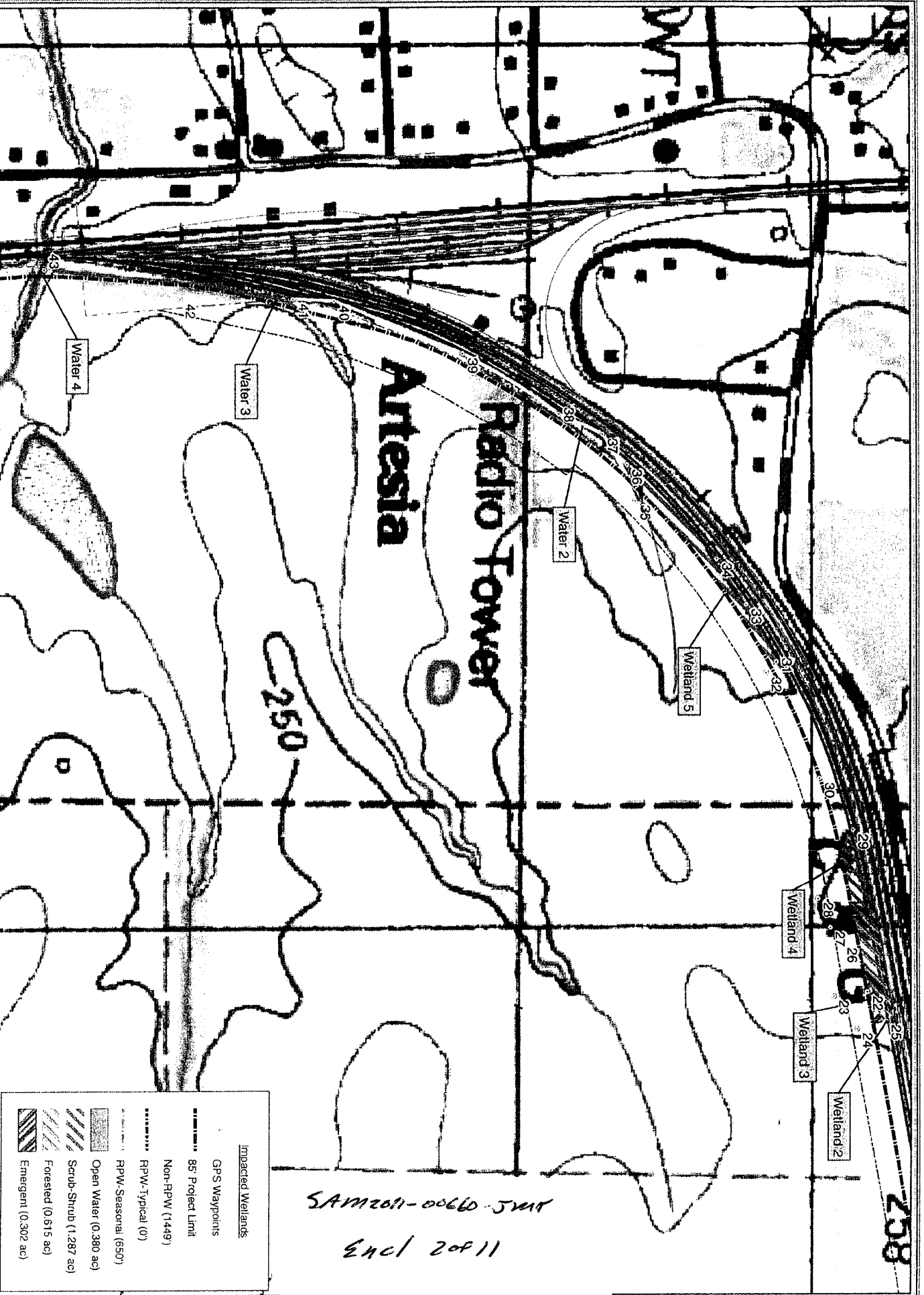

SAM2011-00660-5.mxd
 Encl 2011

	Impacted Wetlands
	GPS Waypoints
	85' Project Limit
	Non-RPW (1449')
	RPW-Typical (0')
	RPW-Seasonal (650')
	Open Water (0.380 ac)
	Scrub-Shrub (1.287 ac)
	Forested (0.615 ac)
	Emergent (0.302 ac)

Wildlife Technical Services, Inc.
 www.wildlifetechnical.com

U.S.G.S. Artesia & Bent
 Oak, Mississippi

Kansas City Southern Railway
 Artesia Yard Expansion Project
 Lowndes County, Mississippi
 GPS/Wetland Location Map

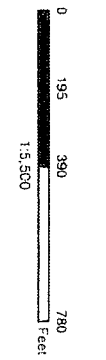

6/15/2011 - AS

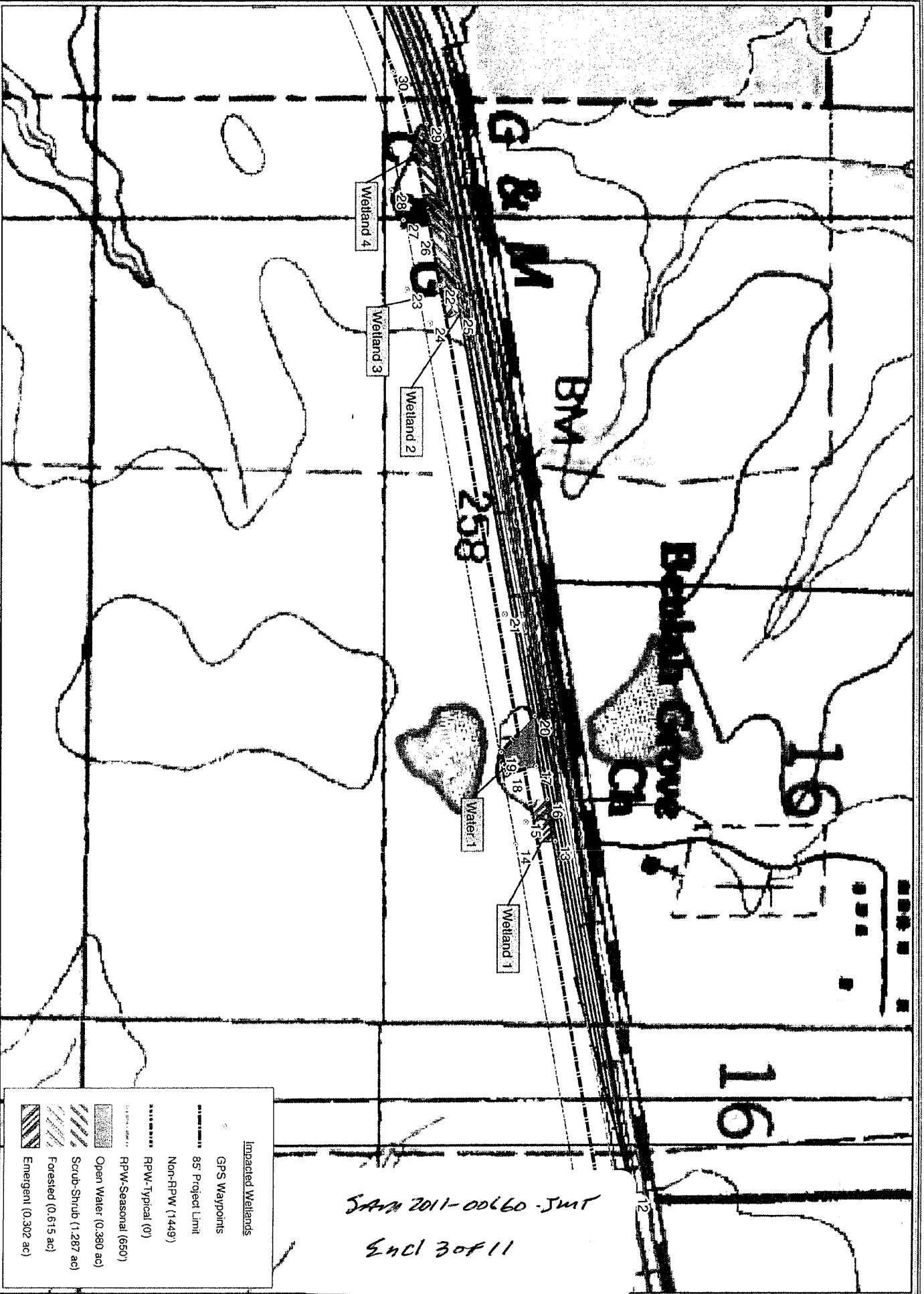

	Impacted Wetlands
	GPS Waypoints
	85' Project Limit
	Non-RPW (1449)
	RPW-Typical (0)
	RPW-Seasonal (650)
	Open Water (0.360 ac)
	Scrub-Shrub (1.287 ac)
	Forested (0.615 ac)
	Emergent (0.302 ac)

SAM 2011-00660 -JMT
Encl 3 of 11



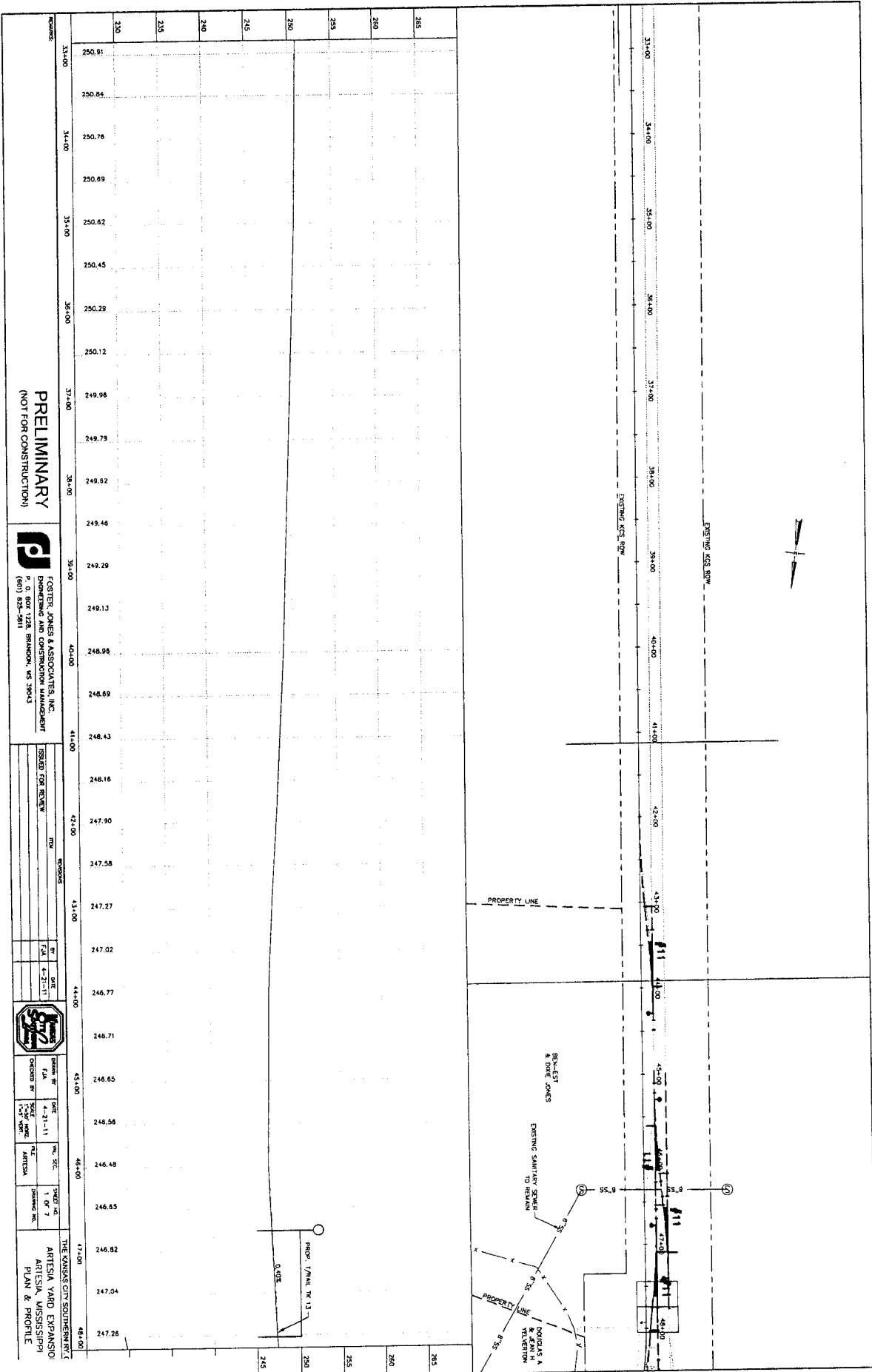

SAM 2011-0660 - JMT

PAGE 5 OF 11

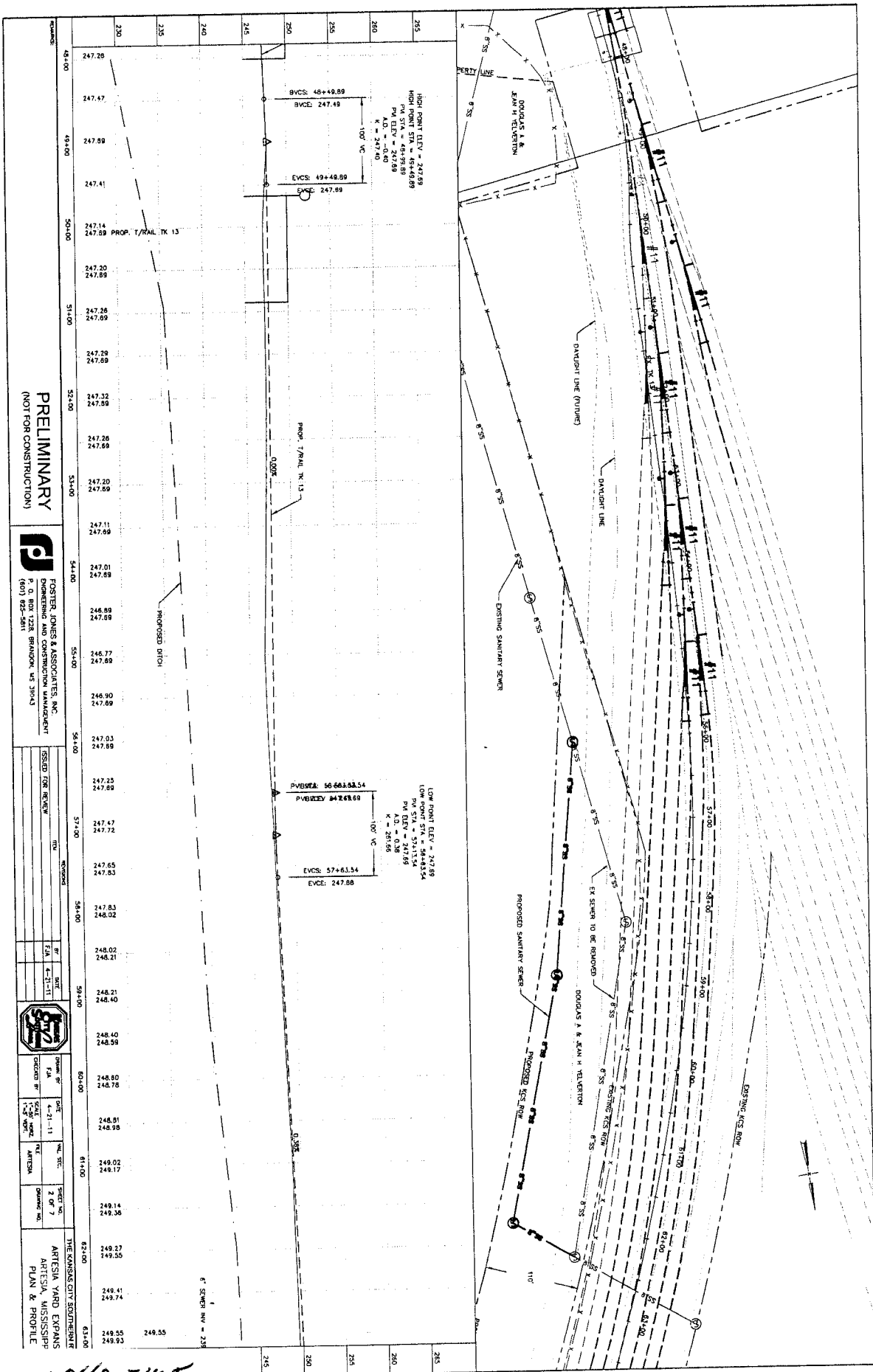

STATIONING	ELEVATION	REMARKS
44+00	247.28	
44+00	247.47	
44+00	247.59	
44+00	247.41	
50+00	247.14	
50+00	247.59	PROP. TYPICAL TK 13
51+00	247.20	
51+00	247.85	
51+00	247.26	
51+00	247.69	
52+00	247.20	
52+00	247.59	
52+00	247.32	
52+00	247.80	
52+00	247.26	
52+00	247.59	
53+00	247.20	
53+00	247.59	
53+00	247.11	
53+00	247.69	
54+00	247.01	
54+00	247.59	
54+00	246.89	
54+00	247.59	
54+00	246.77	
54+00	247.59	
54+00	246.90	
54+00	247.59	
54+00	247.03	
54+00	247.59	
54+00	247.25	
54+00	247.89	
57+00	247.47	
57+00	247.72	
57+00	247.65	
57+00	247.83	
58+00	247.53	
58+00	246.02	
58+00	248.02	
58+00	248.21	
59+00	248.21	
59+00	248.40	
59+00	248.40	
59+00	248.59	
59+00	248.80	
59+00	248.78	
60+00	248.81	
60+00	248.98	
60+00	249.02	
61+00	249.17	
61+00	249.14	
61+00	249.36	
62+00	249.27	
62+00	249.55	
62+00	249.41	
62+00	249.74	
63+00	249.55	
63+00	249.55	
63+00	249.55	

PRELIMINARY
(NOT FOR CONSTRUCTION)



FOSTER, JONES & ASSOCIATES, INC.
ENGINEERING AND CONSTRUCTION MANAGEMENT
P. O. BOX 1228 BRANSON, MO 64617
(417) 822-5811

ISSUED FOR REVIEW

NO.	DATE	BY	REVISION
1	4-21-11	EA	ISSUED FOR REVIEW



NO.	DATE	BY	REVISION
1	4-21-11	EA	ISSUED FOR REVIEW

THE KANSAS CITY SOUTHERN
ARTESIA YARD EXPANSION
ARTESIA, MISSISSIPPI
PLAN & PROFILE

SAN 2011-00660-JMT
EML 60811

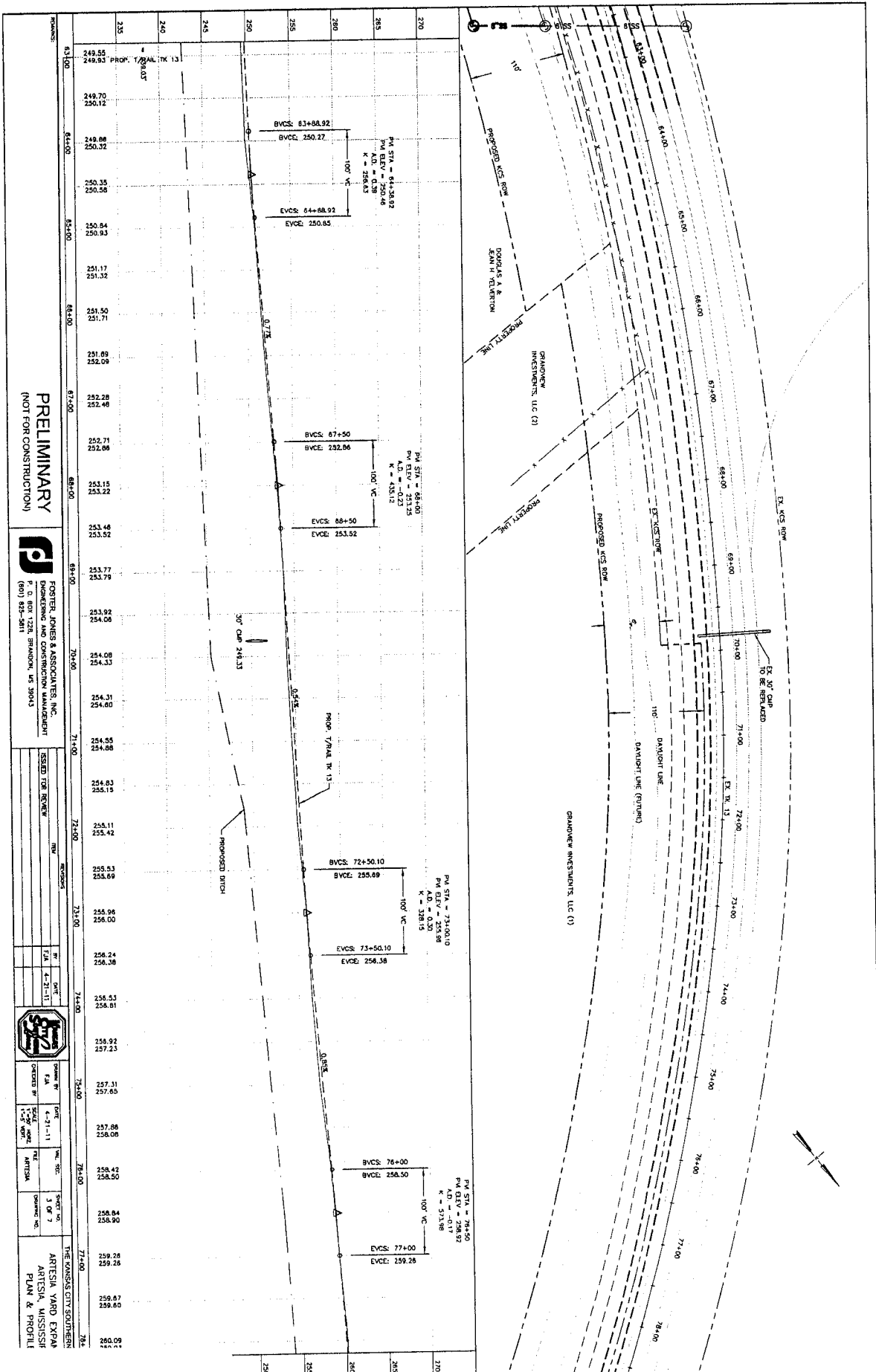

PRELIMINARY
(NOT FOR CONSTRUCTION)



FOSTER JONES & ASSOCIATES, INC.
ENGINEERING AND CONSTRUCTION MANAGEMENT
P. O. BOX 1226, BRANSON, MO 64616
(800) 828-5811

DESIGNED FOR REVIEW
DATE: 4-21-11

NO.	DATE	BY	CHKD.	APP.
1	4-21-11	JMT		



PROJECT NO. 06660
DATE: 4-21-11
SCALE: AS SHOWN
SHEET NO. 7 OF 7

THE KANSAS CITY SOUTHERN
ARTESIA YARD EXPAN
ARTESIA, MISSISSIP
PLAN & PROFILE

5AM2011-06660-JMT
SHEET 7 OF 11

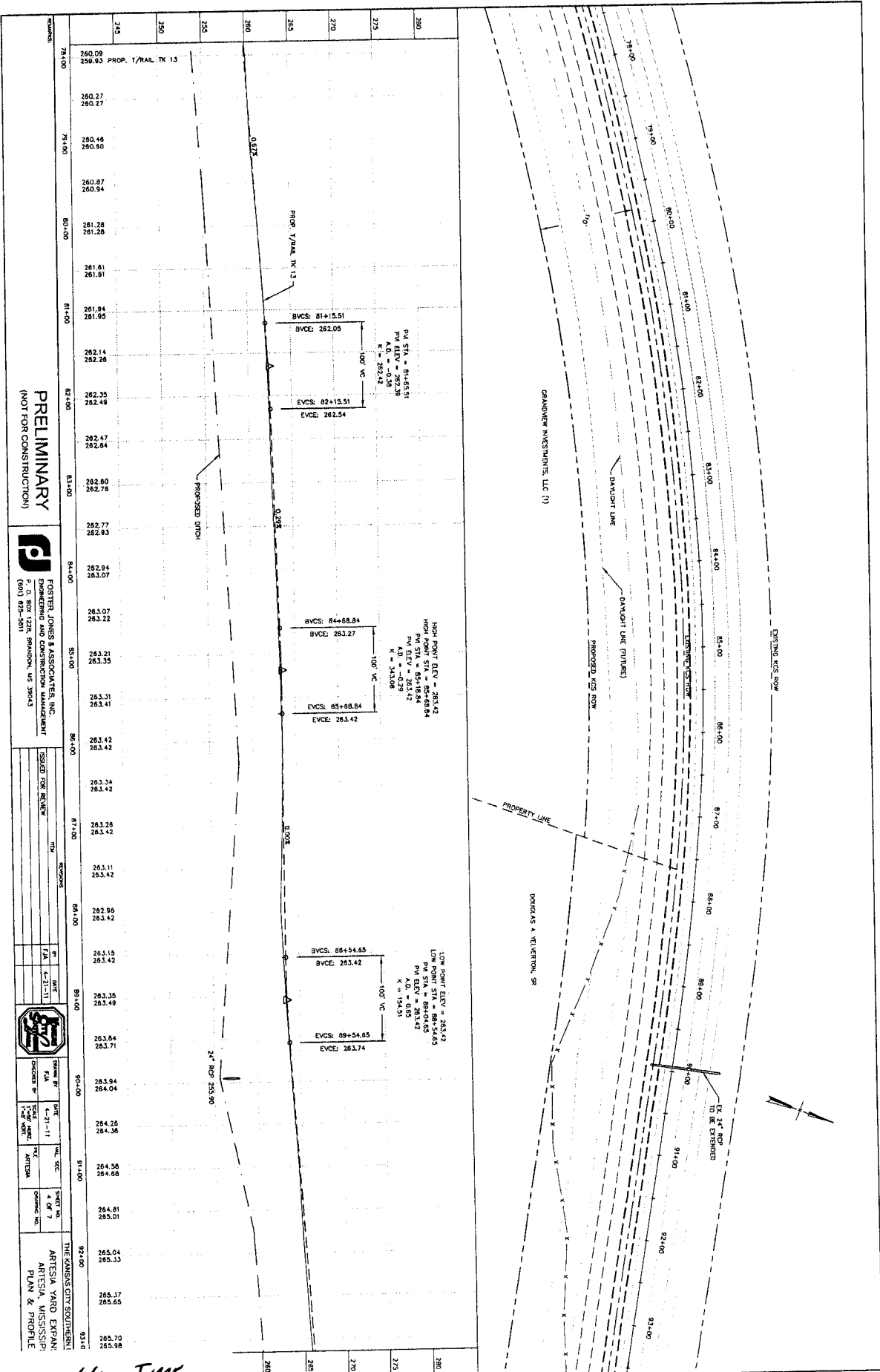

PRELIMINARY
(NOT FOR CONSTRUCTION)



FOSTER JONES & ASSOCIATES, INC.
ENGINEERING AND CONSTRUCTION MANAGEMENT
P. O. BOX 1226, SHAWANO, WI 53084
(608) 623-5811

ISSUED FOR REVIEW

DATE: 10/21/11

BY: [Signature]

DATE: 10/21/11

BY: [Signature]

DATE: 10/21/11

BY: [Signature]

DATE: 10/21/11

BY: [Signature]

THE KANSAS CITY SOUTHERN
ARTESIA YARD EXPAN.
ARTESIA, MISSISSIPPI
PLAN & PROFILE

5AM 2011-0066-JMT

Incl 8 of 11

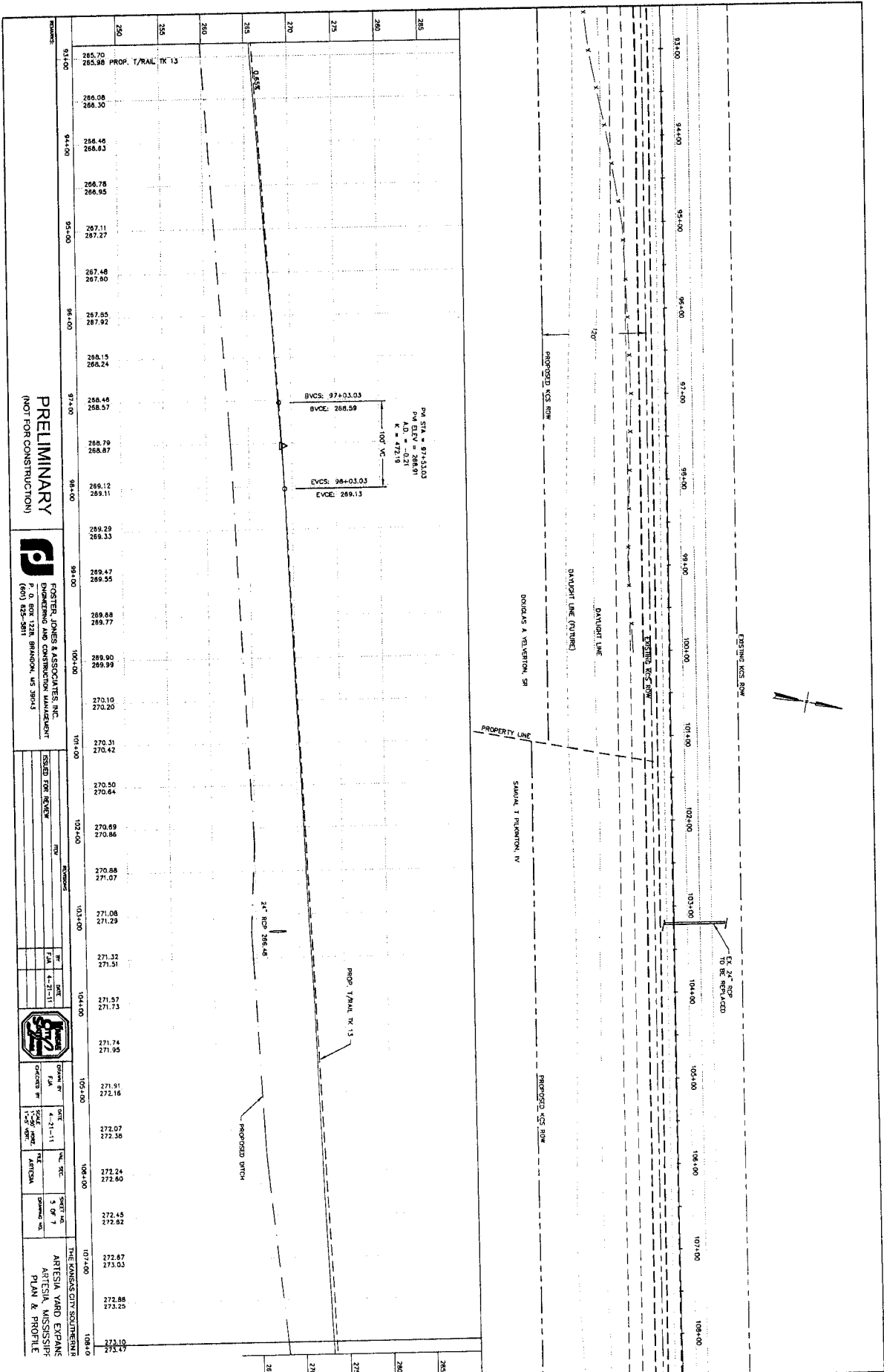

PRELIMINARY
(NOT FOR CONSTRUCTION)

FOSTER, JONES & ASSOCIATES, INC.
ENGINEERING AND CONSTRUCTION MANAGEMENT
P. O. BOX 1218, BRANSON, MO 64614
(660) 622-9811

Station	Proposed	Existing	Notes
93+00			
94+00			
95+00			
96+00			
97+00			
98+00			
99+00			
100+00			
101+00			
102+00			
103+00			
104+00			
105+00			
106+00			
107+00			
108+00			

SAM 2011-0660-JMT

Encl 9 of 11

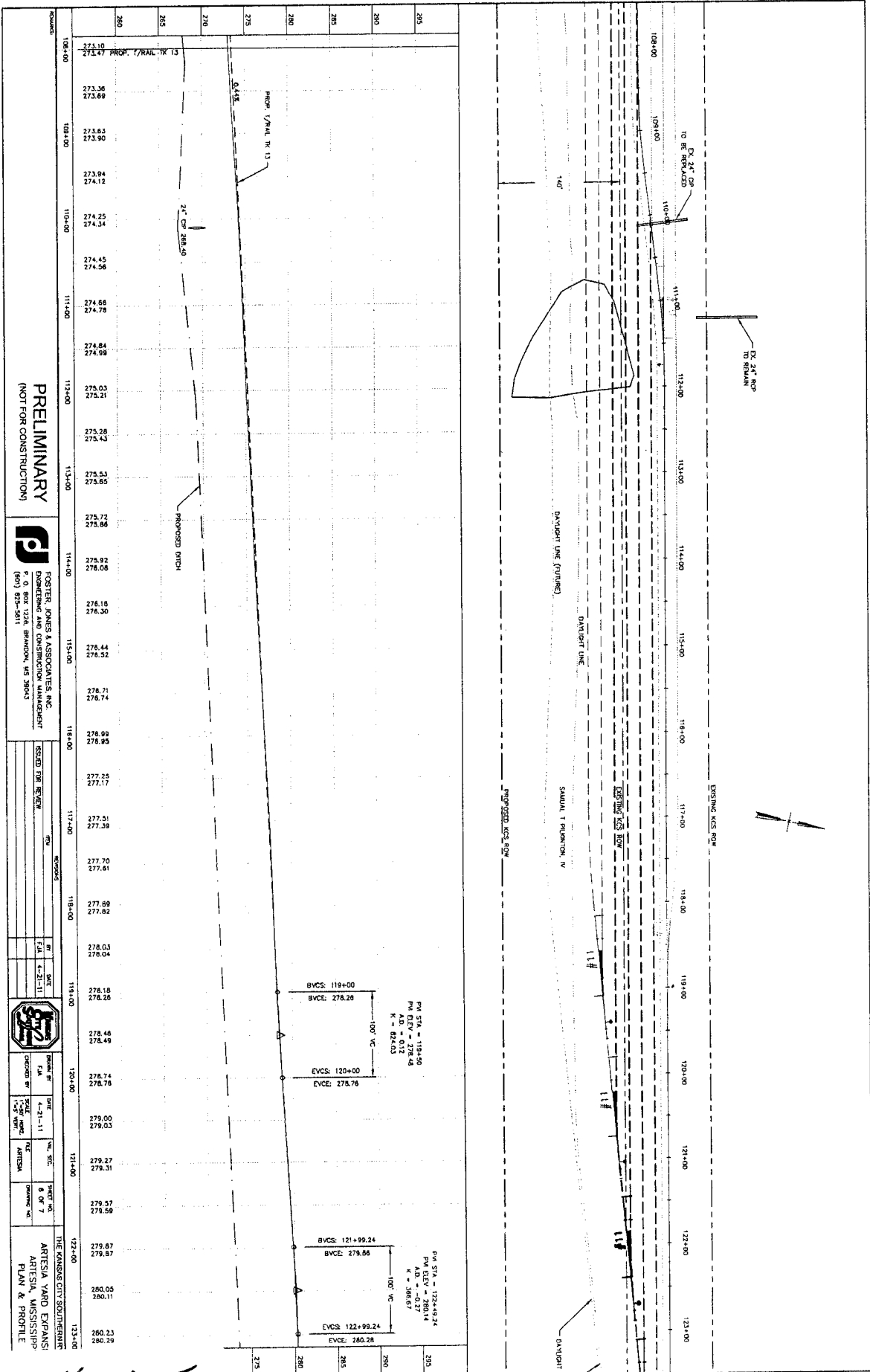

PRELIMINARY
(NOT FOR CONSTRUCTION)



FOSTER JONES ASSOCIATES, INC.
ENGINEERING AND CONSTRUCTION MANAGEMENT
P. O. BOX 1226, BRANSON, MO 64604
(800) 828-5811

DATE	BY	REVISION
1-21-11	FJA	ISSUED FOR REVIEW



DATE	BY	REVISION
4-21-11	FJA	APPROVED FOR CONSTRUCTION

THE KANSAS CITY SOLUTIONS
ARTESIA YARD EXPANSION
ARTESIA, MISSISSIPPI
PLAN & PROFILE

PM STA = 119+50
PV ELEV = 278.46
MS = 0.12
K = 82+00

BVCS: 119+00
BVCE: 278.28

EVCS: 120+00
EVCE: 278.76

PM STA = 122+49.24
PV ELEV = 280.14
MS = 0.12
K = 186.67

BVCS: 121+99.24
BVCE: 279.66

EVCS: 122+99.24
EVCE: 280.28

SAM2011-00660-JMT
Encl 10 of 11

