



REPLY TO
ATTENTION OF:

DEPARTMENT OF THE ARMY
U.S. ARMY ENGINEER DISTRICT, MOBILE DISTRICT
P.O. BOX 2288
MOBILE, ALABAMA 36628-0001

Regulatory Division
Coastal Branch

August 14, 2009

**JOINT PUBLIC NOTICE SAM-2008-1431-SMZ
U.S. ARMY CORPS OF ENGINEERS**

**MISSISSIPPI DEPARTMENT OF ENVIRONMENTAL QUALITY
OFFICE OF POLLUTION CONTROL**

MISSISSIPPI DEPARTMENT OF MARINE RESOURCES

HANCOCK COUNTY UTILITY AUTHORITY PROJECT S5

NORTHERN REGIONAL WASTEWATER TREATMENT FACILITY

KILN, HANCOCK COUNTY, MISSISSIPPI

TO WHOM IT MAY CONCERN:

This District has received an application for a Department of the Army permit pursuant to Section 404 of the Clean Water Act (33 USC 1344) and Section 10 of the Rivers and Harbors Act (33 USC 403). Please communicate this information to interested parties.

APPLICANT: Hancock County Utility Authority
Attention: Mr. David Pitalo
401 Gulfside Street
Waveland, Mississippi 39576

AGENT: Carollo Engineers
Attention: Mr. Barry Hampson
14785 Preston Road, Suite 950
Dallas, Texas 75254

WATERWAY: Wastewater Treatment Facility: Jourdan River and adjacent wetlands on Texas Flat Road, Kiln, Hancock County, Mississippi (Section 35, Township 7 South, Range 5 West (Lat. 30.4118° N; Long. -88.7581° W). Pipelines and pump station: Wetlands along the west side of Highway 603 north of Bayou Lacroix in Hancock County, Mississippi.

WORK: The purpose of the proposed project is to provide centralized wastewater service and capacity to the community of Kiln, Mississippi. Most of the existing Kiln residential and commercial community is served by on-site septic systems which are not adequate to meet current needs. The proposed centralized wastewater service is anticipated to improve water quality in the Jourdan River watershed by the removal of individual on-site septic systems (i.e., septic tanks and drain fields).

CESAM-RD-C

Public Notice Number SAM-2008-1431-SMZ

As a major component of the project, a 1.5 MGD wastewater treatment facility will be constructed on a 9.1-acre portion of a 40-acre parcel located on Texas Flat Road. Approximately 8.3 acres of the proposed site are occupied by low-quality wetlands degraded by previous disturbance including substantial clearing; all of the wetlands at the site are proposed to be impacted by project activities, although approximately 2.3 acres of the impacted wetlands will be utilized as grassed drainage swales and a storm water detention pond. No work in the remainder of the 40-acre parcel is planned at this time. Effluent generated by the wastewater facility will be pumped through an 18-inch outfall pipe to a diffuser unit (with eight, 6-inch diffusers) placed in the tidally-influenced Jourdan River northwest of the Stennis Airport Runway; the diffuser unit will be located approximately 70 feet channel-ward in the river as reckoned from mean high water. Additionally, an 18-inch force main will be constructed parallel to the outfall pipeline along Texas Flat Road to bring wastewater to the facility. Impacts associated with outfall, parallel force main, and diffuser construction total 0.5 acre, all in previously-disturbed, low-quality wetlands

The project will also entail the construction of a terminal wastewater pump station to be located at a 0.64-acre wetland site south of Interstate 10 on the west side of Highway 603; 10-inch and 12-inch pipelines (force mains) connecting to the pump station will be constructed along 25-foot-wide easements on the west side of Highway 603. Approximately 4.4 acres of wetlands will be temporarily impacted by 25,403 linear feet of pipeline installation (clearing, followed by trench-and-backfill) along the easements. Original elevations and contours will be restored after the completion of work, and the areas will be re-seeded and allowed to re-vegetate with native species. Permanent impacts associated with pipeline construction total 0.5 acre; permanent impacts associated with pump station construction total 0.1 acre.

Mitigation for permanent impacts to jurisdictional wetlands will consist of purchasing the appropriate number of credits from a Corps-approved wetland mitigation bank.

The applicant has applied for certification from the State of Mississippi in accordance with Section 401(a)(1) of the Clean Water Act, and upon completion of the required advertising, a determination relative to certification will be made.

The applicant has certified that the proposed activity complies with and will be conducted in a manner that is consistent with the State Coastal Zone Management Program. A determination relative to consistency will be made by the Mississippi Department of Marine Resources.

This public notice is being distributed to all known interested persons in order to assist in developing facts on which a decision by the U.S. Army Corps of Engineers (Corps) can be based. For accuracy and completeness of the record, all data in support of or in opposition to the proposed work should be submitted in writing setting forth sufficient detail to furnish a clear understanding of the reasons for support or opposition. The decision whether to issue a permit will be based on an

CESAM-RD-C

Public Notice Number SAM-2008-1431-SMZ

evaluation of the probable impact, including cumulative impacts, of the proposed activity on the public interest. That decision will reflect the national concern for both protection and utilization of important resources.

The benefit which reasonably may be expected to accrue from the proposal must be balanced against its reasonably foreseeable detriments. All factors which may be relevant to the proposal will be considered, including the cumulative effects thereof; among those are conservation, economics, aesthetics, general environmental concerns, wetlands, cultural values, fish and wildlife values, flood hazards, flood plain values, land use, navigation, shoreline erosion and accretion, recreation, water supply and conservation, water quality, energy needs, safety, food production, and in general, the needs and welfare of the people.

The Corps is soliciting comments from the public; Federal, State, and local agencies and officials; Indian Tribes; and other interested parties in order to consider and evaluate the impacts of this proposed activity. Any comments received will be considered by the Corps to determine whether to issue, modify, condition or deny a permit for this proposal. To make this decision, comments are used to assess impacts on endangered species, historic properties, water quality, general environmental effects, and the other public interest factors listed above. Comments are used in the preparation of an Environmental Assessment and/or an Environmental Impact Statement pursuant to the National Environmental Policy Act. Comments are also used to determine the need for a public hearing and to determine the overall public interest of the proposed activity.

Any person may request, in writing, within the comment period specified in this notice, that a public hearing be held to consider this application. Requests for public hearings shall state with particularity, the reasons for holding a public hearing. The National Register of Historic Places has been consulted and no properties listed in or eligible for the National Register are known to exist which would be affected by the proposed work; by letter to the applicant's consultant dated 6 October 2008, the Mississippi Department of Archives and History determined that no cultural resources are likely to be affected by the project. This review constitutes the full extent of cultural resources investigations unless comment to this notice is received documenting that significant sites or properties exist which may be affected by this work, or that adequately documents that a potential exists for the location of significant sites or properties within the permit area. Copies of this notice are being sent to the State Historic Preservation Officer and the U.S. Department of the Interior, National Park Service, Division of Archeological Services. By letter to the applicant's consultant dated 23 July 2008, the U. S. Fish and Wildlife Service (FWS) determined that no threatened and endangered species or their critical habitat occur on the subject property, and anticipated no impacts to listed species will occur as a result of the project.

Correspondence concerning this Public Notice should refer to Public Notice Number SAM-2008-1431-SMZ and should be directed to the District Engineer, U.S. Army Engineer District, Mobile,

CESAM-RD-C

Public Notice Number SAM-2008-1431-SMZ

Post Office Box 2288, Mobile, Alabama 36628-0001, Attention: Coastal Branch, with a copy to the Mississippi Department of Environmental Quality, Office of Pollution Control, Post Office Box 10385, Jackson, Mississippi 39289, and the Mississippi Department of Marine Resources, 1141 Bayview Avenue, Suite 101, Biloxi, Mississippi 39530, in time to be received within 21 days of the date of this public notice.

If you have any questions concerning this publication, you may contact this office at telephone number (251) 690-2658, or by E-mail at: tad.m.zebryk@usace.army.mil. Please refer to the above Public Notice number.

For additional information about our Regulatory Program, please visit our web site at www.sam.usace.army.mil/RD/reg, and please take a moment to complete our customer satisfaction survey while you're there. Your responses are appreciated and will allow us to improve our services.

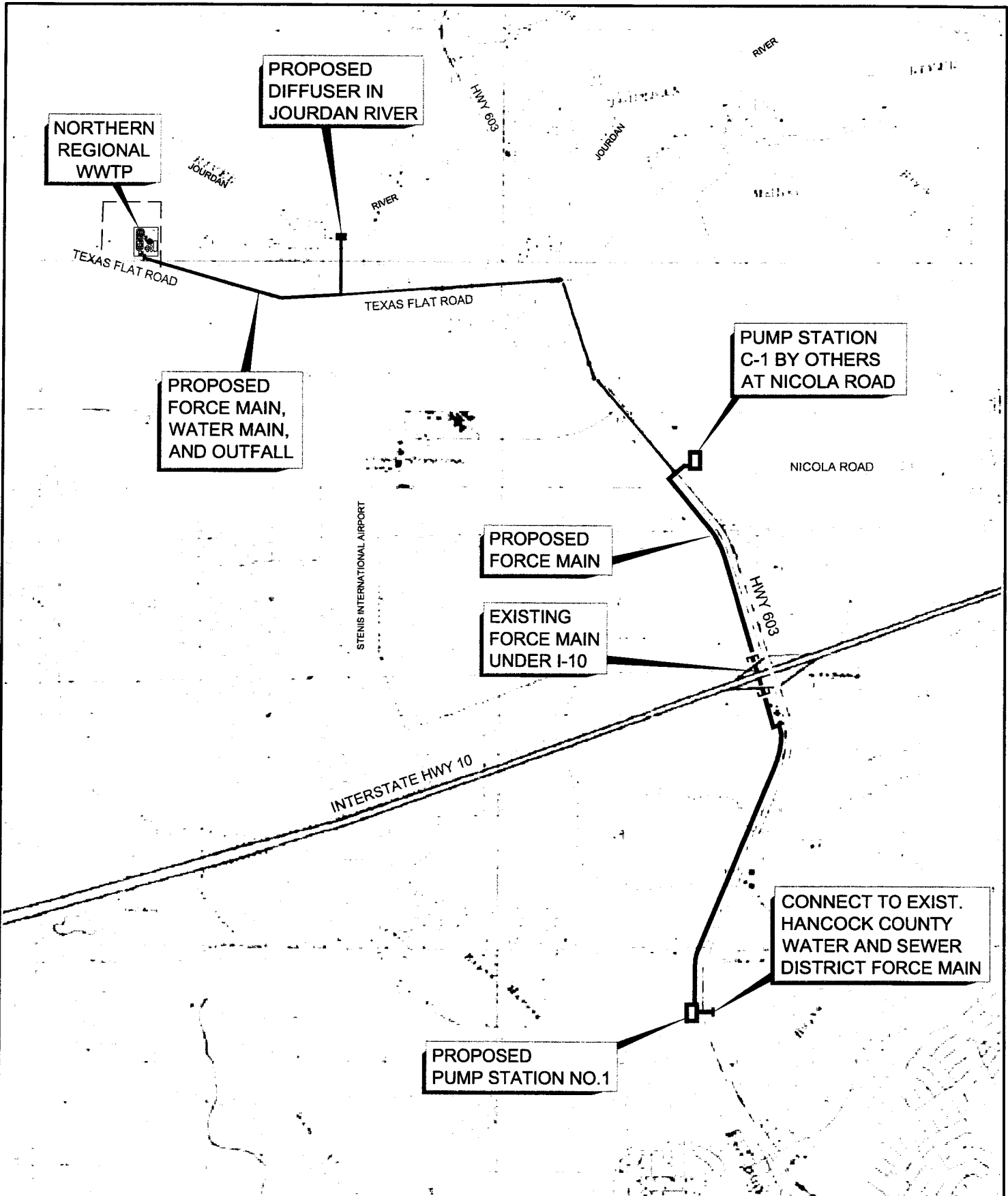

SCALE: 1" = 3000'



LEGEND

- LOCAL ROAD
- PROPOSED PIPELINES
- PROPOSED PUMP STATIONS

VICINITY MAP

FIGURE 1

NORTHERN REGIONAL WASTEWATER TREATMENT FACILITY
KILN, MISSISSIPPI PROJECT S5

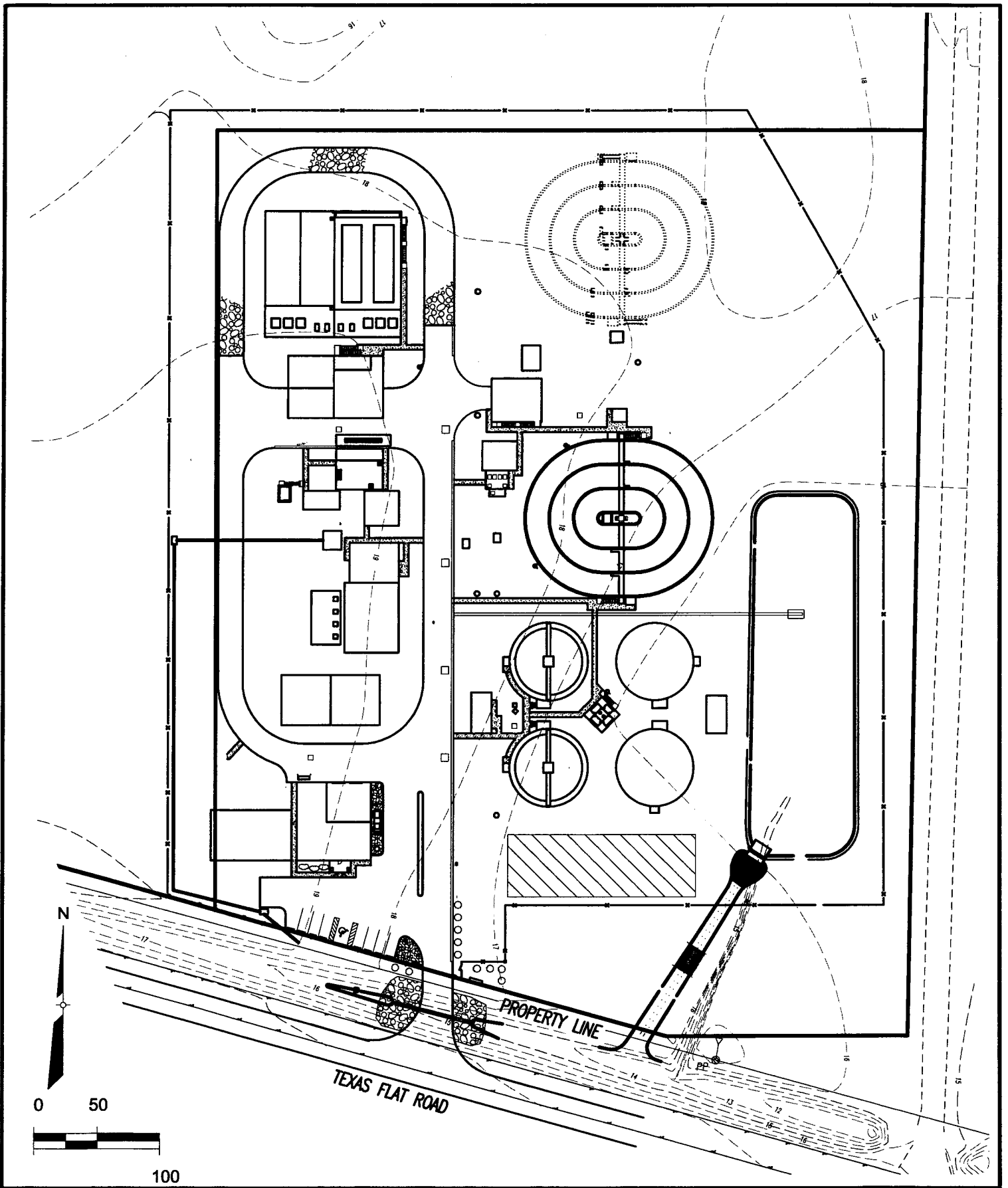

Espey Consultants, Inc.

Environmental & Engineering Services

REGIS. No. F-293

NORTHERN REGIONAL WASTEWATER TREATMENT
FACILITY KILN, MISSISSIPPI PROJECT S5

FIGURE 2

SITE PLAN (9.0 AC.)

FEBRUARY 2009

PN 8082.01

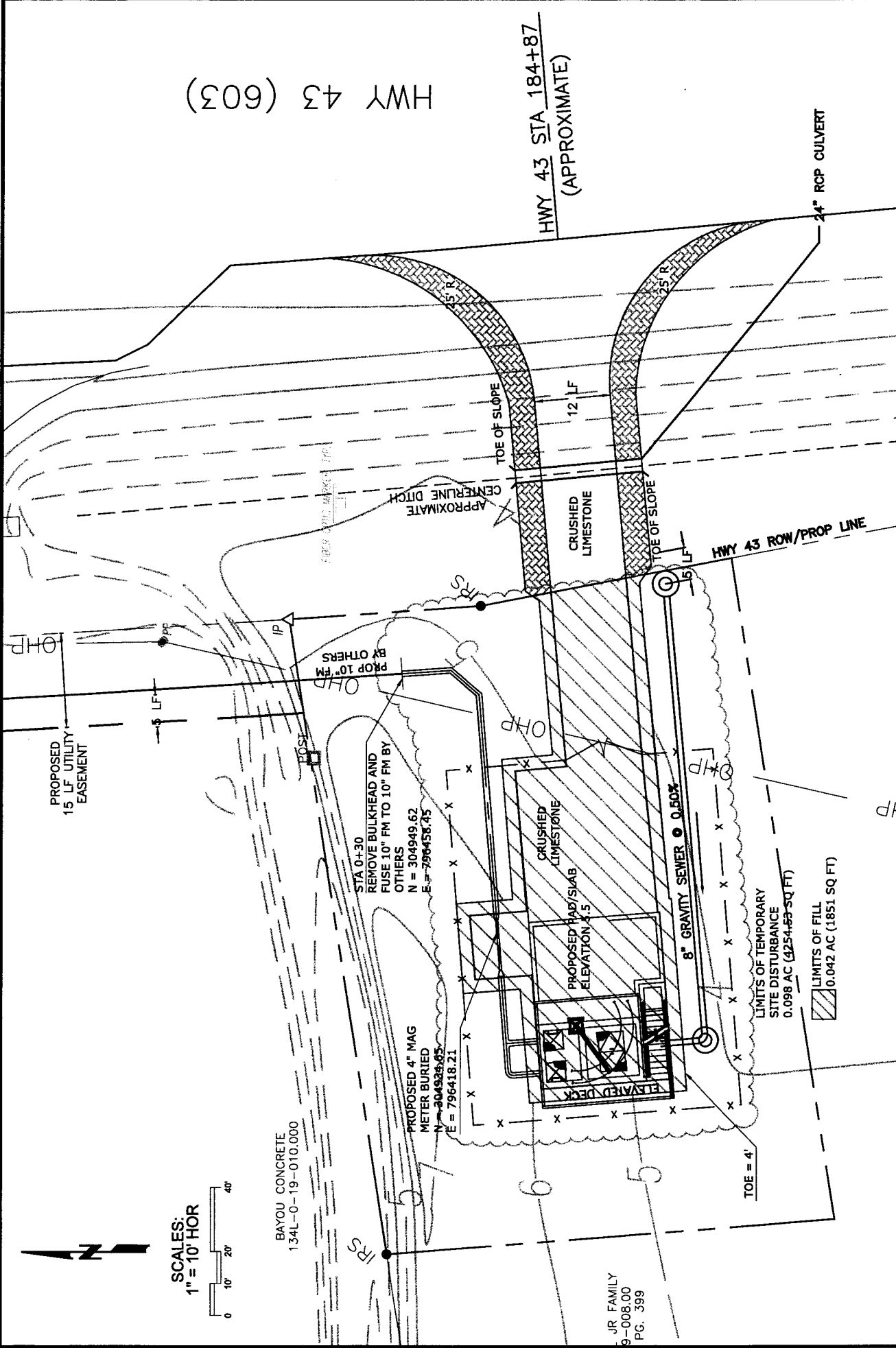

HANCOCK COUNTY UTILITY AUTHORITY
 NORTHERN REGIONAL WWTF
 FIGURE 6
 PUMP STATION NO.1
 SITE MAP

HWY 43 (603)

HWY 43 STA 184+87
(APPROXIMATE)

24" RCP CULVERT

HWY 43 ROW/PROP LINE

PROPOSED 15 LF UTILITY EASEMENT

PROPOSED 4" MAG METER BURIED IN CONCRETE

STATION 0+30 REMOVE BULKHEAD AND FUSE 10" FM TO 10" FM BY OTHERS

N = 304949.62
E = 796458.45

PROPOSED 4" MAG METER BURIED IN CONCRETE
N = 304938.85
E = 796418.21

CRUSHED LIMESTONE

PROPOSED PAD/SLAB ELEVATION 4.5

8" GRAVITY SEWER @ 0.50%

LIMITS OF TEMPORARY SITE DISTURBANCE 0.098 AC (4254.65 SQ FT)

LIMITS OF FILL 0.042 AC (1851 SQ FT)

SCALES: 1" = 10' HOR

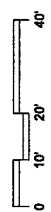

JR FAMILY
9-008.00
PG. 399