



DEPARTMENT OF THE ARMY
MOBILE DISTRICT, CORPS OF ENGINEERS
P.O. BOX 2288
MOBILE, ALABAMA 36628-0001

REPLY TO
ATTENTION OF:

CESAM-RD-C
REVISED PUBLIC NOTICE NO. SAM-2006-0621-MBM (Halley)

August 4, 2009

REVISED JOINT PUBLIC NOTICE
U.S. ARMY CORPS OF ENGINEERS AND
ALABAMA DEPARTMENT OF ENVIRONMENTAL MANAGEMENT

PROPOSED CONSTRUCTION OF A PRIVATE 14-SLIP MARINA ASSOCIATED WITH
A PROPOSED RESIDENTIAL DEVELOPMENT AT THE MOUTH OF THE DOG RIVER,
MOBILE, MOBILE COUNTY, ALABAMA

TO ALL CONCERNED: The U.S. Army Corps of Engineers, Mobile District, has received an application for a Department of the Army Permit pursuant to Section 10 of the Rivers and Harbors Act of 1899 (33 USC 403) and 404 of the Clean Water Act (33 USC 1344). This public notice is being distributed to all known interested persons to assist in developing facts on which a decision by the Corps can be based. Please communicate this information to interested parties.

APPLICANT: The Fish Camps on Dog River
Attention: Mr. Pat McAleer
Post Office Box 7002
Mobile, Alabama 36670

AGENT: Hosey Environmental, LLC
Attention: Mr. Arthur G. Hosey, Jr.
Post Office Box 464
Daphne, Alabama 36526

LOCATION: Mouth of Dog River at Mobile Bay, south shoreline east of Dauphin Island Parkway, Township 5 South, Range 1 West, Section 1, Mobile, Mobile County, Alabama.

WORK: The applicant proposes to perform the following work:

(1) Marina: Construct a private 14-slip marina at the mouth of Dog River in Mobile Bay for a 21 unit residential development "The Fish Camps at Dog River" on a 2.1-acre parcel of land southeast of the Dog River Bridge on Dauphin Island Parkway. The proposed marina would be 132 feet wide and extend 115 feet into the water on the northwest side and 145 feet on the northeast side as measured from the Mean High Tide line. It would cover approximately 0.33 acres of water bottoms (14,520 square feet). The marina would have seven 30-foot-long by 3-foot wide finger piers to create fourteen slips. Eight slips would be located on a 132-foot-long pier at the shoreline. A 110-foot-long by 5-foot-wide pier would be constructed on the east side of the marina with a 98-foot-long by 5-foot wide "L" on the outboard end. Six slips would be located on the "L" pier. The 208 linear feet of aluminum flow through breakwater would be installed on the outside edge under the "L" pier. A 50-foot-long by 5-foot-wide boardwalk will be constructed from the retaining wall over the riprap to access the marina. The marina slips would be assigned to individual home owners and not rented. There would be no fueling facilities or fish cleaning stations.

(2) Perform Maintenance Dredging: Approximately 3,082 cubic yards of sandy/clay would be mechanically dredged from 0.066 acres of existing water bottoms to minus-seven (-7) feet Mean Low Water but would not exceed the controlling depth of the Dog River Channel. Note: The area to be dredged includes 2,990 square feet of former upland area which has eroded into the Bay. The dredge area also includes a 125-foot-long by 29-foot-wide access channel. The excavated material will be placed in a 100 foot wide by 110 foot long temporary upland disposal/de-watering area. The disposal area would have an eight foot high berm. After drying, the excavated material will be hauled to an approved upland landfill.

(3) Shoreline Stabilization: The existing concrete debris along the shoreline and in the water would be removed. A 225 linear foot long retaining wall would be constructed above the existing mean high tide line to stabilize the steep bank and reduce the fill area by shortening the area of the slope. The toe of the bulkhead would be armored with 1,975 cubic yards of riprap using ALDOT class 2 riprap with ALDOT # 57 stone (four foot minimum) as choke out. The riprap would be placed in 2,700 square feet of shallow water bottoms (0.062 acres). This is a former upland area that has eroded in recent hurricanes and winter storms. The riprap will extend from the existing riprap on the right-of-way of Alabama State Highway 163 to the bulkhead on the adjoining property to the east. The eroded bank behind the riprap and retaining wall will be filled to natural grade with 132 cubic yards of clean fill material. The fill will cover approximately 2,112 square feet of eroded bank (0.048 acres).

The decision whether to issue a permit will be based on an evaluation of the probable impact, including cumulative impacts, of the proposal on the public interest. That decision will reflect the national concern for both protection and use of important resources. The benefit which reasonably may be expected to accrue from the proposal must be balanced against its reasonably foreseeable detriments. All factors and their cumulative effects relevant to the proposal will be considered, including conservation, economics, aesthetics, general environmental concerns, wetlands, cultural values, fish and wildlife values, flood hazards, floodplain values, land use, navigation, shoreline erosion and accretion, recreation, water supply and conservation, water quality, energy needs, safety, food and fiber production, mineral needs, property ownership, and in general the needs and welfare of the people.

To evaluate the impacts of this proposal the Corps is soliciting comments from the public; Federal, State and local agencies and officials; Indian Tribes; and other interested parties. For accuracy and completeness of the record, all data in support of or in opposition to the proposed work should be submitted in writing setting forth sufficient detail to furnish a clear understanding of the reasons for support or opposition. Comments will be considered to determine whether to issue, modify, condition or deny a permit. To make this decision, an Environmental Assessment is prepared in accord with the National Environmental Policy Act; impacts are assessed on endangered species, historic properties, water quality, general environmental effects, and the other public interest factors listed above. Comments are also used to determine the need for a public hearing and to determine the overall public interest. Anyone may request a public hearing to consider this proposal. Requests should provide in writing, within the specified comment period, detailed reasons for a hearing.

August 4, 2009

In accordance with Corps polices and Section 106 of the National Historic Preservation Act, this notice is being considered for the potential to effect cultural and historic properties. A preliminary determination by the Corps has concluded that there is a possibility of cultural resources within the project boundary or vicinity of the project that would be impacted by the development. We are seeking comment from the State Historic Preservation Officer (SHPO), federally-recognized American Indian tribes, local historical societies, museums, universities, the National Park Service, and concerned citizens regarding the existence or the potential for existence of significant cultural and historic properties within the permit area. Phase I and Phase II archaeological investigations have been conducted within the permit area and the Corps is beginning the consultation process with the SHPO and other interested parties. This review will constitute the full extent of cultural resources investigations unless comment to this notice is received documenting that significant sites or properties exist which may be affected by this work, or that adequately documents that a potential exists for the location of significant sites or properties.

The U.S. Department of the Interior List of Endangered and Threatened Wildlife and Plants indicates that the proposal will not affect listed species, or their critical habitat. Other impacts from dredge and fill activities will be evaluated by applying Environmental Protection Agency guidelines. The National Marine Fisheries Service requires the evaluation of impacts to Essential Fish Habitat of estuarine species. After review of public comments, the Alabama Department of Environmental Management will determine if the proposal complies with and will be operated or maintained in a manner consistent with the Clean Water Act and the Coastal Zone Management Program.

For additional information, please contact Mr. Harry Halley, Project Manager, telephone number (251) 690-3262. **Comments should be received by within 30 days from the date of this Public Notice.** Please refer to number **SAM-2006-621-MBM (Halley)** and direct your correspondence to the District Engineer, U.S. Army Engineer District, Mobile, Post Office Box 2288, Mobile, Alabama 36628-0001, Attention: Regulatory Division; and a copy to the Alabama Department of Environmental Management, Coastal Facility Section, 4171 Commanders Drive, Mobile, Alabama 36615.

MOBILE DISTRICT
U.S. Army Corps of Engineers

Enclosures

1. Vicinity Map
2. Parcel Map (aerial)
3. Plan View (3)
4. Dredge/Disposal Plan View
5. Typical Cross-Section View (2)

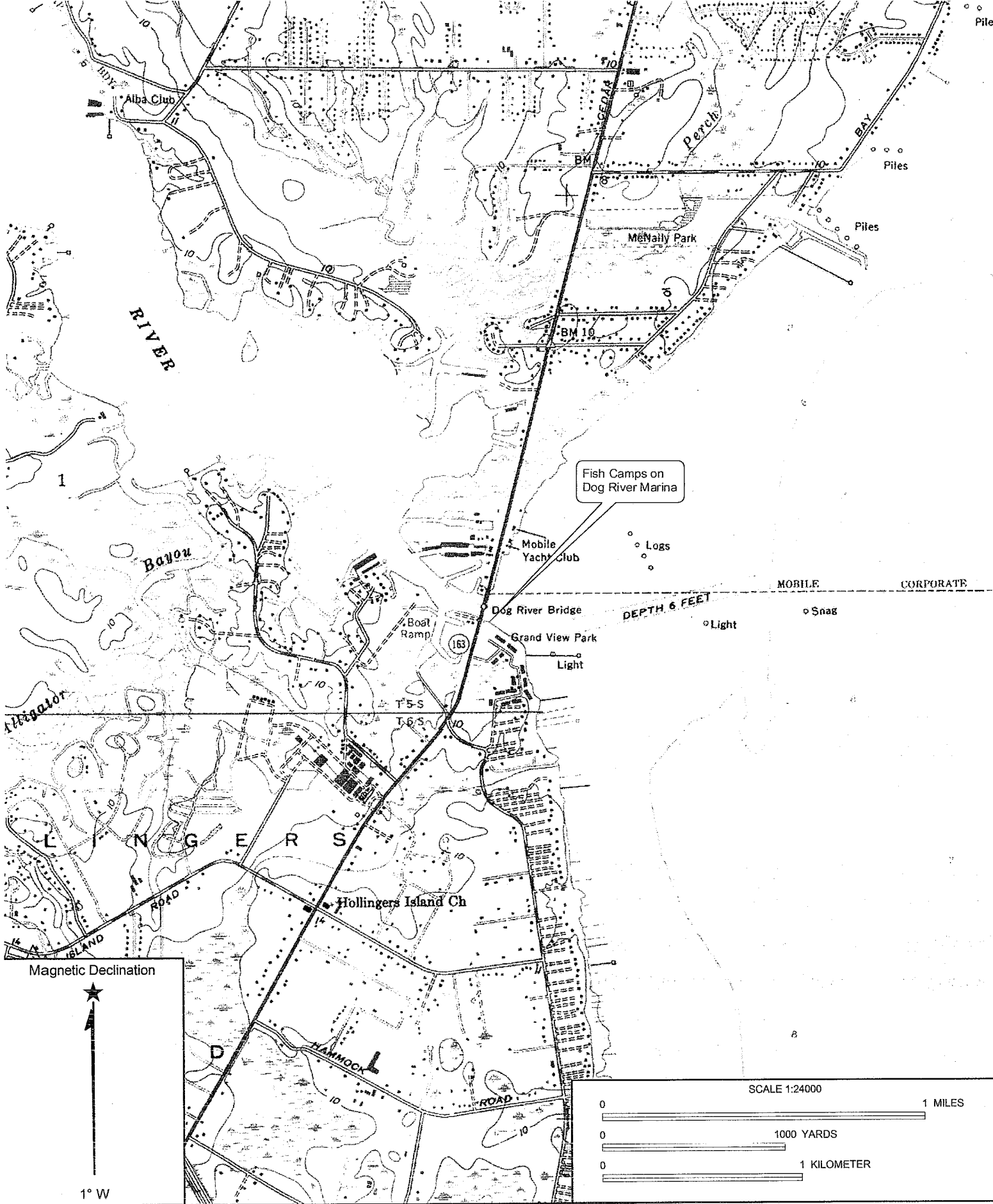

Fish Camps on Dog River Marina

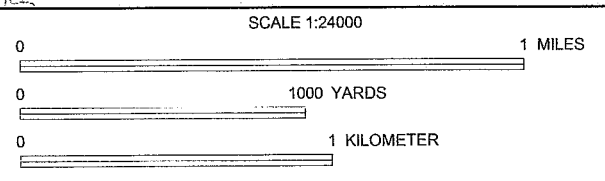
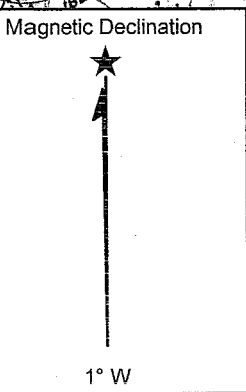

Name: HOLLINGERS ISLAND
 Date: 4/2/2009
 Scale: 1 inch equals 2000 feet

Location: 16 0395762 E 3381731 N NAD27
 Caption: Fish Camps on Dog River Marina



City Of Mobile

Dog River-Mobile Bay Convergence

Legend

2003 Parcels

Parcel of Interest

Tax Account No.
02-32-18-01-0-0005-001

Orthophoto Date: March 2002



1:2,400
1 inch equals 200 feet



The CITY OF MOBILE cannot verify the accuracy or currency of this map and the accuracy of the data used in its preparation. The CITY OF MOBILE does not warrant the accuracy, dimensions, or placement of any map feature thereon.

The CITY OF MOBILE makes no warranty as to the fitness of use for any purpose other than that intended. Any user of this map accepts the same as is, with all faults, and assumes all responsibility for the use hereof, and further warrants and agrees to hold the CITY OF MOBILE harmless from any use of this map, independent verification of all information combined on this map should be obtained by the user. The CITY OF MOBILE disclaims and shall not be held liable for any inaccuracies which may arise from this map product or the use thereof by any person or entity.

THIS MAP IS NOT A SUBSTITUTE FOR A FIELD SURVEY.

The CITY OF MOBILE has copyrighted this map product and hereby reserves all rights thereon, and neither this map, nor any portion thereof may be reproduced in any form or by any means without permission.

MAP DATE: November 2004

DATA SOURCES: City of Mobile GIS
Baldwin County Planning Commission
Photo scale: 1 pixel = 6 inches. Orthophoto data (from rectified March 2002 aerial photography) meets National Map Accuracy Standards for 1" = 100' scale mapping.
Horizontal error factor: 1.0 ± 0.1

GCS_North_American_1983
NAD 83 StatePlane Alabama West FIPS_5102_Feet



THE FISH CAMPS @ DOG RIVER

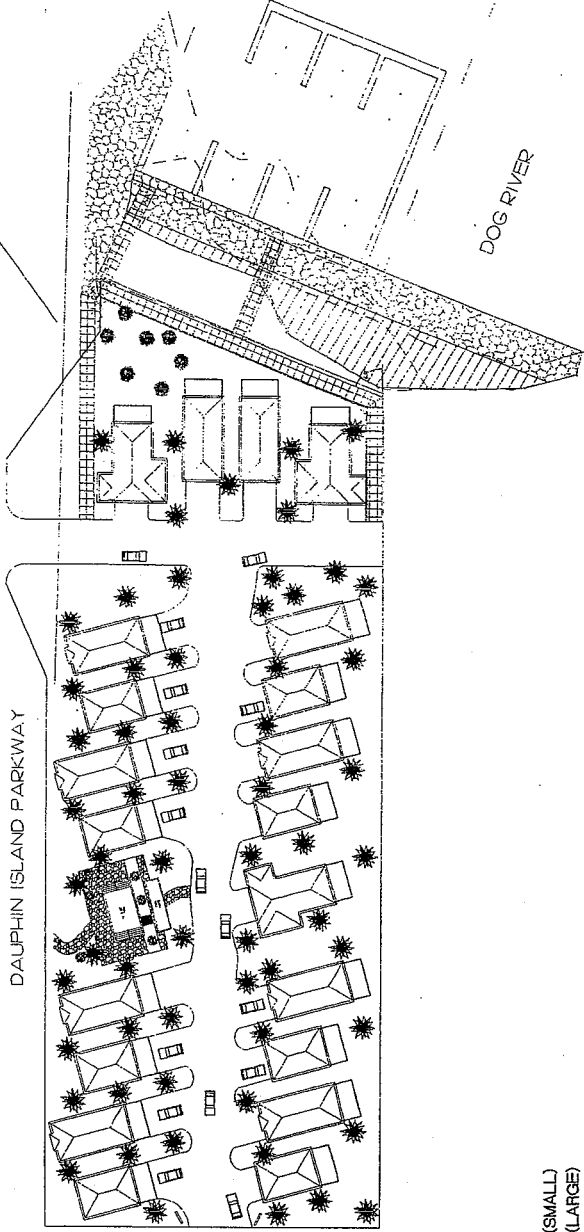

8	1 BEDROOM (SMALL)
2	1 BEDROOM (LARGE)
8	2 BEDROOM (SMALL)
1	2 BEDROOM (MEDIUM)
2	2 BEDROOM (LARGE)
21	TOTAL UNITS

1 SITE PLAN
SCALE 1" = 20'-0"

<p>OMO ARCHITECTURE 144 BRUNNEN, AVE. HELEN, ALASKA 99801 PHONE: 907-486-1800</p>	<p>PROJECT: FISH CAMPS DAUPHIN ISLAND PARKWAY DOG RIVER</p>	<p>OWNER: XX XX XX</p>		<p>OMC#0055 SHEET: 1/1/05 DRAWN BY: MM CHECKED BY: JTB SHEET NO. 1</p>	<p>1</p>
	<p>DATE: 1/1/05</p>	<p>SCALE: 1" = 20'-0"</p>	<p>PROJECT NO.:</p>	<p>DATE: 1/1/05</p>	<p>SCALE: 1" = 20'-0"</p>

THIS DRAWING AND ALL INFORMATION CONTAINED HEREIN ARE THE PROPERTY OF MATTHEW W. INGRAM, P.E. ANY REPRODUCTION OR TRANSMISSION OF THIS DRAWING OR ANY INFORMATION CONTAINED HEREIN WITHOUT THE WRITTEN PERMISSION OF MATTHEW W. INGRAM, P.E. IS STRICTLY PROHIBITED. THIS DRAWING IS VALID FOR THE PROJECT AND DATE SHOWN ONLY.

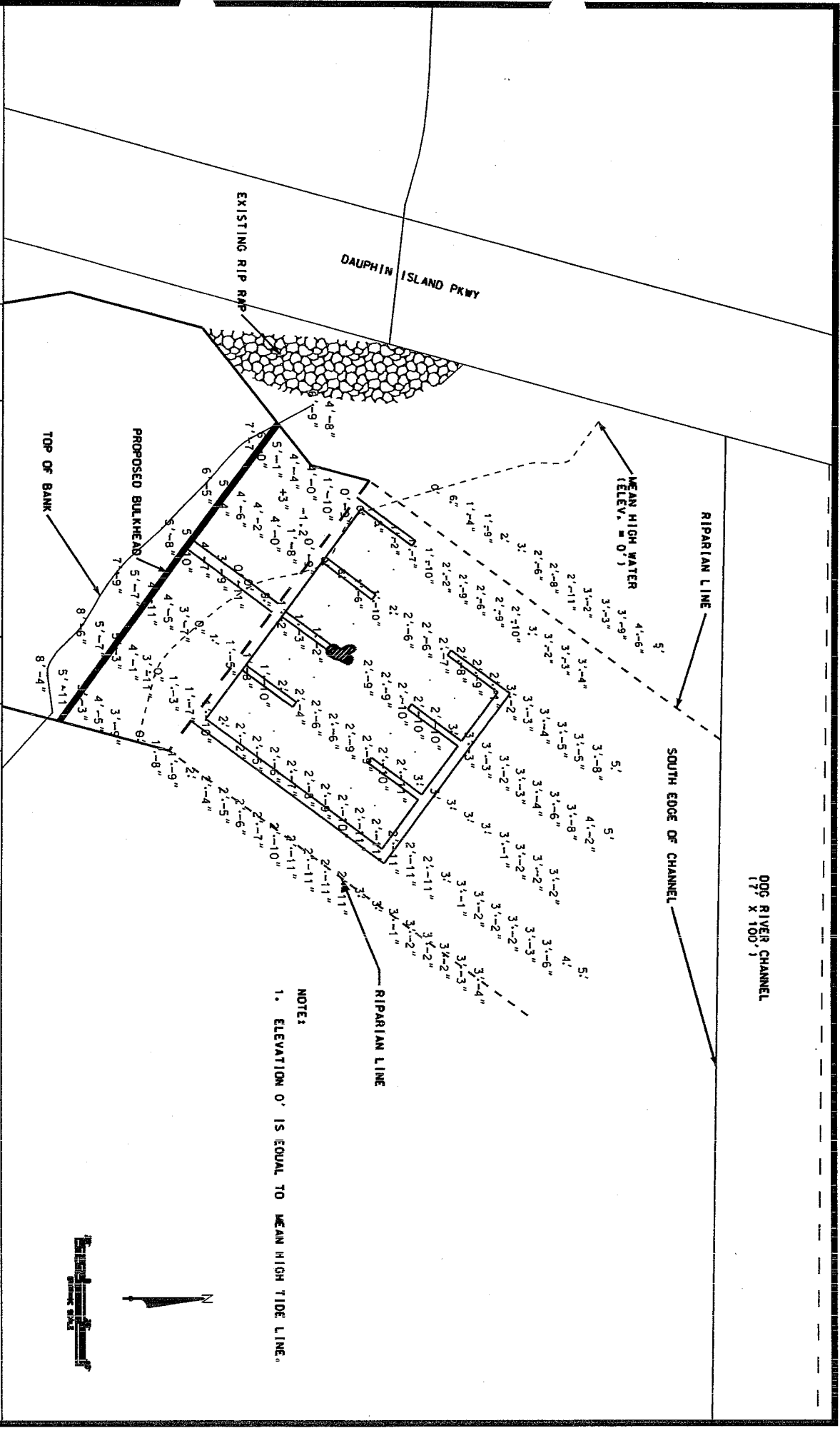

NOTE:
1. ELEVATION 0' IS EQUAL TO MEAN HIGH TIDE LINE.



REVISION NO. 1	DESCRIPTION	DATE	BY
REVISION NO. 1	DESCRIPTION	DATE	BY
REVISION NO. 1	DESCRIPTION	DATE	BY
REVISION NO. 1	DESCRIPTION	DATE	BY

MATTHEW W. INGRAM, P.E.		PAT MCALEER	
11941 VERTIGO DRIVE DAPHNE, AL 36526		DOG RIVER PRE PROJECT DEPTH	
TELEPHONE: 251-370-0392	EMAIL: mwi@ingrampe.com	DATE: 02/07/09	JOB NO. 1
SCALE: 1" = 20'	DROWN BY: []	CHECKED BY: []	DRAWING NO. 1
	APPROVED BY: []		REVISION NO. 1

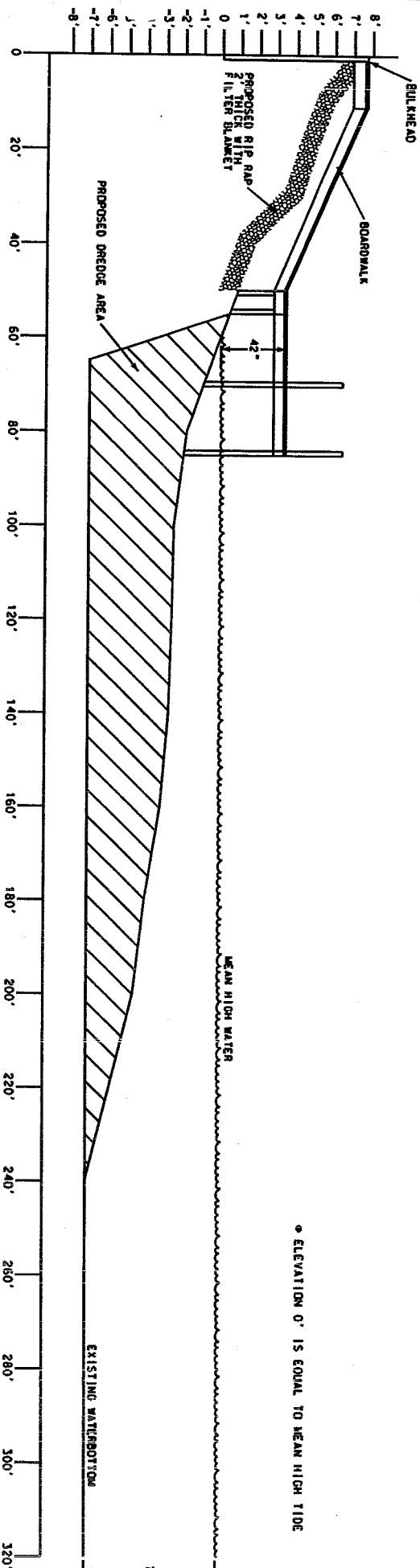

SECTION "A"
N.T.S.

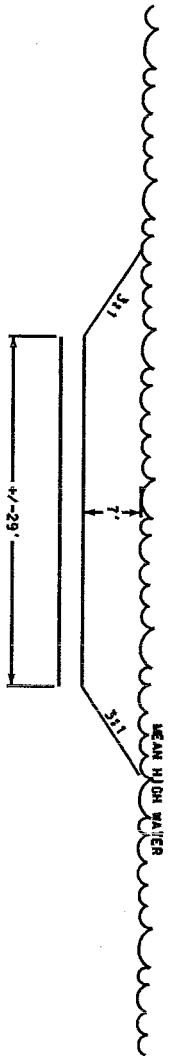

DREDGE CROSS SECTION OF CHANNEL
N.T.S.

THIS DRAWING REPRESENTS DESIGN PROPOSED BY MATTHEW W. INGRAM, P.E., AND PAT MCALEER, P.E. FOR THE PROPOSED DREDGE CROSS SECTION OF THE CHANNEL. THE DESIGNER'S RESPONSIBILITY IS LIMITED TO THE DESIGN AND CONSTRUCTION OF THE CHANNEL. THE DESIGNER IS NOT RESPONSIBLE FOR THE DESIGN OF THE CHANNEL OR THE DESIGN OF THE CHANNEL'S STRUCTURE. THE DESIGNER IS NOT RESPONSIBLE FOR THE DESIGN OF THE CHANNEL'S STRUCTURE.

REVISION NO. 1	DESCRIPTION	DATE	BY	DATE	BY	SCALE	DATE	DATE	DATE	DATE	DATE	DATE
REVISION NO. 1	DESCRIPTION	DATE	BY	DATE	BY	SCALE	DATE	DATE	DATE	DATE	DATE	DATE
REVISION NO. 1	DESCRIPTION	DATE	BY	DATE	BY	SCALE	DATE	DATE	DATE	DATE	DATE	DATE
REVISION NO. 1	DESCRIPTION	DATE	BY	DATE	BY	SCALE	DATE	DATE	DATE	DATE	DATE	DATE

MATTHEW W. INGRAM, P.E.

PAT MCALEER

11941 JERICHO DRIVE
DAPHNE, AL 36526
TELEPHONE: 251-370-0352
EMAIL: mwi@mcwll.com

000 RIVER CROSS SECTIONS



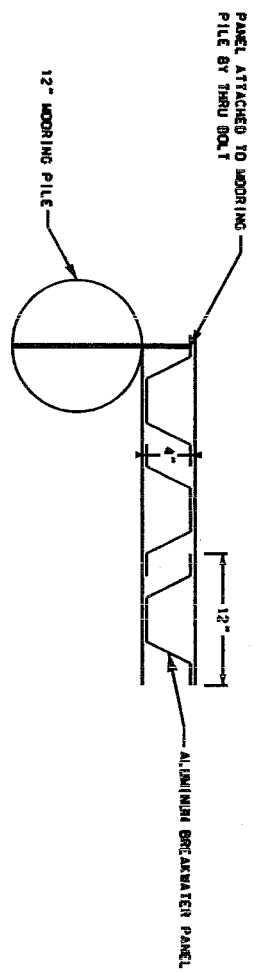
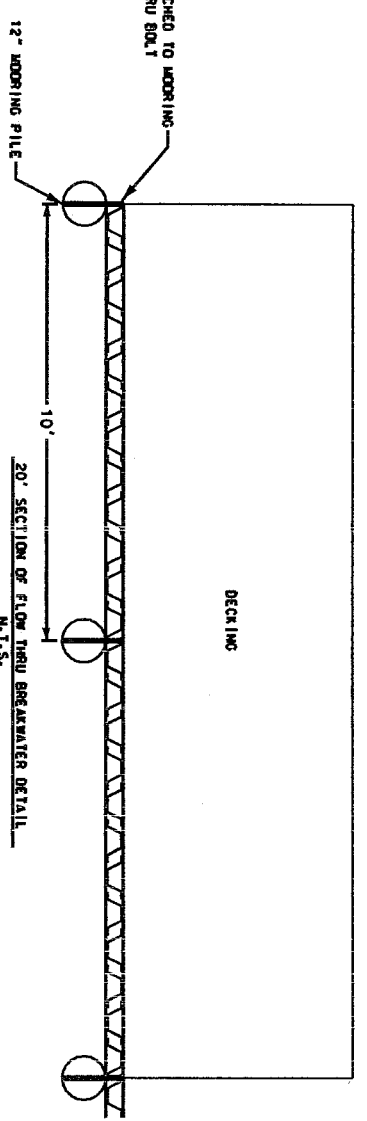
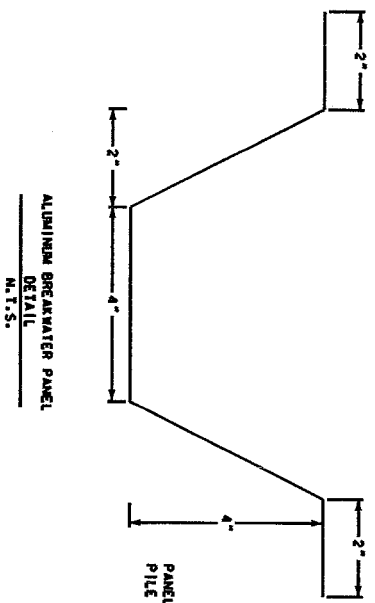

THIS DRAWING REPRESENTS THE DESIGN OF MATTHEW W. INGRAM, P.E., FOR SPECIFIC USE ON THIS PROJECT AND IS NOT TO BE REPRODUCED OR TRANSMITTED IN ANY FORM OR BY ANY MEANS, ELECTRONIC OR MECHANICAL, INCLUDING PHOTOCOPYING, RECORDING, OR BY ANY INFORMATION STORAGE AND RETRIEVAL SYSTEM, WITHOUT THE WRITTEN PERMISSION OF MATTHEW W. INGRAM, P.E. ANY REPRODUCTION OR TRANSMISSION OF THIS DRAWING WITHOUT THE WRITTEN PERMISSION OF MATTHEW W. INGRAM, P.E. IS STRICTLY PROHIBITED.

REVISION NO. 1	DESCRIPTION	DATE	BY
REVISION NO. 1	DESCRIPTION	DATE	BY
REVISION NO. 1	DESCRIPTION	DATE	BY
REVISION NO. 1	DESCRIPTION	DATE	BY

MATTHEW W. INGRAM, P.E.		PAT MCALEER	
11941 JERICHO DRIVE		TELEPHONE: 251-370-0352	
DUNELM, AL 36526		EMAIL: mwi@matthewingram.com	
SCALE: N.T.S.	DRAWN BY: []	CHECKED BY: []	DATE: 06/03/09
			JOB NO. 1
			DRAWING NO. 1
			REVISION NO. 1