

NOTES:

1. ALL ELEVATIONS SHOWN ARE REFERENCED TO FEET BELOW MEAN LOWER LOW WATER, (MLLW).
2. COORDINATES ARE REFERENCED TO ALABAMA ZONE PLANE COORDINATE SYSTEM 83 DATUM WEST.
3. SURVEYED BY: B. TABB
4. SURVEY VESSEL: IRVINGTON
5. TIDE: -0.60 THRU: +0.60
6. SURVEY DATE: 8/17/2011 & 2/4/2011
7. THE INFORMATION DEPICTED ON THIS MAP REPRESENTS THE RESULTS OF SURVEYS MADE ON THE DATES INDICATED AND DOES NOT INDICATE ANY CHANGES IN THE GENERAL CONDITIONS EXISTING AT THE TIME.
8. FREQUENCY SOUNDINGS: 208 KHZ.

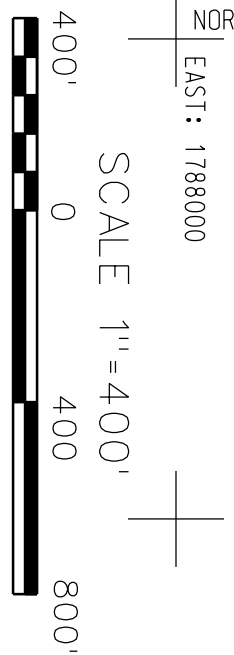
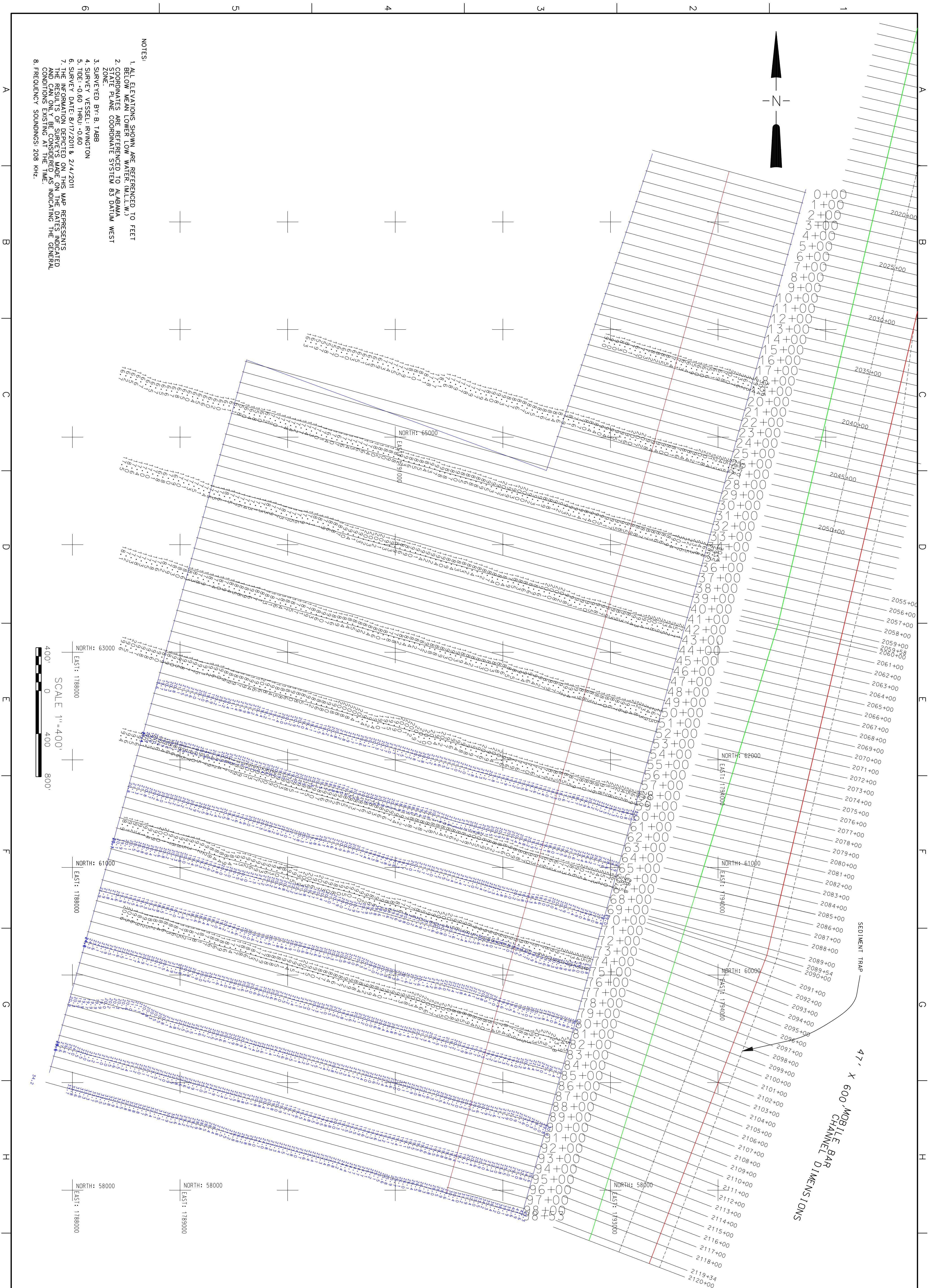

47' X 600' MOBILE BAR CHANNEL DIMENSIONS
 SEDIMENT TRAP

MOBILE HARBOR, ALABAMA

**SAND ISLAND DA
60+00 - 98+55
CONDITION SURVEY**

U.S. ARMY ENGINEER DISTRICT
CORPS OF ENGINEERS
MOBILE, ALABAMA

Designed By: D. CARTER	Date: AUG. 22, 2011
Drawn By: D. CARTER	File No. SI081711DA
Checked By:	I.S.O. Sheet File Name: SI081711.DGN
Reviewed By:	Solicitation Number: MBOI081711C

Symbol	Description	Date	Approved

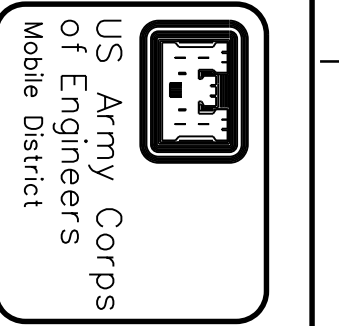

Sheet Reference Number:
1 OF 1